

For KCC Use:
Effective Date: 10-29-07
District # 3
SGA? Yes No

KANSAS CORPORATION COMMISSION
OIL & GAS CONSERVATION DIVISION

Form C-1
December 2002
Form must be Typed
Form must be Signed
All blanks must be Filled

NOTICE OF INTENT TO DRILL

Must be approved by KCC five (5) days prior to commencing well

Expected Spud Date November 7, 2007
month day year

OPERATOR: License# 32711
Name: Mike Becker
Address: 15135 Broadmoor
Stanley, KS 66223
City/State/Zip:
Contact Person: Mike Becker
Phone: 913-271-5179

CONTRACTOR: License# 32711
Name: Mike Becker

Spot East
NE NW NW NW Sec. 31 Twp. 29S S. R. 22 West
190 feet from N / S Line of Section
480 feet from E / W Line of Section
Is SECTION Regular Irregular?

(Note: Locate well on the Section Plat on reverse side)

County: Crawford
Lease Name: Shanolster Well #: 1
Field Name: McCune

Is this a Prorated / Spaced Field? Yes No
Target Formation(s): Bartlesville
Nearest Lease or unit boundary: 2 miles to north (10,500')

Ground Surface Elevation: 860 feet MSL

Water well within one-quarter mile: Yes No

Public water supply well within one mile: Yes No

Depth to bottom of fresh water: 120 feet

Depth to bottom of usable water: 1,000 feet

Surface Pipe by Alternate: 1 2

Length of Surface Pipe Planned to be set: 20 feet

Length of Conductor Pipe required: n/a

Projected Total Depth: 300 feet

Formation at Total Depth: Bartlesville

Water Source for Drilling Operations:
 Well Farm Pond Other Water tank

DWR Permit #: _____

(Note: Apply for Permit with DWR)

Will Cores be taken? Yes No

If Yes, proposed zone: _____

Well Drilled For: Well Class: Type Equipment:
 Oil Enh Rec Infield Mud Rotary
 Gas Storage Pool Ext. Air Rotary
 QWOD Disposal Wildcat Cable
 Seismic; # of Holes Other
 Other

If OWWO: old well information as follows:

Operator: _____

Well Name: _____

Original Completion Date: _____ Original Total Depth: _____

Directional, Deviated or Horizontal wellbore? Yes No

If Yes, true vertical depth: _____

Bottom Hole Location: _____

KCC DKT #: _____

AFFIDAVIT

The undersigned hereby affirms that the drilling, completion and eventual plugging of this well will comply with K.S.A. 55 et. seq. RECEIVED
It is agreed that the following minimum requirements will be met: KANSAS CORPORATION COMMISSION

1. Notify the appropriate district office **prior** to spudding of well;
2. A copy of the approved notice of intent to drill **shall be** posted on each drilling rig;
3. The minimum amount of surface pipe as specified below **shall be set** by circulating cement to the top; in all cases surface pipe **shall be set** through all unconsolidated materials plus a minimum of 20 feet into the underlying formation.
4. If the well is dry hole, an agreement between the operator and the district office on plug length and placement is necessary **prior to plugging**;
5. The appropriate district office will be notified before well is either plugged or production casing is cemented in;
6. If an ALTERNATE II COMPLETION, production pipe shall be cemented from below any usable water to surface within **120 days** of spud date.
Or pursuant to Appendix "B" - Eastern Kansas surface casing order #133,891-C, which applies to the KCC District 3 area, alternate II cementing must be completed within 30 days of the spud date or the well shall be plugged. **In all cases, NOTIFY district office** prior to any cementing.

I hereby certify that the statements made herein are true and to the best of my knowledge and belief.

Date: 10-21-07 Signature of Operator or Agent: Mike Becker Title: Operator

Remember to:

- File Drill Pit Application (form CDP-1) with Intent to Drill;
- File Completion Form ACO-1 within 120 days of spud date;
- File acreage attribution plat according to field proration orders;
- Notify appropriate district office 48 hours prior to workover or re-entry;
- Submit plugging report (CP-4) after plugging is completed;
- Obtain written approval before disposing or injecting salt water.
- If this permit has expired (See: authorized expiration date) please check the box below and return to the address below.

Well Not Drilled - Permit Expired

Signature of Operator or Agent: _____

Date: _____

For KCC Use ONLY

API # 15 - 037-21943-0000

Conductor pipe required None feet

Minimum surface pipe required 20 feet per Alt. Y02

Approved by: KM 10-24-07

This authorization expires: 4-24-08

(This authorization void if drilling not started within 6 months of approval date.)

Spud date: _____ Agent: _____

31
29
22E

IN ALL CASES PLOT THE INTENDED WELL ON THE PLAT BELOW

Plat of acreage attributable to a well in a prorated or spaced field

If the intended well is in a prorated or spaced field, please fully complete this side of the form. If the intended well is in a prorated or spaced field complete the plat below showing that the well will be properly located in relationship to other wells producing from the common source of supply. Please show all the wells and within 1 mile of the boundaries of the proposed acreage attribution unit for gas wells and within 1/2 mile of the boundaries of the proposed acreage attribution unit for oil wells.

API No. 15 - 037-21943-0000
Operator: Mike Becker
Lease: Shanolster
Well Number: 1
Field: McCune
Number of Acres attributable to well: 240 acres
QTR / QTR / QTR of acreage: NE - NW - NW NW

Location of Well: County: Crawford
190 feet from N / S Line of Section
480 feet from E / W Line of Section
Sec. 31 Twp. 29S S. R. 22 East West
Is Section: Regular or Irregular
If Section is Irregular, locate well from nearest corner boundary.
Section corner used: NE NW SE SW

PLAT

(Show location of the well and shade attributable acreage for prorated or spaced wells.)
(Show footage to the nearest lease or unit boundary line.)

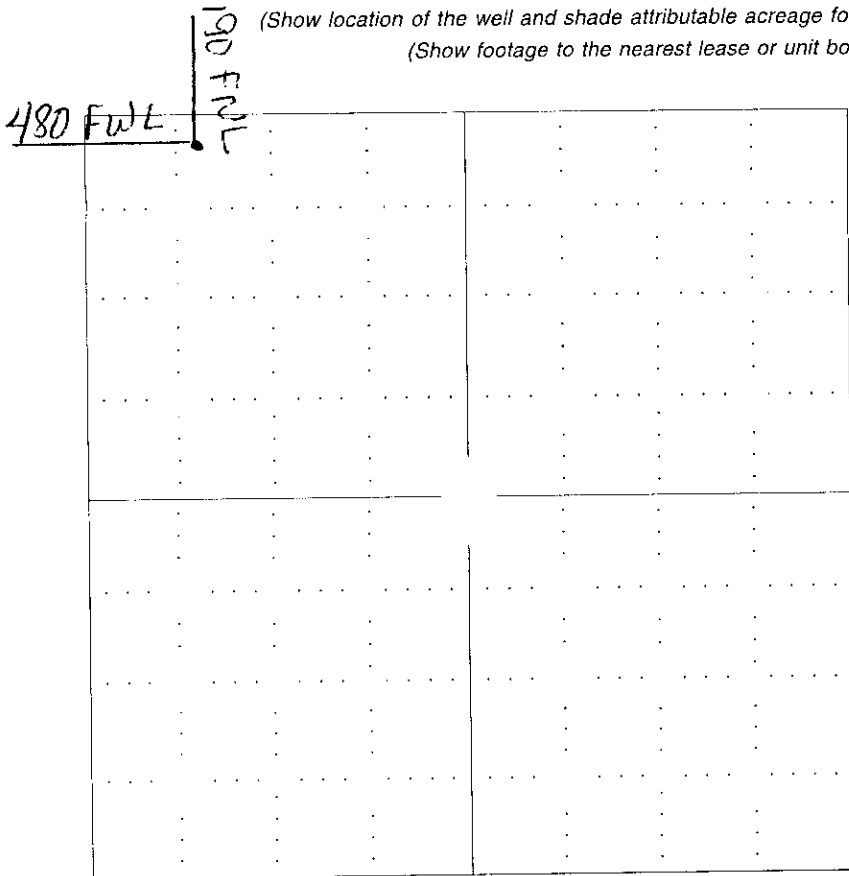

RECEIVED
KANSAS CORPORATION COMMISSION
OCT 24 2007
REGISTRATION DIVISION
LAWRENCE, KS

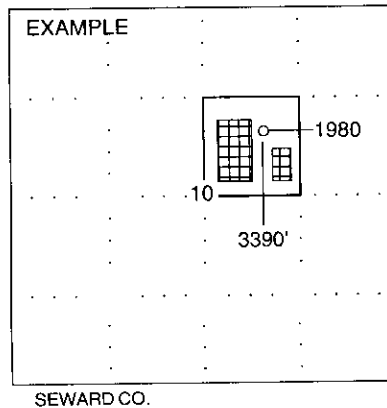

NOTE: In all cases locate the spot of the proposed drilling location.

In plotting the proposed location of the well, you must show:

1. The manner in which you are using the depicted plat by identifying section lines, i.e. 1 section, 1 section with 8 surrounding sections, 4 sections, etc.
2. The distance of the proposed drilling location from the section's south / north and east / west.
3. The distance to the nearest lease or unit boundary line.
4. If proposed location is located within a prorated or spaced field a certificate of acreage attribution plat must be attached: (CO-7 for oil wells; CG-8 for gas wells).

KANSAS CORPORATION COMMISSION
OIL & GAS CONSERVATION DIVISION

Form CDP-1
April 2004
Form must be Typed

APPLICATION FOR SURFACE PIT

Submit in Duplicate

Operator Name: Mike Becker		License Number: 32711	
Operator Address: 15135 Broadmoor, Stanley, KS 66223			
Contact Person: Mike Becker		Phone Number: (913) 271-5179	
Lease Name & Well No.: Kruger #2 Shanolster #1		Pit Location (QQQQ): NE . NW . NW . NW	
Type of Pit: <input type="checkbox"/> Emergency Pit <input type="checkbox"/> Burn Pit <input type="checkbox"/> Settling Pit <input checked="" type="checkbox"/> Drilling Pit <input type="checkbox"/> Workover Pit <input type="checkbox"/> Haul-Off Pit (If WP Supply API No. or Year Drilled)		Pit is: <input checked="" type="checkbox"/> Proposed <input type="checkbox"/> Existing If Existing, date constructed: _____ Pit capacity: 200 (bbls)	
		Sec. 31 Twp. 29S R. 22 <input checked="" type="checkbox"/> East <input type="checkbox"/> West 190 Feet from <input checked="" type="checkbox"/> North / <input type="checkbox"/> South Line of Section 480 Feet from <input type="checkbox"/> East / <input checked="" type="checkbox"/> West Line of Section Crawford County	
Is the pit located in a Sensitive Ground Water Area? <input type="checkbox"/> Yes <input checked="" type="checkbox"/> No		Chloride concentration: _____ mg/l (For Emergency Pits and Settling Pits only)	
Is the bottom below ground level? <input checked="" type="checkbox"/> Yes <input type="checkbox"/> No		Artificial Liner? <input type="checkbox"/> Yes <input checked="" type="checkbox"/> No	
		How is the pit lined if a plastic liner is not used? Clay	
Pit dimensions (all but working pits): 25 feet Length (feet) 8 feet Width (feet) _____ N/A: Steel Pits			
Depth from ground level to deepest point: 6 feet (feet)			
If the pit is lined give a brief description of the liner material, thickness and installation procedure. n/a		Describe procedures for periodic maintenance and determining liner integrity, including any special monitoring. n/a	
Distance to nearest water well within one-mile of pit n/a feet Depth of water well _____ feet		Depth to shallowest fresh water 120 feet. Source of information: _____ measured <input checked="" type="checkbox"/> well owner _____ electric log _____ KDWR	
Emergency, Settling and Burn Pits ONLY: Producing Formation: _____ Number of producing wells on lease: _____ Barrels of fluid produced daily: _____ Does the slope from the tank battery allow all spilled fluids to flow into the pit? <input type="checkbox"/> Yes <input type="checkbox"/> No		Drilling, Workover and Haul-Off Pits ONLY: Type of material utilized in drilling/workover: Water Number of working pits to be utilized: 1 Abandonment procedure: Drain water, fill back in with dirt Drill pits must be closed within 365 days of spud date.	
I hereby certify that the above statements are true and correct to the best of my knowledge and belief.			
10-21-07 Date		Mike Becker Signature of Applicant or Agent	
		RECEIVED KANSAS CORPORATION COMMISSION OCT 24 2007 CONSERVATION DIVISION WICHITA, KS	
KCC OFFICE USE ONLY			
Date Received: 10/24/07 Permit Number: _____ Permit Date: 10/24/07 Lease Inspection: <input type="checkbox"/> Yes <input checked="" type="checkbox"/> No			

15-037-21943-020