

For KCC Use:
Effective Date: 11-4-07
District #: 2
SGA? [X] Yes [] No

KANSAS CORPORATION COMMISSION 1013160
OIL & GAS CONSERVATION DIVISION

Form C-1
November 2005
Form must be Typed
Form must be Signed
All blanks must be Filled

NOTICE OF INTENT TO DRILL
Must be approved by KCC five (5) days prior to commencing well

Expected Spud Date: 10/22/2007
month day year

OPERATOR: License# 4058
Name: American Warrior, Inc.
Address 1: PO BOX 399
Address 2:
City: GARDEN CITY State: KS Zip: 67846 + 0399
Contact Person: Cecil O'Brate
Phone: 620-275-9230

CONTRACTOR: License# 5929
Name: Duke Drilling Co., Inc.

Well Drilled For: [X] Oil [] Enh Rec [] Infield [X] Mud Rotary
[X] Gas [] Storage [] Pool Ext. [] Air Rotary
[] Seismic; # of Holes [] Wildcat [] Cable
[] Other:
[] If OWWO: old well information as follows:

Operator:
Well Name:
Original Completion Date: Original Total Depth:

Directional, Deviated or Horizontal wellbore? [] Yes [X] No
If Yes, true vertical depth:
Bottom Hole Location:
KCC DKT #:

Spot Description: 170°N & 50°W of
SE SW SW Sec. 35 Twp. 33 S. R. 6 [] E [X] W
500 feet from [] N / [X] S Line of Section
940 feet from [] E / [X] W Line of Section

Is SECTION: [X] Regular [] Irregular?
(Note: Locate well on the Section Plat on reverse side)
County: Harper

Lease Name: PULLIAM Well #: 1-35
Field Name: Wildcat

Is this a Prorated / Spaced Field? [] Yes [X] No
Target Formation(s): Mississippi

Nearest Lease or unit boundary line (in footage): 500
Ground Surface Elevation: 1273 feet MSL

Water well within one-quarter mile: [] Yes [X] No
Public water supply well within one mile: [] Yes [X] No

Depth to bottom of fresh water: 120
Depth to bottom of usable water: 180
Surface Pipe by Alternate: [X] I [] II

Length of Surface Pipe Planned to be set: 200
Length of Conductor Pipe (if any):
Projected Total Depth: 4900

Formation at Total Depth: Mississippi
Water Source for Drilling Operations: [X] Well [] Farm Pond [] Other:

DWR Permit #:
(Note: Apply for Permit with DWR [])
Will Cores be taken? [] Yes [X] No
If Yes, proposed zone:

AFFIDAVIT

RECEIVED

The undersigned hereby affirms that the drilling, completion and eventual plugging of this well will comply with K.S.A. 55 et. seq. It is agreed that the following minimum requirements will be met:

- 1. Notify the appropriate district office prior to spudding of well;
2. A copy of the approved notice of intent to drill shall be posted on each drilling rig;
3. The minimum amount of surface pipe as specified below shall be set by circulating cement to the top; in all cases surface pipe shall be set through all unconsolidated materials plus a minimum of 20 feet into the underlying formation.
4. If the well is dry hole, an agreement between the operator and the district office on plug length and placement is necessary prior to plugging;
5. The appropriate district office will be notified before well is either plugged or production casing is cemented in;
6. If an ALTERNATE II COMPLETION, production pipe shall be cemented from below any usable water to surface within 120 DAYS of spud date. Or pursuant to Appendix "B" - Eastern Kansas surface casing order #133,891-C, which applies to the KCC District 3 area, alternate II cementing must be completed within 30 days of the spud date or the well shall be plugged. In all cases, NOTIFY district office prior to any cementing.

I hereby certify that the statements made herein are true and to the best of my knowledge and belief.
Date: 10/30/07 Signature of Operator or Agent: Sally R. Byers Title: Agent

For KCC Use ONLY
API # 15 - 077-21598-0000
Conductor pipe required 0 feet
Minimum surface pipe required 200 feet per ALT. [X] I [] II
Approved by: [Signature] 10-30-07
This authorization expires: 10-30-08
(This authorization void if drilling not started within 6 months of approval date.)
Spud date: Agent:

- Remember to:
- File Drill Pit Application (form CDP-1) with Intent to Drill;
- File Completion Form ACO-1 within 120 days of spud date;
- File acreage attribution plat according to field proration orders;
- Notify appropriate district office 48 hours prior to workover or re-entry;
- Submit plugging report (CP-4) after plugging is completed (within 60 days);
- Obtain written approval before disposing or injecting salt water.
- If this permit has expired (See: authorized expiration date) please check the box below and return to the address below.
[] Well Not Drilled - Permit Expired Date:
Signature of Operator or Agent:

Mail to: KCC - Conservation Division, 130 S. Market - Room 2078, Wichita, Kansas 67202

35
33
6
m
W



1013160

IN ALL CASES PLOT THE INTENDED WELL ON THE PLAT BELOW

Plat of acreage attributable to a well in a prorated or spaced field

If the intended well is in a prorated or spaced field, please fully complete this side of the form. If the intended well is in a prorated or spaced field complete the plat below showing that the well will be properly located in relationship to other wells producing from the common source of supply. Please show all the wells and within 1 mile of the boundaries of the proposed acreage attribution unit for gas wells and within 1/2 mile of the boundaries of the proposed acreage attribution unit for oil wells.

API No. 15 - 077-21598-0000
Operator: American Warrior, Inc.
Lease: PULLIAM
Well Number: 1-35
Field: Wildcat

Location of Well: County: Harper
500 feet from N / S Line of Section
940 feet from E / W Line of Section
Sec. 35 Twp. 33 S. R. 6 E W

Number of Acres attributable to well: _____
QTR/QTR/QTR/QTR of acreage: _____ - SE - SW - SW

Is Section: Regular or Irregular

If Section Is Irregular, locate well from nearest corner boundary.
Section corner used: NE NW SE SW

PLAT

(Show location of the well and shade attributable acreage for prorated or spaced wells.)

(Show footage to the nearest lease or unit boundary line.)

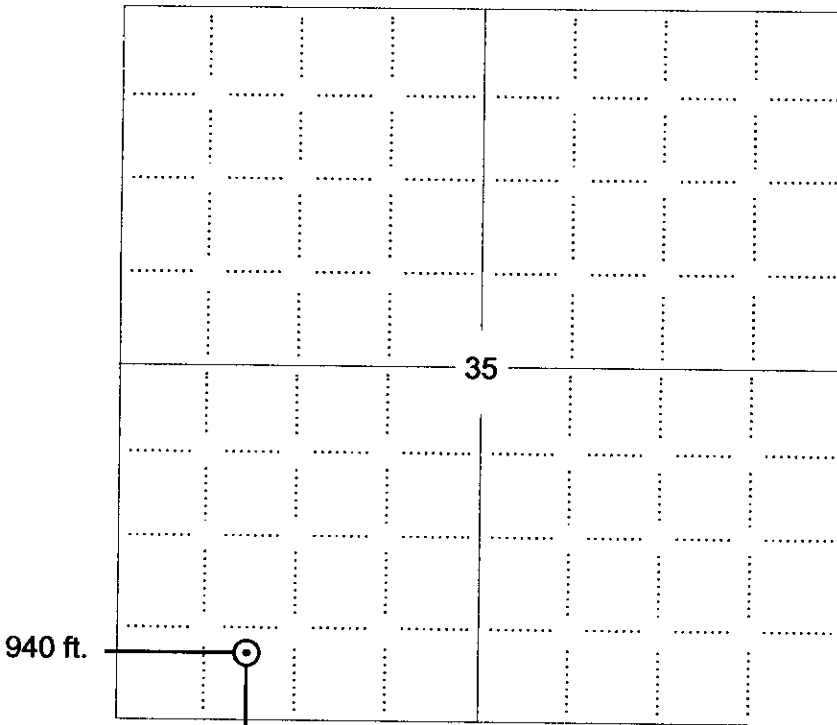

NOTE: In all cases locate the spot of the proposed drilling location.

500 ft.

In plotting the proposed location of the well, you must show:

1. The manner in which you are using the depicted plat by identifying section lines, i.e. 1 section, 1 section with 8 surrounding sections, 4 sections, etc.
2. The distance of the proposed drilling location from the south / north and east / west outside section lines.
3. The distance to the nearest lease or unit boundary line (in footage).
4. If proposed location is located within a prorated or spaced field a certificate of acreage attribution plat must be attached: (C0-7 for oil wells; CG-8 for gas wells).

RECEIVED
KANSAS CORPORATION COMMISSION

OCT 30 2007

CONSERVATION DIVISION
WICHITA, KS

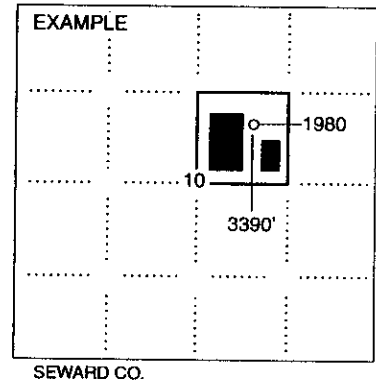

APPLICATION FOR SURFACE PIT

Submit in Duplicate

Operator Name: American Warrior, Inc.		License Number: 4058	
Operator Address: PO BOX 399		GARDEN CITY KS 67846	
Contact Person: Cecil O'Brate		Phone Number: 620-275-9230	
Lease Name & Well No.: PULLIAM 1-35		Pit Location (QQQQ): _____ SE _____ SW _____ SW Sec. 35 Twp. 33 R. 6 <input type="checkbox"/> East <input checked="" type="checkbox"/> West 500 Feet from <input type="checkbox"/> North / <input checked="" type="checkbox"/> South Line of Section 940 Feet from <input type="checkbox"/> East / <input checked="" type="checkbox"/> West Line of Section Harper _____ County	
Type of Pit: <input type="checkbox"/> Emergency Pit <input type="checkbox"/> Burn Pit <input type="checkbox"/> Settling Pit <input checked="" type="checkbox"/> Drilling Pit <input type="checkbox"/> Workover Pit <input type="checkbox"/> Haul-Off Pit (If WP Supply API No. or Year Drilled)		Pit is: <input checked="" type="checkbox"/> Proposed <input type="checkbox"/> Existing If Existing, date constructed: _____ Pit capacity: 4,800 (bbls)	
Is the pit located in a Sensitive Ground Water Area? <input checked="" type="checkbox"/> Yes <input type="checkbox"/> No		Chloride concentration: _____ mg/l (For Emergency Pits and Settling Pits only)	
Is the bottom below ground level? <input checked="" type="checkbox"/> Yes <input type="checkbox"/> No		Artificial Liner? <input type="checkbox"/> Yes <input checked="" type="checkbox"/> No	
		How is the pit lined if a plastic liner is not used? Native clay & mud	
Pit dimensions (all but working pits): _____ Length (feet) _____ Width (feet) _____ N/A: Steel Pits Depth from ground level to deepest point: _____ (feet) _____ No Pit			
If the pit is lined give a brief description of the liner material, thickness and installation procedure.		Describe procedures for periodic maintenance and determining liner integrity, including any special monitoring.	
Distance to nearest water well within one-mile of pit _____ feet Depth of water well _____ feet		Depth to shallowest fresh water _____ feet. Source of information: <input type="checkbox"/> measured <input type="checkbox"/> well owner <input type="checkbox"/> electric log <input checked="" type="checkbox"/> KDWR	
Emergency, Settling and Burn Pits ONLY: Producing Formation: _____ Number of producing wells on lease: _____ Barrels of fluid produced daily: _____ Does the slope from the tank battery allow all spilled fluids to flow into the pit? <input type="checkbox"/> Yes <input type="checkbox"/> No		Drilling, Workover and Haul-Off Pits ONLY: Type of material utilized in drilling/workover: fresh _____ Number of working pits to be utilized: _____ 3 Abandonment procedure: Allowed to dry then backfill _____ Drill pits must be closed within 365 days of spud date.	
RECEIVED			
I hereby certify that the above statements are true and correct to the best of my knowledge and belief. KANSAS CORPORATION COMMISSION			
Date: 10/30/07		Signature of Applicant or Agent: Sally R. Byers	
		OCT 30 2007 CONSERVATION DIVISION WICHITA, KS	
KCC OFFICE USE ONLY			
Date Received: 10/30/07		Permit Number: _____ Permit Date: 10/30/07	
		Lease Inspection: <input type="checkbox"/> Yes <input checked="" type="checkbox"/> No	

K-077-21598-0000



*Kathleen Sebelius, Governor
Thomas E. Wright, Chairman
Michael C. Moffet, Commissioner
Joseph F. Harkins, Commissioner*

October 29, 2007

Cecil O'Brate
American Warrior, Inc.
PO BOX 399
GARDEN CITY, KS67846-0399

Re: Drilling Pit Application
PULLIAM Lease Well No. 1-35
SW/4 Sec.35-33S-06W
Harper County, Kansas

Dear Cecil O'Brate:

District staff has inspected the above referenced location and has determined that an unsealed condition will present a pollution threat to water resources.

District staff has recommended that the reserve pit be lined with bentonite or native clay, constructed **without slots**, the bottom shall be flat and reasonably level and the free fluids must be removed. The fluids are to be removed from the reserve pit as soon as the Hutchinson Salt section has been drilled through and displacement of the fluids into the reserve pit has occurred. The fluids should be removed again within 72 hours after drilling operations have ceased.

If production casing is set all completion fluids shall be removed from the working pits daily. NO completion fluids or non-exempt wastes shall be placed in the reserve pit.

The fluids should be taken to an authorized disposal well. Please call the District Office at (316) 630-4000 when the fluids have been removed. Please file form CDP-5, Exploration and Production Waste Transfer, within 30 days of fluid removal. Conservation division forms are available through our office and on the KCC web site: kcc.ks.gov/conservation/forms/

A copy of this letter should be posted in the doghouse along with the approved Intent to Drill. If you have any questions or concerns please feel free to contact the District Office at (316) 630-4000.

RECEIVED
KANSAS CORPORATION COMMISSION

OCT 30 2007

CONSERVATION DIVISION
Emmy State Office Building, 130 S. Market, Room 2078, Wichita, KS 67202-3892
(316) 337-6200 • Fax: (316) 337-6211 • <http://kcc.ks.gov>

CONSERVATION DIVISION
WICHITA, KS