

STATE CORPORATION COMMISSION OF KANSAS  
OIL & GAS CONSERVATION DIVISION

WELL COMPLETION OR RECOMPLETION FORM  
ACO-1 WELL HISTORY

DESCRIPTION OF WELL AND LEASE

Operator: license # 5109  
name Aylward Drilling Company  
address 909 First Natl. Bank Bldg.  
Wichita, KS 67202  
City/State/Zip

Operator Contact Person Frank Hamlin  
Phone (316) 265-6656

Contractor: license # 5135  
name John O. Farmer, Inc.

Wellsite Geologist Kenneth B. Hamlin  
Phone (316) 265-6656

PURCHASER Mobil Oil Corporation

Designate Type of Completion  
 New Well  Re-Entry  Workover

Oil  SWD  Temp Abd  
 Gas  Inj  Delayed Comp.  
 Dry  Other (Core, Water Supply etc.)

If OWWO: old well info as follows:  
Operator  
Well Name  
Comp. Date Old Total Depth

WELL HISTORY

Drilling Method:  Mud Rotary  Air Rotary  Cable  
9-18-84 9-24-84 9-24-84  
Spud Date Date Reached TD Completion Date

3749  
Total Depth PBDT

Amount of Surface Pipe Set and Cemented at 267 feet

Multiple Stage Cementing Collar Used?  Yes  No

If Yes, Show Depth Set feet

If alternate 2 completion, cement circulated  
from 267 feet depth to surface w/ 185 SX cmt

API NO. 15-065-22,068-00-00

County Graham

NW SE SE Sec 17 Twp 9S Rge 21W East  
(location) West

.990 Ft North from Southeast Corner of Section  
.990 Ft West from Southeast Corner of Section  
(Note: locate well in section plat below)

Lease Name Cooley Well# 2

Field Name Morel

Producing Formation Arbuckle

Elevation: Ground 2240 KB 2245

Section Plat

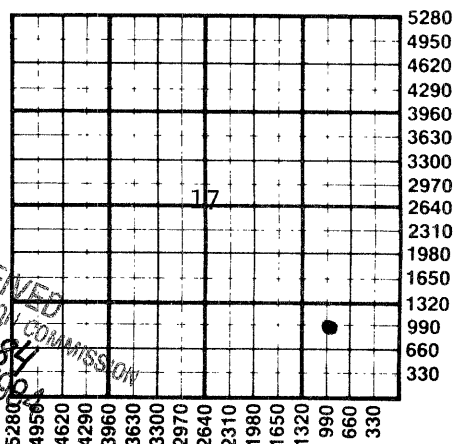

WATER SUPPLY INFORMATION

Source of Water:

Division of Water Resources Permit #

Groundwater Ft North From Southeast Corner and  
(Well) Ft. West From Southeast Corner of  
Sec Twp Rge East West

Surface Water Ft North From Southeast Corner and  
(Stream, Pond etc.) Ft West From Southeast Corner  
NE/4 Sec 17 Twp 10S Rge21W East West

Other (explain)  
(purchased from city, R.W.D.#)

Disposition of Produced Water:  Disposal  Repressuring

Docket # CD-67712

INSTRUCTIONS: This form shall be completed in duplicate and filed with the Kansas Corporation Commission, 200 Colorado Derby Building, Wichita, Kansas 67202, within 90 days after completion or recompletion of any well. Rules 82-3-130 and 82-3-107 apply.

Information on side two of this form will be held confidential for a period of 12 months if requested in writing and submitted with the form. See rule 82-3-107 for confidentiality in excess of 12 months.

One copy of all wireline logs and drillers time log shall be attached with this form. Submit CP-4 form with all plugged wells. Submit CP-111 form with all temporarily abandoned wells.

All requirements of the statutes, rules, and regulations promulgated to regulate the oil and gas industry have been fully complied with and the statements herein are complete and correct to the best of my knowledge.

Signature P. Frank Hamlin

Title Date 11-5-84

Subscribed and sworn to before me this 5th day of November 19 84

Notary Public

Date Commission Expires 4-1-87

K.C.C. OFFICE USE ONLY  
F  Letter of Confidentiality Attached  
C  Wireline Log Received  
C  Drillers Timelog Received  
Distribution  
 KCC  SWD/Rep  NGPA  
 KGS  Plug  Other (Specify)

Sec. 17 Twp. 9 Rge. 21W

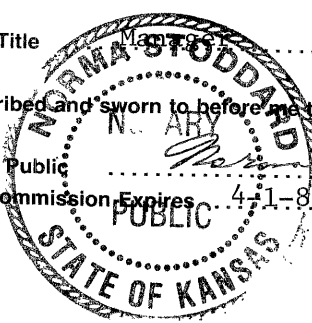

**SIDE TWO**

Operator Name Aylward Drilling Co. Lease Name Cooley Well# 2 SEC 17 TWP. 9S RGE. 21W  East  West

**WELL LOG**

**INSTRUCTIONS:** Show important tops and base of formations penetrated. Detail all cores. Report all drill stem tests giving interval tested, time tool open and closed, flowing and shut-in pressures, whether shut-in pressure reached static level, hydrostatic pressures, bottom hole temperature, fluid recovery, and flow rates if gas to surface during test. Attach extra sheet if more space is needed. Attach copy of log.

Drill Stem Tests Taken  Yes  No  
 Samples Sent to Geological Survey  Yes  No  
 Cores Taken  Yes  No

**Formation Description**  
 Log  Sample

Shale & Sand	0	1215
Sand	1215	1415
Red Bed	1415	1713
Anhydrite	1713	1753
Shale & Shells	1753	1885
Shale	1885	2175
Shale & Lime	2175	3505
Lime	3505	3749

Name	Top	Bottom
Topeka	3147	(- 902)
Heebner	3400	(-1155)
Toronto	3424	(-1179)
Lansing	3439	(-1194)
Arbuckle	3744	(-1499)
T.D.	3750	(-1505)

DST#1 3728-3749  
 30-30-60-30  
 Strong blow throughout  
 Rec: 420' GIP  
 2112' Cln. Gsy. Oil  
 120' HOCGM  
 IBHP 903 FBHP 923  
 IFP 173/759 FFP 817/932  
 Temp. 108°

<b>CASING RECORD</b> <input type="checkbox"/> new <input type="checkbox"/> used							
Report all strings set - conductor, surface, intermediate, production, etc.							
Purpose of string	size hole drilled	size casing set (in O.D.)	weight lbs/ft.	setting depth	type of cement	# sacks used	type and percent additives
Surface	12-1/4"	8-5/8"		267'	20/40 Poz.	185	2% gel, 3% C.C.
Production	7-7/8"	5-1/2"		3745'	Common	75 sx.	
D.V. stage tool set @ 1723 50/50 poz. 400 sx.							
<b>PERFORATION RECORD</b>				<b>Acid, Fracture, Shot, Cement Squeeze Record</b>			
shots per foot	specify footage of each interval perforated			amount and kind of material used			Depth
	Open hole completion			Completed Natural			3745-50
<b>TUBING RECORD</b>							
size 2 7/8" set at 3020 packer at				Liner Run <input type="checkbox"/> Yes <input type="checkbox"/> No			
Date of First Production 10-26-84	Producing method <input type="checkbox"/> flowing <input checked="" type="checkbox"/> pumping <input type="checkbox"/> gas lift <input type="checkbox"/> Other (explain)						
Estimated Production Per 24 Hours	Oil	Gas	Water	Gas-Oil Ratio	Gravity		
	74 Bbls	MCF	337 Bbls	CFPB	26°		

Disposition of gas:  vented  
 sold  
 used on lease

**METHOD OF COMPLETION**  
 open hole  perforation  
 other (specify) .....

Dually Completed.  
 Commingled

**PRODUCTION INTERVAL**  
 3745-3750