

STATE OF KANSAS
STATE CORPORATION COMMISSION

15-143-01158-00-00
WELL PLUGGING RECORD

Give All Information Completely
Make Required Affidavit
Mail or Deliver Report to:
Conservation Division
State Corporation Commission
211 No. Broadway
Wichita, Kansas

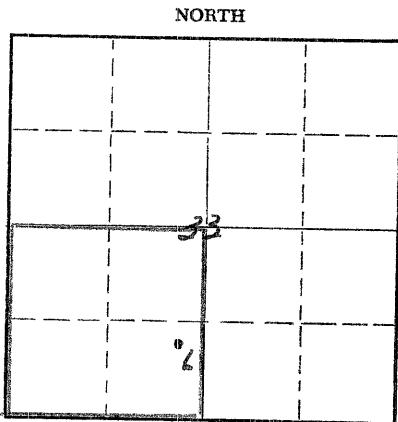

Locate well correctly on above
Section Plat

Rooks County, Sec. 33 Twp. 8S Rge. (E) 19 (W)
Location as "NE/CNW/SW" or footage from lines NE/4 SE/4 SW/4
Lease Owner Skelly Oil Company
Lease Name Frank Rostocil Well No. 6
Office Address Box 1650, Tulsa, Oklahoma
Character of Well (completed as Oil, Gas or Dry Hole) Oil
Date well completed April 15, 1949
Application for plugging filed November 7, 1956
Application for plugging approved November 9, 1956
Plugging commenced November 6, 1956
Plugging completed November 9, 1956
Reason for abandonment of well or producing formation Depleted Oil Well

If a producing well is abandoned, date of last production October 26, 1956
Was permission obtained from the Conservation Division or its agents before plugging was commenced? Yes

Name of Conservation Agent who supervised plugging of this well Mr. Eldon Petty
Producing formation Toronto Lime Depth to top 3186' Bottom 3191' Total Depth of Well 3450 Feet
Show depth and thickness of all water, oil and gas formations. PB 3193'

OIL, GAS OR WATER RECORDS

CASING RECORD

FORMATION	CONTENT	FROM	TO	SIZE	PUT IN	PULLED OUT
Arbuckle Lime	Oil	3446'	3450'	13-3/8"	193' 1"	None
Toronto Lime	Oil	3186'	3191'	8-5/8"	1436' 3"	None
				5-1/2"	3473' 0"	2633' 4"

Describe in detail the manner in which the well was plugged, indicating where the mud fluid was placed and the method or methods used in introducing it into the hole. If cement or other plugs were used, state the character of same and depth placed, from _____ feet to _____ feet for each plug set.

Sand 3193' to 3170'
4 sacks of cement 3170' to 3138'
Mud laden fluid 3138' to 600'
Crushed rock 600' to 590'
15 sacks of cement 590' to 552'
Mud 552' to 48'
Crushed rock 48' to 38'
15 sacks of cement 38' to 6'
Surface soil 6' to 0'

RECEIVED
STATE CORPORATION COMMISSION
NOV 17 1956
11/17/56
CONSERVATION DIVISION
Wichita, Kansas

Name of Plugging Contractor Ace Pipe Pulling Company
Address Box 304, Great Bend, Kansas

STATE OF Kansas, COUNTY OF Reno, ss.

H. J. Ramsley (employee of owner) or (owner or operator) of the above-described well, being first duly sworn on oath, says: That I have knowledge of the facts, statements, and matters herein contained and the log of the above-described well as filed and that the same are true and correct. So help me God.

(Signature)

Box 391, Hutchinson, Kansas
(Address)

SUBSCRIBED AND SWORN TO before me this 16th day of November, 1956

My commission expires April 7, 1959

Josephine L. Johnson
Notary Public.

PLUGGING
FILE SEC 33T 8 R 19W
BOOK PAGE 114 LI E 28

15-163-01158-00-00

SKELLY OIL COMPANY

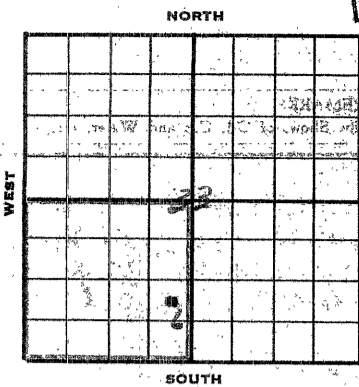

Well Record

Lease Name and No. Frank Russell Well No. 6 Elev. 2000
 Lease Description 3/4 Sec. 33-35-19N, 1/4 Sec 24 1/4 NW/4 and
containing; and 3/4 Sec. 4-95-19N, Books County, Kans
 Location made March 10, 19 49 by P. J. Cassen
990 feet from North line 330 feet from East line 33 1/4
990 feet from South line 330 feet from West line of 33 1/4

Work com'd 3/15 19 49 Rig comp'd 3/26 19 49 Drlg. com'd 3/26 19 49 Drlg. comp'd 4/24
 Rig Contractor Claude Wentworth Drilling Co., Inc.
 Drilling Contractor Claude Wentworth Drilling Co., Inc., Tulsa, Oklahoma
 Rotary Drilling from 707 to 3450' Cable Tool Drilling from To complete to
 Commenced Producing April 15, 19 49 Initial Prod. before shot or acid 17 hrs, 95 cu. ft. per
 Initial Prod. after shot or acid 208 8 hrs, 43 cu. ft. per
 to collar, 24 hr. 300 gal. 120 cu. ft.
 Dry Gas Well Press. _____ Volume _____
 Casing Head Gas Pressure _____ Volume _____
 Braden Head (2-3/8-2-3/8) Gas Pressure _____ Volume _____
 Braden Head (1-3/8-1-3/8) Gas Pressure _____ Volume _____

PRODUCING FORMATION Arbuckle Lime (Name) Top 3446' Bottom 3450' TOTAL DEPTH 3450'

CASING RECORD

OD	Size	Wt.	Thds.	Where Set	PULLED OUT			LEFT IN			KIND	Cond'n	Sacks Used	CEMENTING Method Employed
					Jts.	Feet	In.	Jts.	Feet	In.				
13-5/8"	44 1/2	BR		197'			5	197	1	Arbuckle	A	200	Halliburton	
8-5/8"	28 1/2	BR			(Lot 85)		33	769	0	Arbuckle	A			
8-5/8"	28 1/2	BR		1427'			21	667	3	Arbuckle	A	650	Halliburton	
5-1/2"	15 1/2	BR			(Lot 768)		42	1239	3	Arbuckle	A			
5-1/2"	15 1/2	BR			(Lot 776)		61	1987	3	Arbuckle	A			
5-1/2"	15 1/2	BR		3446'	(Lot 855)		6	246	6	Arbuckle	A	150	Halliburton	
(2-3/8" casing set 7' in collar, 8-5/8" casing set 5' in collar and 5 1/2" casing to derrick floor)														

Liner Set at _____ Length _____ Perforated at _____
 Liner Set at _____ Length _____ Perforated at _____
 Packer Set at _____ Size and Kind _____
 Packer Set at _____ Size and Kind _____

SHOT OR ACID TREATMENT RECORD

Date	FIRST		SECOND		THIRD		FOURTH	
	Ft. and	Gals. Qts.	Ft. and	Gals. Qts.	Ft. and	Gals. Qts.	Ft. and	Gals. Qts.
Shot Between								
Size of Shell								
Put in by (Co.)								
Length anchor								
Distance below Cas'g								
Damage to Casing or Casing Shoulder								

SIGNIFICANT GEOLOGICAL FORMATIONS

NAME	Top	Bottom	GAS		OIL		REMARKS
			From	To	From	To	
Hochberg shale	3162'						
Toronto lime	3183'						
Lansing lime	3204'						
Arbuckle lime	3446'				3446'	3450'	Fair por. & spotted sat.

CLEANING OUT RECORDS

	DATE COMMENCED	DATE COMPLETED	PROD. BEFORE	PROD. AFTER	REMARKS
1st					See Reverse for other d
2nd					" " " "
3rd					" " " "
4th					" " " "

PLUGGING BACK AND DEEPENING RECORDS

	Date Commenced	Date Completed	No. Feet Plugged Back or Deepened	Prod. Before	Prod. After	REMARKS
1st						See Reverse for other d
2nd						" " " "
3rd						" " " "
4th						" " " "

PLUGGING
 FILE SEC 33 T 8 R19W
 BOOK PAGE 114 LINE 28

(See Reverse for Record of Formation)

12-102-0128-00-00

RECORD OF FORMATIONS

FORMATION	TOP	BOTTOM	REMARKS
Surface clay and sand rock	0	43	Set and cemented 1 1/2" casing at 43.5', 1 1/2" S.S. steel casing at 197' with 200 sacks of cement and 4 sacks of gravel. Cement circulated.
Sand and shale	43	227	
Shale	227	350	TOP MEMBER SHALE 1941' TO 1942' 1943' 1944' 1945' 1946' 1947' 1948' 1949' 1950'
Shale and shale	350	1500	
Shale, shales and sand	1500	1434	
Schistosity	1434	1470	
Shale and shales	1470	2010	
Shale and lime	2010	2475	
Lime, sand and shale	2475	2530	
Lime and shale	2530	2600	
Lime	2600	2835	
Lime and shale	2835	3070	
Lime	3070	3284	3284

CASING RECORD

DATE	DEPTH	REMARKS
3295	3445	TOP MEMBER SHALE 1941'
3445	3470	Fair permeability and spotted saturation.
	3480'	Run Halliburton Electric Log Survey.

Set and cemented 2 1/2" of 8-5/8" OD, 22.500, 82 lbs. welded line steel casing (Lot 73) and 647' of 8-5/8" OD, 200', 82 lbs., 2-2, 1-10, Youngstown casing at 197' with 650 sacks of cement and 15 sacks of gravel. Run Halliburton temperature survey and found top of cement 310' from top. Cemented around top of 8-5/8" casing with 15 sacks of cement. April 5, drilled cement plug out of 8-5/8" casing and reconditioned the hole to bottom.

On April 6, set and cemented 2 1/2" of 8-5/8" OD, 11.5%, 82 lbs., 2-2, 1-10, Youngstown casing (Lot 73); 1287' of 2 1/2" OD, 11.5%, 82 lbs., 2-2, 1-10, Youngstown casing (Lot 76); and 1297' of 2 1/2" OD, 11.5%, 82 lbs., 2-2, 1-10, Youngstown casing (Lot 78) at 3445' with 150 sacks of cement. Finished cementing at 1:00 a.m. 4/6/49.

Moved in and rigged up cable tools and bailed the hole dry on April 13, 1949. Drilled cement plug and cleaned out to bottom, and 1 1/2" OD casing and cement job tested OK. Hole filled 400' with oil in 2 hours.

Run 2" tubing and rods, and on April 15, POG 17 hours, 93 barrels of oil and 14 barrels of water. On April 16, POG 14 hours, 66 bbls. of oil and 6 barrels of water.

On April 18, POG 4 hours on State Corporation formation physical potential test, 42.69 barrels of oil and 2 barrels of water established 26 psi potential of 128 barrels. This potential allows 25 barrels per acre for the remainder of April, 1949.

Tests were taken at 20' intervals from 20' to 1220' inclusive with no deviation from vertical noted.

CLEANING OUT RECORD

DATE COMPLETED	DATE COMPLETED	REMARKS
		See Reverse for details

PLUGGING BACK AND DEPTH RECORD

DATE COMPLETED	DATE COMPLETED	REMARKS
		PLUGGING
		FILE SEE 3478
		BOY PAGE 114 LINE 28

See Reverse for Record of Formations

PLUGGING BACK RECORD

Date Commenced: January 31, 1956
 Date Completed: February 17, 1956

Plugged back from 3450' to 3193' PB TD-3193'

Production Before: 3 barrels of oil and 97 barrels of water
 Production After: FOB 24 hours, 10 barrels of oil and 109 barrels of water

5 1/2" casing perforations open below bridging plug:
 3205'-3212' with 42 holes, 3220'-3226' with 36 holes, 3242'-3246'
 with 24 holes, 3282'-3290' with 48 holes, and 3296'-3307' with 54
 holes

Perforations open above bridging plug:
 Producing: 3186'-3191' with 30 holes

Producing Formation: Toronto Lime

Moved in and rigged up cable tools of Red Crow Drilling Company on January 31, 1956. Pulled rods and tubing and ran Lane-wells Omega Ray Survey. Set Baker bridging plug at 3320' and 5 1/2" casing tested dry.

Perforated 5 1/2" casing from 3296' to 3307' with 54 holes by Lane-wells, no shows. Treated through 5 1/2" casing with 500 gallons of Halliburton 15% acid as follows:

ACID TREATMENT NO. 1 - Between 3296' and 3307'

Treatment put in 2/2/56 by Halliburton, using 500 gallons of acid and 82 barrels of water.

TIME	CP	TP	REMARKS
5:57 pm			Start acid
6:01 pm			500 gallons of acid in
6:11 pm			Acid on formation
6:14 pm	650		
6:16 pm	575		
6:19 pm	575		Treatment completed

Swabbed through 5 1/2" casing 2 hours, 82 barrels of water used in treating, then bailed and tested 8 hours, 20 gallons of water per hour with some oil per hour. Set Baker bridging plug at 3292', and 5 1/2" casing tested dry.

Perforated 5 1/2" casing from 3282' to 3290' with 48 holes by Lane-wells, no shows. Treated through 5 1/2" casing with 500 gallons of Halliburton 15% acid as follows:

ACID TREATMENT NO. 2 - Between 3282' and 3290'

Treatment put in 2/3/56 by Halliburton, using 500 gallons of acid and 79 barrels of water.

TIME	CP	TP	REMARKS
1:40 pm			Start acid
1:44 pm			500 gallons of acid in
1:55 pm			Acid on formation
1:57 pm	600		
1:59 pm	550		
2:01 pm	525		Finish flush

Swabbed through 5 1/2" casing 2 1/2 hours, 79 barrels of water used in treating, no oil; bailed and tested 11 hours, 15 gallons of water and no oil per hour. Set Baker bridging plug at 3254' and perforated 5 1/2" casing from 3242' to 3246' with 24 holes by Lane-wells, no shows. Treated through 5 1/2" casing with 500 gallons of Halliburton 15% acid as follows:

ACID TREATMENT NO. 3 - Between 3242' and 3246'

Treatment put in 2/4/56 by Halliburton, using 500 gallons of acid and 76 barrels of water.

TIME	CP	TP	REMARKS
12:41 pm			Start acid
12:43 pm			Acid in
12:44 pm			Start to load hole
12:53 pm			Acid on formation
12:55 pm	700		
12:57 pm	300		
1:00 pm	350		Treatment completed

Swabbed through 5 1/2" casing 2 hours, 76 barrels of water used in treating; then swabbed 10 hours, 11.60 barrels of water with rainbow show of oil. Set Baker bridging plug at 3230', and 5 1/2" casing tested dry.

PLUGGING		
FILE	SEC 33 T 8	19W
BOOK	PAGE 114	LINE 28

00 50-82110-321-21

Perforated 5 1/2" casing from 3220' to 3226' with 36 holes by Lane-wells, no shows. Treated through 5 1/2" casing with 500 gallons of Halliburton 15% acid as follows:

ACID TREATMENT NO. 4 - Between 3220' and 3226'

Treatment put in 2/5/56 by Halliburton, using 500 gallons of acid and 77 barrels of water.

TIME	CP	TP	REMARKS
1:56 pm			Start acid
1:58 pm			Acid in
2:13 pm	150'		Acid on formation
2:18 pm	200'		
2:19 pm	250'		Finished flush

Swabbed through 5 1/2" casing 2 1/2 hours, 77 barrels of water used in treating; then swabbed 8 hours, 6 gallons of oil and 3 barrels of water per hour. Set Baker bridging plug at 3216' and perforated 5 1/2" casing from 3205' to 3212' with 42 holes by Lane-wells, no shows. Treated through 5 1/2" casing with 500 gallons of Halliburton 15% acid as follows:

ACID TREATMENT NO. 5 - Between 3205' and 3212'

Treatment put in 2/6/56 by Halliburton, using 500 gallons of acid and 78 barrels of water.

TIME	CP	TP	REMARKS
12:54 pm			Start acid
12:58 pm			500 gallons of acid in
1:07 pm			Acid on formation
1:09 pm	1000'		
1:11 pm	250'		
1:15 pm	250'		Finished flush

Swabbed through 5 1/2" casing 1 1/2 hours, 78 barrels of water used in treating; then swabbed 10 hours, 2 barrels of water and no oil per hour. Set Baker bridging plug at 3200' and 5 1/2" casing tested dry.

Perforated 5 1/2" casing from 3186' to 3191' with 30 holes and from 3194' to 3196' with 12 holes by Lane-wells, no shows. Treated through 5 1/2" casing with 500 gallons of Halliburton 15% acid as follows:

ACID TREATMENT NO. 6 - Between 3186'-91' and 3194'-96'

Treatment put in 2/7/56 by Halliburton, using 500 gallons of acid and 65 barrels of water.

TIME	CP	TP	REMARKS
2:23 pm			Start acid
2:26 pm			500 gallons of acid in
2:36 pm			Acid on formation
2:38 pm	750'		
2:40 pm	250'		Treatment completed

Swabbed through 5 1/2" casing 2 hours, 65 barrels of water used in treating; then swabbed 7 hours, 10 gallons of oil and 5 barrels of water per hour. On February 8, swabbed 5 hours, 10 gallons of oil and 5 barrels of water per hour. Plugged back from 3200' to 3193' with 58 gallons of Howell Cement. On February 11, swabbed and bailed the hole dry to top of Cement at 3193'. Bailed and tested 8 hours, 10 gallons of oil and 1 barrel of water per hour. Treated through 5 1/2" casing with 1500 gallons of Halliburton HV acid as follows:

ACID TREATMENT NO. 7 - Between 3186' and 3191'

Treatment put in 2/12/56 by Halliburton, using 1500 gallons of acid and 77 barrels of water.

TIME	CP	TP	REMARKS
1:59 pm			Start acid
2:07 pm			1500 gallons of acid in
2:14 pm			Acid on formation
2:16 pm	450'		
2:20 pm	400'		Finished flush

Swabbed through 5 1/2" casing 2 hours, 77 barrels of treating water; then swabbed 10 hours, 18 gallons of oil and 6 barrels of water per hour. Ran 2" tubing and rods and FOB 11 hours, 6 barrels of oil and 95 barrels of water.

Moved out cable tools and FOB 6 hours, 2 barrels of oil and 35 barrels of water, well quit pumping. Pulled and reran rods and FOB 20 hours, 12 barrels of oil and 80 barrels of water. On February 16, FOB 24 hours, 11 barrels of oil and 93 barrels of water. On February 17, FOB 24 hours, 10 barrels of oil and 109 barrels of water.

TOTAL DEPTH 3450' PB 3193'

15-163-01158-00-00

SKELLY OIL COMPANY

REPORT OF CHANGE IN WELL RECORD

Give complete description of all cleaning out, deepening, plugging back and fishing jobs, changes in casing, material lost in hole, etc., not recorded in original well record.

LEASE Frank Kostocil

WELL NO. 5 DISTRICT Western Kansas

SEC. 33 T. E6 R. 19

COUNTY Woods JOB NO. 2198

SURVEY _____ BLOCK _____

STATE Kansas

CLEANING OUT RECORD				PLUGGING BACK OR DEEPENING RECORD			
Date commenced.....	19.....	Date completed.....	19.....	Date commenced.....	November 6,	19	56
Cleaned out from.....	to.....	T. D.....		Plugged back or deepened from.....	3193	to	0' T. D. P & A
Prod. before.....	bbls. oil.....	bbls. water.....	cu. ft. gas.....	Prod. before.....	2 bbls. oil.....	36 bbls. water.....	cu. ft. gas.....
Prod. after.....	bbls. oil.....	bbls. water.....	cu. ft. gas.....	Prod. after.....	bbls. oil.....	bbls. water.....	cu. ft. gas.....
Kind of tools used:.....				Kind of tools used:.....	Pulling Unit		
Tools owned by:.....				Tools owned by:.....	Ace Pipe Pulling Co.		

SHOT RECORD

Date	Size shot	Shot between	Size of shell	Put in by (Co.)	Length anchor	Distance below casing	Damage to casing or casing shoulder

CHANGES IN CASING RECORD

SIZE	Wt.	Thds.	Where Set	PULLED OUT			LEFT IN			KIND	Cond'n	CEMENTING	
				Jts.	Feet	In.	Jts.	Feet	In.			Sacks Used	Method Employed
5-1/2"	151.82	344.6	23	1633	4	25	849	8	J55 R2	RS	8		

RECEIVED
STATE CORPORATION

PLUGGING
FILE SEC T R
BOOK PAGE LINE

Liner set at..... Length..... Perforated at.....
Packer set at..... Size and kind.....

11/12/56

[Signature]

Superintendent.

REMARKS (Give review of work accomplished and any other comment of interest)

On November 6, 1956, moved in and rigged up machine of Ace Pipe Pulling Company and plugged the well as follows:

Sand 3193' to 3170'

4 sacks of cement 3170' to 3138'

Shot off 5 1/2" casing at 3190' and pulled 83 joints (2633' 4") of 5 1/2" O.D., 15.3#, 28 tbd., J-55, I.S. casing (0 sand.)

Mud laden fluid 3138' to 600'

Crushed rock 600' to 590'

15 sacks of cement 590' to 552'

Shot off 4-5/8" casing at 498', 402', 310', and 255', casing would not pull.

Mud 552' to 48'

Crushed rock 48' to 38'

15 sacks of cement 38' to 6'

Surface soil 6' to 0'

Plugged and abandoned November 9, 1956.

RECORD OF FORMATIONS

FORMATION	TOP	BOTTOM	REMARKS
Indicate Casing Points, Describe Shows of Oil, Gas and Water, etc.			