

Give All Information Completely  
Make Required Affidavit  
Mail or Deliver Report to:  
Conservation Division  
State Corporation Commission  
800 Bitting Building  
Wichita, Kansas

OR  
FORMATION PLUGGING RECORD Strike out upper line when reporting plugging of formations.

Rooks County. Sec. 33 Twp. 8S Rge. (E) 19 (W)  
Location as "NE $\frac{1}{4}$ NW $\frac{1}{4}$ SW $\frac{1}{4}$ " or footage from lines. 330' FSL & 330' FEL SW/4  
Lease Owner Skelly Oil Company  
Lease Name Frank Rostocil Well No. 2  
Office Address Box 1650, Tulsa, Oklahoma  
Character of Well (completed as Oil, Gas or Dry Hole) Dry Hole  
Date well completed August 7, 1948  
Application for plugging filed August 9, 1948  
Application for plugging approved August 11, 1948  
Plugging commenced August 10, 1948  
Plugging completed August 10, 1948  
Reason for abandonment of well or producing formation Dry Hole

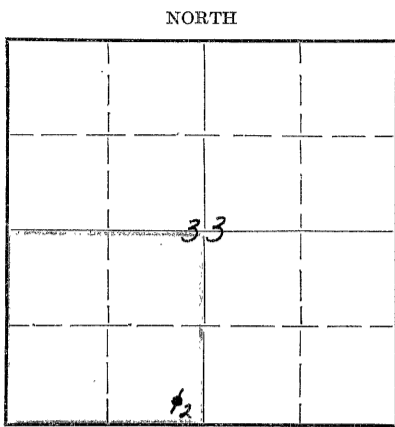

Locate well correctly on above Section Plat

If a producing well is abandoned, date of last production 19  
Was permission obtained from the Conservation Division or its agents before plugging was commenced? Yes (verbally)

Name of Conservation Agent who supervised plugging of this well M. A. Rives  
Producing formation Depth to top Bottom Total Depth of Well 3531' Feet  
Show depth and thickness of all water, oil and gas formations.

OIL, GAS OR WATER RECORDS

CASING RECORD

Formation	Content	From	To	OD Size	Put In	Pulled Out
Arbuckle Lime	Dry	3514'	3531'	8-5/8"	1445'6"	None

Describe in detail the manner in which the well was plugged, indicating where the mud fluid was placed and the method or methods used in introducing it into the hole. If cement or other plugs were used, state the character of same and depth placed, from feet to feet for each plug set.

25 sacks of cement 3531' to 3450'  
Mud laden fluid 3450' to 1440'  
25 sacks of cement 1440' to 1362'  
Mud laden fluid 1362' to 250'  
25 sacks of cement 250' to 172'  
Mud laden fluid 172' to 84'  
25 sacks of cement 84' to 6'  
Surface soil 6' to 0'

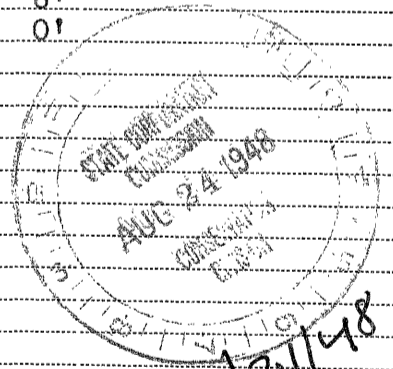

(If additional description is necessary, use BACK of this sheet)

Correspondence regarding this well should be addressed to Skelly Oil Company  
Address Box 391, Hutchinson, Kansas

STATE OF Kansas, COUNTY OF Reno, ss.  
H. E. Wansley (employee of owner)

being first duly sworn on oath, says: That I have knowledge of the facts, statements, and matters herein contained and the log of the above-described well as filed and that the same are true and correct. So help me God.

(Signature)

Box 391, Hutchinson, Kansas  
(Address)

SUBSCRIBED AND SWORN to before me this 23rd day of August, 1948

My commission expires April 7, 1951

Groshen L. Johnson  
Notary Public.

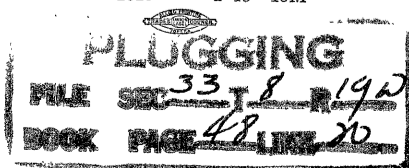

# SKELLY OIL COMPANY

## Well Record

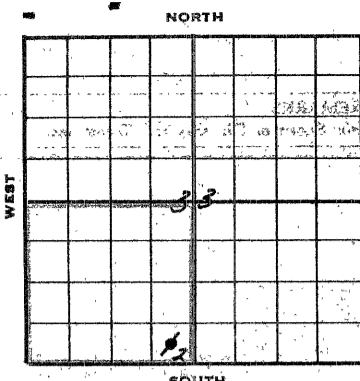

Lease Name and No. Frank Soutwell #33332 Well No. 2 Elev. 2014'  
 Lease Description SW/4 Sec. 33-33-19N, less 2 acres in SW/4 for cemetery; and NE/4 Sec. 4-33-19N, Hooks Co., Kans  
 Location made July 20, 1948 by P. J. Cannon  
330' feet from North line 330 feet from East line SW/4  
330' feet from South line 330 feet from West line of Sec. 33

Work com'd. 7/21 1948 Rig com'p'd. 7/23 1948 Drlg. com'd. 7/23 1948 Drlg. com'p'd. 8/7 1948  
 Rig Contractor Claude Northworth Drilling Co., Inc.  
 Drilling Contractor Claude Northworth Drilling Co., Inc., Tulsa, Oklahoma  
 Rotary Drilling from Top to 3331' Cable Tool Drilling from \_\_\_\_\_ to \_\_\_\_\_

Commenced Producing DRY HOLE 1948 { Initial Prod. before shot or acid \_\_\_\_\_  
 Initial Prod. after shot or acid \_\_\_\_\_  
 Dry Gas Well Press. \_\_\_\_\_ Volume \_\_\_\_\_  
 Casing Head Gas Pressure \_\_\_\_\_ Volume \_\_\_\_\_  
 Braden Head ( \_\_\_\_\_ Size \_\_\_\_\_ ) Gas Pressure \_\_\_\_\_ Volume \_\_\_\_\_  
 Braden Head ( \_\_\_\_\_ Size \_\_\_\_\_ ) Gas Pressure \_\_\_\_\_ Volume \_\_\_\_\_

PRODUCING FORMATION DRY HOLE (Name) Top \_\_\_\_\_ Bottom \_\_\_\_\_ TOTAL DEPTH 3331'

### CASING RECORD

Size	Wt.	Thds.	Where Set	PULLED OUT			LEFT IN			KIND	Cond'n	CEMENTING	
				Jts.	Feet	In.	Jts.	Feet	In.			Sacks Used	Method Employed
<u>4-3/8"</u>	<u>28 1/2</u>	<u>82</u>	<u>1440</u>				<u>46</u>	<u>1445</u>	<u>6</u>	<u>440 32 33</u>	<u>A</u>	<u>600</u>	<u>Halliburton</u>

Liner Set at \_\_\_\_\_ Length \_\_\_\_\_ Perforated at \_\_\_\_\_  
 Liner Set at \_\_\_\_\_ Length \_\_\_\_\_ Perforated at \_\_\_\_\_  
 Packer Set at \_\_\_\_\_ Size and Kind \_\_\_\_\_  
 Packer Set at \_\_\_\_\_ Size and Kind \_\_\_\_\_

### SHOT OR ACID TREATMENT RECORD

	FIRST	SECOND	THIRD	FOURTH
Date				
Acid Used				
Size Shot				
Shot Between	Ft. and Ft.	Ft. and Ft.	Ft. and Ft.	Ft. and Ft.
Size of Shell				
Put in by (Co.)				
Length anchor				
Distance below Cas'g				
Damage to Casing or Casing Shoulder				

### SIGNIFICANT GEOLOGICAL FORMATIONS

NAME	Top	Bottom	GAS		OIL		REMARKS
			From	To	From	To	
<u>Hessner Shale</u>	<u>3160'</u>						
<u>Lansing Lime</u>	<u>3209'</u>						
<u>Conglomerate</u>	<u>3437'</u>				<u>3457'</u>	<u>3461'</u>	<u>all. por. and oil stain</u>
<u>Arbuckle Lime</u>	<u>3514'</u>						

### CLEANING OUT RECORDS

	DATE COMMENCED	DATE COMPLETED	PROD. BEFORE	PROD. AFTER	REMARKS
1st					See Reverse for other d
2nd					" " " "
3rd					" " " "
4th					" " " "

### PLUGGING BACK AND DEEPENING RECORDS

	Date Commenced	Date Completed	No. Feet Plugged Back or Deepened	Prod. Before	Prod. After	REMARKS
1st						See Reverse for other d
2nd						" " " "
3rd						" " " "
4th						" " " "

(See Reverse for Record of Formation)

8/29/48

RECORD OF FORMATIONS

FORMATION	TOP	BOTTOM	REMARKS
Surface soil	0	40	
Sand and shells	40	165	
Sand	165	260	
Sand and shale	260	1145	
Sand	1145	1230	
Sand and red bed	1230	1430	
Hydrate	1430	1440	TOP HYDRATE 1430'
Hydrate	1440	1470	Net and cement 8-3/8" OD, 20' Cr. Std., 2-40, 2-2, 7 1/2" seamless steel casing at 1440' with 600 sacks of cement and 12 sacks of grout.
Sand and shells	1470	1555	
Sand	1555	1930	
Sand and shells	1930	2235	
Sand and shale	2235	2800	
Broken line	2800	2885	
Sand and shale	2885	3165	
Sand	3165	3457	TOP BROWN SHALE 3165'
Sand and brown dolomite	3457	3461	TOP BROWN SHALE 3457'
Weathered dolomite, sand, shale and chert concretion	3461	3514	Slight porosity and oil stain
Hard buff dense dolomite	3514	3531	San Halliburton Drill stem test with packer set at 3442', open 30 minutes, recovered 10' of mud.
TOTAL DEPTH		3531'	TOP UNCONFORMABLE LIMESTONE 3514'

Since no shows of oil or gas in commercial quantity was encountered in drilling to 3531', regular authority was granted on August 8, to plug and abandon the well.

On August 10, plugged the hole as follows:

- 25 sacks of cement and leaden fluid 3531' to 3450'
- 25 sacks of cement and leaden fluid 3450' to 1440'
- 25 sacks of cement and leaden fluid 1440' to 1362'
- 25 sacks of cement and leaden fluid 1362' to 230'
- 25 sacks of cement and leaden fluid 230' to 172'
- 25 sacks of cement and leaden fluid 172' to 84'
- 25 sacks of cement and leaden fluid 84' to 6'
- Surface soil 6' to 0'

Plugged and abandoned August 10, 1942.

**PLUGGING**  
 SEC 33 T 8 R 192  
 BOOK PAGE 48 LINE 20

8/10/42