

4

STATE CORPORATION COMMISSION OF KANSAS
OIL & GAS CONSERVATION DIVISION
WELL COMPLETION OR RECOMPLETION FORM
ACO-1 WELL HISTORY
DESCRIPTION OF WELL AND LEASE

Operator: License # 5135
Name John O. Farmer, Inc.
Address P.O. Box 352
City/State/Zip Russell, KS 67665

Purchaser

Operator Contact Person John O. Farmer
Phone (913) 483-3144

Contractor: License # 8241
Name Emphasis Oil Operations

Wellsite Geologist Sam Farmer
Phone (913) 483-3144

Designate Type of Completion
 New Well Re-Entry Workover
 Oil SWD Temp Abd
 Gas Inj Delayed Comp.
 Dry Other (Core, Water Supply etc.)

If OWO: old well info as follows:
Operator
Well Name
Comp. Date Old Total Depth

WELL HISTORY

Drilling Method:
 Mud Rotary Air Rotary Cable
02-08-88 02/15/88 02/15/88
Spud Date Date Reached TD Completion Date
3540'
Total Depth PBTD

Amount of Surface Pipe Set and Cemented at 218 feet
Multiple Stage Cementing Collar Used? Yes No
If yes, show depth set 1332 feet
If alternate 2 completion, cement circulated from 1332 feet depth to surface/450 SX cmt
Cement Company Name Allied Cement Company
Invoice # 1517
8-15-88

API NO. 15-163-22-980-00-00
County Rooks
SW SE NW Sec. 33 Twp. 8S Rge. 17 East
X West

2970 Ft North from Southeast Corner of Section
3630 Ft West from Southeast Corner of Section
(Note: Locate well in section plat below)

Lease Name Stamper "C" Well # 10

Field Name Dopita East

Producing Formation

Elevation: Ground 1983' KB 1988'

Section Plat

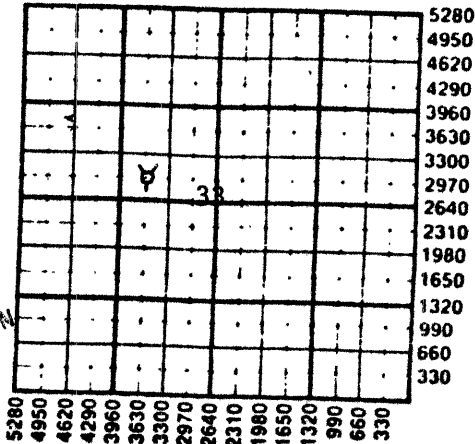

RECEIVED
STATE CORPORATION COMMISSION
AUG - 4 1988
8/4/88
CONSERVATION DIVISION
Wichita, Kansas

WATER SUPPLY INFORMATION

Disposition of Produced Water: Disposal
Docket # Repressuring

Questions on this portion of the ACO-1 call:
Water Resources Board (913) 296-3717
Source of Water:
Division of Water Resources Permit #

Groundwater Ft North from Southeast Corner (Well) Ft West from Southeast Corner of Sec Twp Rge East West

Surface Water 2970 Ft North from Southeast Corner (Stream, pond etc) 660 Ft West from Southeast Corner Sec 32 Twp 8 Rge 17 East X West

Other (explain) (purchased from city, R.W.D. #)

INSTRUCTIONS: This form shall be completed in triplicate and filed with the Kansas Corporation Commission, 200 Colorado Derby Building, Wichita, Kansas 67202, within 120 days of the spud date of any well. Rule 82-3-130, 82-3-107 and 82-3-106 apply. Information on side two of this form will be held confidential for a period of 12 months if requested in writing and submitted with the form. See rule 82-3-107 for confidentiality in excess of 12 months. One copy of all wireline logs and drillers time log shall be attached with this form. Submit CP-4 form with all plugged wells. Submit CP-111 form with all temporarily abandoned wells.

All requirements of the statutes, rules and regulations promulgated to regulate the oil and gas industry have been fully complied with and the statements herein are complete and correct to the best of my knowledge.

Signature John O. Farmer III
John O. Farmer III
Title Vice-president Date 2-19-88

Subscribed and sworn to before me this 19th day of February, 1988
Notary Public Margaret A. Schulte
Margaret A. Schulte

Date Commission Expires

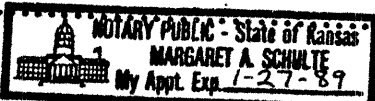

K.C.C. OFFICE USE ONLY
F Letter of Confidentiality Attached
C Wireline Log Received
C Drillers Time Log Received
Distribution
KCC SWD/Rep NGPA
KGS Plug Other
(Specify)
8-4-88
Form ACO-1 (5-86)

Sec 33 Twp 8 Rge 17E

Operator Name John O. Farmer, Inc. Lease Name Stamper 'C' Well # 10

Sec. 33 Twp. 8S Rge. 17 East West County Rooks

WELL LOG

INSTRUCTIONS: Show important tops and base of formations penetrated. Detail all cores. Report all drill stem tests giving interval tested, time tool open and closed, flowing and shut-in pressures, whether shut-in pressure reached static level, hydrostatic pressures, bottom hole temperature, fluid recovery, and flow rates if gas to surface during test. Attach extra sheet if more space is needed. Attach copy of log.

Drill Stem Tests Taken Yes No
 Samples Sent to Geological Survey Yes No
 Cores Taken Yes No

Formation Description
 Log Sample

(DRILLER'S LOG ATTACHED)

Name	Top	Bottom
Anhydrite	1306'	(+682)
Base/Anhy.	1338'	(+650)
Heebner	3102'	(-1114)
Toronto	3125'	(-1137)
Lansing	3144'	(-1156)
Arbuckle	3438'	(-1450)
R.T.D.	3540'	(-1552)

CASING RECORD <input checked="" type="checkbox"/> New <input type="checkbox"/> Used							
Report all strings set-conductor, surface, intermediate, production, etc.							
Purpose of String	Size Hole Drilled	Size Casing Set (in O.D.)	Weight Lbs/Ft.	Setting Depth	Type of Cement	#Sacks Used	Type and Percent Additives
Surface		8-5/8"		218'	60-40 Pod	140	3% C.C. 2% gel
Production		4-1/2"	10-1/2#	3496'	60-40 Pod	150	4% gel
D.V. Tool				1302'	50-50 Pod	425	6% gel
PERFORATION RECORD				Acid, Fracture, Shot, Cement Squeeze Record (Amount and Kind of Material Used)			
Shots Per Foot	Specify Footage of Each Interval Perforated					Depth	
NA	This will be an open hole completion from 3496-3540'			ROPE			
TUBING RECORD				Liner Run <input type="checkbox"/> Yes <input checked="" type="checkbox"/> No			
Date of First Production		Size 2-3/8" Set At		Packer at			
NA		3450'		3450'			
Producing Method		<input type="checkbox"/> Flowing <input type="checkbox"/> Pumping <input type="checkbox"/> Gas Lift <input checked="" type="checkbox"/> Other (explain).... SWD					
Estimated Production Per 24 Hours		Oil	Gas	Water	Gas-Oil Ratio	Gravity	
NA		Bbls	MCF	Bbls	CFPB		

METHOD OF COMPLETION

Disposition of gas: Vented Open Hole Perforation
 Sold Other (Specify)
 Used on Lease Dually Completed Commingled

~~XXXXXXXXXX~~ Interval SWD
 3496-3540'

EMPHASIS OIL OPERATIONS

P. O. Box 506

RUSSELL, KS 67665

DRILLERS LOG

OPERATOR: John O. Farmer, Inc.
P. O. Box 352
Russell, Ks 67665

CONTRACTOR: Emphasis Oil Operations
Box 506
Russell, KS. 67665

LEASE: Stamper 'C'

WELL #10

LOCATION: SW SE NW
Section 33-8S-17W
Rooks County, Kansas

ROTARY TOTAL DEPTH: 3540'

ELEVATION: 1988' KB

COMMENCED: 02/08/88

COMPLETED: 02/15/88

CASING: 8-5/8" @ 218' w/140 sks cement
4-1/2" @ 3496' w/150 sks cement
DV Tool @ 1302' to surface w/425 sks cement

STATUS: Salt Water Disposal

DEPTHS & FORMATIONS

(All Measurements from K.B.)

Top Soil, and Post Rock	0.40	Red Bed	1895
Shale	587	Shale	3101
Dakota Sand	646	Topeka	3102
Red Bed	850	Heebner	3125
Cedar Hills Sand	1017	Toronto	3144
Red Bed	1305	B.L.C.	3430
Anhydrite	1338	Arbuckle (R.T.D.)	3540

RECEIVED
STATE CORPORATION COMMISSION
AUG - 4 1988 8/4/88

STATE OF KANSAS)
) ss -
COUNTY OF RUSSELL)

CONSERVATION DIVISION
Wichita, Kansas

Kyle B. Branum, of Emphasis Oil Operations, states that the above and foregoing is a true and correct log of the above captioned well, to the best of his knowledge.

Kyle B. Branum

Kyle B. Branum

Subscribed and sworn to before me on February 17, 1988.

My Commission expires: 8-15-89

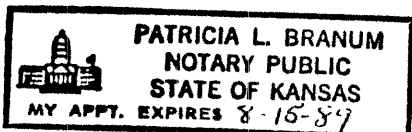

Patricia L. Branum

Patricia L. Branum, Notary Public

Phone 913-483-2627, Russell, Kansas
 Phone 316-793-5861, Great Bend, Kansas

Phone Plainville 913-434-2812
 Phone Ness City 913-798-3842

ALLIED CEMENTING CO., INC.

N^o 1517

Home Office P. O. Box 31

Russell, Kansas 67865

2-15-88

Date	Sec.	Twp.	Range	Called Out	On Location	Job Start	Finish
2-14-88	33	8 ^s	17 ^w	6:30 P.M.	9:00 P.M.	4:45 AM	5:30 AM
Lease <i>Stamper "C"</i>	Well No. <i>10</i>	Location <i>Plainville 6N3 1/2 E 1/2 S 1/4 E</i>		County <i>Rooks</i>	State <i>Ks.</i>		

Contractor <i>Emphasis Oil Operations Rig # 4</i>	Owner <i>Same</i>
Type Job <i>Two-stage Production String</i>	To Allied Cementing Co., Inc. You are hereby requested to rent cementing equipment and furnish cementer and helper to assist owner or contractor to do work as listed.
Hole Size <i>7 7/8"</i>	T.D. <i>3540'</i>
Csg. <i>4 1/2"</i>	Depth <i>3523'</i>
Csg. Size <i>8 7/8"</i>	Depth <i>218'</i>
Drill Pipe	Depth
Tool <i>D.V.</i>	Depth <i>1332'</i>
Cement Left in Csg. <i>21'</i>	Shoe Joint <i>21.19'</i>
Press Max. <i>1500 #</i>	Minimum
Meas Line <i>X</i>	Displace
Perf.	

Charge To <i>John O. Farman, Inc.</i>	
Street <i>P.O. Box 352</i>	
City <i>Russell</i> State <i>Ks. 67865</i>	
The above was done to satisfaction and supervision of owner agent or contractor	
Purchase Order No.	
<i>X</i> <i>John O. Farman</i>	
CEMENT	
Amount Ordered <i>425 sks 50/50 poz 6% gel.</i>	
Consisting of	
Common <i>208 sks @ 5.00/sk.</i>	<i>1040.00</i>
Poz. Mix <i>207 sks @ 2.10/sk.</i>	<i>434.70</i>
Gel. <i>25 sks @ 6.75/sk.</i>	<i>168.75</i>
Chloride	
Quickset	

EQUIPMENT

No.	Cementer	
Pumptrk <i>191</i>	Helper	<i>Gary H. Jim S.</i>
No.	Cementer	
Pumptrk	Helper	
	Driver	<i>Scott R.</i>
Bulktrk <i>#150</i>	Driver	

Handling @ <i>75 1/4/sk. (415 sks)</i>	<i>311.25</i>
Mileage @ <i>0.34/sk./mi. (10 mi.)</i>	<i>124.50</i>
Sub Total	<i>2079.20</i>
Total	

DEPTH of Job

Reference	Description	Amount
<i>#3</i>	<i>Pumptruck-top stage</i>	<i>450.00</i>
<i>#14</i>	<i>mileage</i>	<i>N/C.</i>
	Sub Total	<i>450.00</i>
	Tax	
	Total	

Remarks:

*Cement Circulated.
 Plugged rat hole w/15 sks
 D.V. Tool Closed & H.U.*

RECEIVED
 STATE CORPORATION COMMISSION

AUG - 4 1988

CONSERVATION DIVISION
 Wichita, Kansas

Thanks

8/4/88

Phone 913-483-2627, Russell, Kansas
 Phone 316-793-5861, Great Bend, Kansas

New

Phone Plainville 913-434-2812
 Phone Ness City 913-798-3843

ALLIED CEMENTING CO., INC.

N^o 1516

Home Office P. O. Box 31

Russell, Kansas 67665

Date <u>2-14-88</u>	Sec. <u>33</u>	Twp. <u>8^E</u>	Range <u>17^W</u>	Called Out <u>6:30 P.M.</u>	On Location <u>9:00 P.M.</u>	Job Start <u>3:30 AM</u>	Finish <u>4:15 AM</u>
Lease <u>Stampen "L"</u>	Well No. <u>10</u>	Location <u>Plainville 6N 3 1/2 E 1/2 S 1/4 E</u>		County <u>Rooks</u>	State <u>Ks.</u>		

2-15-88

Contractor <u>Emphasis Oil Operations Rig #6</u>	Owner <u>Same</u>
Type Job <u>Two-stage Production String</u>	To Allied Cementing Co., Inc. You are hereby requested to rent cementing equipment and furnish cementer and helper to assist owner or contractor to do work as listed.
Hole Size <u>7 7/8"</u>	T.D. <u>3540'</u>
Csg. <u>4 1/2"</u>	Depth <u>3523'</u>
Csg. Size <u>8 5/8"</u>	Depth <u>218'</u>
Drill Pipe	Depth
Tool	Depth
Cement Left in Csg. <u>21'</u>	Shoe Joint <u>21.19'</u>
Press Max. <u>1000#</u>	Minimum
Meas Line <u>X</u>	Displace
Perf.	

Charge To <u>John D. Farmer, Inc.</u>	
Street <u>P.O. Box 352</u>	
City <u>Russell</u> State <u>Ks. 67665</u>	
The above was done to satisfaction and supervision of owner agent or contractor	
Purchase Order No.	
X <u>[Signature]</u>	
CEMENT	
Amount Ordered <u>150 sks 6 3/4 40 poz 4 bag.</u>	
Consisting of	
Common <u>90 sks @ \$5.00/sk.</u>	<u>450.00</u>
Poz. Mix <u>60 sks @ 2.00/sk.</u>	<u>120.00</u>
Gel. <u>6 sks @ 6.75/sk.</u>	<u>40.50</u>
Chloride	
Quickset	

EQUIPMENT

No.	Cementor	<u>Gary H.</u>
Pumptrk <u>191</u>	Helper	
No.	Cementor	<u>Jim S.</u>
Pumptrk	Helper	
	Driver	<u>Randy P.</u>
Bulktrk <u>#60</u>	Driver	

Handling <u>\$75.4/sk. (150 sks)</u>	<u>112.50</u>
Mileage <u>\$0.34/sk./mi. (10 mi.)</u>	<u>45.00</u>
Sub Total	<u>774.00</u>
Total	

DEPTH of Job

Reference: <u>#3 Pumptruck-bottom stage</u>	<u>\$838.00</u>
<u>#14 mileage @ 1.00/mi.</u>	<u>10.00</u>
Sub Total	<u>\$848.00</u>

Sales Tax	
Floating Equipment <u>4 1/2"</u>	

Remarks: FLOAT Held

AUG - 4 1988

CONSERVATION DIVISION
Wichita, Kansas

Thanks

1-packer shoe	<u>1,124.00</u>
1-AFU insert (model "C")	<u>161.00</u>
1-stage collar	<u>2,267.00</u>
1-cementing basket	<u>108.00</u>
3-centralizers @ \$41.00 ea.	<u>123.00</u>
Total	<u>\$3783.00</u>

RECEIVED
STATE CORPORATION COMMISSION