

SIDE ONE

STATE CORPORATION COMMISSION OF KANSAS
OIL & GAS CONSERVATION DIVISION
WELL COMPLETION OR RECOMPLETION FORM
ACO-1 WELL HISTORY
DESCRIPTION OF WELL AND LEASE

5

API NO. 15-163-22,992 - 00 - 00
County Rooks
SW NW NE Sec. 34 Twp 8S Rge. 19 East
X West

Operator: License # 3701
Name Balcron Oil Company
Address P.O. Box 21017
City/State/Zip Billings, Montana 59104

4290 Ft North from Southeast Corner of Section
2310 Ft West from Southeast Corner of Section
(Note: Locate well in section plat below)

Purchaser

Lease Name McCauley Well # 1-34

Operator Contact Person Allen Townsend
Phone (406) 259-7860

Field Name

Producing Formation

Contractor: License # 5422
Name Abercrombie Drilling, Inc.

Elevation: Ground 1975 KB 1980

Wellsite Geologist
Phone

Designate Type of Completion
X New Well Re-Entry Workover
Oil SWD Temp Abd
Gas Inj Delayed Comp.
X Dry Other (Core, Water Supply etc.)

If OWWP: old well info as follows:
Operator
Well Name
Comp. Date Old Total Depth

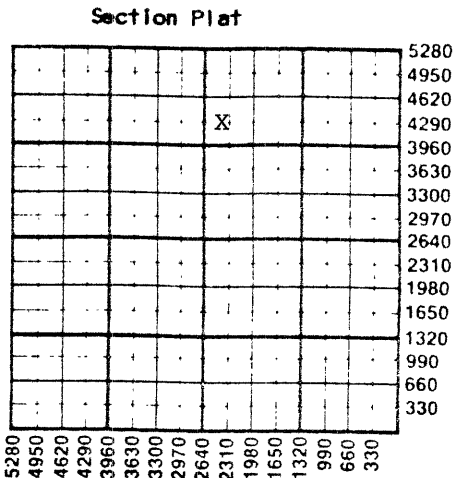

WATER SUPPLY INFORMATION
Disposition of Produced Water: Disposal
Docket # Repressuring

WELL HISTORY

Questions on this portion of the ACO-1 call:
Water Resources Board (913) 296-3717

Source of Water: T88-156
Division of Water Resources Permit #

Groundwater Ft North from Southeast Corner (Well) Ft West from Southeast Corner of Sec Twp Rge East West

X Surface Water 3300 Ft North from Southeast Corner (Stream, pond etc.) 4620 Ft West from Southeast Corner Sec 26 Twp 8S Rge 19 East X West

Other (explain) (purchased from city, R.W.D. #)

Drilling Method: X Mud Rotary Air Rotary Cable
3-19-88 3-25-88 3-26-88
Spud Date Date Reached TD Completion Date
3456
Total Depth PBD

Amount of Surface Pipe Set and Cemented at 218 feet
Multiple Stage Cementing Collar Used? Yes No
If yes, show depth set feet
If alternate 2 completion, cement circulated from feet depth to w/ SX cmt
Cement Company Name
Invoice #

INSTRUCTIONS: This form shall be completed in triplicate and filed with the Kansas Corporation Commission, 200 Colorado Derby Building, Wichita, Kansas 67202, within 120 days of the spud date of any well. Rule 82-3-130, 82-3-107 and 82-3-106 apply. Information on side two of this form will be held confidential for a period of 12 months if requested in writing and submitted with the form. See rule 82-3-107 for confidentiality in excess of 12 months. One copy of all wireline logs and drillers time log shall be attached with this form. Submit CP-4 form with all plugged wells. Submit CP-111 form with all temporarily abandoned wells.

All requirements of the statutes, rules and regulations promulgated to regulate the oil and gas industry have been fully complied with and the statements herein are complete and correct to the best of my knowledge.

Signature James Alan Townsend
Title Operations Superintendent Date April 15, 1988

Subscribed and sworn to before me this 15th day of April 1988
Notary Public Roberta L. Schuman
Date Commission Expires January 25, 1991

K.C.C. OFFICE USE ONLY
F Letter of Confidentiality Attached
C Wireline Log Received
C Drillers Timelog Received
Distribution
KCC SWD/Rep NGPA
KGS Plug Other (Specify)

RECEIVED
STATE CORPORATION COMMISSION
Wichita, Kansas

Form ACO-1 (5-86)

Sec 34 Twp 8S Rge 19

SIDE TWO

Operator Name Balcron Oil Company Lease Name McCauley Well # 1-34

Sec. 34 Twp. 8S Rge. 19 East West County Rooks

WELL LOG

INSTRUCTIONS: Show important tops and base of formations penetrated. Detail all cores. Report all drill stem tests giving interval tested, time tool open and closed, flowing and shut-in pressures, whether shut-in pressure reached static level, hydrostatic pressures, bottom hole temperature, fluid recovery, and flow rates if gas to surface during test. Attach extra sheet if more space is needed. Attach copy of log.

Drill Stem Tests Taken Yes No
 Samples Sent to Geological Survey Yes No
 Cores Taken Yes No

Formation Description
 Log Sample

DST #1 3,316'-3,376' (Lansing)

Times: 30/60/15/30
 IHP 1690 FFP 87-87
 IFP 76-76 FSIP 131
 ISIP 918 FHP 1657

Recovery: 30' mud with spots of oil
 Temperature: 103°

DST #2 3,376'-3,431' (Arbuckle)

Times: 30/60/15/30
 IHP 1701 FFP 87-87
 IFP 76-76 FSIP 76
 ISIP 120 FHP 1690

Recovery: 20' mud, no show
 Temperature: 104°

Name	Top	Bottom
Anhydrite	1390 (590)	
Topeka	2931 (- 951)	
Heebner	3141 (-1,161)	
Lansing-K.C.	3182 (-1,202)	
Base K.C.	3382 (-1,402)	
Arbuckle	3421 (-1,441)	
R T D	3456 (-1,476)	

See attached geologist's log.

CASING RECORD <input type="checkbox"/> New <input checked="" type="checkbox"/> Used							
Report all strings set-conductor, surface, intermediate, production, etc.							
Purpose of String	Size Hole Drilled	Size Casing Set (in O.D.)	Weight Lbs/Ft.	Setting Depth	Type of Cement	#Sacks Used	Type and Percent Additives
Surface	12 1/4"	8 5/8	20#	218'	Posmix	140	2% gel, 3% ec
PERFORATION RECORD				Acid, Fracture, Shot, Cement Squeeze Record			
Shots Per Foot	Specify Footage of Each Interval Perforated			(Amount and Kind of Material Used)		Depth	
TUBING RECORD				Liner Run <input type="checkbox"/> Yes <input type="checkbox"/> No			
Date of First Production		Producing Method <input type="checkbox"/> Flowing <input type="checkbox"/> Pumping <input type="checkbox"/> Gas Lift <input type="checkbox"/> Other (explain).....					
Estimated Production Per 24 Hours		Oil Bbls	Gas MCF	Water Bbls	Gas-Oil Ratio	Gravity	

METHOD OF COMPLETION

Production Interval

Disposition of gas: Vented Open Hole Perforation
 Sold Other (Specify)
 Used on Lease Dually Completed
 Conmngled