

SIDE ONE

STATE CORPORATION COMMISSION OF KANSAS  
OIL & GAS CONSERVATION DIVISION

WELL COMPLETION OR RECOMPLETION FORM  
ACO-1 WELL HISTORY

DESCRIPTION OF WELL AND LEASE

Operator: License # 5252  
Name R P NIXON OPERATIONS  
Address 207 W 12TH  
City/State/Zip HAYS, KS 67601

Operator Contact Person DAN NIXON  
Phone (913) 628-3834

Contractor: License # 7733  
Name SUPERIOR WELL SERVICE

Wellsite Geologist  
Phone

PURCHASER NCRA  
P O BOX 1167 McPHERSON KS

Designate Type of Completion  
 New Well  Re-Entry  Workover  
 Oil  SWD  Temp Abd  
 Gas  Inj  Delayed Comp.  
 Dry  Other (Core, Water Supply etc.)

If OWWO: old well info as follows:  
Operator BIRD & BORING  
Well Name #1 VEVERKA  
Comp. Date FEB. 1946 Old Total Depth 3423'

WELL HISTORY

Drilling Method:  
 Mud Rotary  Air Rotary  Cable  
3-23-84 3-30-84 3-30-84  
Spud Date Date Reached TD Completion Date  
3423' PBTD  
Total Depth

Amount of Surface Pipe Set and Cemented at 256 feet

Multiple Stage Cementing Collar Used?  Yes  No  
If yes, show depth set.....feet

If alternate 2 completion, cement circulated from.....feet depth to.....w/.....SX cmt

API No. 15-163-01,000 ~~19113 00 01~~ 15-163-01,000-00-01  
County ROOKS  
C-S/2 SW SW Sec. 27 Twp. 8 Rge. 19  East  West

330'  
4620' Ft North from Southeast Corner of Section  
Ft West from Southeast Corner of Section  
(Note: Locate well in section plat below)

Lease Name VEVERKA Well # 4

Field Name WEBSTER

Producing Formation LANSING & ARBUCKLE

Elevation: Ground 1981 1988 KB

Section Plat

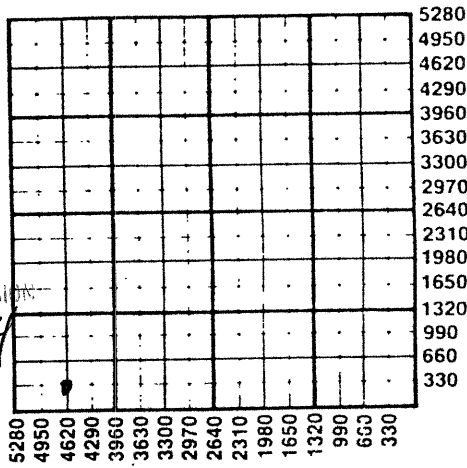

RECEIVED  
STATE CORPORATION COMMISSION  
NOV 13 1984  
CONSERVATION DIVISION  
Wichita, Kansas

WATER SUPPLY INFORMATION

Source of Water:  
Division of Water Resources Permit #

Groundwater.....Ft North from Southeast Corner (Well) .....Ft West from Southeast Corner of Sec Twp Rge  East  West

Surface Water.....Ft North from Southeast Corner (Stream, pond etc).....Ft West from Southeast Corner Sec Twp Rge  East  West

Other (explain) ..... (purchased from city, R.W.D.#)

Disposition of Produced Water:  Disposal  Repressuring

Docket # CD-580S

INSTRUCTIONS: This form shall be completed in duplicate and filed with the Kansas Corporation Commission, 200 Colorado Derby Building, Wichita, Kansas 67202, within 90 days after completion or recompletion of any well. Rule 82-3-130 and 82-3-107 apply. Information on side two of this form will be held confidential for a period of 12 months if requested in writing and submitted with the form. See rule 82-3-107 for confidentiality in excess of 12 months. One copy of all wireline logs and drillers time log shall be attached with this form. Submit CP-4 form with all plugged wells. Submit CP-111 form with all temporarily abandoned wells.

All requirements of the statutes, rules and regulations promulgated to regulate the oil and gas industry have been fully complied with and the statements herein are complete and correct to the best of my knowledge.

Signature *[Signature]*

Title GEOLOGIST Date 11-7-84

Subscribed and sworn to before me this 8th day of November 1984

Notary Public *[Signature]*  
Date Commission Expires 6-19-88

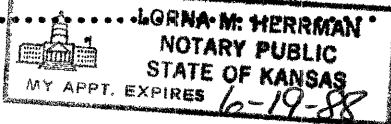

K.C.C. OFFICE USE ONLY  
 Letter of Confidentiality Attached  
 Wireline Log Received  
 Drillers Timelog Received  
Distribution  
 KCC  SWD/Rep  NGPA  
 KGS  Plug  Other (Specify)

Operator Name **R. P. NIXON OPER** Lease Name **VEVERKA** Well # **4** SEC. **27** TWP. **8** RGE. **19**  East  West

WELL LOG

INSTRUCTIONS: Show important tops and base of formations penetrated. Detail all cores. Report all drill stem tests giving interval tested, time tool open and closed, flowing and shut-in pressures, whether shut-in pressure reached static level, hydrostatic pressures, bottom hole temperature, fluid recovery, and flow rates if gas to surface during test. Attach extra sheet if more space is needed. Attach copy of log.

Drill Stem Tests Taken  Yes  No  
 Samples Sent to Geological Survey  Yes  No  
 Cores Taken  Yes  No

Formation Description  
 Log  Sample

Name	Top	Bottom
HEEBNER	3132'	
TORONTO	3160'	
LANSING-KC	3173'	
BASE OF KC	3389'	
ARBUCKLE	3412'	
LTD	3423'	

NEW INFORMATION:

Re-entered 3-20-84. Wash down to appr. 1600', left hole, drilled new hole to 3424 TD, logged, set 5 1/2" casing at 3418'. Moved in completion tools, swab down and received 3 BOPH natural. Set cast iron bridge plug at 3400'. Perforated 1/3365, 1/3342, 1/3241. Acidized 3000 gallons 28%. Swab all zones together received 2.5 BFPH, 17% oil. Drilled plug to bottom, set cast iron bridge plug at 3241, perforated 3093-95 acidized 500 gallons 15%, swab down and received 10 BFPH (1% oil). Squeezed perfs with cement, drilled plug to bottom. Put on pump, produced 20 bbls oil and 70 bbls water per day.

CASING RECORD <input checked="" type="checkbox"/> New <input type="checkbox"/> Used							
Report all strings set-conductor, surface, intermediate, production, etc.							
Purpose of String	Size Hole Drilled	Size Casing Set (in O.D.)	Weight Lbs/Ft.	Setting Depth	Type of Cement	#Sacks Used	Type and Percent Additives
SURFACE		8 5/8"		256'			
PRODUCTION	7 7/8"	5 1/2"		3416'	COMMON	100	10% salt
PERFORATION RECORD				Acid, Fracture, Shot, Cement Squeeze Record			
Shots Per Foot	Specify Footage of Each Interval Perforated			(Amount and Kind of Material Used)		Depth	
1 @	3365, 3342, 3241			2000 gal 28% Non-E		perfs	
	3093-3095			500 gal 15% Non-E acid		perfs	
TUBING RECORD		Size	Set At	Packer at	Liner Run	<input type="checkbox"/> Yes <input type="checkbox"/> No	
		2 3/8"					
Date of First Production		Producing Method					
5-21-84		<input type="checkbox"/> Flowing <input checked="" type="checkbox"/> Pumping <input type="checkbox"/> Gas Lift <input type="checkbox"/> Other (explain).....					
Estimated Production Per 24 Hours		Oil	Gas	Water	Gas-Oil Ratio	Gravity	
		20 Bbls	MCF	70 Bbls		CFPB	

METHOD OF COMPLETION Production Interval

Disposition of gas:  Vented  Open Hole  Perforation  
 Sold  Other (Specify) .....  
 Used on Lease  Dually Completed .....  
 Commingled