

STATE CORPORATION COMMISSION OF KANSAS  
OIL & GAS CONSERVATION DIVISION  
WELL COMPLETION OR RECOMPLETION FORM  
ACO-1 WELL HISTORY  
DESCRIPTION OF WELL AND LEASE

Operator: License # 5131  
Name Thunderbird Drilling, Inc.  
Address P. O. Box 780407  
City/State/Zip Wichita, KS 67278

Purchaser

Operator Contact Person Burke Krueger  
Phone (316) 685-1441

Contractor: License # 5422  
Name Abercrombie Drilling, Inc.

Wellsite Geologist Craig Caulk  
Phone 264-4396

Designate Type of Completion

New Well  Re-Entry  Workover  
 Oil  SWD  Temp Abd  
 Gas  Inj  Delayed Comp.  
 Dry  Other (Core, Water Supply etc.)

If ONWD: old well info as follows:

Operator  
Well Name  
Comp. Date Old Total Depth

WELL HISTORY

Drilling Method:

Mud Rotary  Air Rotary  Cable

4-08-89 4-11-89 4-12-89  
Spud Date Date Reached TD Completion Date  
3270'  
Total Depth PBTD

Amount of Surface Pipe Set and Cemented at 249 feet  
Multiple Stage Cementing Collar Used? Yes No  
If yes, show depth set feet  
If alternate 2 completion, cement circulated  
from feet depth to w/SX cmt  
Cement Company Name  
Invoice #

INSTRUCTIONS: This form shall be completed in triplicate and filed with the Kansas Corporation Commission, 200 Colorado Derby Building, Wichita, Kansas 67202, within 120 days of the spud date of any well. Rule 82-3-130, 82-3-107 and 82-3-106 apply.

Information on side two of this form will be held confidential for a period of 12 months if requested in writing and submitted with the form. See rule 82-3-107 for confidentiality in excess of 12 months. One copy of all wireline logs and drillers time log shall be attached with this form. Submit CP-4 form with all plugged wells. Submit CP-111 form with all temporarily abandoned wells.

All requirements of the statutes, rules and regulations promulgated to regulate the oil and gas industry have been fully complied with and the statements herein are complete and correct to the best of my knowledge.

Signature Burke B. Krueger  
Title Vice-President Date 4/20/89

Subscribed and sworn to before me this 20th day of April 1989  
Notary Public Gloria DeJesus  
Date Commission Expires 3-25-92

GLORIA DE JESUS  
NOTARY PUBLIC  
STATE OF KANSAS  
MY APPT. EXP.

API NO. 15-163-23,040-0000

County Rooks

SE SE NE Sec 23 Twp 8S Rge 20 East X West

2970 Ft North from Southeast Corner of Section  
330 Ft West from Southeast Corner of Section  
(Note: Locate well in section plat below)

Lease Name Baldwin Well # 1

Field Name WC

Producing Formation Arbuckle

Elevation: Ground 2024' KB 2029' KB

Section Plat

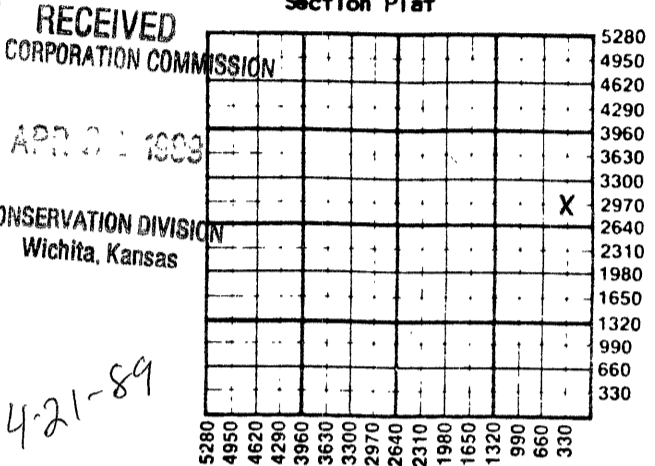

WATER SUPPLY INFORMATION

Disposition of Produced Water: Disposal  
Docket # Repressuring

Questions on this portion of the ACO-1 call:

Water Resources Board (913) 296-3717

Source of Water:  
Division of Water Resources Permit # T 89-178

Groundwater Ft North from Southeast Corner  
(Well) Ft West from Southeast Corner of  
Sec Twp Rge East West

X Surface Water 200 Ft North from Southeast Corner  
(Stream, pond etc) 5080 Ft West from Southeast Corner  
Rooks Sec 26 Twp 8S Rge 19 East X West

Other (explain)

(purchased from city, R.W.D. #)  
Russell Bouchey, Box 203, Stockton, KS 67669

K.C.C. OFFICE USE ONLY  
F Letter of Confidentiality Attached  
C Wireline Log Received  
C Drillers Timelog Received  
Distribution  
KCC SWD/Rep NGPA  
KGS Plug Other (Specify)  
4-21-89 X(4)

SIDE TWO

Operator Name Thunderbird Drilling, Inc. Lease Name Baldwin Well # 1

Sec. 23 Twp. 8S Rge. 20  East  West County Rooks

WELL LOG

INSTRUCTIONS: Show important tops and base of formations penetrated. Detail all cores. Report all drill stem tests giving interval tested, time tool open and closed, flowing and shut-in pressures, whether shut-in pressure reached static level, hydrostatic pressures, bottom hole temperature, fluid recovery, and flow rates if gas to surface during test. Attach extra sheet if more space is needed. Attach copy of log.

Drill Stem Tests Taken  Yes  No  
 Samples Sent to Geological Survey  Yes  No  
 Cores Taken  Yes  No

Formation Description  
 Log  Sample

Name	Top	Bottom
Anhydrite	1544+	485
Topeka	3027-	998
Heebner	3233-	1204
RTD	3270-	1241
LTD	3270-	1241

CASING RECORD  New  Used  
 Report all strings set-conductor, surface, intermediate, production, etc.

Purpose of String	Size Hole Drilled	Size Casing Set (in O.D.)	Weight Lbs/Ft.	Setting Depth	Type of Cement	#Sacks Used	Type and Percent Additives
Surface	12 1/2"	8 5/8"	28#	249'	60/40poz	165	3% cc, 2% ge

Shots Per Foot	Specify Footage of Each Interval Perforated	Acid, Fracture, Shot, Cement Squeeze Record (Amount and Kind of Material Used)	Depth
.....	.....	.....	.....
.....	.....	.....	.....
.....	.....	.....	.....
.....	.....	.....	.....

TUBING RECORD	Size	Set At	Packer at	Liner Run	<input type="checkbox"/> Yes <input type="checkbox"/> No
.....	.....	.....	.....	.....	.....

Date of First Production \_\_\_\_\_ Producing Method  Flowing  Pumping  Gas Lift  Other (explain).....

Estimated Production Per 24 Hours	Oil Bbls	Gas MCF	Water Bbls	Gas-Oil Ratio	Gravity
.....	.....	.....	.....	.....	.....

METHOD OF COMPLETION

Production Interval

Disposition of gas:  Vented  Open Hole  Perforation  
 Sold  Other (Specify) .....  
 Used on Lease  Dually Completed .....  
 Commingled .....