



For KCC Use:
 Effective Date: 11/10/2007
 District # 1
 SGA? Yes No

KANSAS CORPORATION COMMISSION 1013925
 OIL & GAS CONSERVATION DIVISION

Form C-1
 October 2007

Form must be Typed
 Form must be Signed
 All blanks must be Filled

NOTICE OF INTENT TO DRILL

Must be approved by KCC five (5) days prior to commencing well

Expected Spud Date: 11/20/2007
 month day year

OPERATOR: License# 33168
 Name: Woolsey Operating Company, LLC
 Address 1: 125 N MARKET STE 1000
 Address 2:
 City: WICHITA State: KS Zip: 67202 + 1729
 Contact Person: DEAN PATTISSON
 Phone: 316-267-4379

CONTRACTOR: License#
 Name: Advise on ACO-1 -- Must be licensed by KCC

Well Drilled For:	Well Class:	Type Equipment:
<input type="checkbox"/> Oil	<input type="checkbox"/> Enh Rec	<input checked="" type="checkbox"/> Infield
<input type="checkbox"/> Gas	<input type="checkbox"/> Storage	<input type="checkbox"/> Mud Rotary
<input type="checkbox"/> Seismic : # of Holes	<input checked="" type="checkbox"/> Disposal	<input type="checkbox"/> Air Rotary
<input type="checkbox"/> Other:	<input type="checkbox"/> Pool Ext.	<input type="checkbox"/> Cable
	<input type="checkbox"/> Wildcat	
	<input type="checkbox"/> Other	

If OWWO: old well information as follows:
 Operator: LEE BANKS
 Well Name: McMORAN 1
 Original Completion Date: 01/31/1981 Original Total Depth: 5300

Directional, Deviated or Horizontal wellbore? Yes No
 If Yes, true vertical depth:
 Bottom Hole Location:
 KCC DKT #:

Spot Description: 200' S & 60' W of
 NE SW SW Sec. 4 Twp. 35 S. R. 16 E W
 (a-a-a) 790 feet from N / S Line of Section
 930 feet from E / W Line of Section

Is SECTION: Regular Irregular?

(Note: Locate well on the Section Plat on reverse side)
 County: Comanche
 Lease Name: McMORAN Well #: SWD
 Field Name: YELLOWSTONE

Is this a Prorated / Spaced Field? Yes No
 Target Formation(s): ARBUCKLE

Nearest Lease or unit boundary line (in footage): 790
 Ground Surface Elevation: 1815 feet MSL
 Water well within one-quarter mile: Yes No
 Public water supply well within one mile: Yes No

Depth to bottom of fresh water: 180
 Depth to bottom of usable water: 180
 Surface Pipe by Alternate: I II
 Length of Surface Pipe Planned to be set: 407
 Length of Conductor Pipe (if any): 0

Projected Total Depth: 6550
 Formation at Total Depth: ARBUCKLE

Water Source for Drilling Operations:
 Well Farm Pond Other: TO BE HAULED
 DWR Permit #:

(Note: Apply for Permit with DWR)

Will Cores be taken? Yes No
 If Yes, proposed zone:

AFFIDAVIT

The undersigned hereby affirms that the drilling, completion and eventual plugging of this well will comply with K.S.A. 55 et. seq.
 It is agreed that the following minimum requirements will be met:

1. Notify the appropriate district office **prior** to spudding of well;
2. A copy of the approved notice of intent to drill **shall be** posted on each drilling rig;
3. The minimum amount of surface pipe as specified below **shall be set** by circulating cement to the top; in all cases surface pipe **shall be set** through all unconsolidated materials plus a minimum of 20 feet into the underlying formation.
4. If the well is dry hole, an agreement between the operator and the district office on plug length and placement is necessary **prior to plugging**;
5. The appropriate district office will be notified before well is either plugged or production casing is cemented in;
6. If an ALTERNATE II COMPLETION, production pipe shall be cemented from below any usable water to surface within **120 DAYS** of spud date.
 Or pursuant to Appendix "B" - Eastern Kansas surface casing order #133,891-C, which applies to the KCC District 3 area, alternate II cementing must be completed within 30 days of the spud date or the well shall be plugged. **In all cases, NOTIFY district office** prior to any cementing.

Submitted Electronically

For KCC Use ONLY
 API # 15-033-20408-00-01
 Conductor pipe required 0 feet
 Minimum surface pipe required 407 feet per ALT I II
 Approved by: Rick Hestermann 11/05/2007
 This authorization expires: 11/05/2008
 (This authorization void if drilling not started within 12 months of approval date.)
 Spud date: Agent:

Remember to:

- File Drill Pit Application (form CDP-1) with Intent to Drill;
- File Completion Form ACO-1 within 120 days of spud date;
- File acreage attribution plat according to field proration orders;
- Notify appropriate district office 48 hours prior to workover or re-entry;
- Submit plugging report (CP-4) after plugging is completed (within 60 days);
- Obtain written approval before disposing or injecting salt water.
- if this permit has expired (See: authorized expiration date) please check the box below and return to the address below.

Well Not Drilled - Permit Expired Date:
 Signature of Operator or Agent:

Mail to: KCC - Conservation Division, 130 S. Market - Room 2078, Wichita, Kansas 67202

4
 35
 16
 E
 W



1013925

IN ALL CASES PLOT THE INTENDED WELL ON THE PLAT BELOW

Plat of acreage attributable to a well in a prorated or spaced field

If the intended well is in a prorated or spaced field, please fully complete this side of the form. If the intended well is in a prorated or spaced field complete the plat below showing that the well will be properly located in relationship to other wells producing from the common source of supply. Please show all the wells and within 1 mile of the boundaries of the proposed acreage attribution unit for gas wells and within 1/2 mile of the boundaries of the proposed acreage attribution unit for oil wells.

API No. 15 - 15-033-20408-00-01

Operator: Woolsey Operating Company, LLC

Lease: McMORAN

Well Number: SWD

Field: YELLOWSTONE

Location of Well: County: Comanche

790 feet from N / S Line of Section

930 feet from E / W Line of Section

Sec. 4 Twp. 35 S. R. 16 E W

Number of Acres attributable to well:

QTR/QTR/QTR/QTR of acreage: - NE - SW - SW

Is Section: Regular or Irregular

If Section is Irregular, locate well from nearest corner boundary.

Section corner used: NE NW SE SW

PLAT

(Show location of the well and shade attributable acreage for prorated or spaced wells.)

(Show footage to the nearest lease or unit boundary line.)

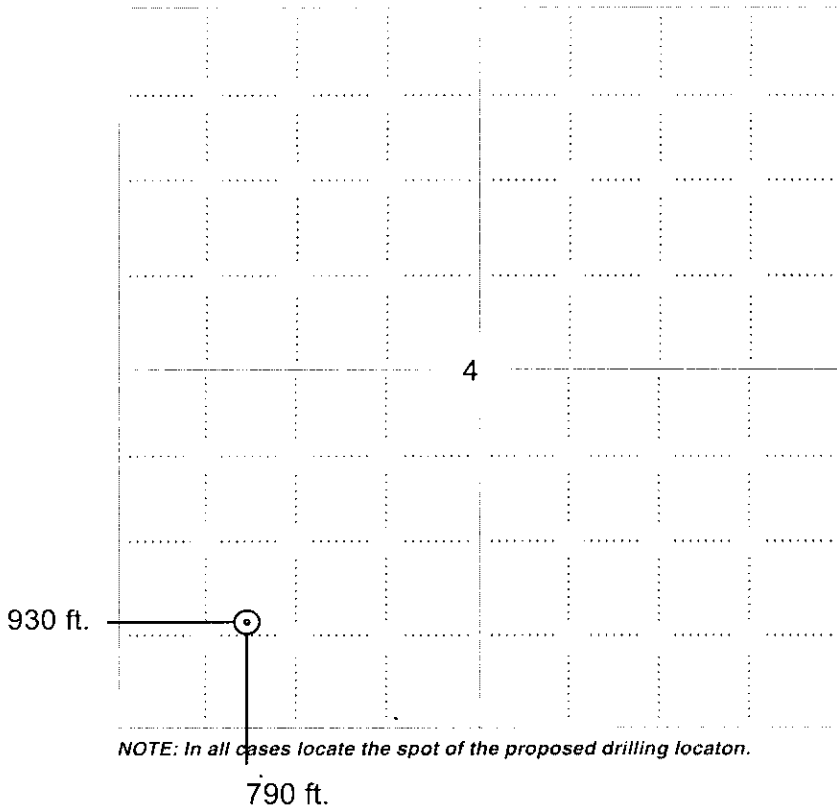

NOTE: In all cases locate the spot of the proposed drilling location.

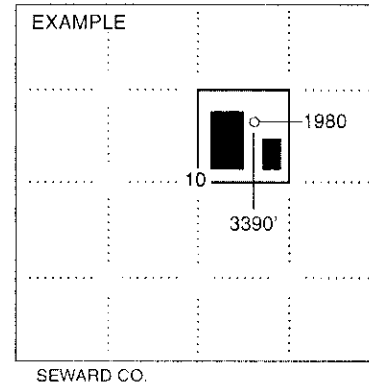

In plotting the proposed location of the well, you must show:

1. The manner in which you are using the depicted plat by identifying section lines, i.e. 1 section, 1 section with 8 surrounding sections, 4 sections, etc.
2. The distance of the proposed drilling location from the south / north and east / west outside section lines.
3. The distance to the nearest lease or unit boundary line (in footage).
4. If proposed location is located within a prorated or spaced field a certificate of acreage attribution plat must be attached: (CO-7 for oil wells; CG-8 for gas wells).



KANSAS CORPORATION COMMISSION 1013925
OIL & GAS CONSERVATION DIVISION

Form CDP-1
April 2004
Form must be Typed

APPLICATION FOR SURFACE PIT

Submit in Duplicate

Operator Name: Woolsey Operating Company, LLC		License Number: 33168	
Operator Address: 125 N MARKET STE 1000		WICHITA KS 67202	
Contact Person: DEAN PATTISSON		Phone Number: 316-267-4379	
Lease Name & Well No.: McMORAN SWD		Pit Location (QQQQ): SW - NE - SW - SW	
Type of Pit: <input type="checkbox"/> Emergency Pit <input type="checkbox"/> Burn Pit <input type="checkbox"/> Settling Pit <input checked="" type="checkbox"/> Drilling Pit <input type="checkbox"/> Workover Pit <input type="checkbox"/> Haul-Off Pit <i>(If WP Supply API No. or Year Drilled)</i>		Pit is: <input checked="" type="checkbox"/> Proposed <input type="checkbox"/> Existing If Existing, date constructed: _____ Pit capacity: 4,800 (bbls)	
Is the pit located in a Sensitive Ground Water Area? <input type="checkbox"/> Yes <input checked="" type="checkbox"/> No		Chloride concentration: _____ mg/l <i>(For Emergency Pits and Settling Pits only)</i>	
Is the bottom below ground level? <input checked="" type="checkbox"/> Yes <input type="checkbox"/> No		Artificial Liner? <input type="checkbox"/> Yes <input checked="" type="checkbox"/> No	
How is the pit lined if a plastic liner is not used? CLAYS FROM MUD WILL PROVIDE SEALER			
Pit dimensions (all but working pits): _____ Length (feet) _____ Width (feet) _____ N/A: Steel Pits Depth from ground level to deepest point: _____ (feet) _____ No Pit			
If the pit is lined give a brief description of the liner material, thickness and installation procedure.		Describe procedures for periodic maintenance and determining liner integrity, including any special monitoring.	
Distance to nearest water well within one-mile of pit _____ feet Depth of water well _____ feet		Depth to shallowest fresh water _____ feet. Source of information: <input type="checkbox"/> measured <input type="checkbox"/> well owner <input type="checkbox"/> electric log <input type="checkbox"/> KDWR	
Emergency, Settling and Burn Pits ONLY: Producing Formation: _____ Number of producing wells on lease: _____ Barrels of fluid produced daily: _____ Does the slope from the tank battery allow all spilled fluids to flow into the pit? <input type="checkbox"/> Yes <input type="checkbox"/> No		Drilling, Workover and Haul-Off Pits ONLY: Type of material utilized in drilling/workover: FRESH Number of working pits to be utilized: 3 Abandonment procedure: WHEN DRY, BACKFILL AND RESTORE LOCATION Drill pits must be closed within 365 days of spud date.	
Submitted Electronically			

KCC OFFICE USE ONLY		Steel Pit <input type="checkbox"/>	RFAC <input checked="" type="checkbox"/>	RFAS <input type="checkbox"/>
Date Received: 11/01/2007	Permit Number: 15-033-20408-00-01	Permit Date: 11/02/2007	Lease Inspection: <input type="checkbox"/> Yes <input checked="" type="checkbox"/> No	

FORM CP-4

KANSAS
CONSERVATION COMMISSION

Information Completely
Required Affidavit
or Deliver Report to
Conservation Division
State Corporation Comm.
245 North Water
Wichita, KS 67202

WELL PLUGGING RECORD

Comanche County, Sec. 4 Twp. 35S Rge. 16W E/W
Location as "NE/CNW/SW" or footage from lines

NE SW SW
Lease Owner Lee Banks
Lease Name McMoran Well No. 1
Office Address 200 W. Douglas, Suite 550, Wichita, KS 67202
Character of Well (Completed as Oil, Gas or Dry Hole)
Dry Hole

Date Well completed January 31, 1981
Application for plugging filed January 31, 1981
Application for plugging approved January 31, 1981
Plugging commenced January 31, 1981
Plugging completed January 31, 1981
Reason for abandonment of well or producing formation

Dry Hole
If a producing well is abandoned, date of last production 19

Was permission obtained from the Conservation Division or its agents before plugging was commenced? Yes

Name of Conservation Agent who supervised plugging of this well Wm. T. Owen
Producing formation _____ Depth to top _____ Bottom _____ Total Depth of Well 5300
Show depth and thickness of all water, oil and gas formations.

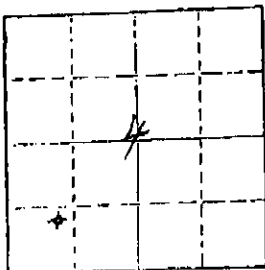

OIL, GAS OR WATER RECORDS

CASING RECORD

FORMATION	CONTENT	FROM	TO	SIZE	PUT IN	PULLED OUT
		0'	407'	8-5/8"	399.26'	None

Describe in detail the manner in which the well was plugged, indicating where the mud fluid was placed and the method or methods used in introducing it into the hole. If cement or other plugs were used, state the character of same and depth placed, from _____ feet to _____ feet for each plug set.

Plugged with 40 sacks cement at 415';
10 sacks cement at 40'; and 15 sacks
cement in rat hole.

(If additional description is necessary, use BACK of this sheet)

Name of Plugging Contractor Allied Cementing Co.

STATE OF KANSAS COUNTY OF SEDGWICK, ss.
John D. Knightley Agent (employee of owner) or (owner or operator)
of the above-described well, being first duly sworn on oath, says: That I have knowledge of the facts, statements, and matters herein contained and the log of the above-described well as filed, and that the same are true and correct. So help me God.

(Signature) [Signature]
221 S. Broadway, Wichita, Kansas 67202
(Address)

SUBSCRIBED AND SWORN TO before me this 23rd day of February, 19 81

[Signature]
Notary Public.

My commission expires March 12, 1983

FEB 23 1981
WICHITA, KANSAS



*Kathleen Sebelius, Governor
Thomas E. Wright, Chairman
Michael C. Moffet, Commissioner
Joseph F. Harkins, Commissioner*

**NOTICE TO OPERATORS FILING INTENT TO DRILL
FOR DISPOSAL OR ENHANCED RECOVERY
INJECTION WELLS. (CLASS II INJECTION WELL)**

The attached approved Notice of Intent to Drill indicates the proposed well is to be used for injection. An approved "Intent to Drill" does not approve injection authority as a Class II Injection Well in Kansas.

Before any well is used for injection purposes, the operator must file an application for injection authority in accordance with K.A.R. 82-3-401 and provide notice in accordance with K.A.R. 82-3-402. The Conservation Division must issue a written permit granting the application before commencement of injection.

The Conservation Division requirements and restrictions associated with Class II Injection are identified in K.A.R. 82-3-400 et seq of our regulations. Associated regulations governing drilling, completion and injection applications may be found in K.A.R. 82-3-135, Table I, Table II, in the Cedar Hills Sandstone Moratorium, (Docket #156,397-C), and the Eastern Kansas Surface Casing Order, (Docket #133,891-C).

If you have questions regarding the approval of injection authority, an injection application may be filed as a "Design Approval" before actual drilling and completion of the well occurs. If you have any questions or concerns regarding Class II injection wells or regulations, call the Underground Injection Control Department at 316-337-6200.

Failure to obtain commission approval before beginning injection is punishable by a penalty, shut-in of the well or both.



*Kathleen Sebelius, Governor
Thomas E. Wright, Chairman
Michael C. Moffet, Commissioner
Joseph F. Harkins, Commissioner*

November 02, 2007

DEAN PATTISSON
Woolsey Operating Company, LLC
125 N MARKET STE 1000
WICHITA, KS67202-1729

Re: Drilling Pit Application
McMORAN Lease Well No. SWD
SW/4 Sec.04-35S-16W
Comanche County, Kansas

Dear DEAN PATTISSON:

District staff has inspected the above referenced location and has determined that the reserve pit shall be constructed **without slots**, the bottom shall be flat and reasonably level, and the free fluids must be removed. The fluids are to be removed from the reserve pit as soon as practical after drilling operations have ceased. **Keep pit away from valley.**

If production casing is set all completion fluids shall be removed from the working pits daily. NO completion fluids or non-exempt wastes shall be placed in the reserve pit.

The fluids should be taken to an authorized disposal well. Please call the District Office at (620) 225-8888 when the fluids have been removed. Please file form CDP-5 (August 2004), Exploration and Production Waste Transfer, within 30 days of fluid removal. Conservation division forms are available through our office and on the KCC web site:
kcc.ks.gov/conservation/forms/

A copy of this letter should be posted in the doghouse along with the approved Intent to Drill. If you have any questions or concerns please feel free to contact the District Office at (620) 225-8888.