

For KCC Use: 11-11-07
Effective Date: 11-11-07
District # 3
SGA? Yes No

KANSAS CORPORATION COMMISSION
OIL & GAS CONSERVATION DIVISION
NOTICE OF INTENT TO DRILL

Form C-1
December 2002
Form must be Typed
Form must be Signed
All blanks must be Filled

Must be approved by KCC five (5) days prior to commencing well

Expected Spud Date 11 28 07 Spot SE NW SE SW Sec. 4 Twp. 24 S. R. 17 East West
30331 month day year

OPERATOR: License# 30531
Name: Bill and Julie Dible
Address: 2336 180th rd
City/State/Zip: Neosho Falls Ks 66758
Contact Person: Bill Dible
Phone: 620-963 2782

770 feet from N / S Line of Section
1890 feet from E / W Line of Section
Is SECTION Regular Irregular?

W (Note: Locate well on the Section Plat on reverse side)

CONTRACTOR: License# 33783 Michael Drilling, LLC
Name: Rick Michael

County: Woodson
Lease Name: Dible Well #: 2A

Field Name: Neosho Falls LeRoy
Is this a Prorated / Spaced Field? Yes No

Well Drilled For: Oil Gas CWAO Seismic; # of Holes Other
Well Class: Infield Pool Ext. Wildcat Other
Type Equipment: Mud Rotary Air Rotary Cable

Target Formation(s): Mississippi
Nearest Lease or unit boundary: 770 ft

Ground Surface Elevation: 975 feet MSL

Water well within one-quarter mile: Yes No

Public water supply well within one mile: Yes No

Depth to bottom of fresh water: 100ft 159ft

Depth to bottom of usable water: 200 150ft

Surface Pipe by Alternate: 1 2

Length of Surface Pipe Planned to be set: 40ft

Length of Conductor Pipe required: na

Projected Total Depth: 1250ft

Formation at Total Depth: Mississippi

Water Source for Drilling Operations: Well Farm Pond Other _____

DWR Permit #: _____

(Note: Apply for Permit with DWR)

Will Cores be taken? Yes No

If Yes, proposed zone: _____

If OWWO: old well information as follows:

Operator: _____

Well Name: _____

Original Completion Date: _____ Original Total Depth: _____

Directional, Deviated or Horizontal wellbore? Yes No

If Yes, true vertical depth: _____

Bottom Hole Location: _____

KCC DKT #: _____

AFFIDAVIT

The undersigned hereby affirms that the drilling, completion and eventual plugging of this well will comply with K.S.A. 55 et seq. It is agreed that the following minimum requirements will be met:

1. Notify the appropriate district office **prior** to spudding of well;
2. A copy of the approved notice of intent to drill **shall be posted** on each drilling rig;
3. The minimum amount of surface pipe as specified below **shall be set** by circulating cement to the top; in all cases surface pipe through all unconsolidated materials plus a minimum of 20 feet into the underlying formation.
4. If the well is dry hole, an agreement between the operator and the district office on plug length and placement is necessary **prior to plugging**;
5. The appropriate district office will be notified before well is either plugged or production casing is cemented in;
6. If an ALTERNATE II COMPLETION, production pipe shall be cemented from below any usable water to surface within **120 days** of spud date. Or pursuant to Appendix "B" - Eastern Kansas surface casing order #133,891-C, which applies to the KCC District 3 area, alternate II cementing must be completed within 30 days of the spud date or the well shall be plugged. **In all cases, NOTIFY district office** prior to any cementing.

I hereby certify that the statements made herein are true and to the best of my knowledge and belief.

Date: 11-01-07 Signature of Operator or Agent: Julie Dible Title: Owner

RECEIVED
NOV 05 2007
KANSAS CORPORATION COMMISSION

OIL & GAS CONSERVATION DIVISION
WICHITA, KS

For KCC Use ONLY
API # 15 - 207-27322-0000
Conductor pipe required None feet
Minimum surface pipe required 20 feet per Alt. 2
Approved by: FWH 11-6-07
This authorization expires: 11-6-08
(This authorization void if drilling not started within 12 months of approval date.)
Spud date: _____ Agent: _____

Remember to:

- File Drill Pit Application (form CDP-1) with Intent to Drill;
- File Completion Form ACO-1 within 120 days of spud date;
- File acreage attribution plat according to field proration orders;
- Notify appropriate district office 48 hours prior to workover or re-entry;
- Submit plugging report (CP-4) after plugging is completed;
- Obtain written approval before disposing or injecting salt water.

If this permit has expired (See: authorized expiration date) please check the box below and return to the address below.

Well Not Drilled - Permit Expired

Signature of Operator or Agent: _____

Date: _____

Mail to: KCC - Conservation Division, 130 S. Market - Room 2078, Wichita, Kansas 67202

4
24
17E

IN ALL CASES PLOT THE INTENDED WELL ON THE PLAT BELOW

Plat of acreage attributable to a well in a prorated or spaced field

If the intended well is in a prorated or spaced field, please fully complete this side of the form. If the intended well is in a prorated or spaced field complete the plat below showing that the well will be properly located in relationship to other wells producing from the common source of supply. Please show all the wells and within 1 mile of the boundaries of the proposed acreage attribution unit for gas wells and within 1/2 mile of the boundaries of the proposed acreage attribution unit for oil wells.

API No. 15 - 207-27322-0000

Operator: _____

Lease: _____

Well Number: _____

Field: _____

Number of Acres attributable to well: _____

QTR / QTR / QTR of acreage: _____

Location of Well: County: Woodson

770 feet from N / S Line of Section

1890 feet from E / W Line of Section

Sec. 4 Twp. 24 S. R. 17 East West

Is Section: Regular or Irregular

If Section is Irregular, locate well from nearest corner boundary.

Section corner used: NE NW SE SW

PLAT

(Show location of the well and shade attributable acreage for prorated or spaced wells.)

(Show footage to the nearest lease or unit boundary line.)

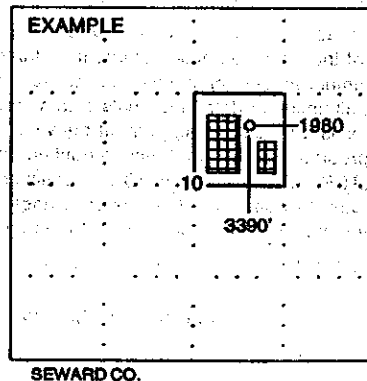
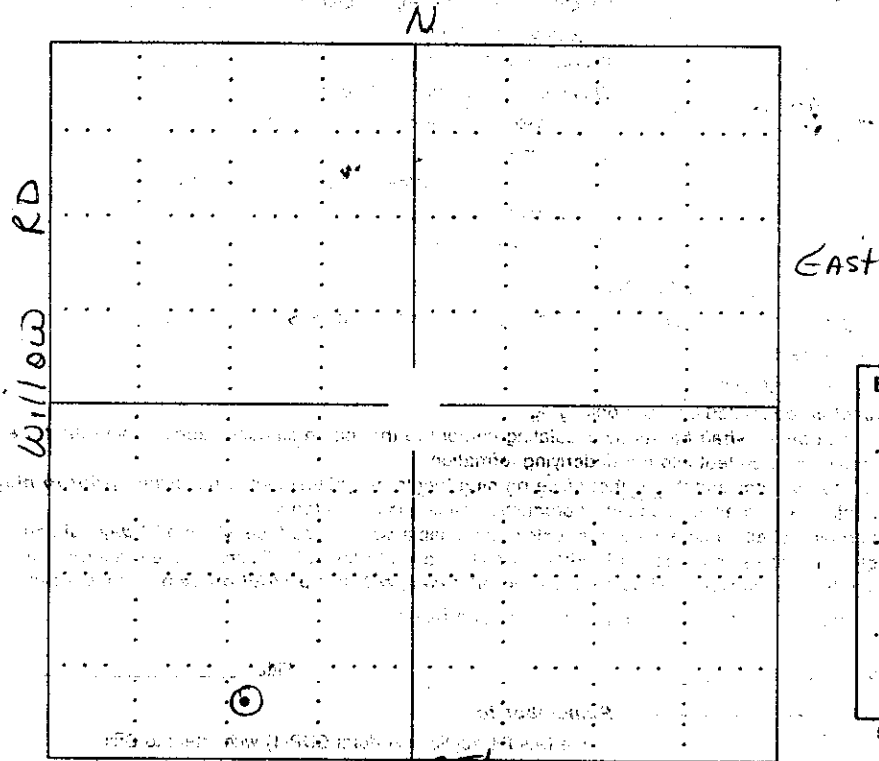

NOTE: In all cases locate the spot of the proposed drilling location.

In plotting the proposed location of the well, you must show:

1. The manner in which you are using the depicted plat by identifying section lines, i.e. 1 section, 1 section with 8 surrounding sections, 4 sections, etc.
2. The distance of the proposed drilling location from the section's south / north and east / west.
3. The distance to the nearest lease or unit boundary line.
4. If proposed location is located within a prorated or spaced field a certificate of acreage attribution plat must be attached: (C0-7 for oil wells; CG-8 for gas wells).

KANSAS CORPORATION COMMISSION
OIL & GAS CONSERVATION DIVISION
APPLICATION FOR SURFACE PIT

Form CDP-1
April 2004
Form must be Typed

Submit in Duplicate

Operator Name: <u>B Bill and Julie Dible</u>		License Number: <u>30531</u>
Operator Address: <u>2336 180th rd</u>		
Contact Person: <u>Bill Dible</u>		Phone Number: <u>620) 963-2782</u>
Lease Name & Well No.: <u>Dible 2 A</u>		Pit Location (QQQQ): <u>SE NW SE SW</u>
Type of Pit: <input type="checkbox"/> Emergency Pit <input type="checkbox"/> Burn Pit <input type="checkbox"/> Settling Pit <input type="checkbox"/> Drilling Pit <input type="checkbox"/> Workover Pit <input type="checkbox"/> Haul-Off Pit <small>(If WP Supply API No. or Year Drilled)</small>	Pit is: <input checked="" type="checkbox"/> Proposed <input type="checkbox"/> Existing If Existing, date constructed: _____ Pit capacity: _____ (bbls)	Sec. <u>4</u> Twp. <u>24</u> R. <u>17</u> <input type="checkbox"/> East <input type="checkbox"/> West <u>770</u> Feet from <input type="checkbox"/> North / <input checked="" type="checkbox"/> South Line of Section <u>1890</u> Feet from <input type="checkbox"/> East / <input checked="" type="checkbox"/> West Line of Section <u>Woodson</u> County
Is the pit located in a Sensitive Ground Water Area? <input checked="" type="checkbox"/> Yes <input checked="" type="checkbox"/> No		Chloride concentration: _____ mg/l <small>(For Emergency Pits and Settling Pits only)</small>
Is the bottom below ground level? <input checked="" type="checkbox"/> Yes <input type="checkbox"/> No	Artificial Liner? <input type="checkbox"/> Yes <input checked="" type="checkbox"/> No	How is the pit lined if a plastic liner is not used? <u>natural clay</u>
Pit dimensions (all but working pits): <u>20</u> Length (feet) <u>10</u> Width (feet) _____ N/A: Steel Pits Depth from ground level to deepest point: <u>5</u> (feet)		
If the pit is lined give a brief description of the liner material, thickness and installation procedure.		Describe procedures for periodic maintenance and determining liner integrity, including any special monitoring.
Distance to nearest water well within one-mile of pit <u>1320</u> feet Depth of water well <u>18</u> feet		Depth to shallowest fresh water <u>18</u> feet. Source of information: _____ measured <input checked="" type="checkbox"/> well owner _____ electric log _____ KDWR
Emergency, Settling and Burn Pits ONLY: Producing Formation: _____ Number of producing wells on lease: _____ Barrels of fluid produced daily: _____ Does the slope from the tank battery allow all spilled fluids to flow into the pit? <input type="checkbox"/> Yes <input type="checkbox"/> No		Drilling, Workover and Haul-Off Pits ONLY: Type of material utilized in drilling/workover: <u>drilling mud</u> Number of working pits to be utilized: _____ Abandonment procedure: <u>evaporation and backfill</u> Drill pits must be closed within 365 days of spud date.
I hereby certify that the above statements are true and correct to the best of my knowledge and belief.		
<u>11-1-07</u> Date		<u>Julie Dible</u> Signature of Applicant or Agent

RECEIVED
KANSAS CORPORATION COMMISSION
NOV 05 2007
CONSERVATION DIVISION
WICHITA, KS

15-207-27322-0000

KCC OFFICE USE ONLY

Date Received: 11/5/07 Permit Number: _____ Permit Date: 11/5/07 Lease Inspection: Yes No