



For KCC Use:
Effective Date: 11/18/2007
District # 1
SGA? ☒ Yes ☐ No

KANSAS CORPORATION COMMISSION
OIL & GAS CONSERVATION DIVISION

1014141

Form C-1
October 2007

Form must be Typed
Form must be Signed
All blanks must be Filled

NOTICE OF INTENT TO DRILL

Must be approved by KCC five (5) days prior to commencing well

Expected Spud Date: 11/27/2007
month day year

OPERATOR: License# 33168
Name: Woolsey Operating Company, LLC
Address 1: 125 N MARKET STE 1000
Address 2:
City: WICHITA State: KS Zip: 67202 + 1729
Contact Person: DEAN PATTISSON
Phone: 316-267-4379
CONTRACTOR: License# 33610
Name: Fossil Drilling, Inc.

Well Drilled For: Well Class: Type Equipment:
☒ Oil ☐ Enh Rec ☒ Infield ☒ Mud Rotary
☒ Gas ☐ Storage ☐ Pool Ext. ☐ Air Rotary
☐ Disposal ☐ Wildcat ☐ Cable
☐ Seismic: # of Holes ☐ Other
☐ Other:

☐ If OWWO: old well information as follows:

Operator:
Well Name:
Original Completion Date: Original Total Depth:

Directional, Deviated or Horizontal wellbore? ☐ Yes ☒ No
If Yes, true vertical depth:
Bottom Hole Location:
KCC DKT #:

Spot Description:
NW NE NW Sec. 4 Twp. 34 S. R. 11 ☐ E ☒ W
(0-0-0-0) 330 feet from ☒ N / ☐ S Line of Section
1,650 feet from ☐ E / ☒ W Line of Section

Is SECTION: ☒ Regular ☐ Irregular?

(Note: Locate well on the Section Plat on reverse side)

County: Barber
Lease Name: FORESTER C Well #: 1
Field Name: ROUNDUP SOUTH
Is this a Prorated / Spaced Field? ☐ Yes ☒ No
Target Formation(s): MISSISSIPPIAN

Nearest Lease or unit boundary line (in footage): 330
Ground Surface Elevation: 1360 feet MSL
Water well within one-quarter mile: ☐ Yes ☒ No
Public water supply well within one mile: ☐ Yes ☒ No
Depth to bottom of fresh water: 180
Depth to bottom of usable water: 180
Surface Pipe by Alternate: ☒ I ☐ II
Length of Surface Pipe Planned to be set: 200
Length of Conductor Pipe (if any): 0
Projected Total Depth: 5100
Formation at Total Depth: SIMPSON
Water Source for Drilling Operations:
☐ Well ☐ Farm Pond ☒ Other: TO BE HAULED

DWR Permit #: (Note: Apply for Permit with DWR ☐)
Will Cores be taken? ☐ Yes ☒ No
If Yes, proposed zone:

AFFIDAVIT

The undersigned hereby affirms that the drilling, completion and eventual plugging of this well will comply with K.S.A. 55 et. seq.

It is agreed that the following minimum requirements will be met:

1. Notify the appropriate district office **prior** to spudding of well;
2. A copy of the approved notice of intent to drill **shall be** posted on each drilling rig;
3. The minimum amount of surface pipe as specified below **shall be set** by circulating cement to the top; in all cases surface pipe **shall be set** through all unconsolidated materials plus a minimum of 20 feet into the underlying formation.
4. If the well is dry hole, an agreement between the operator and the district office on plug length and placement is necessary **prior to plugging**;
5. The appropriate district office will be notified before well is either plugged or production casing is cemented in;
6. If an ALTERNATE II COMPLETION, production pipe shall be cemented from below any usable water to surface within **120 DAYS** of spud date.
Or pursuant to Appendix "B" - Eastern Kansas surface casing order #133,891-C, which applies to the KCC District 3 area, alternate II cementing must be completed within 30 days of the spud date or the well shall be plugged. **In all cases, NOTIFY district office** prior to any cementing.

Submitted Electronically

For KCC Use ONLY
API # 15 - 15-007-23235-00-00
Conductor pipe required 0 feet
Minimum surface pipe required 200 feet per ALT. ☒ I ☐ II
Approved by: Rick Hestermann 11/13/2007
This authorization expires: 11/13/2008
(This authorization void if drilling not started within 12 months of approval date.)
Spud date: Agent:

Remember to:

- File Drill Pit Application (form CDP-1) with Intent to Drill;
- File Completion Form ACO-1 within 120 days of spud date;
- File acreage attribution plat according to field proration orders;
- Notify appropriate district office 48 hours prior to workover or re-entry;
- Submit plugging report (CP-4) after plugging is completed (within 60 days);
- Obtain written approval before disposing or injecting salt water.
- If this permit has expired (See: authorized expiration date) please check the box below and return to the address below.

☐ Well Not Drilled - Permit Expired Date: Signature of Operator or Agent:

Mail to: KCC - Conservation Division, 130 S. Market - Room 2078, Wichita, Kansas 67202

4

34

11

☐ E

☒ W



1014141

IN ALL CASES PLOT THE INTENDED WELL ON THE PLAT BELOW

Plat of acreage attributable to a well in a prorated or spaced field

If the intended well is in a prorated or spaced field, please fully complete this side of the form. If the intended well is in a prorated or spaced field complete the plat below showing that the well will be properly located in relationship to other wells producing from the common source of supply. Please show all the wells and within 1 mile of the boundaries of the proposed acreage attribution unit for gas wells and within 1/2 mile of the boundaries of the proposed acreage attribution unit for oil wells.

API No. 15 - 15-007-23235-00-00

Operator: Woolsey Operating Company, LLC

Lease: FORESTER C

Well Number: 1

Field: ROUNDUP SOUTH

Number of Acres attributable to well:

QTR/QTR/QTR/QTR of acreage: - NW - NE - NW

Location of Well: County: Barber

330 feet from ☒ N / ☐ S Line of Section1,650 feet from ☐ E / ☒ W Line of SectionSec. 4 Twp. 34 S. R. 11 ☐ E ☒ WIs Section: ☒ Regular or ☐ Irregular

If Section is Irregular, locate well from nearest corner boundary.

Section corner used: ☐ NE ☐ NW ☐ SE ☐ SW

PLAT

(Show location of the well and shade attributable acreage for prorated or spaced wells.)

(Show footage to the nearest lease or unit boundary line.)

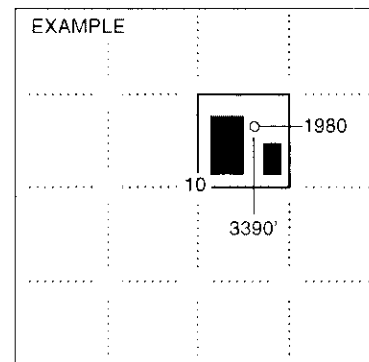
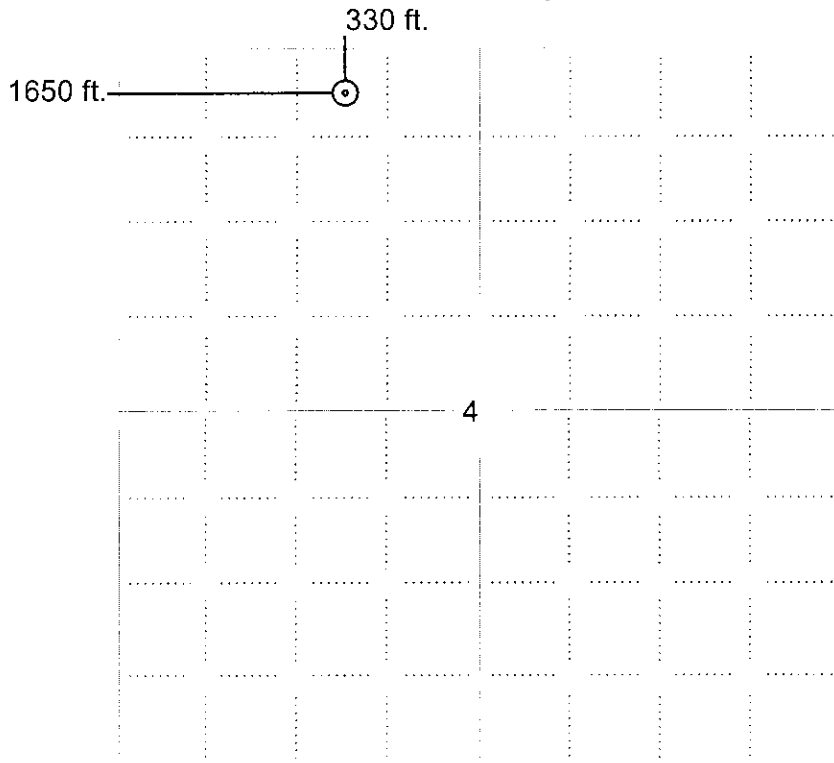

SEWARD CO.

NOTE: In all cases locate the spot of the proposed drilling location.

In plotting the proposed location of the well, you must show:

1. The manner in which you are using the depicted plat by identifying section lines, i.e. 1 section, 1 section with 8 surrounding sections, 4 sections, etc.
2. The distance of the proposed drilling location from the south / north and east / west outside section lines.
3. The distance to the nearest lease or unit boundary line (in footage).
4. If proposed location is located within a prorated or spaced field a certificate of acreage attribution plat must be attached: (CO-7 for oil wells; CG-8 for gas wells).



KANSAS CORPORATION COMMISSION 1014141
OIL & GAS CONSERVATION DIVISION

Form CDP-1
April 2004
Form must be Typed

APPLICATION FOR SURFACE PIT

Submit in Duplicate

Operator Name: Woolsey Operating Company, LLC		License Number: 33168	
Operator Address: 125 N MARKET STE 1000		WICHITA KS 67202	
Contact Person: DEAN PATTISSON		Phone Number: 316-267-4379	
Lease Name & Well No.: FORESTER C 1		Pit Location (QQQQ): NW NE NW Sec. 4 Twp. 34 R. 11 <input type="checkbox"/> East <input checked="" type="checkbox"/> West 330 Feet from <input checked="" type="checkbox"/> North / <input type="checkbox"/> South Line of Section 1,650 Feet from <input type="checkbox"/> East / <input checked="" type="checkbox"/> West Line of Section Barber County	
Type of Pit: <input type="checkbox"/> Emergency Pit <input type="checkbox"/> Burn Pit <input type="checkbox"/> Settling Pit <input checked="" type="checkbox"/> Drilling Pit <input type="checkbox"/> Workover Pit <input type="checkbox"/> Haul-Off Pit (If WP Supply API No. or Year Drilled)	Pit is: <input checked="" type="checkbox"/> Proposed <input type="checkbox"/> Existing If Existing, date constructed: Pit capacity: 4,800 (bbls)		
Is the pit located in a Sensitive Ground Water Area? <input checked="" type="checkbox"/> Yes <input type="checkbox"/> No		Chloride concentration: _____ mg/l (For Emergency Pits and Settling Pits only)	
Is the bottom below ground level? <input checked="" type="checkbox"/> Yes <input type="checkbox"/> No		Artificial Liner? <input type="checkbox"/> Yes <input checked="" type="checkbox"/> No	
		How is the pit lined if a plastic liner is not used? CLAYS FROM MUD WILL PROVIDE SEALER	
Pit dimensions (all but working pits): 100 Length (feet) 100 Width (feet) <input type="checkbox"/> N/A: Steel Pits Depth from ground level to deepest point: 4 (feet) <input type="checkbox"/> No Pit			
If the pit is lined give a brief description of the liner material, thickness and installation procedure.		Describe procedures for periodic maintenance and determining liner integrity, including any special monitoring.	
Distance to nearest water well within one-mile of pit 2091 feet Depth of water well 32 feet		Depth to shallowest fresh water 16 feet. Source of information: <input type="checkbox"/> measured <input type="checkbox"/> well owner <input type="checkbox"/> electric log <input checked="" type="checkbox"/> KDWR	
Emergency, Settling and Burn Pits ONLY: Producing Formation: Number of producing wells on lease: Barrels of fluid produced daily: Does the slope from the tank battery allow all spilled fluids to flow into the pit? <input type="checkbox"/> Yes <input type="checkbox"/> No		Drilling, Workover and Haul-Off Pits ONLY: Type of material utilized in drilling/workover: FRESH Number of working pits to be utilized: 3 Abandonment procedure: MONITOR UNTIL DRY, THEN BACKFILL TO RESTORE LOCATION Drill pits must be closed within 365 days of spud date.	
Submitted Electronically			

KCC OFFICE USE ONLY		Steel Pit <input type="checkbox"/>	RFAC <input checked="" type="checkbox"/>	RFAS <input checked="" type="checkbox"/>
Date Received: 11/12/2007	Permit Number: 15-007-23235-00-00	Permit Date: 11/13/2007	Lease Inspection: <input checked="" type="checkbox"/> Yes <input type="checkbox"/> No	

Mail to: KCC - Conservation Division, 130 S. Market - Room 2078, Wichita, Kansas 67202



*Kathleen Sebelius, Governor
Thomas E. Wright, Chairman
Michael C. Moffet, Commissioner
Joseph F. Harkins, Commissioner*

November 13, 2007

DEAN PATTISSON
Woolsey Operating Company, LLC
125 N MARKET STE 1000
WICHITA, KS67202-1729

Re: Drilling Pit Application
FORESTER C Lease Well No. 1
NW/4 Sec.04-34S-11W
Barber County, Kansas

Dear DEAN PATTISSON:

District staff has inspected the above referenced location and has determined that the reserve pit shall be constructed **without slots**, the bottom shall be flat and reasonably level and the free fluids must be removed. The fluids are to be removed from the reserve pit as soon as the Hutchinson Salt section has been drilled through and displacement of the fluids into the reserve pit has occurred. The fluids should be removed again as soon as practical after drilling operations have ceased.

If production casing is set all completion fluids shall be removed from the working pits daily. NO completion fluids or non-exempt wastes shall be placed in the reserve pit.

The fluids should be taken to an authorized disposal well. Please call the District Office at (620) 225-8888 when the fluids have been removed. Please file form CDP-5 (August 2004), Exploration and Production Waste Transfer, within 30 days of fluid removal. Conservation division forms are available through our office and on the KCC web site: kcc.ks.gov/conservation/forms/

A copy of this letter should be posted in the doghouse along with the approved Intent to Drill. If you have any questions or concerns please feel free to contact the District Office at (620) 225-8888.