

For KCC Use: 11-18-07
Effective Date: _____
District # _____
SGA? Yes No

KANSAS CORPORATION COMMISSION
OIL & GAS CONSERVATION DIVISION

Form C-1
December 2002
Form must be Typed
Form must be Signed
All blanks must be Filled

NOTICE OF INTENT TO DRILL

Must be approved by KCC five (5) days prior to commencing well

Expected Spud Date November 19 2007
month day year

OPERATOR: License # 5003
Name: McCoy Petroleum Corporation
Address: 8080 E. Central, Suite #300
City/State/Zip: Wichita, KS 67206-2366
Contact Person: Scott Hampel
Phone: 316-636-2737x104

CONTRACTOR: License # 5142
Name: Sterling Drilling Company

Well Drilled For: Oil Enh Rec Gas OWWO Seismic Other
Well Class: Infield Pool Ext. Wildcat Other
Type Equipment: Mud Rotary Air Rotary Cable

If OWWO: old well information as follows:
Operator: _____
Well Name: _____
Original Completion Date: _____ Original Total Depth: _____
Directional, Deviated or Horizontal wellbore? Yes No
If Yes, true vertical depth: _____
Bottom Hole Location: _____
KCC DKT #: _____

Spot _____ East
C SW SW Sec 20 Twp. 26 S. R. 17 West
_____ 660 feet from N / S Line of Section
_____ 660 feet from E / W Line of Section

Is SECTION Regular Irregular?
(Note: Locate well on the Section Plat on reverse side)

County: Edwards
Lease Name: SPRIGGS "A" Well #: 1-20
Field Name: Mull West

Is this a Prorated / Spaced Field? Yes No

Target Information(s): Mississippian
Nearest Lease or unit boundary: 660'

Ground Surface Elevation: 2138' feet MSL

Water well within one-quarter mile: Yes No

Public water supply well within one mile: Yes No

Depth to bottom of fresh water: 200'

Depth to bottom of usable water: 240'

Surface Pipe by Alternate: 1 2

Length of Surface Pipe Planned to be set: 270'

Length of Conductor Pipe required: None

Projected Total Depth: 4600'

Formation at Total Depth: Mississippian

Water Source for Drilling Operations:

Well Farm Pond Other

DWR Permit #: _____

(Note: Apply for Permit with DWR)

Will Cores be taken? Yes No

If Yes, proposed zone: _____

AFFIDAVIT

The undersigned hereby affirms that the drilling, completion and eventual plugging of this well will comply with K.S.A. 55 et. seq.

RECEIVED
KANSAS CORPORATION COMMISSION

It is agreed that the following minimum requirements will be met:

1. Notify the appropriate district office **prior** to spudding of well;
2. A copy of the approved notice of intent to drill **shall be** posted on each drilling rig;
3. The minimum amount of surface pipe as specified below **shall be set** by circulating cement to the top, in all cases surface pipe **shall be set** through all unconsolidated materials plus a minimum of 20 feet into the underlying formation.
4. If the well is dry hole, an agreement between the operator and the district office on plug length and placement is necessary **prior to plugging**;
5. The appropriate district office will be notified before well is either plugged or production casing is cemented in;
6. If an ALTERNATE II COMPLETION, production pipe shall be cemented from below any unable water to surface within **120 days** of plug date. Or pursuant to Appendix "B" - Eastern Kansas surface casing order #133.891-C, which applies to the KCC District 3 area, alternate II cementing must be completed within 30 days of the spud date or the well shall be plugged. **In all cases, NOTIFY district office** prior to any cementing.

NOV 08 2007

I hereby certify that the statements made herein are true and to the best of my knowledge and belief.

Date: 11/7/07 Signature of Operator or Agent: Scott Hampel Title: Vice President - Production

Scott Hampel

Remember to:

- File Drill Pit Application (form CDP-1) with Intent to Drill;
- File Completion Form ACO-1 within 120 days of spud date;
- File acreage attribution plat according to field proration orders;
- Notify appropriate district office 48 hours prior to workover or re-entry;
- Submit plugging report (CP-4) after plugging is completed;
- Obtain written approval before disposing or injecting salt water.

- If this permit has expired (see: authorized expiration date) please check the box below and return to the address below.

Well Not Drilled - Permit Expired

Signature of Operator or Agent: _____
Date: _____

For KCC Use ONLY
API # 15 - 047-21565-0000
Conductor pipe required None feet
Minimum surface pipe required 260 feet per Alt 1
Approved by: Permit 11-13-07
This authorization expires: 11-13-08
(This authorization void if drilling not started within 1/2 months of effective date.)
Spud date: _____ Agent: _____

Mail to: KCC - Conservation Division, 130 S. Market - Room 2078, Wichita, Kansas 67202

20
26
17M

IN ALL CASES PLOT THE INTENDED WELL ON THE PLAT BELOW

Plat of acreage attributable to a well in a prorated or spaced field

If the intended well is in a prorated or spaced field, please fully complete this side of the form. If the intended well is in a prorated or spaced field complete the plat below showing that the well will be properly located in relationship to other wells producing from the common source of supply. Please show all the wells and within 1 mile of the boundaries of the proposed acreage attribution unit for gas wells and within 1/2 mile of the boundaries of the proposed acreage attribution unit for oil wells.

API No. 15 - 047-21565-0000
 Operator: McCoy Petroleum Corporation
 Lease: SPRIGGS "A"
 Well Number: #1-20
 Field: Mull West
 Number of Acres attributable to well: 160
 QTR / QTR / QTR of acreage: C SW SW

Location of Well: County: Edwards Co., KS
660 feet from N S (check one) Line of Section
660 feet from E W (check one) Line of Section
 Sec 20 Twp 26s S. R. 17w East West
 Is Section X Regular or _____ Irregular
If Section is Irregular, locate well from nearest corner boundary.
 Section corner used: NE NW SE X SW

PLAT

(Show location of the well and shade attributable acreage for prorated or spaced wells)
(Show footage to the nearest lease or unit boundary fine.)

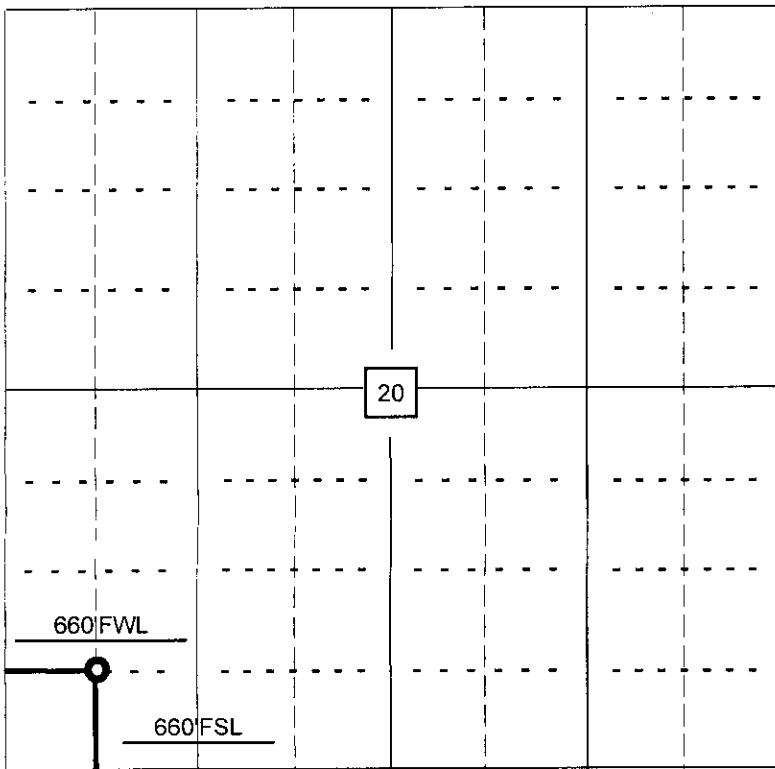

RECEIVED
 KANSAS CORPORATION COMMISSION
 NOV 08 2007
 CONSERVATION DIVISION
 WICHITA, KS

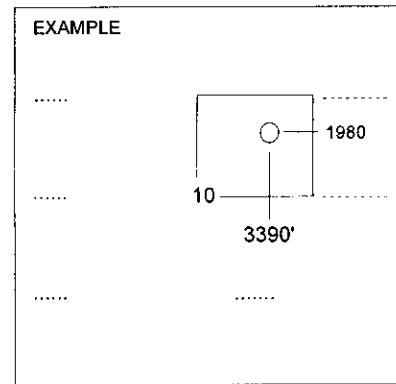

SEWARD CO.

NOTE: In all cases locate the spot of the proposed drilling location.

In plotting the proposed location of the well, you must show.

1. The manner in which you are using the depicted plat by identifying section lines, i.e. 1 section, 1 section with 8 surrounding sections, 4 sections, etc.
2. The distance of the proposed drilling location from the section's south / north and east / west.
3. The distance to the nearest lease or unit boundary line.
4. If proposed location is located within a prorated or spaced field a certificate of acreage attribution plat must be attached: (CO-7 for oil wells; CG-8 for gas wells).

**KANSAS CORPORATION COMMISSION
OIL & GAS CONSERVATION DIVISION
APPLICATION FOR SURFACE PIT**

Form CDP-1
April 2004
Form must be Typed

Submit in Duplicate

Operator Name: McCoy Petroleum Corporation		License Number: 5003
Operator Address: 8080 E. Central, Suite #300, Wichita, KS 67206-2366		
Contact Person: Scott Hampel		Phone Number: 316-636-2737x104
Lease Name & Well No.: SPRIGGS "A" #1-20		Pit Location (QQQQ):
Type of Pit: <input type="checkbox"/> Emergency Pit <input type="checkbox"/> Burn Pit <input type="checkbox"/> Settling Pit <input checked="" type="checkbox"/> Drilling Pit <input type="checkbox"/> Workover Pit <input type="checkbox"/> Haul-Off Pit <small>(If WP Supply API No. or Year Drilled)</small>		Pit is: <input checked="" type="checkbox"/> Proposed <input type="checkbox"/> Existing If Existing, date constructed: _____ Pit capacity: 3600 (bbls)
Is the pit located in a Sensitive Ground Water Area? <input checked="" type="checkbox"/> Yes <input type="checkbox"/> No		Chloride concentration: _____ mg/l <small>(For Emergency Pits and Settling Pits only)</small>
Is the bottom below ground level? <input checked="" type="checkbox"/> Yes <input type="checkbox"/> No		How is the pit lined if a plastic liner is not used? Bentonite / Drilling Mud
Pit dimensions (all but working pits): <u>80</u> Length (feet) <u>80</u> Width (feet) _____ N/A: Steel Pits Depth from ground level to deepest point: <u>4</u> (feet)		
If the pit is lined give a brief description of the liner material, thickness and installation procedure.		Describe procedures for periodic maintenance and determining liner integrity, including any special monitoring.
Distance to nearest water well within one-mile of pit <u>NA 1013</u> feet Depth of water well <u>NA 70</u> feet		Depth to shallowest fresh water <u>NA 28</u> feet. Source of information: <input type="checkbox"/> measured <input checked="" type="checkbox"/> well owner <input type="checkbox"/> electric log <input type="checkbox"/> KDWR
Emergency, Settling and Burn Pits ONLY: Producing Formation: _____ Number of producing wells on lease: _____ Barrels of fluid produced daily: _____ Does the slope from the tank battery allow all spilled fluids to flow into the pit? <input type="checkbox"/> Yes <input type="checkbox"/> No		Drilling, Workover and Haul-Off Pits ONLY: Type of material utilized in drilling/workover: <u>Bentonite</u> Number of working pits to be utilized: <u>3</u> Abandonment procedure: <u>Remove free fluid, let dry, backfill, return surface to original condition.</u> Drill pits must be closed within 365 days of spud date.
I hereby certify that the above statements are true and correct to the best of my knowledge and belief.		
_____ Date 11/7/07		_____ Signature of Applicant or Agent Scott Hampel

15-047-21565-0000

KCC OFFICE USE ONLY

RFSvc

RECEIVED

Date Received: 11/8/07 Permit Number: _____ Permit Date: 11/13/07 Lease Inspection _____

Mail to: KCC - Conservation Division, 130 S. Market - Room 2078, Wichita, Kansas 67202

NOV 08 2007

CONSERVATION DIVISION
WICHITA, KS



Kathleen Sebelius, Governor
Thomas E. Wright, Chairman
Michael C. Moffet, Commissioner
Joseph F. Harkins, Commissioner

November 13, 2007

Mr. Scott Hampel
McCoy Petroleum Corporation
8080 E. Central Ste 300
Wichita, KS 67206-2366

RE: Drilling Pit Application
Spriggs A Lease Well No. 1-20
SW/4 Sec. 20-26S-17W
Edwards County, Kansas

Dear Mr. Hampel:

District staff has inspected the above referenced location and has determined that the reserve pit shall be constructed **without slots**, the bottom shall be flat and reasonably level and the free fluids must be removed. The fluids are to be removed from the reserve pit as soon as the Hutchinson Salt section has been drilled through and displacement of the fluids into the reserve pit has occurred. The fluids should be removed again as soon as practical after drilling operations have ceased.

If production casing is set all completion fluids shall be removed from the working pits daily. NO completion fluids or non-exempt wastes shall be placed in the reserve pit.

The fluids should be taken to an authorized disposal well. Please call the District Office at (620) 225-8888 when the fluids have been removed. Please file form CDP-5 (August 2004), Exploration and Production Waste Transfer, within 30 days of fluid removal. Conservation division forms are available through our office and on the KCC web site: www.kcc.state.ks.us/conservation/forms.

A copy of this letter should be posted in the doghouse along with the approved Intent to Drill.

If you have any questions or concerns please feel free to contact the undersigned at the above address.

Sincerely,

Kathy Haynes
Department of Environmental Protection and Remediation

cc: File