

For KCC Use: 11-1907
 Effective Date: 4
 District # 4
 SGA? Yes No

KANSAS CORPORATION COMMISSION
 OIL & GAS CONSERVATION DIVISION

Form C-1

October 2007

Form must be Typed

Form must be Signed

All blanks must be Filled

NOTICE OF INTENT TO DRILL

Must be approved by KCC five (5) days prior to commencing well

Expected Spud Date: 11-23-07
 month day year

OPERATOR: License# 5259 ✓
 Name: Mai Oil Operations, Inc.
 Address 1: P.O. Box 33
 Address 2:
 City: Russell, Ks. State: Ks. Zip: 67665 +
 Contact Person: Allen Bangert
 Phone: 785-483-2169

CONTRACTOR: License# 33350 ✓
 Name: Southwind Drilling, Inc.

Well Drilled For: Oil Gas Seismic; # of Holes Other:
 Enh Rec Storage Disposal
 Well Class: Infield Pool Ext. Wildcat Other
 Type Equipment: Mud Rotary Air Rotary Cable

If OWWO: old well information as follows:
 Operator:
 Well Name:
 Original Completion Date: Original Total Depth:

Directional, Deviated or Horizontal wellbore? Yes No
 If Yes, true vertical depth:
 Bottom Hole Location:
 KCC DKT #:

Spot Description: 28' South and 18' West
 SW NE NW Sec. 27 Twp. 15 S. R. 14 E W
 (a/a/a/a) 1,018 feet from N / S Line of Section
1,632 feet from E / W Line of Section

Is SECTION: Regular Irregular?
 (Note: Locate well on the Section Plat on reverse side)
 County: Russell

Lease Name: Brunardt Well #: 1
 Field Name: Wildcat

Is this a Prorated / Spaced Field? Yes No
 Target Formation(s): Arbuckle

Nearest Lease or unit boundary line (in footage): 1008'
 Ground Surface Elevation: 1895' feet MSL

Water well within one-quarter mile: Yes No
 Public water supply well within one mile: Yes No

Depth to bottom of fresh water: 220'
 Depth to bottom of usable water: 380' 380'

Surface Pipe by Alternate: I II
 Length of Surface Pipe Planned to be set: 380' 400 minimum

Length of Conductor Pipe (if any): None
 Projected Total Depth: 3420'

Formation at Total Depth: Arbuckle
 Water Source for Drilling Operations:
 Well Farm Pond Other:

DWR Permit #: (Note: Apply for Permit with DWR)

Will Cores be taken? Yes No
 If Yes, proposed zone:

AFFIDAVIT

The undersigned hereby affirms that the drilling, completion and eventual plugging of this well will comply with K.S.A. 55 et. seq.
 It is agreed that the following minimum requirements will be met:

RECEIVED
 NOV 13 2007

KCC WICHITA

1. Notify the appropriate district office **prior** to spudding of well;
2. A copy of the approved notice of intent to drill **shall be posted** on each drilling rig;
3. The minimum amount of surface pipe as specified below **shall be set** by circulating cement to the top; in all cases surface pipe **shall be set** through all unconsolidated materials plus a minimum of 20 feet into the underlying formation.
4. If the well is dry hole, an agreement between the operator and the district office on plug length and placement is necessary **prior to plugging**;
5. The appropriate district office will be notified before well is either plugged or production casing is cemented in;
6. If an ALTERNATE II COMPLETION, production pipe shall be cemented from below any usable water to surface within **120 DAYS** of spud date. Or pursuant to Appendix "B" - Eastern Kansas surface casing order #133,891-C, which applies to the KCC District 3 area, alternate II cementing must be completed within 30 days of the spud date or the well shall be plugged. **In all cases, NOTIFY district office** prior to any cementing.

I hereby certify that the statements made herein are true and correct to the best of my knowledge and belief.

Date: 11-08-07 Signature of Operator or Agent: Allen Bangert Title: Prod. Supt.

For KCC Use ONLY
 API # 15 - 167-23472-0000
 Conductor pipe required None feet
 Minimum surface pipe required 400 feet per ALT. I II
 Approved by: 11-14-07
 This authorization expires: 11/14/08
 (This authorization void if drilling not started within 12 months of approval date.)
 Spud date: Agent:

- Remember to:
- File Drill Pit Application (form CDP-1) with Intent to Drill;
 - File Completion Form ACO-1 within 120 days of spud date;
 - File acreage attribution plat according to field proration orders;
 - Notify appropriate district office 48 hours prior to workover or re-entry;
 - Submit plugging report (CP-4) after plugging is completed (within 60 days);
 - Obtain written approval before disposing or injecting salt water.
 - If this permit has expired (See: authorized expiration date) please check the box below and return to the address below.

Well Not Drilled - Permit Expired Date: Signature of Operator or Agent:

27
15
14
 E W

IN ALL CASES PLOT THE INTENDED WELL ON THE PLAT BELOW

Plat of acreage attributable to a well in a prorated or spaced field

If the intended well is in a prorated or spaced field, please fully complete this side of the form. If the intended well is in a prorated or spaced field complete the plat below showing that the well will be properly located in relationship to other wells producing from the common source of supply. Please show all the wells and within 1 mile of the boundaries of the proposed acreage attribution unit for gas wells and within 1/2 mile of the boundaries of the proposed acreage attribution unit for oil wells.

API No. 15 - 167-23472-0000
 Operator: Mai Oil Operations, Inc.
 Lease: Brungardt
 Well Number: 1
 Field: Wildcat

Number of Acres attributable to well: _____
 QTR/QTR/QTR/QTR of acreage: SW - NE - NW - _____

Location of Well: County: Russell
 1,018 feet from N / S Line of Section
 1,632 feet from E / W Line of Section
 Sec. 27 Twp. 15 S. R. 14 E W

Is Section: Regular or Irregular

If Section is Irregular, locate well from nearest corner boundary.

Section corner used: NE NW SE SW

PLAT

(Show location of the well and shade attributable acreage for prorated or spaced wells.)

(Show footage to the nearest lease or unit boundary line.)

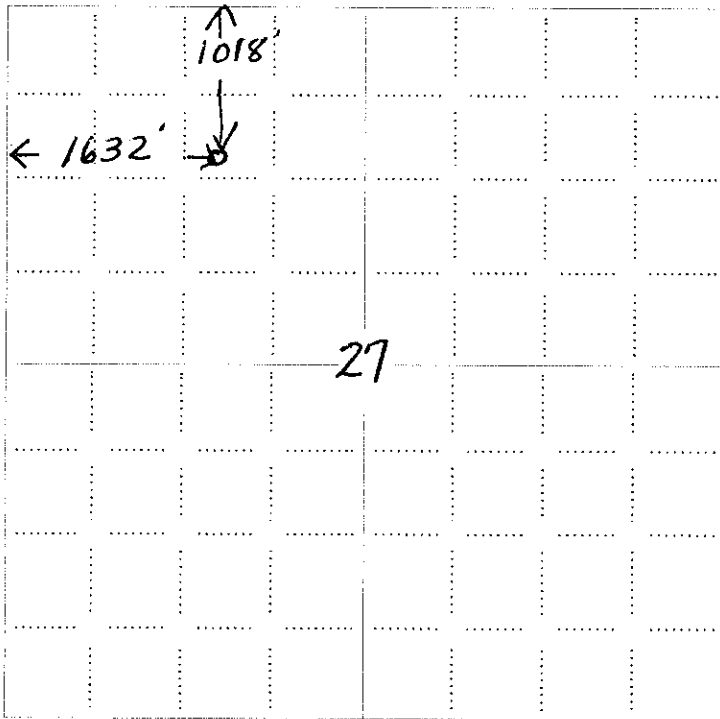

RECEIVED
NOV 13 2007
KCC WICHITA

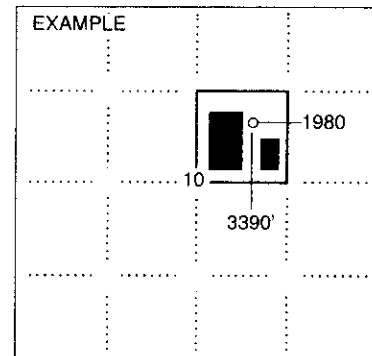

SEWARD CO.

NOTE: In all cases locate the spot of the proposed drilling location.

In plotting the proposed location of the well, you must show:

1. The manner in which you are using the depicted plat by identifying section lines, i.e. 1 section, 1 section with 8 surrounding sections, 4 sections, etc.
2. The distance of the proposed drilling location from the south / north and east / west outside section lines.
3. The distance to the nearest lease or unit boundary line (in footage).
4. If proposed location is located within a prorated or spaced field a certificate of acreage attribution plat must be attached: (CO-7 for oil wells; CG-8 for gas wells).

**KANSAS CORPORATION COMMISSION
OIL & GAS CONSERVATION DIVISION
APPLICATION FOR SURFACE PIT**

Form CDP-1
April 2004
Form must be Typed

Submit in Duplicate

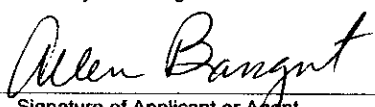
Operator Name: Mai Oil Operations, Inc.		License Number: 5259
Operator Address: P.O. Box 33		Russell, Ks. Ks. 67665
Contact Person: Allen Bangert		Phone Number: 785-483-2169
Lease Name & Well No.: Brungardt 1		Pit Location (QQQQ): SW NE NW
Type of Pit: <input type="checkbox"/> Emergency Pit <input type="checkbox"/> Burn Pit <input type="checkbox"/> Settling Pit <input checked="" type="checkbox"/> Drilling Pit <input type="checkbox"/> Workover Pit <input type="checkbox"/> Haul-Off Pit <small>(If WP Supply API No. or Year Drilled)</small>		Pit is: <input checked="" type="checkbox"/> Proposed <input type="checkbox"/> Existing If Existing, date constructed: _____ Pit capacity: 500 (bbls)
Is the pit located in a Sensitive Ground Water Area? <input type="checkbox"/> Yes <input checked="" type="checkbox"/> No		Sec. 27 Twp. 15 R. 14 <input type="checkbox"/> East <input checked="" type="checkbox"/> West 1,018 Feet from <input checked="" type="checkbox"/> North / <input type="checkbox"/> South Line of Section 1,632 Feet from <input type="checkbox"/> East / <input checked="" type="checkbox"/> West Line of Section Russell County
Is the bottom below ground level? <input checked="" type="checkbox"/> Yes <input type="checkbox"/> No		Chloride concentration: _____ mg/l <small>(For Emergency Pits and Settling Pits only)</small>
Artificial Liner? <input type="checkbox"/> Yes <input checked="" type="checkbox"/> No		How is the pit lined if a plastic liner is not used? Drilling Mud
Pit dimensions (all but working pits): 75 Length (feet) 75 Width (feet) <input type="checkbox"/> N/A: Steel Pits Depth from ground level to deepest point: 3 (feet) <input type="checkbox"/> No Pit		
If the pit is lined give a brief description of the liner material, thickness and installation procedure.		Describe procedures for periodic maintenance and determining liner integrity, including any special monitoring. <div style="text-align: right; font-weight: bold; font-size: 1.2em;"> RECEIVED NOV 13 2007 KCC WICHITA </div>
Distance to nearest water well within one-mile of pit 3827 feet Depth of water well 180 feet		Depth to shallowest fresh water 150 feet. Source of information: <input type="checkbox"/> measured <input type="checkbox"/> well owner <input type="checkbox"/> electric log <input checked="" type="checkbox"/> KDWR
Emergency, Settling and Burn Pits ONLY: Producing Formation: _____ Number of producing wells on lease: _____ Barrels of fluid produced daily: _____ Does the slope from the tank battery allow all spilled fluids to flow into the pit? <input type="checkbox"/> Yes <input type="checkbox"/> No		Drilling, Workover and Haul-Off Pits ONLY: Type of material utilized in drilling/workover: Drilling Mud Number of working pits to be utilized: 3 Abandonment procedure: Let Dry and Backfill Drill pits must be closed within 365 days of spud date.
I hereby certify that the above statements are true and correct to the best of my knowledge and belief.		
_____ 11-08-07 Date		 Signature of Applicant or Agent
KCC OFFICE USE ONLY		
Steel Pit <input type="checkbox"/> RFAC <input type="checkbox"/> RFAS <input type="checkbox"/>		
Date Received: 11/13/07 Permit Number: _____ Permit Date: 11/13/07 Lease Inspection: <input type="checkbox"/> Yes <input checked="" type="checkbox"/> No		

15-107-23472-0000

Mail to: KCC - Conservation Division, 130 S. Market - Room 2078, Wichita, Kansas 67202