

For KCC Use: 11-21-07  
Effective Date: \_\_\_\_\_  
District # 1  
SGA?  Yes  No

KANSAS CORPORATION COMMISSION  
OIL & GAS CONSERVATION DIVISION

Form C-1  
October 2007  
Form must be Typed  
Form must be Signed  
All blanks must be Filled

NOTICE OF INTENT TO DRILL

Must be approved by KCC five (5) days prior to commencing well

Expected Spud Date: November 22 2007  
month day year

OPERATOR: License# 31093  
Name: Becker Oil Corporation  
Address 1: P. O. Box 1150  
Address 2: \_\_\_\_\_  
City: Ponca City State: OK Zip: 74602  
Contact Person: Clyde M. Becker, Jr.  
Phone: 303-816-2013

CONTRACTOR: License# 33549  
Name: Landmark Drilling, LLC

Well Drilled For:  Oil  Gas  Enh Rec  Storage  Disposal  Seismic; # of Holes \_\_\_\_\_  Other: \_\_\_\_\_  
Well Class:  Infield  Pool Ext.  Wildcat  Other  
Type Equipment:  Mud Rotary  Air Rotary  Cable

If OWWO: old well information as follows:  
Operator: \_\_\_\_\_  
Well Name: \_\_\_\_\_  
Original Completion Date: \_\_\_\_\_ Original Total Depth: \_\_\_\_\_

Directional, Deviated or Horizontal wellbore?  Yes  No  
If Yes, true vertical depth: \_\_\_\_\_  
Bottom Hole Location: \_\_\_\_\_  
KCC DKT #: \_\_\_\_\_

Spot Description: \_\_\_\_\_  
\_\_\_\_\_ SE NE Sec. 30 Twp. 23 S. R. 22  E  W  
(000/000) 1,860 feet from  N /  S Line of Section  
660 feet from  E /  W Line of Section

Is SECTION:  Regular  Irregular?  
(Note: Locate well on the Section Plat on reverse side)

County: Hodgeman  
Lease Name: Burke Well #: 1  
Field Name: Lippoldt Southeast

Is this a Prorated / Spaced Field?  Yes  No  
Target Formation(s): Chase Group  
Nearest Lease or unit boundary line (in footage): 1860'

Ground Surface Elevation: 2378' feet MSL  
Water well within one-quarter mile:  Yes  No  
Public water supply well within one mile:  Yes  No

Depth to bottom of fresh water: 250'  
Depth to bottom of usable water: 570' 6.50  
Surface Pipe by Alternate:  I  II  
Length of Surface Pipe Planned to be set: 570' 270' per operator 11-15-07  
Length of Conductor Pipe (if any): N/A  
Projected Total Depth: 2750'  
Formation at Total Depth: Wreford

Water Source for Drilling Operations:  
 Well  Farm Pond  Other: \_\_\_\_\_  
DWR Permit #: \_\_\_\_\_

(Note: Apply for Permit with DWR )  
Will Cores be taken?  Yes  No  
If Yes, proposed zone: \_\_\_\_\_

AFFIDAVIT

RECEIVED  
KANSAS CORPORATION COMMISSION

NOV 15 2007

CONSERVATION DIVISION  
WICHITA, KS

The undersigned hereby affirms that the drilling, completion and eventual plugging of this well will comply with K.S.A. 55 et. seq.  
It is agreed that the following minimum requirements will be met:

1. Notify the appropriate district office **prior** to spudding of well;
2. A copy of the approved notice of intent to drill **shall be** posted on each drilling rig;
3. The minimum amount of surface pipe as specified below **shall be set** by circulating cement to the top; in all cases surface pipe **shall be set** through all unconsolidated materials plus a minimum of 20 feet into the underlying formation.
4. If the well is dry hole, an agreement between the operator and the district office on plug length and placement is necessary **prior to plugging**;
5. The appropriate district office will be notified before well is either plugged or production casing is cemented in;
6. If an ALTERNATE II COMPLETION, production pipe shall be cemented from below any usable water to surface within **120 DAYS** of spud date.  
Or pursuant to Appendix "B" - Eastern Kansas surface casing order #133,891-C, which applies to the KCC District 3 area, alternate II cementing must be completed within 30 days of the spud date or the well shall be plugged. **In all cases, NOTIFY district office** prior to any cementing.

I hereby certify that the statements made herein are true and correct to the best of my knowledge and belief.

Date: Nov 8, 2007 Signature of Operator or Agent: Clyde M Becker Jr Title: President

**For KCC Use ONLY**  
API # 15 - 083-21540-0000  
Conductor pipe required None feet  
Minimum surface pipe required 270 feet per ALT.  I  II  
Approved by: Auth 11-16-07  
This authorization expires: 11-16-08  
(This authorization void if drilling not started within 12 months of approval date.)  
Spud date: \_\_\_\_\_ Agent: \_\_\_\_\_

**Remember to:**  
- File Drill Pit Application (form GDP-1) with Intent to Drill;  
- File Completion Form ACO-1 within 120 days of spud date;  
- File acreage attribution plat according to field proration orders;  
- Notify appropriate district office 48 hours prior to workover or re-entry;  
- Submit plugging report (CP-4) after plugging is completed (within 60 days);  
- Obtain written approval before disposing or injecting salt water.  
- If this permit has expired (See: authorized expiration date) please check the box below and return to the address below.  
 Well Not Drilled - Permit Expired Date: \_\_\_\_\_  
Signature of Operator or Agent: \_\_\_\_\_

30  
23  
22  
 E  
 W

**IN ALL CASES PLOT THE INTENDED WELL ON THE PLAT BELOW**

*Plat of acreage attributable to a well in a prorated or spaced field*

**If the intended well is in a prorated or spaced field, please fully complete this side of the form.** If the intended well is in a prorated or spaced field complete the plat below showing that the well will be properly located in relationship to other wells producing from the common source of supply. Please show all the wells and within 1 mile of the boundaries of the proposed acreage attribution unit for gas wells and within 1/2 mile of the boundaries of the proposed acreage attribution unit for oil wells.

API No. 15 - 083-21540-0000  
 Operator: Becker Oil Corporation  
 Lease: Burke  
 Well Number: 1  
 Field: Lippoldt Southeast

Location of Well: County: Hodgeman  
1,860 feet from  N /  S Line of Section  
660 feet from  E /  W Line of Section  
 Sec. 30 Twp. 23 S. R. 22  E  W

Number of Acres attributable to well: \_\_\_\_\_  
 QTR/QTR/QTR/QTR of acreage: \_\_\_\_\_ - \_\_\_\_\_ - SE - NE

Is Section:  Regular or  Irregular

**If Section is Irregular, locate well from nearest corner boundary.**

Section corner used:  NE  NW  SE  SW

**PLAT**

*(Show location of the well and shade attributable acreage for prorated or spaced wells.)*

*(Show footage to the nearest lease or unit boundary line.)*

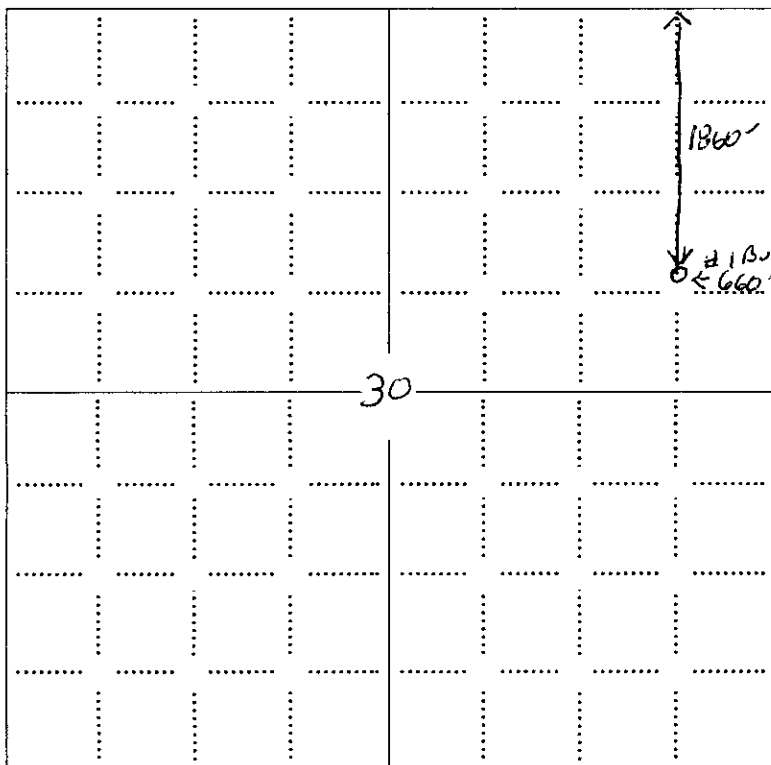

RECEIVED  
 KANSAS CORPORATION COMMISSION

NOV 15 2007

CONSERVATION DIVISION  
 WICHITA, KS

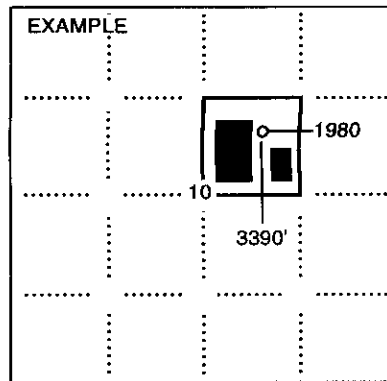

**NOTE: In all cases locate the spot of the proposed drilling location.**

**In plotting the proposed location of the well, you must show:**

1. The manner in which you are using the depicted plat by identifying section lines, i.e. 1 section, 1 section with 8 surrounding sections, 4 sections, etc.
2. The distance of the proposed drilling location from the south / north and east / west outside section lines.
3. The distance to the nearest lease or unit boundary line (in footage).
4. If proposed location is located within a prorated or spaced field a certificate of acreage attribution plat must be attached (CO-7 for oil wells)

**KANSAS CORPORATION COMMISSION  
OIL & GAS CONSERVATION DIVISION  
APPLICATION FOR SURFACE PIT**

Form CDP-1  
April 2004  
Form must be Typed

*Submit in Duplicate*

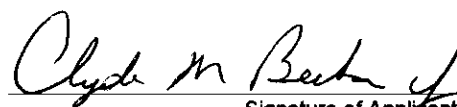
|   |  |   |  |
|---|--|---|--|
| Operator Name: <b>Becker Oil Corporation</b>  |  | License Number: <b>31093</b>  |  |
| Operator Address: <b>P. O. Box 1150</b>   |  | <b>Ponca City OK 74602</b>  |  |
| Contact Person: <b>Clyde M. Becker, Jr.</b>   |  | Phone Number: <b>303-816-2013</b>   |  |
| Lease Name & Well No.: <b>Burke 1</b>   |  | Pit Location (QQQQ):<br><b>SE NE/4</b>  |  |
| Type of Pit:<br><input type="checkbox"/> Emergency Pit <input type="checkbox"/> Burn Pit<br><input type="checkbox"/> Settling Pit <input checked="" type="checkbox"/> Drilling Pit<br><input type="checkbox"/> Workover Pit <input type="checkbox"/> Haul-Off Pit<br><i>(If WP Supply API No. or Year Drilled)</i>  |  | Pit is:<br><input checked="" type="checkbox"/> Proposed <input type="checkbox"/> Existing<br>If Existing, date constructed: _____<br>Pit capacity:<br><b>1,800</b> (bbbls)  |  |
| Is the pit located in a Sensitive Ground Water Area? <input type="checkbox"/> Yes <input checked="" type="checkbox"/> No  |  | Chloride concentration: _____ mg/l<br><i>(For Emergency Pits and Settling Pits only)</i>  |  |
| Is the bottom below ground level?<br><input checked="" type="checkbox"/> Yes <input type="checkbox"/> No  |  | Artificial Liner?<br><input type="checkbox"/> Yes <input checked="" type="checkbox"/> No  |  |
| How is the pit lined if a plastic liner is not used?  |  | Sec. <b>30</b> Twp. <b>23</b> R. <b>22</b> <input type="checkbox"/> East <input checked="" type="checkbox"/> West<br><b>1,860</b> Feet from <input checked="" type="checkbox"/> North / <input type="checkbox"/> South Line of Section<br><b>660</b> Feet from <input checked="" type="checkbox"/> East / <input type="checkbox"/> West Line of Section<br><b>Hodgeman</b> County |  |
| Pit dimensions (all but working pits): <b>60</b> Length (feet) <b>60</b> Width (feet) <input type="checkbox"/> N/A: Steel Pits<br>Depth from ground level to deepest point: <b>3</b> (feet) <input type="checkbox"/> No Pit   |  |   |  |
| If the pit is lined give a brief description of the liner material, thickness and installation procedure.   |  | Describe procedures for periodic maintenance and determining liner integrity, including any special monitoring.   |  |
| Distance to nearest water well within one-mile of pit<br><b>3880'</b> feet    Depth of water well <b>225</b> feet   |  | Depth to shallowest fresh water <b>50</b> feet.<br>Source of information:<br><input type="checkbox"/> measured <input type="checkbox"/> well owner <input type="checkbox"/> electric log <input checked="" type="checkbox"/> KDWR   |  |
| <b>Emergency, Settling and Burn Pits ONLY:</b><br>Producing Formation: _____<br>Number of producing wells on lease: _____<br>Barrels of fluid produced daily: _____<br>Does the slope from the tank battery allow all spilled fluids to flow into the pit? <input type="checkbox"/> Yes <input type="checkbox"/> No |  | <b>Drilling, Workover and Haul-Off Pits ONLY:</b><br>Type of material utilized in drilling/workover: <u>Starch Mud</u><br>Number of working pits to be utilized: <u>Steel-2</u><br>Abandonment procedure: <u>Allow to Evaporate, backfill replace top soil</u><br>Drill pits must be closed within 365 days of spud date.   |  |
| I hereby certify that the above statements are true and correct to the best of my knowledge and belief.   |  | RECEIVED<br>KANSAS CORPORATION COMMISSION   |  |
| Nov 8, 2007<br>Date   |  | <br>Signature of Applicant or Agent   |  |
|   |  | NOV 15 2007<br>CONSERVATION DIVISION<br>WICHITA, KS   |  |

15083-21540-0000

|                                |                      |                                    |   |                               |
|--------------------------------|----------------------|------------------------------------|---|-------------------------------|
| <b>KCC OFFICE USE ONLY</b>     |                      | Steel Pit <input type="checkbox"/> | RFAC <input type="checkbox"/>   | RFAS <input type="checkbox"/> |
| Date Received: <u>11/15/07</u> | Permit Number: _____ | Permit Date: <u>11/15/07</u>       | Lease Inspection: <input type="checkbox"/> Yes <input checked="" type="checkbox"/> No |                               |