



For KCC Use:
 Effective Date: 11/21/2007
 District # 1
 SGA? Yes No

KANSAS CORPORATION COMMISSION 1014126
 OIL & GAS CONSERVATION DIVISION

Form C-1
 October 2007

Form must be Typed
 Form must be Signed
 All blanks must be Filled

NOTICE OF INTENT TO DRILL

Must be approved by KCC five (5) days prior to commencing well

Expected Spud Date: 11/16/2007
 month day year

OPERATOR: License# 5278
 Name: EOG Resources, Inc.
 Address 1: 3817 NW EXPRESSWAY STE 500
 Address 2:
 City: OKLAHOMA CITY State: OK Zip: 73112 + 1483
 Contact Person: Melissa Sturm
 Phone: 405-246-3234

CONTRACTOR: License# 34000
 Name: Kenai Mid-Continent, Inc.

Well Drilled For:	Well Class:	Type Equipment:
<input type="checkbox"/> Oil	<input type="checkbox"/> Enh Rec	<input type="checkbox"/> infield
<input checked="" type="checkbox"/> Gas	<input type="checkbox"/> Storage	<input type="checkbox"/> Pool Ext.
<input type="checkbox"/> Seismic : # of Holes	<input type="checkbox"/> Disposal	<input checked="" type="checkbox"/> Wildcat
<input type="checkbox"/> Other:	<input type="checkbox"/> Other	<input checked="" type="checkbox"/> Mud Rotary
		<input type="checkbox"/> Air Rotary
		<input type="checkbox"/> Cable

If OWWO: old well information as follows:

Operator:
 Well Name:
 Original Completion Date: Original Total Depth:

Directional, Deviated or Horizontal wellbore? Yes No

If Yes, true vertical depth:

Bottom Hole Location:

KCC DKT #:

PRORATED & SPACED: HUGOTON-PANOMA

Spot Description:
 NE NE SW NE Sec. 18 Twp. 31 S. R. 36 E W
 (0:0-0-0) 1,460 feet from N / S Line of Section
 1,470 feet from E / W Line of Section

Is SECTION: Regular Irregular?

(Note: Locate well on the Section Plat on reverse side)

County: Stevens

Lease Name: Loewen-Fisher Well #: 18 #1

Field Name: Wildcat

Is this a Prorated / Spaced Field? Yes No

Target Formation(s): Morrow

Nearest Lease or unit boundary line (in footage): 1460

Ground Surface Elevation: 3033 feet MSL

Water well within one-quarter mile: Yes No

Public water supply well within one mile: Yes No

Depth to bottom of fresh water: 440

Depth to bottom of usable water: 540

Surface Pipe by Alternate: I II

Length of Surface Pipe Planned to be set: 1700

Length of Conductor Pipe (if any): 40

Projected Total Depth: 6250

Formation at Total Depth: St. Louis

Water Source for Drilling Operations:

Well Farm Pond Other:

DWR Permit #:

(Note: Apply for Permit with DWR)

Will Cores be taken? Yes No

If Yes, proposed zone:

AFFIDAVIT

The undersigned hereby affirms that the drilling, completion and eventual plugging of this well will comply with K.S.A. 55 et. seq.

It is agreed that the following minimum requirements will be met:

1. Notify the appropriate district office **prior** to spudding of well;
2. A copy of the approved notice of intent to drill **shall be** posted on each drilling rig;
3. The minimum amount of surface pipe as specified below **shall be set** by circulating cement to the top; in all cases surface pipe **shall be set** through all unconsolidated materials plus a minimum of 20 feet into the underlying formation.
4. If the well is dry hole, an agreement between the operator and the district office on plug length and placement is necessary **prior to plugging**;
5. The appropriate district office will be notified before well is either plugged or production casing is cemented in;
6. If an ALTERNATE II COMPLETION, production pipe shall be cemented from below any usable water to surface within **120 DAYS** of spud date.
 Or pursuant to Appendix "B" - Eastern Kansas surface casing order #133,891-C, which applies to the KCC District 3 area, alternate II cementing must be completed within 30 days of the spud date or the well shall be plugged. **In all cases, NOTIFY district office** prior to any cementing.

Submitted Electronically

For KCC Use ONLY
 API # 15- 15-189-22628-00-00
 Conductor pipe required 0 feet
 Minimum surface pipe required 560 feet per ALT I II
 Approved by: Rick Hestermann 11/16/2007
 This authorization expires: 11/16/2008
 (This authorization void if drilling not started within 12 months of approval date.)
 Spud date: Agent:

Remember to:

- File Drill Pit Application (form CDP-1) with Intent to Drill;
- File Completion Form ACO-1 within 120 days of spud date;
- File acreage attribution plat according to field proration orders;
- Notify appropriate district office 48 hours prior to workover or re-entry;
- Submit plugging report (CP-4) after plugging is completed (within 60 days);
- Obtain written approval before disposing or injecting salt water.
- If this permit has expired (See: authorized expiration date) please check the box below and return to the address below.

Well Not Drilled - Permit Expired Date: Signature of Operator or Agent:

18 31 36 E W



1014126

IN ALL CASES PLOT THE INTENDED WELL ON THE PLAT BELOW

Plat of acreage attributable to a well in a prorated or spaced field

If the intended well is in a prorated or spaced field, please fully complete this side of the form. If the intended well is in a prorated or spaced field complete the plat below showing that the well will be properly located in relationship to other wells producing from the common source of supply. Please show all the wells and within 1 mile of the boundaries of the proposed acreage attribution unit for gas wells and within 1/2 mile of the boundaries of the proposed acreage attribution unit for oil wells.

API No. 15 - 15-189-22628-00-00

Operator: EOG Resources, Inc.

Lease: Loewen-Fisher

Well Number: 18 #1

Field: Wildcat

Number of Acres attributable to well: _____

QTR/QTR/QTR/QTR of acreage: NE - NE - SW - NE

Location of Well: County: Stevens

1,460 feet from N / S Line of Section

1,470 feet from E / W Line of Section

Sec. 18 Twp. 31 S. R. 36 E W

Is Section: Regular or Irregular

If Section is Irregular, locate well from nearest corner boundary.

Section corner used: NE NW SE SW

PLAT

(Show location of the well and shade attributable acreage for prorated or spaced wells.)

(Show footage to the nearest lease or unit boundary line.)

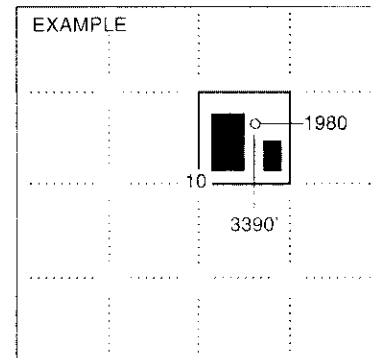
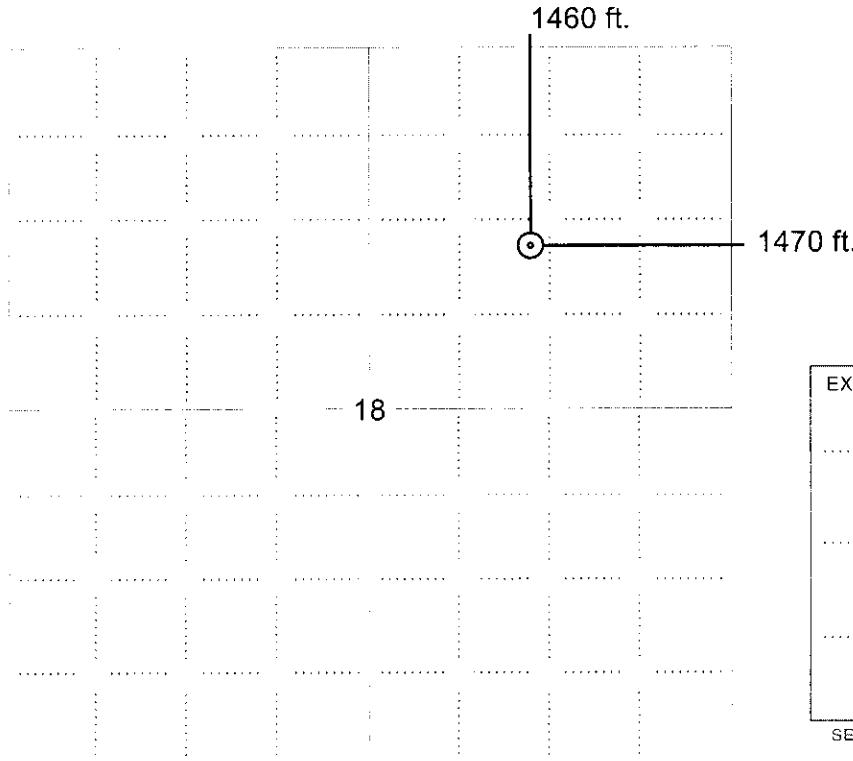

SEWARD CO.

NOTE: In all cases locate the spot of the proposed drilling location.

In plotting the proposed location of the well, you must show:

1. The manner in which you are using the depicted plat by identifying section lines, i.e. 1 section, 1 section with 8 surrounding sections, 4 sections, etc.
2. The distance of the proposed drilling location from the south / north and east / west outside section lines.
3. The distance to the nearest lease or unit boundary line (in footage).
4. If proposed location is located within a prorated or spaced field a certificate of acreage attribution plat must be attached: (CO-7 for oil wells; CG-8 for gas wells).



KANSAS CORPORATION COMMISSION 1014126
OIL & GAS CONSERVATION DIVISION

Form CDP-1
April 2004
Form must be Typed

APPLICATION FOR SURFACE PIT

Submit in Duplicate

Operator Name: EOG Resources, Inc.		License Number: 5278
Operator Address: 3817 NW EXPRESSWAY STE 500		OKLAHOMA CITY OK 73112
Contact Person: Melissa Sturm		Phone Number: 405-246-3234
Lease Name & Well No.: Loewen-Fisher 18 #1		Pit Location (QQQQ):
Type of Pit: <input type="checkbox"/> Emergency Pit <input type="checkbox"/> Burn Pit <input type="checkbox"/> Settling Pit <input type="checkbox"/> Drilling Pit <input type="checkbox"/> Workover Pit <input type="checkbox"/> Haul-Off Pit <small>(If WP Supply API No. or Year Drilled)</small>		Pit is: <input type="checkbox"/> Proposed <input type="checkbox"/> Existing If Existing, date constructed: _____ Pit capacity: _____ (bbls)
Is the pit located in a Sensitive Ground Water Area? <input type="checkbox"/> Yes <input checked="" type="checkbox"/> No		Sec. 18 Twp. 31 R. 36 <input type="checkbox"/> East <input checked="" type="checkbox"/> West _____ Feet from <input type="checkbox"/> North / <input type="checkbox"/> South Line of Section _____ Feet from <input type="checkbox"/> East / <input type="checkbox"/> West Line of Section Stevens _____ County
Is the bottom below ground level? <input type="checkbox"/> Yes <input type="checkbox"/> No		Chloride concentration: _____ mg/l <small>(For Emergency Pits and Settling Pits only)</small>
Artificial Liner? <input type="checkbox"/> Yes <input type="checkbox"/> No		How is the pit lined if a plastic liner is not used? Haul-off pit - soil compaction
Pit dimensions (all but working pits): _____ Length (feet) _____ Width (feet) <input checked="" type="checkbox"/> N/A: Steel Pits Depth from ground level to deepest point: _____ (feet) <input type="checkbox"/> No Pit		
If the pit is lined give a brief description of the liner material, thickness and installation procedure. Haul-off pit - soil compaction		Describe procedures for periodic maintenance and determining liner integrity, including any special monitoring. Haul-off pit - soil compaction
Distance to nearest water well within one-mile of pit _____ feet Depth of water well _____ feet		Depth to shallowest fresh water _____ feet. Source of information: <input type="checkbox"/> measured <input type="checkbox"/> well owner <input type="checkbox"/> electric log <input type="checkbox"/> KDWR
Emergency, Settling and Burn Pits ONLY: Producing Formation: _____ Number of producing wells on lease: _____ Barrels of fluid produced daily: _____ Does the slope from the tank battery allow all spilled fluids to flow into the pit? <input type="checkbox"/> Yes <input type="checkbox"/> No		Drilling, Workover and Haul-Off Pits ONLY: Type of material utilized in drilling/workover: _____ Number of working pits to be utilized: _____ Abandonment procedure: _____ Drill pits must be closed within 365 days of spud date.
Submitted Electronically		

KCC OFFICE USE ONLY		Steel Pit <input checked="" type="checkbox"/>	RFAC <input checked="" type="checkbox"/>	RFAS <input type="checkbox"/>
Date Received: 11/14/2007	Permit Number: 15-189-22628-00-00	Permit Date: 11/15/2007	Lease Inspection: <input checked="" type="checkbox"/> Yes <input type="checkbox"/> No	

Mail to: KCC - Conservation Division, 130 S. Market - Room 2078, Wichita, Kansas 67202

Offsite Pit Permission

To Whom it may concern:

I Jace K Loewen do hereby give EOG Resources
Surface owner

Permission to take drilling fluids from the Loewen-Fisher 18-1, to
Well name

a reserve pit in the SE, NE Sec 18-31S-36W Stevans Co
1270' FNL 200' FEL Legal description

Stevans County, Kansas State

Lat: 37.35530 Long: 101.26784

Jace K Loewen Surface owner
11-11-09 Date



*Kathleen Sebelius, Governor
Thomas E. Wright, Chairman
Michael C. Moffet, Commissioner
Joseph F. Harkins, Commissioner*

November 15, 2007

Ms. Melissa Sturm
EOG Resources, Inc.
3817 NW Expressway Ste 500
Oklahoma City, OK 73112

Re: Haul-Off Pit Application
Loewen-Fisher Lease Well No. 18 #1
NE/4 Sec. 18-31S-36W
Stevens County, Kansas

Dear Ms. Sturm:

District staff has inspected the above referenced location and has determined that the haul-off pit shall be constructed **without slots**, the bottom shall be flat and reasonably level, and the free fluids must be removed. The fluids are to be removed from the haul-off pit after drilling operations have ceased.

If production casing is set all completion fluids shall be removed from the working pits daily. NO completion fluids or non-exempt wastes shall be placed in the reserve pit.

The fluids should be taken to an authorized disposal well. Please call the District Office at (620) 225-8888 when the fluids have been removed. Please file form CDP-5, Exploration and Production Waste Transfer, within 30 days of fluid removal. Conservation division forms are available through our office and on the KCC web site: www.kcc.state.ks.us/conservation/forms.

A copy of this letter should be posted in the doghouse along with the approved Intent to Drill. If you have any questions or concerns please feel free to contact the undersigned at the above address.

Sincerely,

Kathy Haynes
Environmental Protection and Remediation Department

cc: S Durrant