



For KCC Use:
 Effective Date: 11/26/2007
 District # 4
 SGA? Yes No

KANSAS CORPORATION COMMISSION 1014101
 OIL & GAS CONSERVATION DIVISION

Form C-1
 October 2007

Form must be Typed
 Form must be Signed
 All blanks must be Filled

NOTICE OF INTENT TO DRILL

Must be approved by KCC five (5) days prior to commencing well

Expected Spud Date: 12/15/2007
 month day year

OPERATOR: License# 5086
 Name: Pintail Petroleum, Ltd.
 Address 1: 225 N MARKET STE 300
 Address 2:
 City: WICHITA State: KS Zip: 67202 + 2024
 Contact Person: Flip Phillips
 Phone: 316-263-2243

CONTRACTOR: License# 33493
 Name: American Eagle Drilling LLC

Well Drilled For: Oil Gas Seismic Other:
 Well Class: Enh Rec Storage Disposal # of Holes
 Type Equipment: Mud Rotary Air Rotary Cable Infield Pool Ext. Wildcat Other
 If OWWO: old well information as follows:

Operator:
 Well Name:
 Original Completion Date: Original Total Depth:

Directional, Deviated or Horizontal wellbore? Yes No
 If Yes, true vertical depth:
 Bottom Hole Location:
 KCC DKT #:

Spot Description:
 NE NW SE NW Sec. 30 Twp. 14 S. R. 21 E W
 (a-a-0-0) 1,350 feet from N / S Line of Section
 1,680 feet from E / W Line of Section

Is SECTION: Regular Irregular?

(Note: Locate well on the Section Plat on reverse side)

County: Trego
 Lease Name: Schmidt 'RP' Well #: 6-30
 Field Name: Butterfield Trail

Is this a Prorated / Spaced Field? Yes No
 Target Formation(s): Mississippi

Nearest Lease or unit boundary line (in footage): 960

Ground Surface Elevation: 2087 feet MSL

Water well within one-quarter mile: Yes No

Public water supply well within one mile: Yes No

Depth to bottom of fresh water: 100

Depth to bottom of usable water: 600

Surface Pipe by Alternate: I II

Length of Surface Pipe Planned to be set: 200

Length of Conductor Pipe (if any):

Projected Total Depth: 4300

Formation at Total Depth: MISSISSIPPI

Water Source for Drilling Operations:

Well Farm Pond Other: HAULED

DWR Permit #: Hauled (Note: Apply for Permit with DWR)

Will Cores be taken? Yes No

If Yes, proposed zone:

AFFIDAVIT

The undersigned hereby affirms that the drilling, completion and eventual plugging of this well will comply with K.S.A. 55 et. seq.

It is agreed that the following minimum requirements will be met:

1. Notify the appropriate district office **prior** to spudding of well;
2. A copy of the approved notice of intent to drill **shall be** posted on each drilling rig;
3. The minimum amount of surface pipe as specified below **shall be set** by circulating cement to the top; in all cases surface pipe **shall be set** through all unconsolidated materials plus a minimum of 20 feet into the underlying formation.
4. If the well is dry hole, an agreement between the operator and the district office on plug length and placement is necessary **prior to plugging**;
5. The appropriate district office will be notified before well is either plugged or production casing is cemented in;
6. If an ALTERNATE II COMPLETION, production pipe shall be cemented from below any usable water to surface within **120 DAYS** of spud date. Or pursuant to Appendix "B" - Eastern Kansas surface casing order #133,891-C, which applies to the KCC District 3 area, alternate II cementing must be completed within 30 days of the spud date or the well shall be plugged. **In all cases, NOTIFY district office** prior to any cementing.

Submitted Electronically

For KCC Use ONLY
 API # 15 - 15-195-22518-00-00
 Conductor pipe required 0 feet
 Minimum surface pipe required 200 feet per ALT. I II
 Approved by: Walter Moody 11/21/2007
 This authorization expires: 11/21/2008
 (This authorization void if drilling not started within 12 months of approval date.)
 Spud date: Agent:

Remember to:

- File Drill Pit Application (form CDP-1) with Intent to Drill;
- File Completion Form ACO-1 within 120 days of spud date;
- File acreage attribution plat according to field proration orders;
- Notify appropriate district office 48 hours prior to workover or re-entry;
- Submit plugging report (CP-4) after plugging is completed (within 60 days);
- Obtain written approval before disposing or injecting salt water.
- If this permit has expired (See: authorized expiration date) please check the box below and return to the address below.

Well Not Drilled - Permit Expired Date: Signature of Operator or Agent:

Mail to: KCC - Conservation Division, 130 S. Market - Room 2078, Wichita, Kansas 67202

30 14 21 E W



1014101

IN ALL CASES PLOT THE INTENDED WELL ON THE PLAT BELOW

Plat of acreage attributable to a well in a prorated or spaced field

If the intended well is in a prorated or spaced field, please fully complete this side of the form. If the intended well is in a prorated or spaced field complete the plat below showing that the well will be properly located in relationship to other wells producing from the common source of supply. Please show all the wells and within 1 mile of the boundaries of the proposed acreage attribution unit for gas wells and within 1/2 mile of the boundaries of the proposed acreage attribution unit for oil wells.

API No. 15 - 15-195-22518-00-00
 Operator: Pintail Petroleum, Ltd.
 Lease: Schmidt 'RP'
 Well Number: 6-30
 Field: Butterfield Trail

Number of Acres attributable to well: _____
 QTR/QTR/QTR/QTR of acreage: NE - NW - SE - NW

Location of Well: County: Trego
 1,350 feet from N / S Line of Section
 1,680 feet from E / W Line of Section
 Sec. 30 Twp. 14 S. R. 21 E W

Is Section: Regular or Irregular

If Section is Irregular, locate well from nearest corner boundary.

Section corner used: NE NW SE SW

PLAT

(Show location of the well and shade attributable acreage for prorated or spaced wells.)

(Show footage to the nearest lease or unit boundary line.)

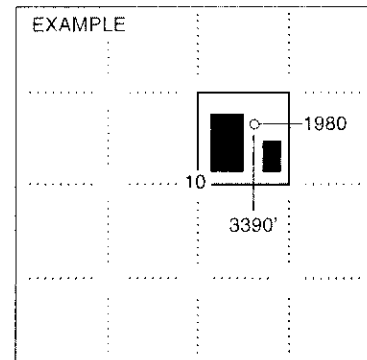
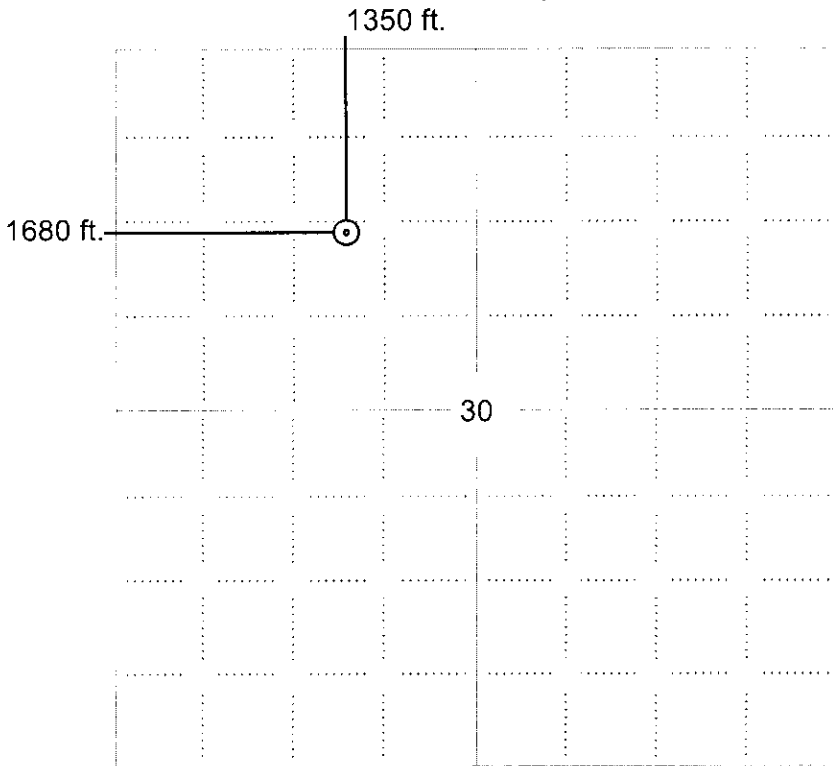

SEWARD CO.

NOTE: In all cases locate the spot of the proposed drilling locaton.

In plotting the proposed location of the well, you must show:

1. The manner in which you are using the depicted plat by identifying section lines, i.e. 1 section, 1 section with 8 surrounding sections, 4 sections, etc.
2. The distance of the proposed drilling location from the south / north and east / west outside section lines.
3. The distance to the nearest lease or unit boundary line (in footage).
4. If proposed location is located within a prorated or spaced field a certificate of acreage attribution plat must be attached: (CO-7 for oil wells; CG-8 for gas wells).



KANSAS CORPORATION COMMISSION 1014101
 OIL & GAS CONSERVATION DIVISION
APPLICATION FOR SURFACE PIT

Form CDP-1
 April 2004
 Form must be Typed

Submit in Duplicate

Operator Name: Pintail Petroleum, Ltd.		License Number: 5086	
Operator Address: 225 N MARKET STE 300		WICHITA KS 67202	
Contact Person: Flip Phillips		Phone Number: 316-263-2243	
Lease Name & Well No.: Schmidt 'RP' 6-30		Pit Location (QQQQ): NE - NW - SE - NW	
Type of Pit: <input type="checkbox"/> Emergency Pit <input type="checkbox"/> Burn Pit <input type="checkbox"/> Settling Pit <input checked="" type="checkbox"/> Drilling Pit <input type="checkbox"/> Workover Pit <input type="checkbox"/> Haul-Off Pit <small>(If WP Supply API No. or Year Drilled)</small>		Pit is: <input checked="" type="checkbox"/> Proposed <input type="checkbox"/> Existing If Existing, date constructed: _____ Pit capacity: 4,100 (bbls)	
Is the pit located in a Sensitive Ground Water Area? <input checked="" type="checkbox"/> Yes <input type="checkbox"/> No		Chloride concentration: _____ mg/l <small>(For Emergency Pits and Settling Pits only)</small>	
Is the bottom below ground level? <input checked="" type="checkbox"/> Yes <input type="checkbox"/> No		Artificial Liner? <input type="checkbox"/> Yes <input checked="" type="checkbox"/> No	
How is the pit lined if a plastic liner is not used? MUD AND BENTONITE			
Pit dimensions (all but working pits): _____ 80 _____ Length (feet) _____ 80 _____ Width (feet)		<input type="checkbox"/> N/A: Steel Pits	
Depth from ground level to deepest point: _____ 4 _____ (feet)		<input type="checkbox"/> No Pit	
if the pit is lined give a brief description of the liner material, thickness and installation procedure.		Describe procedures for periodic maintenance and determining liner integrity, including any special monitoring.	
Distance to nearest water well within one-mile of pit _____ 4314 _____ feet Depth of water well _____ 27 _____ feet		Depth to shallowest fresh water _____ 13 _____ feet. Source of information: <input type="checkbox"/> measured <input type="checkbox"/> well owner <input type="checkbox"/> electric log <input checked="" type="checkbox"/> KDWR	
Emergency, Settling and Burn Pits ONLY: Producing Formation: _____ Number of producing wells on lease: _____ Barrels of fluid produced daily: _____ Does the slope from the tank battery allow all spilled fluids to flow into the pit? <input type="checkbox"/> Yes <input type="checkbox"/> No		Drilling, Workover and Haul-Off Pits ONLY: Type of material utilized in drilling/workover: <u>Fresh water and drilling mud</u> Number of working pits to be utilized: _____ 3 _____ Abandonment procedure: <u>Evaporate and backfill</u> Drill pits must be closed within 365 days of spud date.	
Submitted Electronically			
KCC OFFICE USE ONLY			
Date Received: 11/19/2007		Permit Number: 15-195-22518-00-00	
Permit Date: 11/21/2007		Lease Inspection: <input checked="" type="checkbox"/> Yes <input type="checkbox"/> No	
Steel Pit <input type="checkbox"/>		RFAC <input checked="" type="checkbox"/> RFAS <input type="checkbox"/>	



*Kathleen Sebelius, Governor
Thomas E. Wright, Chairman
Michael C. Moffet, Commissioner
Joseph F. Harkins, Commissioner*

November 21, 2007

Flip Phillips
Pintail Petroleum, Ltd.
225 N MARKET STE 300
WICHITA, KS67202-2024

Re: Drilling Pit Application
Schmidt 'RP' Lease Well No. 6-30
NW/4 Sec.30-14S-21W
Trego County, Kansas

Dear Flip Phillips:

District staff has inspected the above referenced location and has determined that the reserve pit shall be constructed **without slots**, the bottom shall be flat and reasonably level, and the free fluids must be removed. The fluids are to be removed from the reserve pit as soon as practical after drilling operations have ceased.

If production casing is set all completion fluids shall be removed from the working pits daily. NO completion fluids or non-exempt wastes shall be placed in the reserve pit.

The fluids should be taken to an authorized disposal well. Please call the District Office at (785) 625-0550 when the fluids have been removed. Please file form CDP-5 (August 2004), Exploration and Production Waste Transfer, within 30 days of fluid removal. Conservation division forms are available through our office and on the KCC web site:
kcc.ks.gov/conservation/forms/

A copy of this letter should be posted in the doghouse along with the approved Intent to Drill. If you have any questions or concerns please feel free to contact the District Office at (785) 625-0550.