

15-163-00538-00-00

Give All Information Completely
Make Required Affidavit
Mail or Deliver Report to:
Conservation Division
State Corporation Commission
800 Bitting Building
Wichita, Kansas

WELL PLUGGING RECORD

NORTH

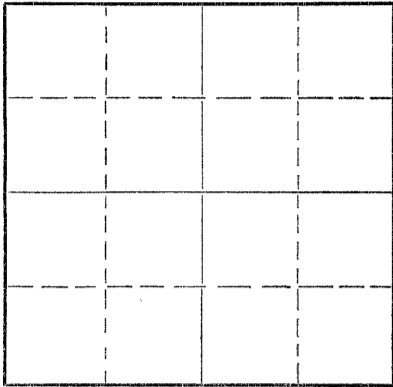

Locate well correctly on above Section Plat

Rooks County. Sec. 26 Twp. 8S Rge. (E)19 (W)
Location as "NE/CNW/SW" or footage from lines NE NE SW
Lease Owner Jones, Shelburne & Farmer, Inc.
Lease Name Veverka Well No. 1
Office Address Russell, Kansas
Character of Well (completed as Oil, Gas or Dry Hole) Dry
Date well completed 7-29 19 53
Application for plugging filed 7-29 19 53
Application for plugging approved 7-29 19 53
Plugging commenced 7-29 19 53
Plugging completed 7-29 19 53
Reason for abandonment of well or producing formation dry

If a producing well is abandoned, date of last production Never produced 19
Was permission obtained from the Conservation Division or its agents before plugging was commenced? yes

Name of Conservation Agent who supervised plugging of this well Elden Petty
Producing formation Depth to top Bottom Total Depth of Well 3548 Feet
Show depth and thickness of all water, oil and gas formations.

OIL, GAS OR WATER RECORDS

CASING RECORD

FORMATION	CONTENT	FROM	TO	SIZE	PUT IN	PULLED OUT
				8 5/8	165'	none

Describe in detail the manner in which the well was plugged, indicating where the mud fluid was placed and the method or methods used in introducing it into the hole. If cement or other plugs were used, state the character of same and depth placed, from feet to feet for each plug set.

1. Filled hole with heavy mud
2. Pushed plug to 160'
3. Dumped 1/2 sack hulls on top of plug
4. Mixed 15 sacks cement and dumped on top of hulls
5. Filled hole to top
6. Pushed plug to 40'
7. Dumped in 1/2 sack hulls
8. Mixed 10 sacks cement and filled hole to top with same

RECEIVED
STATE CORPORATION COMMISSION
AUG 2 1953
CONS. DIVISION
8/3/53

(If additional description is necessary, use BACK of this sheet)
Name of Plugging Contractor Jones, Shelburne & Farmer, Inc.
Address Russell, Kansas

STATE OF Kansas, COUNTY OF Russell, ss.
John O. Farmer (employee of owner) or (owner or operator) of the above-described well, being first duly sworn on oath, says: That I have knowledge of the facts, statements, and matters herein contained and the log of the above-described well as filed and that the same are true and correct. So help me God.
(Signature) John O. Farmer
Russell, Kansas (Address)

SUBSCRIBED AND SWORN to before me this 30th day of July, 19 53
Bonnie Berryhill
Notary Public.

My commission expires April 23, 1956

PLUGGING
FILE SEC 26 T 8 R 19W
BOOK PAGE 118 LINE 40

Form 1002A
 19 RGE
 8 TWP
 26 SEC
 1 COUNTY Rooks
 1 WELL NO. 1
 Ververka

KANSAS CORPORATION COMMISSION
 (Mail to Corporation Commission, Oklahoma City, Oklahoma)
OKLAHOMA CORPORATION COMMISSION

OIL AND GAS CONSERVATION DEPARTMENT

FORMATION RECORD

Give detailed description and thickness of all formations drilled through, contents of sand, whether dry, water, oil or gas.

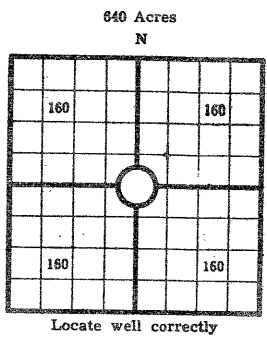

WELL RECORD
 COUNTY Rooks, SEC. 26, TWP. 8, RGE. 19
 COMPANY OPERATING Jones, Shelburne & Farmer, Inc.
 OFFICE ADDRESS Russell, Kansas
 FARM NAME Ververka WELL NO. 1
 DRILLING STARTED 7-19, 1953, DRILLING FINISHED 7-28, 1953
 DATE OF FIRST PRODUCTION _____ COMPLETED _____
 WELL LOCATED NE 1/4 NE 1/4 SW 1/4, North of South
 Line and _____ ft. East of West Line of Quarter Section
 Elevation (Relative to sea level) DERRICK FLOOR 1974 GROUND _____
 CHARACTER OF WELL (Oil, gas or dryhole) Dry

OIL OR GAS SANDS OR ZONES

Name	From	To	Name	From	To
1			4		
2			5		
3			6		

Perforating Record if Any

Formation	From	To	No. of Shots	Formation	From	To	Size of Shot

CASING RECORD

Size	Wt.	Amount Set		In.	Ft.	In.	Amount Pulled		Packer Record	
		Thds.	Mkts.				Size	Length	Depth Set	Make
8 5/8				152				none		

Liner Record: Amount _____ Kind _____ Top _____ Bottom _____

CEMENTING AND MUDDING

Size	Amount Set		Sacks Cement	Chemical		Method of Cementing	Amount	Mudding Method	Results (See Note)
	Ft.	In.		Gal.	Make				
8 5/8	152		100						

Note: What method was used to protect sands if outer strings were pulled? _____

NOTE: Were bottom hole plugs used? _____ If so, state kind, depth set and results obtained _____

TOOLS USED

Rotary Tools were used from _____ feet to _____ feet to _____ feet, and from _____ feet to _____ feet, and from _____ feet to _____ feet.

Cable tools were used from _____ feet to _____ feet.

Type Rig _____

INITIAL PRODUCTION TEST

Describe initial test: whether by flow through tubing or casing or by pumping _____

Amount of Oil _____ bbls Size of choke, if any _____ Length of test _____ Water Production _____

Gravity of oil _____ Type of Pump if pump is used, describe _____

Formation	Top	Bottom	Formation	Top	Bottom
Shale	0	190			
Shale & sand	190	1050			
Sand & shale	1050	1150			
Shale & redbed	1150	1380			
Shale	1380	1398			
Anhydrite	1398	1435			
Shale & shells	1435	2110			
Shale & lime	2110	2845			
Lime & shale	2845	3165			
Lime	3165	3205			
Shale	3205	3430			
Cong.	3430	3548			

TOPS:
 Elevation 1976 K. B.
 Heebner 3129
 Toronto 3152
 Lansing 3168
 Cong. 3430
 T. D. 3548

I, the undersigned, being first duly sworn upon oath, state that this well record is true, correct and complete according to the records of this office and to the best of my knowledge and belief.

John W. Farmer
 Name and title of representative of company
 Vice-President

Subscribed and sworn to before me this 30th day of July, 1953
 My Commission expires April 23, 1956
Bonnie Perryhill
 Notary Public