

STATE OF KANSAS  
STATE CORPORATION COMMISSION

Form CP-4

Give All Information Completely  
Make Required Affidavit  
Mail or Deliver Report to:  
Conservation Division  
State Corporation Commission  
211 No. Broadway  
Wichita, Kansas

WELL PLUGGING RECORD

NORTH

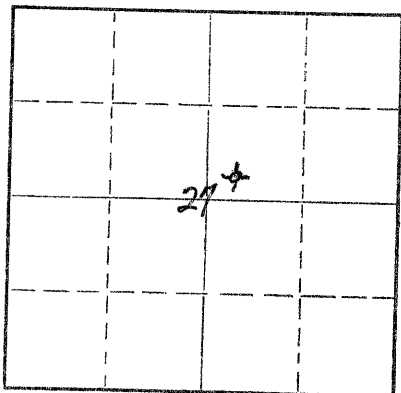

Locate well correctly on above  
Section Plat

Rooks \_\_\_\_\_ County. Sec. 27 Twp. 8 Rge. 19 (E) \_\_\_\_\_ (W) \_\_\_\_\_  
Location as "NE/CNW/SW" or footage from lines SW SW NE  
Lease Owner Rains & Williamson Oil Company  
Lease Name Jeffrey Well No. 1  
Office Address Wichita, Kansas  
Character of Well (completed as Oil, Gas or Dry Hole) \_\_\_\_\_  
Date well completed \_\_\_\_\_  
Application for plugging filed \_\_\_\_\_ 19\_\_\_\_  
Application for plugging approved \_\_\_\_\_ 19\_\_\_\_  
Plugging commenced 7/28/67 19\_\_\_\_  
Plugging completed 7/31/67 19\_\_\_\_  
Reason for abandonment of well or producing formation depleted. 19\_\_\_\_

If a producing well is abandoned, date of last production \_\_\_\_\_ 19\_\_\_\_  
Was permission obtained from the Conservation Division or its agents before plugging was commenced? yes

Name of Conservation Agent who supervised plugging of this well Massey  
Producing formation \_\_\_\_\_ Depth to top \_\_\_\_\_ Bottom \_\_\_\_\_ Total Depth of Well 3415 Feet  
Show depth and thickness of all water, oil and gas formations.

OIL, GAS OR WATER RECORDS

CASING RECORD

FORMATION	CONTENT	FROM	TO	SIZE	PUT IN	PULLED OUT
				8-5/8"	270	none
				5-1/2	3414	2817

Describe in detail the manner in which the well was plugged, indicating where the mud fluid was placed and the method or methods used in introducing it into the hole. If cement or other plugs were used, state the character of same and depth placed, from \_\_\_\_\_ feet to \_\_\_\_\_ feet for each plug set.

Checked hole and sanded hole to 3390'. Set 5 sacks of cement. Shot pipe at 2914', 2818' and worked pipe loose. Started pumping mud. Mud started circulating out of rat hole. Ran 750' of tubing, pumped 25 sacks of mud and pulled tubing to 600'. Pumped 100 sacks of cement, pulled tubing to 240'. Pumped 35 sacks of cement. Pulled tubing to 60', pumped 35 sacks of cement. Talled pipe.

PLUGGING COMPLETE.

RECEIVED  
STATE CORPORATION COMMISSION  
AUG 8 1967  
AUG 8 1967  
CONSERVATION DIVISION  
Wichita, Kansas

(If additional description is necessary, use BACK of this sheet)

Name of Plugging Contractor KNIGHT CASING PULLING COMPANY  
Address CHASE, KANSAS

STATE OF KANSAS COUNTY OF RICE, ss. NOEL J. KNIGHT

(employee of owner) or (owner or operator) of the above-described well, being first duly sworn on oath, says: That I have knowledge of the facts, statements, and matters herein contained and the log of the above-described well, as filed and that the same are true and correct. So help me God.

(Signature) Noel Knight  
CHASE, KANSAS  
(Address)

SUBSCRIBED AND SWORN TO before me this 2nd day of August, 1967

My commission expires February 15, 1971.

Margaret Meloder  
Notary Public.

ROTARY DRILLING LOG

Operator: Rains & Williamson Oil Co., Inc.  
#1 JEFFREY (OWWO)  
SW SW NE Sec. 27-8S-19W  
Rooks County, Kansas

Contractor: Rains & Williamson Oil Co., Inc.  
Commenced: 6-12-67  
Completed: 6-14-67

Remarks: Set 5 1/2" casing at 3414' (1' off bottom) with 125 sacks salt saturated common cement with salt flush ahead.

Formations:

Washdown  
Lime  
Rotary Total Depth

0'-3379'  
3379'-3415'  
3415'

RECEIVED  
STATE CORPORATION COMMISSION  
JUL 27 1967  
JUL 27 1967  
CONSERVATION DIVISION  
Wichita, Kansas

We certify the above log is true and correct to the best of our knowledge and belief.

RAINS & WILLIAMSON OIL CO., INC.

Wilson Rains  
Wilson Rains

Subscribed and sworn to before me, a Notary Public in and for the State of Kansas, County of Sedgwick, this 25 day of July, 1967.

Sherry Gish  
Sherry Gish Notary Public

My Commission Expires:  
June 30, 1971

ROTARY DRILLING LOG

Operator: Rains & Williamson Oil Co.	Contractor: Rains & Williamson Oil Co.
#1 Jeffrey	Commenced: 3-21-66
SW SW NE Sec. 27-8S-19W	Completed: 3-29-66
Rooks County, Kansas	Remarks: Set 270.60 of 8-5/8" surface pipe with 150 sacks of GL3.

FORMATIONS

Shale & Shells & Sand	680'
Shale & Hard Sand Streaks	855'
D. Sand	1035'
Sand	1085'
Shale	1362'
Anhydrite	1398'
Shale	1934'
Lime W/Shale	2181'
Ft. Riley Lime	2295'
Lime & Shale	2455'
Lime W/Shale	2655'
Lime & Shale	2945'
Lime W/Shale	3063'
Lime	3152'
Lime W/Shale	3165'
Lime	3379'
Rotary Total Depth (D & A)	3379'

RECEIVED  
STATE CORPORATION COMMISSION  
JUL 27 1967  
JUL 27, 1967  
CONSERVATION DIVISION  
Wichita, Kansas

We certify the above log is true and correct to the best of our knowledge and belief.

RAINS & WILLIAMSON OIL CO.

*Lloyd R. Williamson*  
Lloyd R. Williamson, Partner

Subscribed and sworn to before me, a Notary Public in and for the State of Kansas, County of Sedgwick, this 1st day of April, 1966.

My Commission Expires: March 3, 1970

*Mary J. Brown*  
Mary J. Brown Notary Public