

EFFECTIVE DATE: 7-25-92

DISTRICT # 4

SGA? Yes No

State of Kansas

NOTICE OF INTENTION TO DRILL

Must be approved by the K.C.C. five (5) days prior to commencing well

*COR* mail to emphasis FORM C-1 4/91  
"CORRECTION" FORM MUST BE TYPED

FORM MUST BE SIGNED  
ALL BLANKS MUST BE FILLED

Expected Spud Date July 22, 1992  
month day year

\* Spot 130' N & 130' E of East  
SW NE SE Sec 15 Twp 10S. S. Rg 18. X West

OPERATOR: License # 31003  
Name: Howard S. Shepard  
Address: 1325 State Street  
City/State/Zip: Hays, KS 67601  
Contact Person: Howard S. Shepard  
Phone: (913)-625-8160

\* 1780 feet from South / North line of Section  
\* 860 feet from East / West line of Section  
IS SECTION X REGULAR \_\_\_\_\_ IRREGULAR?

CONTRACTOR: License #: 8241  
Name: Emphasis Oil Operations

(NOTE: Locate well on the Section Plat on Reverse Side)  
County: Rooks  
Lease Name: Valenta Well #: 1  
Field Name: Flagler

Well Drilled For: Well Class: Type Equipment:  
X Oil ... Enh Rec X Infield X Mud Rotary  
... Gas ... Storage ... Pool Ext. ... Air Rotary  
... OWWO ... Disposal ... Wildcat ... Cable  
... Seismic; ... # of Holes ... Other  
... Other

Is this a Prorated/Spaced Field? ... yes X no  
Target Formation(s): Lansing/Arbuckle  
Nearest lease or unit boundary: 860'  
\* Ground Surface Elevation: 2163 feet MSL

If OWWO: old well information as follows:  
Operator: \_\_\_\_\_  
Well Name: \_\_\_\_\_  
Comp. Date: \_\_\_\_\_ Old Total Depth \_\_\_\_\_

Domestic well within 330 feet: ... yes X no  
Municipal well within one mile: ... yes X no  
Depth to bottom of fresh water: 80  
Depth to bottom of usable water: 900

Directional, Deviated or Horizontal wellbore? ... yes X no  
If yes, total depth location: \_\_\_\_\_  
Bottom Hole Location: \_\_\_\_\_

Surface Pipe by Alternate: ... 1 X 2  
Length of Surface Pipe Planned to be set: 240' 270'  
Length of Conductor pipe required: N/A  
Projected Total Depth: 3775'  
Formation at Total Depth: Arbuckle

*was 240' alt 2*  
*2310 fs | 330' fe | NENESE*  
The undersigned hereby affirms that the drilling, completion and eventual plugging of this well will comply with K.S.A. 55-101, et. seq.  
It is agreed that the following minimum requirements will be met:

Water Source for Drilling Operations:  
... well X farm pond ... other  
DWR Permit #: \_\_\_\_\_  
Will Cores Be Taken?: ... yes X no

\* If yes, proposed zone: \_\_\_\_\_  
*15 270' alt # 1780 fs | 860 fe |*  
*130' N + 130' E of SW NESE*

AFFIDAVIT

1. Notify the appropriate district office prior to spudding of well;
2. A copy of the approved notice of intent to drill shall be posted on each drilling rig;
3. The minimum amount of surface pipe as specified below shall be set by circulating cement to the top; in all cases surface pipe shall be set through all unconsolidated materials plus a minimum of 20 feet into the underlying formation;
4. If the well is dry hole, an agreement between the operator and the district office on plug length and placement is necessary prior to plugging;
5. The appropriate district office will be notified before well is either plugged or production casing is cemented in;
6. IF AN ALTERNATE II COMPLETION, PRODUCTION PIPE SHALL BE CEMENTED FROM BELOW ANY USABLE WATER TO SURFACE WITHIN 120 DAYS OF SPUD DATE. IN ALL CASES, NOTIFY DISTRICT OFFICE PRIOR TO ANY CEMENTING.

I hereby certify that the statements made herein are true and to the best of my knowledge and belief.  
Date: 8-5-92 Signature of Operator or Agent: \_\_\_\_\_ Title: Agent

FOR KCC USE:  
API # 15-163-23,207-00-00  
Conductor pipe required None feet  
Minimum surface pipe required 270' feet per Alt. X  
Approved by: C.B. 7-20-92  
This authorization expires: 1-20-93  
(This authorization void if drilling not started within 6 months of effective date.)  
Spud date: \_\_\_\_\_ Agent: \_\_\_\_\_

*COR* CB 812-92

REMEMBER TO:

- File Drill Pit Application (form CDP-1) with Intent to Drill;
- File Completion Form ACO-1 within 120 days of spud date;
- File acreage attribution plat according to field proration orders;
- Notify appropriate district office 48 hours prior to workover or re-entry;
- Submit plugging report (CP-4) after plugging is completed;
- Obtain written approval before disposing or injecting salt water.

Mail to: Conservation Division, 200 Colorado Derby Building, 202 W. First St., Wichita, Kansas 67202-1286.

RECEIVED  
STATE CORPORATION COMMISSION  
08-06-1992  
AUG 6 1992  
CONSERVATION DIVISION  
Wichita, Kansas

15  
14  
18

# IN ALL CASES PLOT THE INTENDED WELL ON THE PLAT BELOW

## PLAT OF ACREAGE ATTRIBUTABLE TO A WELL IN A PRORATED OR SPACED FIELD

If the intended well is in a prorated or spaced field, please fully complete this side of the form. If the intended well is in a prorated or spaced field complete the plat below showing that the well will be properly located in relationship to other wells producing from the common source of supply. Please show all the wells within 1 mile of the boundaries of the proposed acreage attribution unit for gas wells and within 1/2 mile of the boundaries of the proposed acreage attribution unit for oil wells.

API NO. 15- \_\_\_\_\_  
 OPERATOR \_\_\_\_\_ LOCATION OF WELL: COUNTY \_\_\_\_\_  
 LEASE \_\_\_\_\_ feet from south/north line of section  
 WELL NUMBER \_\_\_\_\_ feet from east/west line of section  
 FIELD \_\_\_\_\_ SECTION \_\_\_\_\_ TWP \_\_\_\_\_ RG \_\_\_\_\_

NUMBER OF ACRES ATTRIBUTABLE TO WELL \_\_\_\_\_ IS SECTION \_\_\_\_\_ REGULAR or \_\_\_\_\_ IRREGULAR  
 QTR/QTR/QTR OF ACREAGE \_\_\_\_\_ - \_\_\_\_\_ - \_\_\_\_\_ IF SECTION IS IRREGULAR, LOCATE WELL FROM NEAREST CORNER BOUNDARY.

Section corner used: \_\_\_\_\_ NE \_\_\_\_\_ NW \_\_\_\_\_ SE \_\_\_\_\_ SW

### PLAT

(Show location of the well and shade attributable acreage for prorated or spaced wells.)  
 (Show footage to the nearest lease or unit boundary line.)

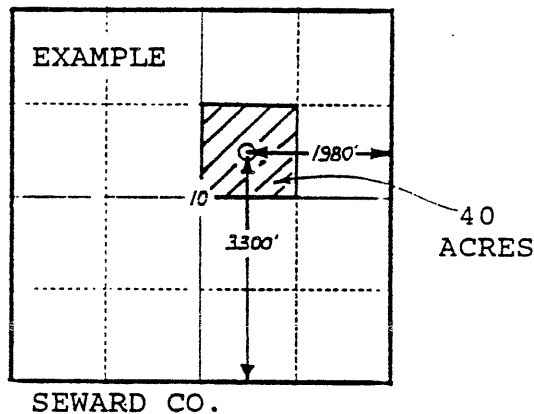
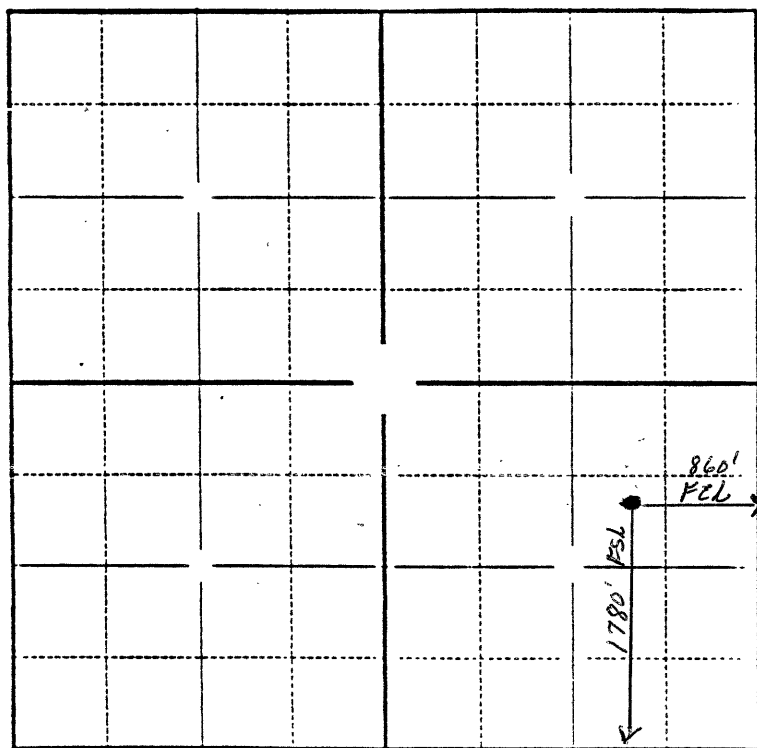

In plotting the proposed location of the well, you must show:

- 1) The manner in which you are using the depicted plat by identifying section lines, i.e. 1 section, 1 section with 8 surrounding sections, 4 sections, etc.;
- 2) the distance of the proposed drilling location from the section's south/north and east/west; and
- 3) the distance to the nearest lease or unit boundary line.