

15-163-21082-00-00

RECEIVED STATE CORPORATION COMMISSION FORM CP-4

STATE OF KANSAS STATE CORPORATION COMMISSION

WELL PLUGGING RECORD

AUG 19 1980

Give All Information Completely Make Required Affidavit Mail or Deliver Report to Conservation Division State Corporation Comm. 245 North Water Wichita, KS 67202

Rooks County, Sec. 25, Twp. 18S, Rge. 18 W Location as "NE/CNW 1/4 SW 1/4" or footage from lines C S/2 S/2 SE/4

Lease Owner A. L. Abercrombie, Inc. Lease Name SCHMIDT Well No. 4 Office Address 801 Union Center, Wichita, KS 67202 Character of Well (Completed as Oil, Gas or Dry Hole)

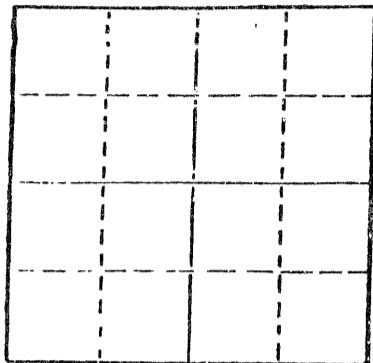

Locate well correctly on above Section Plat

Dry Hole Date Well completed 06-03 1980 Application for plugging filed 06-03 1980 Application for plugging approved 06-03 1980 Plugging commenced 06-03 1980 Plugging completed 06-03 1980

Reason for abandonment of well or producing formation No commercial quantity of oil or gas encountered If a producing well is abandoned, date of last production 19

Was permission obtained from the Conservation Division or its agents before plugging was commenced? Yes

Name of Conservation Agent who supervised plugging of this well Marion Schmidt Producing formation Depth to top Bottom Total Depth of Well 3592' Show depth and thickness of all water, oil and gas formations.

OIL, GAS OR WATER RECORDS

CASING RECORD

Table with columns: FORMATION, CONTENT, FROM, TO, SIZE, PUT IN, PULLED OUT

Describe in detail the manner in which the well was plugged, indicating where the mud fluid was placed and the method or methods used in introducing it into the hold. If cement or other plugs were used, state the character of same and depth placed, from feet to feet for each plug set.

T.D. 3592' Set 1st plug at 750' with 70 sx. 2nd plug at 200' with 20 sx. 3rd plug at 40' solid bridge with 10 sx. and rathole with 5 sx.

Cemented with 50/50 posmix, 6% gel. Plug was down at 11:30 p.m. 06-30-80 State plugger - Marion Schmidt.

RECEIVED STATE CORPORATION COMMISSION AUG 14 1980 CONSERVATION DIVISION Wichita, Kansas

(If additional description is necessary, use BACK of this sheet)

Name of Plugging Contractor Abercrombie Drilling, Inc.

STATE OF Kansas COUNTY OF Sedgwick, ss. Jack L. Partridge, Asst. Sec.-Treas. (employee of owner) or (owner or operator) of the above-described well, being first duly sworn on oath, says: That I have knowledge of the facts, statements, and matters herein contained and the log of the above-described well as filed and that the same are true and correct. So help me God.

(Signature) Jack L. Partridge 801 Union Center, Wichita, Kansas 67202 (Address)

SUBSCRIBED AND SWORN TO before me this 13th day of August, 1980



Sherrie L. Brooks Notary Public.

My commission expires

KANSAS DRILLERS LOG

S. 25 T.10S R.18W ^E/_W
 Loc. C S/2 S/2 SE/4

API No. 15 — 163 — 21,082-00-00
 County Number

County Rooks

Operator
 A. L. Abercrombie, Inc.

Address
 801 Union Center, Wichita, Kansas 67202

Well No. 4 Lease Name Schmidt

Footage Location
 feet from (N) (S) line feet from (E) (W) line

Principal Contractor Abercrombie Drilling, Inc. Geologist Jack K. Wharton

Spud Date 5/27/80 Total Depth 3592 P.B.T.D.

Date Completed 6/3/80 Oil Purchaser

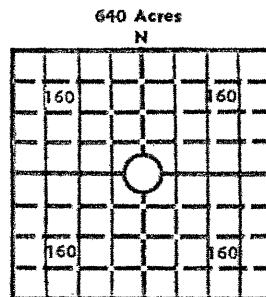

Elev.: Gr. 1989'
 DF 1995' KB 1997'

CASING RECORD

Report of all strings set— surface, intermediate, production, etc.

Purpose of string	Size hole drilled	Size casing set (in O.D.)	Weight lbs/ft.	Setting depth	Type cement	Sacks	Type and percent additives
Surface	12 1/2	8 5/8"	20#	205	Common	170	2% gel, 3% Ca.CI

LINER RECORD

PERFORATION RECORD

Top, ft.	Bottom, ft.	Sacks cement	Shots per ft.	Size & type	Depth interval

TUBING RECORD

Size	Setting depth	Packer set at

ACID, FRACTURE, SHOT, CEMENT SQUEEZE RECORD

Amount and kind of material used	Depth interval treated

INITIAL PRODUCTION

Date of first production	Producing method (flowing, pumping, gas lift, etc.)
RATE OF PRODUCTION PER 24 HOURS	Oil bbls. Gas MCF Water bbls. Gas-oil ratio CFPB
Disposition of gas (vented, used on lease or sold)	Producing interval (s)

RECEIVED
 STATE CORPORATION COMMISSION
 AUG 14 1980
 CONSERVATION DIVISION
 Wichita, Kansas

INSTRUCTIONS: As provided in KCC Rule 82-2-125, within 90 days after completion of a well, one completed copy of this Drillers Log shall be transmitted to the State Geological Survey of Kansas, 4150 Monroe Street, Wichita, Kansas 67209. Copies of this form are available from the Conservation Division, State Corporation Commission, 3830 So. Meridian (P.O. Box 17027), Wichita, Kansas 66217. Phone AC 315-522-2206. If confidential custody is desired, please note Rule 82-2-125. Drillers Logs will be on an open file in the Oil and Gas Division, State Geological Survey of Kansas, Lawrence, Kansas 66044.

DESIGNATE TYPE OF COMP.: OIL, GAS,
DRY HOLE, SWDW, ETC.:

Operator

A. I. ABERCROMBIE, INC.

Well No.

4

Lease Name

Schmidt

S 25 T 10s R 18w^EW

WELL LOG

Show all important zones of porosity and contents thereof; cored intervals, and all drill-stem tests, including depth interval tested, cushion used, time tool open, flowing and shut-in pressures, and recoveries.

SHOW GEOLOGICAL MARKERS, LOGS RUN,
OR OTHER DESCRIPTIVE INFORMATION.

FORMATION DESCRIPTION, CONTENTS, ETC.	TOP	BOTTOM	NAME	DEPTH
Sand & shale	0	244	<u>SAMPLE TOPS:</u>	
Shale & sand	244	1301	Anhydrite	1301' (+ 696)
Anhydrite	1301	1334	B/Znhydrite	1334' (+ 663)
Shale	1334	1865	Heebner	3184' (- 487)
Lime & shale	1865	2115	Toronto	3200' (-1203)
Shale	2115	2570	Lansing	3226' (-1229)
Lime & shale	2570	2995	Arbuckle	3586' (-1589)
Shale & Lime	2995	3115		
Lime & shale	3115	3230		
Lime	3230	3592		
Rotary Total Depth		3592		
DST #1 (3248-3292') 30", 45", 30", 30". IFP 29-21, IBHP 63, FFP 19-19, FBHP 21.	Rec. 5' mud.			
DST #2 (3410-3454') 30", 45", 30", 30". IFP 21-20, IBHP 32, FFP 21-21, FBHP 21.	Rec. 5' mud.			

USE ADDITIONAL SHEETS, IF NECESSARY, TO COMPLETE WELL RECORD.

Date Received

Jack L. Partridge

Signature

Jack L. Partridge

Assistant Secretary-Treasurer

Title

Date