

KANSAS CORPORATION COMMISSION
OIL & GAS CONSERVATION DIVISION
WELL PLUGGING APPLICATION
Please TYPE Form and File ONE Copy

Form CP-1
September 2003
This Form must be Typed
Form must be Signed
All blanks must be Filled

API # 15 - 163-22742-0001 (Identifier Number of this well). This must be listed for wells drilled since 1967; if no API # was issued, indicate original spud or completion date Spud July 19, 1991.

Well Operator: Bowman Oil Company KCC License #: 6931
(Owner / Company Name) (Operator's)
Address: 805 Codell Road City: Codell
State: Kansas Zip Code: 67663 Contact Phone: (785) 434 - 2286 M-F 7-12 AM
Lease: Sutor D Well #: 1 (previous #1-24) Sec. 24 Twp. 10S S. R. 20 East West
- NW - SE - SW Spot Location / QQQQ County: Rooks County, Kansas

990 Feet (in exact footage) From North / South (from nearest outside section corner) Line of Section (Not Lease Line)
3630 Feet (in exact footage) From East / West (from nearest outside section corner) Line of Section (Not Lease Line) **from SE corner**

Check One: Oil Well Gas Well D&A Cathodic Water Supply Well
 SWD Docket # _____ ENHR Docket # _____ Other: _____

Conductor Casing Size: _____ Set at: _____ Cemented with: _____ Sacks
Surface Casing Size: 8 5/8" Set at: 305' Cemented with: 215 Sacks
Production Casing Size: 4 1/2" Set at: 3693' Cemented with: 150 Sacks

List (ALL) Perforations and Bridgeplug Sets: Perfs. 3542' to 3546' Plug set @ 3680' - Wireline Plug

Elevation: 2128 (G.L. / K.B.) T.D.: 3696 PBTD: 3690 Anhydrite Depth: 1553
(Stone Corral Formation)

Condition of Well: Good Poor Casing Leak Junk in Hole

Proposed Method of Plugging (attach a separate page if additional space is needed): Will Cement According to KCC District #4's Instructions

Is Well Log attached to this application as required? Yes No Is ACO-1 filed? Yes No

If not explain why? _____

Plugging of this Well will be done in accordance with K.S.A. 55-101 et. seq. and the Rules and Regulations of the State Corporation Commission.

List Name of Company Representative authorized to be in charge of plugging operations: _____

Louis "Don" Bowman Phone: (785) 434 - 2286 M-F 7-12 AM

Address: 805 Codell Road City / State: Codell, Kansas 67663

Plugging Contractor: Allied Cementing Company, Inc. KCC License #: _____
(Company Name) (Contractor's)

Address: 24 S. Lincoln Russell, Kansas 67665 Phone: (785) 434 - 2627

Proposed Date and Hour of Plugging (if known?): October 10, 2007

Payment of the Plugging Fee (K.A.R. 82-3-118) will be guaranteed by Operator or Agent

Date: September 24, 2007 Authorized Operator / Agent: Connie Jo Austin
(Signature)

RECEIVED
KANSAS CORPORATION COMMISSION

Mail to: KCC - Conservation Division, 130 S. Market - Room 2078, Wichita, Kansas 67202 **SEP 25 2007**

CONSERVATION DIVISION
WICHITA, KS

* Corrected ACO-1
24-10-20W rd. 81

STATE CORPORATION COMMISSION OF KANSAS
OIL & GAS CONSERVATION DIVISION

WELL COMPLETION OR RECOMPLETION FORM
ACO-1 WELL HISTORY

DESCRIPTION OF WELL AND LEASE

Operator: License # 5020
Name Rine Exploration Company
Address Suite #645
300 W. Douglas
City/State/Zip Wichita, KS 67202

* Purchaser ~~AT&T~~ Mobil Oil
Kc-Kc Kc-Kc

Operator Contact Person M. Bradford Rine
Phone 316/262-5418

Contractor: License # 5422
Name Abercrombie Drilling, Inc.

Wellsite Geologist Steve Kriedler
Phone 316/265-5370

Designate Type of Completion

New Well Re-Entry Workover

Oil SWD Temp Abd
 Gas Inj Delayed Comp.
 Dry Other (Core, Water Supply etc.)

If OWWO: old well info as follows:

Operator
Well Name
Comp. Date Old Total Depth

WELL HISTORY

Drilling Method:
 Mud Rotary Air Rotary Cable

08/27/85 09/02/85 09/03/85
Spud Date Date Reached TD Completion Date
3696' 3690'
Total Depth PBD

Amount of Surface Pipe Set and Cemented at 305' feet
Multiple Stage Cementing Collar Used? Yes No
If yes, show depth set.....feet
If alternate 2 completion, cement circulated
from.....feet depth to.....w/.....SX cmt

API NO. 15-163-22-742
County Rooks
NW 1/4 SE 1/4 SW 1/4 Sec. 24 Twp. 10S Rge. 20W
 East West

990 Ft North from Southeast Corner of Section
3630 Ft West from Southeast Corner of Section
(Note: Locate well in section plat below)

Lease Name Sutor Well # 1-24

Field Name Marcotte

Producing Formation Arbuckle

Elevation: Ground 2128' KB 2133'

Section Plat

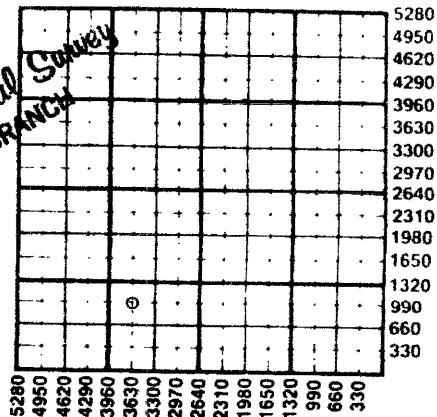

NOT 07 1985
State Geological Survey
WICHITA BRANCH

WATER SUPPLY INFORMATION

Disposition of Produced Water: Disposal
Docket # Repressuring

Questions on this portion of the ACO-1 call:

Water Resources Board (913) 296-3717

Source of Water:
Division of Water Resources Permit #

Groundwater.....Ft North from Southeast Corner
(Well)Ft West from Southeast Corner of
Sec Twp Rge East West

Surface Water 850 Ft North from Southeast Corner
(Stream, pond etc) 3630 Ft West from Southeast Corner
Sec 24 Twp 10S Rge 20 East West

Other (explain).....
(purchased from city, R.W.D. #)

INSTRUCTIONS: This form shall be completed in duplicate and filed with the Kansas Corporation Commission, 200 Colorado Derby Building, Wichita, Kansas 67202, within 90 days after completion or recompletion of any well. Rule 82-3-130 and 82-3-107 apply.

Information on side two of this form will be held confidential for a period of 12 months if requested in writing and submitted with the form. See rule 82-3-107 for confidentiality in excess of 12 months. One copy of all wireline logs and drillers time log shall be attached with this form. Submit CP-4 form with plugged wells. Submit CP-111 form with all temporarily abandoned wells.

RECEIVED
KANSAS CORPORATION COMMISSION

SEP 25 2007

75635

SIDE TWO

Operator Name RINE EXPLORATION COMPANY Lease Name Sutor Well # 1-24

24 10 South 20 West ~~East~~ ~~West~~ County Rooks

Date of First Production Approx. Oct. 15, 1985 Producing Method Flowing Pumping Gas Lift Other (explain).....

Estimated Production Per 24 Hours	Oil 50 Bbls	Gas -0- MCF	Water Trace Bbls	Gas-Oil Ratio CFPB	Gravity
-----------------------------------	----------------	----------------	---------------------	-----------------------	---------

Drill Stem Tests Taken Yes No
 Samples Sent to Geological Survey Yes No
 Cores Taken Yes No

Formation Description
 Log Sample

DST #1 / 3160'-3206' (Topeka) 30-45-45-60. Weak blow, rec. 120' watery cut mud with slight show of oil.
 IFP 21 - 21 ISIP 690
 FFP 32 - 32 FSIP 679

DST #2 / 3527'-3657' (KC-Marm.) 30-30-30-30. Weak blow died in 20 min., rec. 10' mud.
 IFP 32 - 32 ISIP 345
 FFP 43 - 43 FSIP 226

DST #3 / 3636'-3696' (Arbuckle) 30-60-30-60. Strong blow, rec. 154' oil cut mud, 124' heavy oil and gas cut mud - 65% oil, 434' gassy oil.
 IFP 86 - 216 ISIP 1055
 FFP 280 - 313 FSIP 1012

Name	Top	Bottom
<u>SAMPLE TOPS</u>		
Anhydrite	1553	+ 580
Base Anhydrite	1586	+ 547
Topeka	3143	-1010
Heebner	3352	-1219
Lansing	3390	-1257
Base Kansas City	3597	-1464
Arbuckle	3692	-1559
RTD	3696	-1563
<u>E-LOG TOPS</u>		
Anhydrite	1551	+ 582
Base Anhydrite	1589	+ 544
Topeka	3143	-1010
Heebner	3351	-1218
Lansing	3389	-1256
Base Kansas City	3597	-1464
Arbuckle	Not on Log	
LTD	3696	-1563

METHOD OF COMPLETION
 Open Hole Perfora
 Other (Specify)

State Geological Survey
WICHITA BRANCH
7 1985

CASING RECORD New Used
 Report all strings set-conductor, surface, intermediate, production, etc.

Purpose of String	Size Hole Drilled	Size Casing Set (in O.D.)	Weight Lbs/Ft.	Setting Depth	Type of Cement	#Sacks Used	Type and Percent Additives
Surface	12 1/4"	8 5/8"	24#	305.50'	Common	215	2% gel/3% cc
Production	7 7/8"	4 1/2"	10 1/2#	3693.50'	Mud Flush	10#	50-50 pop 150 10% Salt, 75% CFR2

PERFORATION RECORD

Shots Per Foot	Specify Footage of Each Interval Perforated	Acid, Fracture, Shot, Cement Squeeze Record (Amount and Kind of Material Used)	Depth
Two	At 1554' and squeeze-cemented off the Dakota Sandstone with 300 sacks	300 gal. of MOD-202 (15% HCL-10% Acetic) ATR - 1/3 bbl. per min., MTP - 1/3 bbl. per min., ATP - 300#, MTP - 300#	

TUBING RECORD

Size	Set At	Packer at	Liner Run	<input type="checkbox"/> Yes <input type="checkbox"/> No
2 3/8"	3691'	N/A		

RECEIVED KANSAS CORPORATION COMMISSION

SEP 25 2007

CONSERVATION DIVISION WICHITA, KS

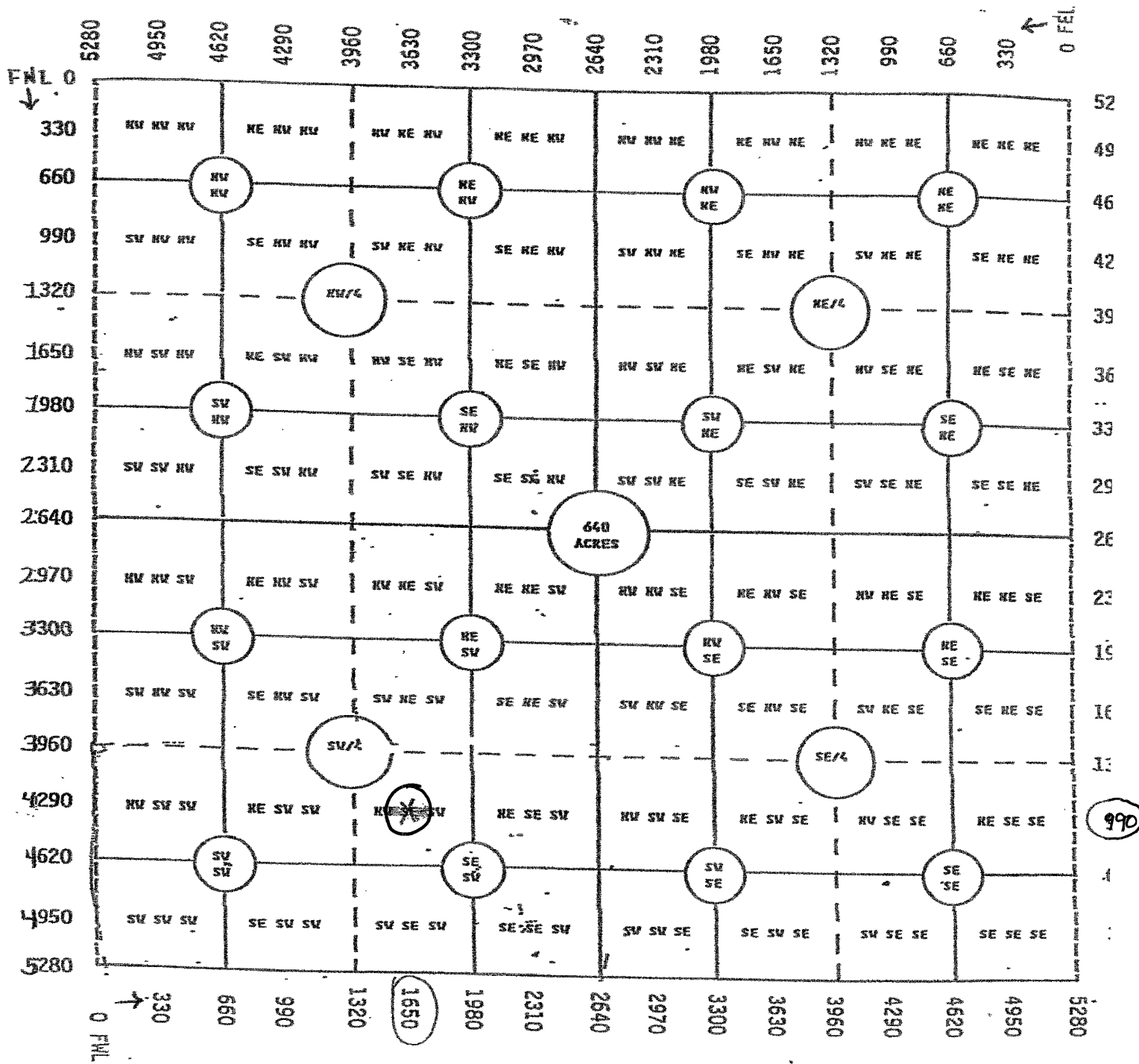

Sutor "D" # 1-24 NW SE SW Rooks Co, KS 24-10-20

4290 FNL
 990 FSL
 1650 FNL
 3630 FEL

from SE Corner
 990 FSL
 3630 FEL



CORPORATION COMMISSION

Kathleen Sebelius, Governor Thomas E. Wright, Chairman Michael C. Moffet, Commissioner Joseph F. Harkins, Commissioner

NOTICE OF RECEIPT OF WELL PLUGGING APPLICATION (CP-1)

BOWMAN OIL COMPANY, A GENERAL PARTNERSHIP
805 CODELL RD
CODELL, KS 67663-8500

October 03, 2007

Re: SUTOR D #1
API 15-163-22742-00-01
24-10S-20W, 990 FSL 1650 FWL
ROOKS COUNTY, KANSAS

Dear Operator:

This letter is to notify you that the Conservation Division has received your plugging proposal, form CP-1, for the above well and has reviewed the proposal for completeness. The central office will now forward your CP-1 to the district office listed below for review of the proposed plugging method. **Please contact the district office for approval of your proposed plugging method at least five (5) days before plugging the well, pursuant to K.A.R. 82-3-113(b). If a workover pit will be used during the plugging of the well it must be permitted. A CDP-1 form must be filed and approved prior to the use of the pit in accordance with K.A.R. 82-3-600.**

The Conservation Division's review of form CP-1, either in the central or district office, does not include an inquiry into well ownership or the filing operator's legal right to plug the well. This notice in no way constitutes authorization to plug the above well by persons not having legal rights of ownership or interest in the well.

This notice is void after March 31, 2008. The CP-1 filing does not bring the above well into compliance with K.A.R. 82-3-111 with regard to the Commission's temporary abandonment requirements.

District: #4
2301 E. 13th
Hays, KS 67601
(785) 625-0550

Sincerely,

Steve Bond
Production Department Supervisor