

Give All Information Completely  
Make Required Affidavit  
Mail or Deliver Report to:  
Conservation Division  
State Corporation Commission  
211 No. Broadway  
Wichita, Kansas

WELL PLUGGING RECORD

Graham County, Sec. 16 Twp. 9 Rge. 21 (E) W (W)

Location as "NE/CNW/SW" or footage from lines NE NE NE

Lease Owner Jenkins- Ray Supply

Lease Name H. Kolste Well No. 1

Office Address Ponca City, Oklahoma

Character of Well (completed as Oil, Gas or Dry Hole) \_\_\_\_\_

Date well completed \_\_\_\_\_ 19 \_\_\_\_\_

Application for plugging filed \_\_\_\_\_ 19 \_\_\_\_\_

Application for plugging approved \_\_\_\_\_ 19 \_\_\_\_\_

Plugging commenced 2-28-64 \_\_\_\_\_ 19 \_\_\_\_\_

Plugging completed 3-1-64 \_\_\_\_\_ 19 \_\_\_\_\_

Reason for abandonment of well or producing formation Depleted.

If a producing well is abandoned, date of last production \_\_\_\_\_ 19 \_\_\_\_\_

Was permission obtained from the Conservation Division or its agents before plugging was commenced? yes

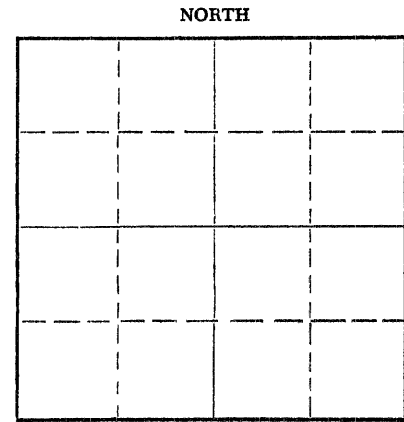

Locate well correctly on above Section Plat

Name of Conservation Agent who supervised plugging of this well W. L. Nichols

Producing formation \_\_\_\_\_ Depth to top \_\_\_\_\_ Bottom \_\_\_\_\_ Total Depth of Well 4216 Feet

Show depth and thickness of all water, oil and gas formations.

OIL, GAS OR WATER RECORDS

CASING RECORD

FORMATION	CONTENT	FROM	TO	SIZE	PUT IN	PULLED OUT
				13"	246'	None
				7"	4034'	1640'

Describe in detail the manner in which the well was plugged, indicating where the mud fluid was placed and the method or methods used in introducing it into the hole. If cement or other plugs were used, state the character of same and depth placed, from \_\_\_\_\_ feet to \_\_\_\_\_ feet for each plug set.

Checked hole to 4216', set plug @ 4010', sanded to 4000' and dumped 6 sacks of cement @ 4000' with dump bailer. Pulled 7" casing to 600' and circulated pipe with gel. mud. Pulled 7" casing to 540' and dumped 30 sacks of cement @ 540'. Pulled 7" casing to 240' and dumped 30 sacks of cement @ 240'. ~~XXXX~~ Pulled balance of 7" casing, ~~mud~~ bailed mud to 35', set rock bridge to 30' and ran 15 sacks of cement to base of cellar.

RECEIVED  
STATE CORPORATION COMMISSION

PLUGGING COMPLETE.

MAR 10 1964  
3-10-64  
CONSERVATION DIVISION  
Wichita, Kansas

(If additional description is necessary, use BACK of this sheet)

Name of Plugging Contractor KNIGHT CASING PULLING COMPANY

Address CHASE, KANSAS

STATE OF KANSAS, COUNTY OF RICE, ss.

Noel J. Knight (employee of owner) or ~~OWNER OR OPERATOR~~ of the above-described well, being first duly sworn on oath, says: That I have knowledge of the facts, statements, and matters herein contained and the log of the above-described well as filed and that the same are true and correct. So help me God.

(Signature) Noel J. Knight

Chase, Kansas

(Address)

SUBSCRIBED AND SWORN TO before me this 9th day of March, 19 64

Milton J. Volin  
Notary Public.

My commission expires May 20, 1964

COPY

CONTINENTAL OIL CO.  
 H. Kolste No. 1.

*Jenkins Ray Supply*  
*Parca City Okla.*

SEC. 16 T. 9 R. 21W  
 NE 35  
 330'S 330'W E $\frac{1}{2}$  Cor.

Total Depth. 4218'  
 Comm. 3-20-39 Comp. 5-13-39  
 Shot or Treated. 6000 Gal.  
 Contractor. F.P. Cullum Ind. Co.  
 Issued. 7-15-39

County. Graham

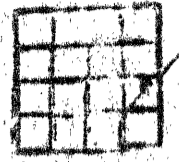

CASING:  
 13" 246'  
 9 5/8" 1487'  
 7" 4034'

Elevation.

Production. Salt Wtr Disp.

Figures Indicate Bottom of Formations.

shale & sand	316	sdv dolomite	4130
shale & shells	530	sand	4170
shale	985	granite	4218
shale & lime shells	1030	Total Depth.	
shale	1071		
sand	1096		
shale & sand	1143		
sand	1407	Corrected total depth	
shale & sand	1425	from ground level 4218'	
shale	1706		
anhydrite	1748	Top of Anhydrite 1706	
shale & shells	1870	Top of Lansing lime 3450	
shale	2030	good shows of oil 3610-18	
brkn lime & shale	2378	Top of Conglomerate 3737	
lime	2385	Top of Arbuckle lime 3871	
brkn lime & shale	2416	above tops from rotary	
shale	2428	table	
lime, shale, salt	2509		
lime	2525	Cored 3879-3994 3' roc of	
brkn lime & shale	2681	Arbuckle lime, no sh oil	
shale	2697	Perforated casing w/50	
lime	2701	shots 3606 $\frac{1}{2}$ -17 $\frac{1}{2}$ found	
brkn lime	2765	salt wtr	
lime	2804	Finding the Arbuckle lime	
brkn lime	2867	dry the well was drilled	
lime & sticky shale	2864	deeper for a salt wtr	
shale	2871	input well.	
lime	2936	5-19-39 acidized w/6000 G.	
shale & lime	2954	After acidizing the well	
shale	3012	took 240 BW in 1 Hr thru	
shale & lime	3116	a 2" line on 20 point	
lime & sand	3129	vacuum.	
lime	3140		
brkn lime	3259		
shale	3270		
lime	3283		
lime & gyp	3286		
brkn lime	3294		
lime hrd	3303		
lime	3706		
lime & shale	3712		
lime	3727		
chert conglomerate	3751		
shale & chert	3768		
shale	3785		
conglomerate	3792		
chert & sand	3797		
lime	3804		
chert	3810		
lime	3813		
chert	3816		
chert & shale	3825		
chert	3828		
chert & shale	3850		
chert, shale dolomite	3865		
chert	3866		
chert, shale, dolomite	3879		
lime hrd	3889		
lime	4080		

**RECEIVED**  
 STATE CORPORATION COMMISSION

FEB 27 1964

CONSERVATION DIVISION  
 Wichita, Kansas