

NOV 27 2007

Form C-1  
December 2002

For KCC Use:  
Effective Date: 12-5-07  
District #: 1  
SGA?  Yes  No

KANSAS CORPORATION COMMISSION  
OIL & GAS CONSERVATION DIVISION

CONSERVATION DIVISION  
WICHITA, KS Form must be Typed  
Form must be Signed  
All blanks must be Filled

NOTICE OF INTENT TO DRILL

Must be approved by KCC five (5) days prior to commencing well

Expected Spud Date 11 23 2007  
month day year

OPERATOR: License# 5118  
Name: TGT Petroleum Corp.  
Address: 7570 W. 21st-Bldg. 1010-D  
City/State/Zip: Wichita, Ks. 67205  
Contact Person: B. Lynn Herrington  
Phone: 773-2266

CONTRACTOR: License# 5123  
Name: Pickrell Drilling

Well Drilled For:  Oil  Gas  OWO  Seismic; # of Holes  Other  
 Enh Rec  Storage  Disposal  Other  
Well Class:  Infield  Pool Ext.  Wildcat  Other  
Type Equipment:  Mud Rotary  Air Rotary  Cable

If OWWO: old well information as follows:  
Operator: \_\_\_\_\_  
Well Name: \_\_\_\_\_  
Original Completion Date: \_\_\_\_\_ Original Total Depth: \_\_\_\_\_  
Directional, Deviated or Horizontal wellbore?  Yes  No  
If Yes, true vertical depth: \_\_\_\_\_  
Bottom Hole Location: \_\_\_\_\_  
KCC DKT #: \_\_\_\_\_

Spot Approx C  East  West  
N/2. NW/4 Sec. 34 Twp. 27 S. R. 19  
510 feet from  N /  S Line of Section  
1212 feet from  E /  W Line of Section  
Is SECTION  Regular  Irregular?

(Note: Locate well on the Section Plat on reverse side)  
County: Kiowa  
Lease Name: Wheeler "H" Well #: 1  
Field Name: Einsel  
Is this a Prorated / Spaced Field?  Yes  No  
Target Information(s): Mississippi  
Nearest Lease or unit boundary: 660'  
Ground Surface Elevation: 2245' GL feet MSL  
Water well within one-quarter mile:  Yes  No  
Public water supply well within one mile:  Yes  No  
Depth to bottom of fresh water: 240'  
Depth to bottom of usable water: 240' 280'  
Surface Pipe by Alternate:  1  2  
Length of Surface Pipe Planned to be set: 450'  
Length of Conductor Pipe required: None  
Projected Total Depth: 4950'  
Formation at Total Depth: Mississippi  
Water Source for Drilling Operations:  
 Well  Farm Pond Other \_\_\_\_\_  
DWR Permit #: \_\_\_\_\_  
(Note: Apply for Permit with DWR )  
Will Cores be taken?  Yes  No  
If Yes, proposed zone: \_\_\_\_\_

AFFIDAVIT

The undersigned hereby affirms that the drilling, completion and eventual plugging of this well will comply with K.S.A. 55 et. seq.  
It is agreed that the following minimum requirements will be met:

1. Notify the appropriate district office *prior* to spudding of well;
2. A copy of the approved notice of intent to drill *shall be* posted on each drilling rig;
3. The minimum amount of surface pipe as specified below *shall be set* by circulating cement to the top; in all cases surface pipe *shall be set* through all unconsolidated materials plus a minimum of 20 feet into the underlying formation.
4. If the well is dry hole, an agreement between the operator and the district office on plug length and placement is necessary *prior to plugging*;
5. The appropriate district office will be notified before well is either plugged or production casing is cemented in;
6. If an ALTERNATE II-COMPLETION, production pipe shall be cemented from below any usable water to surface within *120 days* of spud date.  
Or pursuant to Appendix "B" - Eastern Kansas surface casing order #133,891-C, which applies to the KCC District 3 area, alternate II cementing must be completed within 30 days of the spud date or the well shall be plugged. *In all cases, NOTIFY district office* prior to any cementing.

I hereby certify that the statements made herein are true and to the best of my knowledge and belief  
Date: 11/9/07 Signature of Operator or Agent: B. Lynn Herrington Title: Exc. Vice-President  
Remember to:

For KCC Use ONLY  
API # 15 - 097-21622-0000  
Conductor pipe required None feet  
Minimum surface pipe required 300 feet per Alt. 1  
Approved by: 11-30-07  
This authorization expires: 11-30-08  
(This authorization void if drilling not started within 12 months of effective date.)  
Spud date: \_\_\_\_\_ Agent: \_\_\_\_\_

- File Drill Pit Application (form CDP-1) with Intent to Drill;
  - File Completion Form ACO-1 within 120 days of spud date;
  - File acreage attribution plat according to field proration orders;
  - Notify appropriate district office 48 hours prior to workover or re-entry;
  - Submit plugging report (CP-4) after plugging is completed;
  - Obtain written approval before disposing or injecting salt water.
- If this permit has expired (See: authorized expiration date)-please check the box below and return to the address below.  
 Well Not Drilled - Permit Expired  
Signature of Operator or Agent: \_\_\_\_\_  
Date: \_\_\_\_\_

34  
27  
19W

### IN ALL CASES PLOT THE INTENDED WELL ON THE PLAT BELOW

*Plat of acreage attributable to a well in a prorated or spaced field*

*If the intended well is in a prorated or spaced field, please fully complete this side of the form. If the intended well is in a prorated or spaced field complete the plat below showing that the well will be properly located in relationship to other wells producing from the common source of supply. Please show all the wells and within 1 mile of the boundaries of the proposed acreage attribution unit for gas wells and within 1/2 mile of the boundaries of the proposed acreage attribution unit for oil wells.*

API No. 15 - 097-21622-0000

Operator: \_\_\_\_\_

Lease: \_\_\_\_\_

Well Number: \_\_\_\_\_

Field: \_\_\_\_\_

Number of Acres attributable to well: \_\_\_\_\_

QTR / QTR / QTR of acreage: \_\_\_\_\_

Location of Well: County: \_\_\_\_\_

\_\_\_\_\_ feet from  N /  S Line of Section

\_\_\_\_\_ feet from  E /  W Line of Section

Sec. \_\_\_\_\_ Twp. \_\_\_\_\_ S. R. \_\_\_\_\_  East  West

Is Section:  Regular or  Irregular

If Section is Irregular, locate well from nearest corner boundary.

Section corner used:  NE  NW  SE  SW

### PLAT

*(Show location of the well and shade attributable acreage for prorated or spaced wells.)*

*(Show footage to the nearest lease or unit boundary line.)*

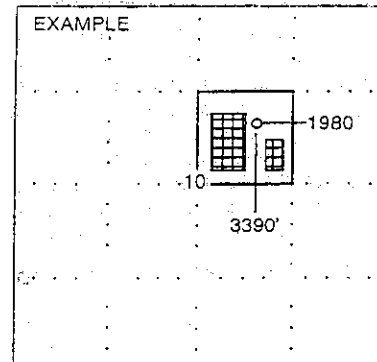
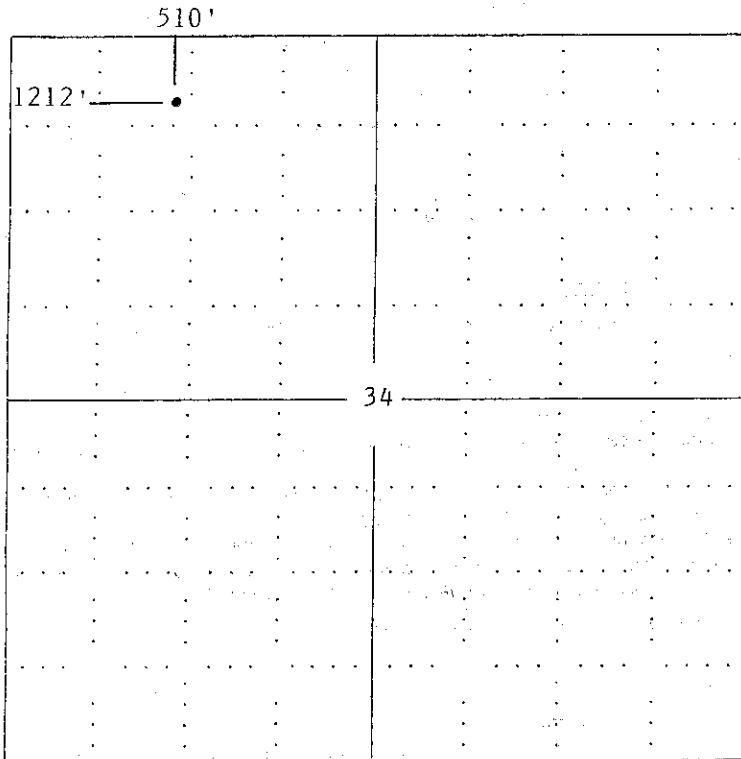

SEWARD CO.

**NOTE: In all cases locate the spot of the proposed drilling locaton.**

**In plotting the proposed location of the well, you must show:**

1. The manner in which you are using the depicted plat by identifying section lines, i.e. 1 section, 1 section with 8 surrounding sections, 4 sections, etc.
2. The distance of the proposed drilling location from the section's south / north and east / west.
3. The distance to the nearest lease or unit boundary line.
4. If proposed location is located within a prorated or spaced field a certificate of acreage attribution plat must be attached: (CO-7 for oil wells; CG-8 for gas wells).

RECEIVED  
KANSAS CORPORATION COMMISSION  
KANSAS CORPORATION COMMISSION  
OIL & GAS CONSERVATION DIVISION  
NOV 27 2007  
APPLICATION FOR SURFACE PIT

Form CDP-1  
April 2004  
Form must be Typed

CONSERVATION DIVISION  
WICHITA, KS

Submit in Duplicate

Operator Name: TGT Petroleum Corporation		License Number: 5118
Operator Address: 7570 W. 21st-Bldg. 1010-D, Wichita, Ks. 67205		
Contact Person: B. Lynn Herrington		Phone Number: ( 316 ) 773-2266
Lease Name & Well No.: Wheeler "H" #1		Pit Location (QQQQ): Approx C - N/2 - NW/4 -
Type of Pit: <input type="checkbox"/> Emergency Pit <input type="checkbox"/> Burn Pit <input type="checkbox"/> Settling Pit <input checked="" type="checkbox"/> Drilling Pit <input type="checkbox"/> Workover Pit <input type="checkbox"/> Haul-Off Pit (If WP Supply API No. or Year Drilled)		Pit is: <input checked="" type="checkbox"/> Proposed <input type="checkbox"/> Existing If Existing, date constructed: _____ Pit capacity: 10,000 (bbls)
Is the pit located in a Sensitive Ground Water Area? <input type="checkbox"/> Yes <input checked="" type="checkbox"/> No		Sec. 34 Twp. 27S R. 19 <input type="checkbox"/> East <input checked="" type="checkbox"/> West 510 Feet from <input checked="" type="checkbox"/> North / <input type="checkbox"/> South Line of Section 1212 Feet from <input type="checkbox"/> East / <input checked="" type="checkbox"/> West Line of Section Kiowa County
Is the bottom below ground level? <input checked="" type="checkbox"/> Yes <input type="checkbox"/> No		Chloride concentration: _____ mg/l (For Emergency Pits and Settling Pits only)
Artificial Liner? <input type="checkbox"/> Yes <input checked="" type="checkbox"/> No		How is the pit lined if a plastic liner is not used?
Pit dimensions (all but working pits): 75 Length (feet) 75 Width (feet)    N/A: Steel Pits Depth from ground level to deepest point: 4 (feet)		
If the pit is lined give a brief description of the liner material, thickness and installation procedure.		Describe procedures for periodic maintenance and determining liner integrity, including any special monitoring.
Distance to nearest water well within one-mile of pit Unknown 189 feet    Depth of water well 151 feet		Depth to shallowest fresh water Est 100/300 feet Source of information: _____ measured    _____ well owner    _____ electric log <input checked="" type="checkbox"/> KDWR
<b>Emergency, Settling and Burn Pits ONLY:</b> Producing Formation: _____ Number of producing wells on lease: _____ Barrels of fluid produced daily: _____ Does the slope from the tank battery allow all spilled fluids to flow into the pit? <input type="checkbox"/> Yes <input type="checkbox"/> No		<b>Drilling, Workover and Haul-Off Pits ONLY:</b> Type of material utilized in drilling/workover: Bentonite & gel Number of working pits to be utilized: Two Abandonment procedure: Let dry naturally and backfill when completely dry. Drill pits must be closed within 365 days of spud date.
I hereby certify that the above statements are true and correct to the best of my knowledge and belief. Nov. 9, 2007    B. Lynn Herrington Date    Signature of Applicant or Agent		

15-097-21622-0000

<b>KCC OFFICE USE ONLY</b>		<i>R.F.A.S.C. Clay / Bentonite Line</i>
Date Received: 11/27/07	Permit Number: _____	Permit Date: 11/30/07    Lease Inspection: <input checked="" type="checkbox"/> Yes <input type="checkbox"/> No

Mail to: KCC - Conservation Division, 130 S. Market - Room 2078, Wichita, Kansas 67202



Kathleen Sebelius, Governor  
Thomas E. Wright, Chairman  
Michael C. Moffet, Commissioner  
Joseph F. Harkins, Commissioner

November 30, 2007

Lynn Herrington  
TGT Petroleum Corp  
7570 W 21<sup>st</sup>, Bldg 1010-D  
Wichita KS 67205

Re: Drilling Pit Application  
Wheeler H Lease Well No. 1  
NW/4 34-27S-19W  
Kiowa County, Kansas

Dear Mr. Herrington:

District staff has inspected the above referenced location and has determined that an unsealed condition will present a pollution threat to water resources.

District staff has recommended that the reserve pit be lined with native clay or bentonite, constructed **without slots**, the bottom shall be flat and reasonably level and the free fluids must be removed. The fluids are to be removed from the reserve pit as soon as the Hutchinson Salt section has been drilled through and displacement of the fluids into the reserve pit has occurred. The fluids should be removed again as soon as practical after drilling operations have ceased.

**If production casing is set all completion fluids shall be removed from the working pits daily. NO completion fluids or non-exempt wastes shall be placed in the reserve pit.**

The fluids should be taken to an authorized disposal well. Please call the District Office at (620) 225-8888 when the fluids have been removed. Please file form CDP-5, Exploration and Production Waste Transfer, within 30 days of fluid removal. Conservation division forms are available through our office and on the KCC web site: <http://kcc.ks.gov/conservation/forms/>

**A copy of this letter should be posted in the doghouse along with the approved Intent to Drill.** If you have any questions or concerns please feel free to contact the undersigned at the above address.

Sincerely,

Jonelle Rains, Supervisor  
Department of Environmental Protection and Remediation

cc: Steve Durrant  
File