

For KCC Use:  
 Effective Date: 12-9-07  
 District #: 3  
 SGA?  Yes  No

KANSAS CORPORATION COMMISSION  
 OIL & GAS CONSERVATION DIVISION

Form C-1  
 October 2007  
 Form must be Typed  
 Form must be Signed  
 All blanks must be Filled

**NOTICE OF INTENT TO DRILL**

Must be approved by KCC five (5) days prior to commencing well

Expected Spud Date: 12 month 14 day 07 year

Spot Description:  
 NW SE SE Sec. 19 Twp. 27 S. R. 22  E  W  
 1,835 feet from  N /  S Line of Section  
 1,250 feet from  E /  W Line of Section

OPERATOR: License# 34019  
 Name: Us Energy LLC  
 Address 1: 20 lakeview SL  
 Address 2:  
 City: Garnett State: Ks. Zip: 66032  
 Contact Person: Jim Goad  
 Phone: 661-569-0383

Is SECTION:  Regular  Irregular?  
 (Note: Locate well on the Section Plat on reverse side)  
 County: Bourbon  
 Lease Name: Shawman Well #: 4 aa  
 Field Name: unknown

CONTRACTOR: License# 34708 33977  
 Name: Ensminger Kinzey E K Energy LLC

Is this a Prorated / Spaced Field?  Yes  No  
 Target Formation(s): Tucker  
 Nearest Lease or unit boundary line (in footage): 1036  
 Ground Surface Elevation: 1001 feet MSL

Well Drilled For:  Oil  Gas  Enh Rec  Storage  Disposal  
 Well Class:  Infield  Pool Ext.  Wildcat  Other  
 Type Equipment:  Mud Rotary  Air Rotary  Cable  
 Seismic: # of Holes  
 Other:  
 If OWWO: old well information as follows:

Water well within one-quarter mile:  Yes  No  
 Public water supply well within one mile:  Yes  No  
 Depth to bottom of fresh water: 50 ft  
 Depth to bottom of usable water: 100 ft  
 Surface Pipe by Alternate:  I  II  
 Length of Surface Pipe Planned to be set: 20 ft  
 Length of Conductor Pipe (if any):  
 Projected Total Depth: 700 ft.  
 Formation at Total Depth: Tucker

Operator:  
 Well Name:  
 Original Completion Date: Original Total Depth:

Water Source for Drilling Operations:  
 Well  Farm Ponds  Other:  
 DWR Permit #: (Note: Apply for Permit with DWR)   
 Will Cores be taken?  Yes  No  
 If Yes, proposed zone:

**AFFIDAVIT**

RECEIVED

The undersigned hereby affirms that the drilling, completion and eventual plugging of this well will comply with K.S.A. 55 et. seq. KANSAS CORPORATION COMMISSION  
 It is agreed that the following minimum requirements will be met:

DEC 03 2007

1. Notify the appropriate district office **prior** to spudding of well;
2. A copy of the approved notice of intent to drill **shall be posted** on each drilling rig;
3. The minimum amount of surface pipe as specified below **shall be set** by circulating cement to the top; in all cases surface pipe shall be set through all unconsolidated materials plus a minimum of 20 feet into the underlying formation.
4. If the well is dry hole, an agreement between the operator and the district office on plug length and placement is necessary **prior to plugging**;
5. The appropriate district office will be notified before well is either plugged or production casing is cemented in;
6. If an ALTERNATE II COMPLETION, production pipe shall be cemented from below any usable water to surface within **120 DAYS** of spud date. Or pursuant to Appendix "B" - Eastern Kansas surface casing order #133,891-C, which applies to the KCC District 3 area, alternate II cementing must be completed within 30 days of the spud date or the well shall be plugged. **In all cases, NOTIFY district office** prior to any cementing.

CONSERVATION DIVISION  
 WICHITA, KS

I hereby certify that the statements made herein are true and correct to the best of my knowledge and belief.

Date: 11-29-07 Signature of Operator or Agent: Jim Goad Title: V.P.

**For KCC Use ONLY**  
 API # 15 - 011-23336-0000  
 Conductor pipe required None feet  
 Minimum surface pipe required 20 feet per ALT.    
 Approved by: fw 12-4-07  
 This authorization expires: 12-4-08  
 (This authorization void if drilling not started within 12 months of approval date.)  
 Spud date: Agent:

**Remember to:**

- File Drill Pit Application (Form CDP-1) with Intent to Drill;
  - File Completion Form ACIO-II within 120 days of spud date;
  - File acreage attribution plat according to field proration orders;
  - Notify appropriate district office 48 hours prior to workover or re-entry;
  - Submit plugging reports (CP-4) after plugging is completed (within 60 days);
  - Obtain written approval before disposing or injecting salt water.
  - If this permit has expired (See: authorized expiration date) please check the box below and return to the address below.
- Well Not Drilled - Permit Expired Date: Signature of Operator or Agent:

19  
27  
22  
 E  
 W

**IN ALL CASES PLOT THE INTENDED WELL ON THE PLAT BELOW**

*Plat of acreage attributable to a well in a prorated or spaced field*

*If the intended well is in a prorated or spaced field, please fully complete this side of the form. If the intended well is in a prorated or spaced field complete the plat below showing that the well will be properly located in relationship to other wells producing from the common source of supply. Please show all the wells and within 1 mile of the boundaries of the proposed acreage attribution unit for gas wells and within 1/2 mile of the boundaries of the proposed acreage attribution unit for oil wells.*

API No. 15 - 011-23336-000  
 Operator: Us Energy LLC  
 Lease: Shireman  
 Well Number: 4 aa  
 Field: unknown

Location of Well: County: Bourbon  
 1,836 feet from  N /  S Line of Section  
 1,250 feet from  E /  W Line of Section  
 Sec. 19 Twp. 27 S. R. 22  E  W

Number of Acres attributable to well: \_\_\_\_\_  
 QTR/QTR/QTR/QTR of acreage: sw - nw - se - se  
sw

Is Section:  Regular or  Irregular

**If Section is Irregular, locate well from nearest corner boundary.**

Section corner used:  NE  NW  SE  SW

**PLAT**

*(Show location of the well and shade attributable acreage for prorated or spaced wells.)*

*(Show footage to the nearest lease- or unit boundary line.)*

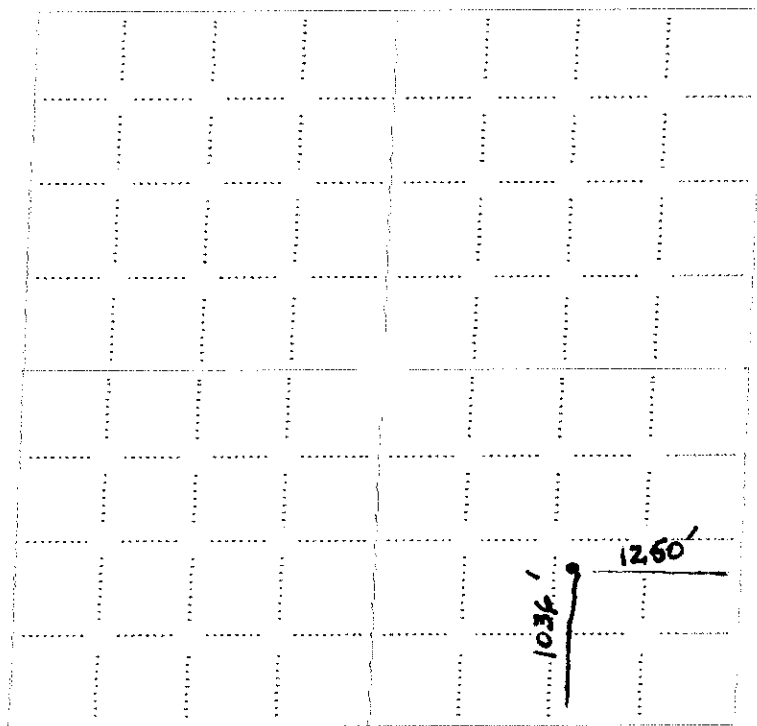

**NOTE: In all cases locate the spot of the proposed drilling location.**

RECEIVED  
 KANSAS CORPORATION COMMISSION

DEC 03 2007

CONSERVATION DIVISION  
 WICHITA, KS

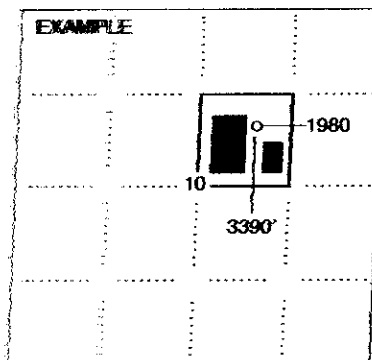

SEWARD CO.

**in plotting the proposed location of the well, you must show:**

- The manner in which you are using the depicted plat by identifying section lines, i.e. 1 section, 1 section with 8 surrounding sections, 4 sections, etc.
- The distance of the proposed drilling location from the south / north and east / west outside section lines.
- The distance to the nearest lease or unit boundary line (in footage).
- If proposed location is located within a prorated or spaced field a certificate of acreage attribution plat must be attached: (CO-7 for oil wells; CG-8 for gas wells).

**KANSAS CORPORATION COMMISSION  
OIL & GAS CONSERVATION DIVISION  
APPLICATION FOR SURFACE PIT**

Form CDP-1  
April 2004  
Form must be Typed

*Submit in Duplicate*

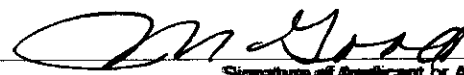
Operator Name: <b>Us Energy LLC</b>		License Number: <b>34019</b>	
Operator Address: <b>20 lakeview St.</b>		<b>Garnett Ks. 66032</b>	
Contact Person: <b>Jim Goad</b>		Phone Number: <b>661-599-0303</b>	
Lease Name & Well No.: <b>Shireman 4 aa</b>		Pit Location (QQQQ): <u>NW NW SE SE</u>	
Type of Pit: <input type="checkbox"/> Emergency Pit <input type="checkbox"/> Burn Pit <input type="checkbox"/> Settling Pit <input checked="" type="checkbox"/> Drilling Pit <input type="checkbox"/> Workover Pit <input type="checkbox"/> Haul-Off Pit <i>(If WP Supply API No. or Year Drilled)</i>	Pit is: <input checked="" type="checkbox"/> Proposed <input type="checkbox"/> Existing If Existing, date constructed: _____  Pit capacity: 150 _____ (bbls)	Sec. <u>19</u> Twp. <u>27</u> R. <u>22</u> <input checked="" type="checkbox"/> East <input type="checkbox"/> West <u>1036</u> Feet from <input type="checkbox"/> North / <input checked="" type="checkbox"/> South Line of Section <u>1250</u> Feet from <input checked="" type="checkbox"/> East / <input type="checkbox"/> West Line of Section <b>Bourbon</b> _____ County	
	Is the pit located in a Sensitive Ground Water Area? <input type="checkbox"/> Yes <input checked="" type="checkbox"/> No		Chloride concentration: _____ mg/l <i>(For Emergency Pits and Settling Pits only)</i>
Is the bottom below ground level? <input checked="" type="checkbox"/> Yes <input type="checkbox"/> No	Artificial Liner? <input type="checkbox"/> Yes <input checked="" type="checkbox"/> No	How is the pit lined if a plastic liner is not used?	
Pit dimensions (all but working pits): <u>20</u> Length (feet) <u>8</u> Width (feet) <input type="checkbox"/> N/A: Steel Pits Depth from ground level to deepest point: <u>4</u> (feet) <input type="checkbox"/> No Pit			
If the pit is lined give a brief description of the liner material, thickness and installation procedure.		Describe procedures for periodic maintenance and determining liner integrity, including any special monitoring.	
Distance to nearest water well within one-mile of pit <u>N/A</u> feet    Depth of water well _____ feet		Depth to shallowest fresh water _____ feet. Source of information: <input type="checkbox"/> measured <input type="checkbox"/> well owner <input type="checkbox"/> electric log <input type="checkbox"/> KDWR	
<b>Emergency, Settling and Burn Pits ONLY:</b> Producing Formation: _____ Number of producing wells on lease: _____ Barrels of fluid produced daily: _____ Does the slope from the tank battery allow all spilled fluids to flow into the pit? <input type="checkbox"/> Yes <input checked="" type="checkbox"/> No		<b>Drilling, Workover and Haul-Off Pits ONLY:</b> Type of material utilized in drilling/workover: _____ Number of working pits to be utilized: _____ Abandonment procedure: <b>air dry backfill</b> Drill pits must be closed within 365 days of spud date.	
I hereby certify that the above statements are true and correct to the best of my knowledge and belief.			
<u>11-29-07</u> Date		 Signature of Applicant or Agent	

15-011-23336-000

RECEIVED  
KANSAS CORPORATION COMMISSION  
DEC 03 2007  
CONSERVATION DIVISION  
WICHITA, KS

<b>KCC OFFICE USE ONLY</b>		Steel Pit <input type="checkbox"/>	RFAC <input type="checkbox"/>	RFAS <input type="checkbox"/>
Date Received: <u>12/3/07</u>	Permit Number: _____	Permit Date: <u>12/3/07</u>	Lease Inspection: <input type="checkbox"/> Yes <input checked="" type="checkbox"/> No	

Mail to: KCC - Conservation Division, 130 S. Market - Room 2078, Wichita, Kansas 67202