

For KCC Use: 12-11-07  
 Effective Date: 12-11-07  
 District # 3  
 SGA?  Yes  No

KANSAS CORPORATION COMMISSION  
 OIL & GAS CONSERVATION DIVISION

Form C-1  
 December 2002  
**Form must be Typed**  
**Form must be Signed**  
**All blanks must be Filled**

**NOTICE OF INTENT TO DRILL**

Must be approved by KCC five (5) days prior to commencing well

Expected Spud Date January 2, 2008  
 month day year

Spot S/2 - NW Sec. 16 Twp. 31 S. R. 19  East  West  
1980 feet from  N /  S Line of Section  
1320 feet from  E /  W Line of Section  
 Is SECTION  Regular  Irregular?

OPERATOR: License# 33344  
 Name: Quest Cherokee LLC  
 Address: 210 Park Avenue, Suite 2750  
 City/State/Zip: Oklahoma City Oklahoma 73102  
 Contact Person: Richard Marlin  
 Phone: 405-702-7480

(Note: Locate well on the Section Plat on reverse side)  
 County: Labeite  
 Lease Name: O'Connor Trust Well #: 16-2  
 Field Name: Cherokee Basin CBM

CONTRACTOR: License# Will be licensed by the KCC  
 Name: Will advise on the ACO-1

Is this a Prorated / Spaced Field?  Yes  No  
 Target Formation(s): Cherokee Coal  
 Nearest Lease or unit boundary: 575

Well Drilled For: Well Class: Type Equipment:  
 Oil  Enh Rec  Infield  Mud Rotary  
 Gas  Storage  Pool Ext.  Air Rotary  
 OWWO  Disposal  Wildcat  Cable  
 Seismic: # of Holes  Other  
 Other: Coalbed Methane

Ground Surface Elevation: 909 feet MSL  
 Water well within one-quarter mile:  Yes  No  
 Public water supply well within one mile:  Yes  No

If OWWO: old well information as follows:  
 Operator: \_\_\_\_\_  
 Well Name: \_\_\_\_\_  
 Original Completion Date: \_\_\_\_\_ Original Total Depth: \_\_\_\_\_

Depth to bottom of fresh water: N/A 100  
 Depth to bottom of usable water: N/A 150  
 Surface Pipe by Alternate:  1  2

Directional, Deviated or Horizontal wellbore?  Yes  No  
 If Yes, true vertical depth: \_\_\_\_\_  
 Bottom Hole Location: \_\_\_\_\_  
 KCC DKT #: \_\_\_\_\_

Length of Surface Pipe Planned to be set: 25  
 Length of Conductor Pipe required: \_\_\_\_\_  
 Projected Total Depth: 1100  
 Formation at Total Depth: Cherokee Coals

Water Source for Drilling Operations:  
 Well  Farm Pond Other Air  
 DWR Permit #: \_\_\_\_\_

(Note: Apply for Permit with DWR )  
 Will Cores be taken?  Yes  No  
 If Yes, proposed zone: \_\_\_\_\_

**AFFIDAVIT**

RECEIVED  
 KANSAS CORPORATION COMMISSION

The undersigned hereby affirms that the drilling, completion and eventual plugging of this well will comply with K.S.A. 55 et. seq.  
 It is agreed that the following minimum requirements will be met:

DEC 06 2007

1. Notify the appropriate district office **prior** to spudding of well;
2. A copy of the approved notice of intent to drill **shall be** posted on each drilling rig;
3. The minimum amount of surface pipe as specified below **shall be set** by circulating cement to the top; in all cases surface pipe **shall be set** through all unconsolidated materials plus a minimum of 20 feet into the underlying formation.
4. If the well is dry hole, an agreement between the operator and the district office on plug length and placement is necessary **prior to plugging**;
5. The appropriate district office will be notified before well is either plugged or production casing is cemented in;
6. If an ALTERNATE II COMPLETION, production pipe shall be cemented from below any usable water to surface within **120 days** of spud date.  
 Or pursuant to Appendix "B" - Eastern Kansas surface casing order #133,891-C, which applies to the KCC District 3 area, alternate II cementing must be completed within 30 days of the spud date or the well shall be plugged. **In all cases, NOTIFY district office** prior to any cementing.

CONSERVATION DIVISION  
 WICHITA, KS

I hereby certify that the statements made herein are true and to the best of my knowledge and belief.  
 Date: December 4, 2007 Signature of Operator or Agent: Richard Marlin Title: Vice President

**For KCC Use ONLY**  
 API # 15 - 099-24240-0000  
 Conductor pipe required None feet  
 Minimum surface pipe required 20 feet per Alt. 102  
 Approved by: KW 12-10-07  
 This authorization expires: 12-6-08  
 (This authorization void if drilling not started within 1/2 months of approval date.)  
 Spud date: \_\_\_\_\_ Agent: \_\_\_\_\_

**Remember to:**  
 - File Drill Pit Application (form CDP-1) with Intent to Drill;  
 - File Completion Form ACO-1 within 120 days of spud date;  
 - File acreage attribution plat according to field proration orders;  
 - Notify appropriate district office 48 hours prior to workover or re-entry;  
 - Submit plugging report (CP-4) after plugging is completed;  
 - Obtain written approval before disposing or injecting salt water.  
 - If this permit has expired (See: authorized expiration date) please check the box below and return to the address below.  
 Well Not Drilled - Permit Expired  
 Signature of Operator or Agent: \_\_\_\_\_  
 Date: \_\_\_\_\_

Mail to: KCC - Conservation Division, 130 S. Market - Room 2078, Wichita, Kansas 67202

16  
 31  
 19E

**IN ALL CASES PLOT THE INTENDED WELL ON THE PLAT BELOW**

*Plat of acreage attributable to a well in a prorated or spaced field*

**If the intended well is in a prorated or spaced field, please fully complete this side of the form.** If the intended well is in a prorated or spaced field complete the plat below showing that the well will be properly located in relationship to other wells producing from the common source of supply. Please show all the wells and within 1 mile of the boundaries of the proposed acreage attribution unit for gas wells and within 1/2 mile of the boundaries of the proposed acreage attribution unit for oil wells.

API No. 15 - 099-24240-0000  
Operator: Quest Cherokee LLC  
Lease: O'Connor Trust  
Well Number: 16-2  
Field: Cherokee Basin CBM  
Number of Acres attributable to well: \_\_\_\_\_  
QTR / QTR / QTR of acreage: \_\_\_\_\_ - S/2 - NW

Location of Well: County: Labelle  
1980 feet from  N /  S Line of Section  
1320 feet from  E /  W Line of Section  
Sec. 16 Twp. 31 S. R. 19  East  West

Is Section:  Regular or  Irregular

**If Section is Irregular, locate well from nearest corner boundary.**  
Section corner used:  NE  NW  SE  SW

**PLAT**

*(Show location of the well and shade attributable acreage for prorated or spaced wells.)  
(Show footage to the nearest lease or unit boundary line.)*

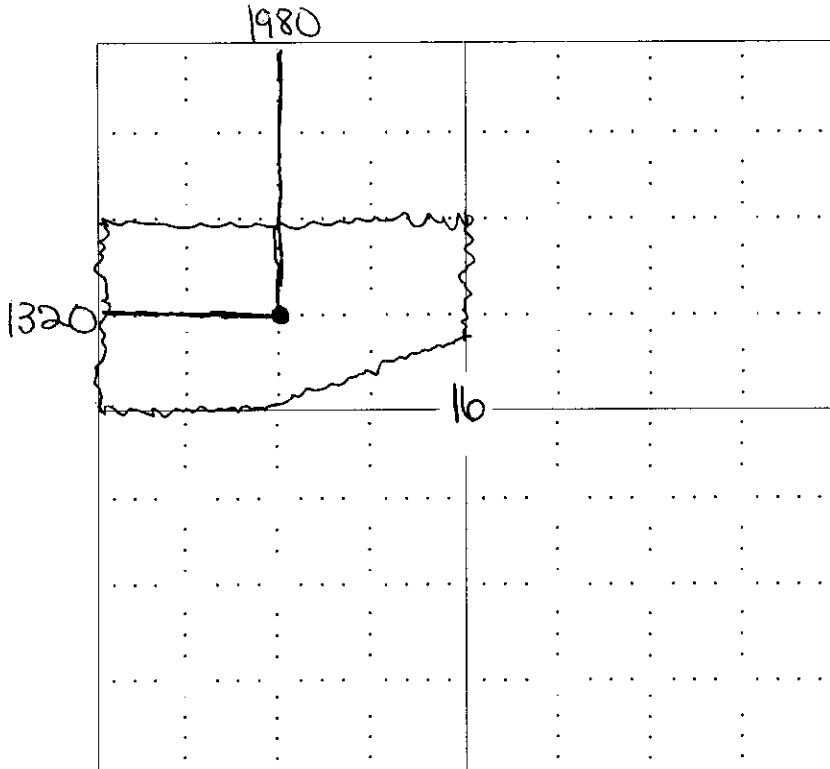

RECEIVED  
KANSAS CORPORATION COMMISSION  
**DEC 06 2007**  
CONSERVATION DIVISION  
WICHITA, KS

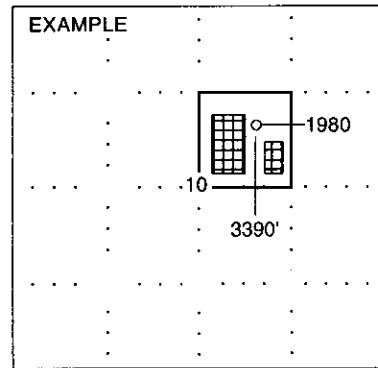

**NOTE: In all cases locate the spot of the proposed drilling locaton.**

**In plotting the proposed location of the well, you must show:**

1. The manner in which you are using the depicted plat by identifying section lines, i.e. 1 section, 1 section with 8 surrounding sections, 4 sections, etc.
2. The distance of the proposed drilling location from the section's south / north and east / west.
3. The distance to the nearest lease or unit boundary line.
4. If proposed location is located within a prorated or spaced field a certificate of acreage attribution plat must be attached: (CO-7 for oil wells; CG-8 for gas wells).

**KANSAS CORPORATION COMMISSION  
OIL & GAS CONSERVATION DIVISION  
APPLICATION FOR SURFACE PIT**

Form CDP-1  
April 2004  
Form must be Typed

*Submit in Duplicate*

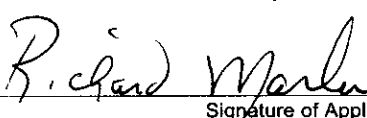
Operator Name: <b>Quest Cherokee LLC</b>		License Number: <b>33344</b>
Operator Address: <b>210 Park Avenue, Suite 2750, Oklahoma City Oklahoma 73102</b>		
Contact Person: <b>Richard Marlin</b>		Phone Number: ( <b>405</b> ) <b>702</b> - <b>7480</b>
Lease Name & Well No.: <b>O'Connor Trust 16-2</b>		Pit Location (QQQQ): _____ S/2 _____ NW
Type of Pit: <input type="checkbox"/> Emergency Pit <input type="checkbox"/> Burn Pit <input type="checkbox"/> Settling Pit <input checked="" type="checkbox"/> Drilling Pit <input type="checkbox"/> Workover Pit <input type="checkbox"/> Haul-Off Pit <small>(If WP Supply API No. or Year Drilled)</small>	Pit is: <input checked="" type="checkbox"/> Proposed <input type="checkbox"/> Existing If Existing, date constructed: _____ Pit capacity: <b>300</b> (bbls)	Sec. <b>16</b> Twp. <b>31</b> R. <b>19</b> <input checked="" type="checkbox"/> East <input type="checkbox"/> West _____ Feet from <input checked="" type="checkbox"/> North / <input type="checkbox"/> South Line of Section <b>1980</b> _____ Feet from <input type="checkbox"/> East / <input checked="" type="checkbox"/> West Line of Section <b>1320</b> <b>Labette</b> _____ County
Is the pit located in a Sensitive Ground Water Area? <input type="checkbox"/> Yes <input checked="" type="checkbox"/> No		Chloride concentration: _____ mg/l <small>(For Emergency Pits and Settling Pits only)</small>
Is the bottom below ground level? <input type="checkbox"/> Yes <input checked="" type="checkbox"/> No	Artificial Liner? <input type="checkbox"/> Yes <input checked="" type="checkbox"/> No	How is the pit lined if a plastic liner is not used?
Pit dimensions (all but working pits): <u>30</u> Length (feet) <u>10</u> Width (feet)    _____ N/A: Steel Pits Depth from ground level to deepest point: <u>10</u> (feet)		
If the pit is lined give a brief description of the liner material, thickness and installation procedure.		Describe procedures for periodic maintenance and determining liner integrity, including any special monitoring.  <b>Air Drilling Operation Lasting Approx 3 Days</b>
Distance to nearest water well within one-mile of pit <u>N/A 3988</u> feet    Depth of water well <u>80</u> feet	Depth to shallowest fresh water <u>14</u> feet. Source of information: _____ measured    _____ well owner    _____ electric log <input checked="" type="checkbox"/> KDWR	
<b>Emergency, Settling and Burn Pits ONLY:</b> Producing Formation: _____ Number of producing wells on lease: _____ Barrels of fluid produced daily: _____ Does the slope from the tank battery allow all spilled fluids to flow into the pit? <input type="checkbox"/> Yes <input type="checkbox"/> No	<b>Drilling, Workover and Haul-Off Pits ONLY:</b> Type of material utilized in drilling/workover: <u>Air -Drilled</u> Number of working pits to be utilized: <u>One</u> Abandonment procedure: <u>Air dry, Back fill and cover</u> _____ Drill pits must be closed within 365 days of spud date.	
I hereby certify that the above statements are true and correct to the best of my knowledge and belief.		<b>RECEIVED</b> KANSAS CORPORATION COMMISSION
<u>December 4, 2007</u> Date	 Signature of Applicant or Agent	<b>DEC 06 2007</b> CONSERVATION DIVISION WICHITA, KS
<b>KCC OFFICE USE ONLY</b>		
Date Received: <u>12/6/07</u> Permit Number: _____ Permit Date: <u>12/6/07</u> Lease Inspection: <input type="checkbox"/> Yes <input checked="" type="checkbox"/> No		

15-099-24240-0000