

For KCC Use: 12-16-07  
 Effective Date: \_\_\_\_\_  
 District # \_\_\_\_\_  
 SGA?  Yes  No

KANSAS CORPORATION COMMISSION  
 OIL & GAS CONSERVATION DIVISION

Form C-1  
 December 2002  
 Form must be Typed  
 Form must be Signed  
 All blanks must be Filled

**NOTICE OF INTENT TO DRILL**

Must be approved by KCC five (5) days prior to commencing well

Expected Spud Date Jan. 2 2008  
month day year

OPERATOR: License# 32016  
 Name: Pioneer Resources  
 Address: 177 W. Limestone Rd.  
 City/State/Zip: Phillipsburg, Kansas 67661  
 Contact Person: Rodger D. Wells  
 Phone: 785-543-5556

CONTRACTOR: License# 33350  
 Name: Southwind Drilling Inc.

Spot  East  
 SE - NW - SW Sec. 36 Twp. 11 S. R. 20  West  
1610 feet from  N /  S Line of Section  
990 feet from  E /  W Line of Section  
 Is SECTION  Regular  Irregular?

(Note: Locate well on the Section Plat on reverse side)

County: Ellis

Lease Name: JoAnn Well #: 1

Field Name: Stella

Is this a Prorated / Spaced Field?  Yes  No

Target Formation(s): Arbuckle

Nearest Lease or unit boundary: 990'

Ground Surface Elevation: 2111 feet MSL

Water well within one-quarter mile:  Yes  No

Public water supply well within one mile:  Yes  No

Depth to bottom of fresh water: 180'

Depth to bottom of usable water: 1100 750'

Surface Pipe by Alternate:  1  2

Length of Surface Pipe Planned to be set: 250'

Length of Conductor Pipe required: \_\_\_\_\_

Projected Total Depth: 3900'

Formation at Total Depth: Arbuckle

Water Source for Drilling Operations:

Well  Farm Pond Other

DWR Permit #: \_\_\_\_\_

(Note: Apply for Permit with DWR )

Will Cores be taken?

If Yes, proposed zone: \_\_\_\_\_

<b>Well Drilled For:</b>	<b>Well Class:</b>	<b>Type Equipment:</b>
<input checked="" type="checkbox"/> Oil	<input type="checkbox"/> Enh Rec	<input checked="" type="checkbox"/> Mud Rotary
<input type="checkbox"/> Gas	<input type="checkbox"/> Storage	<input type="checkbox"/> Air Rotary
<input type="checkbox"/> OWWO	<input type="checkbox"/> Disposal	<input type="checkbox"/> Cable
<input type="checkbox"/> Seismic; # of Holes _____	<input checked="" type="checkbox"/> Wildcat	
<input type="checkbox"/> Other _____	<input type="checkbox"/> Infield	
	<input type="checkbox"/> Pool Ext.	
	<input type="checkbox"/> Other _____	

If OWWO: old well information as follows:

Operator: \_\_\_\_\_

Well Name: \_\_\_\_\_

Original Completion Date: \_\_\_\_\_ Original Total Depth: \_\_\_\_\_

Directional, Deviated or Horizontal wellbore?  Yes  No

If Yes, true vertical depth: \_\_\_\_\_

Bottom Hole Location: \_\_\_\_\_

KCC DKT #: \_\_\_\_\_

**AFFIDAVIT**

The undersigned hereby affirms that the drilling, completion and eventual plugging of this well will comply with K.S.A. 55 et. seq.

It is agreed that the following minimum requirements will be met:

1. Notify the appropriate district office **prior** to spudding of well;
2. A copy of the approved notice of intent to drill **shall be posted** on each drilling rig;
3. The minimum amount of surface pipe as specified below **shall be set** by circulating cement to the top; in all cases surface pipe shall be set through all unconsolidated materials plus a minimum of 20 feet into the underlying formation.
4. If the well is dry hole, an agreement between the operator and the district office on plug length and placement is necessary **prior to plugging**;
5. The appropriate district office will be notified before well is either plugged or production casing is cemented in;
6. If an ALTERNATE II COMPLETION, production pipe shall be cemented from below any usable water to surface within **120 days** of spud date. Or pursuant to Appendix "B" - Eastern Kansas surface casing order #133,891-C, which applies to the KCC District 3 area, alternate II cementing must be completed within 30 days of the spud date or the well shall be plugged. **In all cases, NOTIFY district office** prior to any cementing.

I hereby certify that the statements made herein are true and to the best of my knowledge and belief.

Date: 12-7-07 Signature of Operator or Agent: Rodger D. Wells Title: Owner

RECEIVED  
 DEC 10 2007

KCC WICHITA

**For KCC Use ONLY**  
 API # 15 - 051-25712-0000  
 Conductor pipe required None feet  
 Minimum surface pipe required 200 feet per Alt. **K2**  
 Approved by: fw-12-11-07  
 This authorization expires: 12-11-08  
 (This authorization void if drilling not started within 12 months of approval date.)  
 Spud date: \_\_\_\_\_ Agent: \_\_\_\_\_

**Remember to:**

- File Drill Pit Application (form CDP-1) with Intent to Drill;
- File Completion Form ACO-1 within 120 days of spud date;
- File acreage attribution plat according to field proration orders;
- Notify appropriate district office 48 hours prior to workover or re-entry;
- Submit plugging report (CP-4) after plugging is completed;
- Obtain written approval before disposing or injecting salt water.
- If this permit has expired (See: authorized expiration date) please check the box below and return to the address below.

Well Not Drilled - Permit Expired

Signature of Operator or Agent: \_\_\_\_\_

Date: \_\_\_\_\_

Mail to: KCC - Conservation Division, 130 S. Market - Room 2078, Wichita, Kansas 67202

36  
 11  
 2007

**IN ALL CASES PLOT THE INTENDED WELL ON THE PLAT BELOW**

*Plat of acreage attributable to a well in a prorated or spaced field*

*If the intended well is in a prorated or spaced field, please fully complete this side of the form. If the intended well is in a prorated or spaced field complete the plat below showing that the well will be properly located in relationship to other wells producing from the common source of supply. Please show all the wells and within 1 mile of the boundaries of the proposed acreage attribution unit for gas wells and within 1/2 mile of the boundaries of the proposed acreage attribution unit for oil wells.*

API No. 15 - 051-25712-0000  
 Operator: Pioneer Resources  
 Lease: JoAnn  
 Well Number: 1  
 Field: Stella  
 Number of Acres attributable to well: 10  
 QTR / QTR / QTR of acreage: SE - NW - SW

Location of Well: County: Ellis  
1610 feet from  N /  S Line of Section  
990 feet from  E /  W Line of Section  
 Sec. 36 Twp. 11 S. R. 20  East  West

Is Section:  Regular or  Irregular

If Section is Irregular, locate well from nearest corner boundary.  
 Section corner used:  NE  NW  SE  SW

**PLAT**

*(Show location of the well and shade attributable acreage for prorated or spaced wells.)  
 (Show footage to the nearest lease or unit boundary line.)*

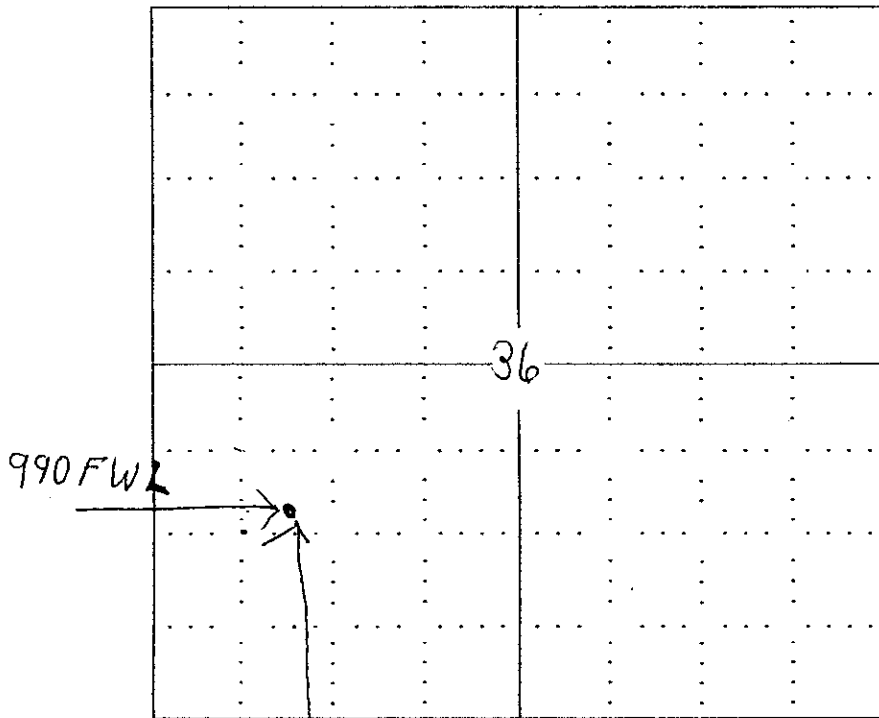

**NOTE: In all cases locate the spot of the proposed drilling location.**

1610 FSL

**In plotting the proposed location of the well, you must show:**

1. The manner in which you are using the depicted plat by identifying section lines, i.e. 1 section, 1 section with 8 surrounding sections, 4 sections, etc.
2. The distance of the proposed drilling location from the section's south / north and east / west.
3. The distance to the nearest lease or unit boundary line.
4. If proposed location is located within a prorated or spaced field a certificate of acreage attribution plat must be attached: (CO-7 for oil wells; CG-8 for gas wells).

RECEIVED  
 DEC 10 2007  
 KCC WICHITA

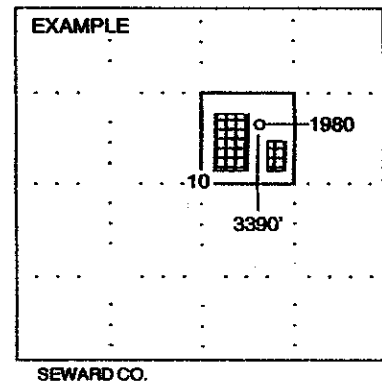

KANSAS CORPORATION COMMISSION  
OIL & GAS CONSERVATION DIVISION

Form CDP-1  
April 2004  
Form must be Typed

APPLICATION FOR SURFACE PIT

Submit in Duplicate

Operator Name: Pioneer Resources		License Number: 32016
Operator Address: 177 W. Limestone Rd. Phillipsburg, Kansas 67661		
Contact Person: Rodger D. Wells		Phone Number: (785) 543-5556
Lease Name & Well No.: JoAnn No.1		Pit Location (QQQQ): SE - SE - NW - SW Sec. 36 Twp. 11 R. 20 <input type="checkbox"/> East <input checked="" type="checkbox"/> West 1610 Feet from <input type="checkbox"/> North / <input checked="" type="checkbox"/> South Line of Section 990 Feet from <input type="checkbox"/> East / <input checked="" type="checkbox"/> West Line of Section Ellis County
Type of Pit: <input type="checkbox"/> Emergency Pit <input type="checkbox"/> Burn Pit <input type="checkbox"/> Settling Pit <input checked="" type="checkbox"/> Drilling Pit <input type="checkbox"/> Workover Pit <input type="checkbox"/> Haul-Off Pit <small>(If WP Supply API No. or Year Drilled)</small>	Pit is: <input checked="" type="checkbox"/> Proposed <input type="checkbox"/> Existing If Existing, date constructed: Pit capacity: (bbls)	
Is the pit located in a Sensitive Ground Water Area? <input type="checkbox"/> Yes <input checked="" type="checkbox"/> No		Chloride concentration: _____ mg/l <small>(For Emergency Pits and Settling Pits only)</small>
Is the bottom below ground level? <input checked="" type="checkbox"/> Yes <input type="checkbox"/> No	Artificial Liner? <input checked="" type="checkbox"/> Yes <input type="checkbox"/> No	How is the pit lined if a plastic liner is not used?
Pit dimensions (all but working pits): 80 Length (feet) 40 Width (feet) N/A: Steel Pits Depth from ground level to deepest point: 4 (feet)		
If the pit is lined give a brief description of the liner material, thickness and installation procedure. Plastic pit liner	Describe procedures for periodic maintenance and determining liner integrity, including any special monitoring. Daily inspection	
Distance to nearest water well within one-mile of pit 2365 feet Depth of water well 46 feet	Depth to shallowest fresh water 35 feet. Source of information: _____ measured _____ well owner _____ electric log <input checked="" type="checkbox"/> KDWR	
<b>Emergency, Settling and Burn Pits ONLY:</b> Producing Formation: _____ Number of producing wells on lease: _____ Barrels of fluid produced daily: _____ Does the slope from the tank battery allow all spilled fluids to flow into the pit? <input type="checkbox"/> Yes <input type="checkbox"/> No	<b>Drilling, Workover and Haul-Off Pits ONLY:</b> Type of material utilized in drilling/workover: Mud Number of working pits to be utilized: 3 Abandonment procedure: Air dry & leveled with Mechanical dozer Drill pits must be closed within 365 days of spud date.	
I hereby certify that the above statements are true and correct to the best of my knowledge and belief.  12-7-07 Date		RECEIVED DEC 10 2007 Signature of Applicant or Agent: <i>Rodger D. Wells</i> KCC WICHITA
<b>KCC OFFICE USE ONLY</b>		
Date Received: 12/10/07 Permit Number: _____ Permit Date: 12/10/07 Lease Inspection: <input type="checkbox"/> Yes <input checked="" type="checkbox"/> No		

1505125712-0000