



For KCC Use:  
 Effective Date: 12/25/2007  
 District # 1  
 SGA?  Yes  No

KANSAS CORPORATION COMMISSION 1015027  
 OIL & GAS CONSERVATION DIVISION

Form C-1  
 October 2007

Form must be Typed  
 Form must be Signed  
 All blanks must be Filled

NOTICE OF INTENT TO DRILL

Must be approved by KCC five (5) days prior to commencing well

Expected Spud Date: 01/07/2008  
 month day year

Spot Description:  
 E2 SW Sec. 1 Twp. 33 S. R. 38  E  W  
 (a/a/o/a) 1,320 feet from  N /  S Line of Section  
 1,980 feet from  E /  W Line of Section

OPERATOR: License# 5278  
 Name: EOG Resources, Inc.  
 Address 1: 3817 NW EXPRESSWAY STE 500  
 Address 2:  
 City: OKLAHOMA CITY State: OK Zip: 73112 + 1483  
 Contact Person: Melissa Sturm  
 Phone: 405-246-3234

Is SECTION:  Regular  Irregular?

CONTRACTOR: License# 34000  
 Name: Kenal Mid-Continent, Inc.

(Note: Locate well on the Section Plat on reverse side)  
 County: Stevens  
 Lease Name: Savage Heirs Well #: 1 #1  
 Field Name: Gentzler

Is this a Prorated / Spaced Field?  Yes  No

Target Formation(s): Upper Morrow

Nearest Lease or unit boundary line (in footage): 1320

Ground Surface Elevation: 3147 feet MSL

Water well within one-quarter mile:  Yes  No

Public water supply well within one mile:  Yes  No

Depth to bottom of fresh water: 540

Depth to bottom of usable water: 540

Surface Pipe by Alternate:  I  II

Length of Surface Pipe Planned to be set: 1700

Length of Conductor Pipe (if any): 40

Projected Total Depth: 6500

Formation at Total Depth: St. Louis

Water Source for Drilling Operations:

Well  Farm Pond  Other:

DWR Permit #: (Note: Apply for Permit with DWR )

Will Cores be taken?  Yes  No

If Yes, proposed zone:

Well Drilled For: Well Class: Type Equipment:  
 Oil  Enh Rec  Infield  Mud Rotary  
 Gas  Storage  Pool Ext.  Air Rotary  
 Seismic; # of Holes  Wildcat  Cable  
 Other:

If OWWO: old well information as follows:

Operator:

Well Name:

Original Completion Date: Original Total Depth:

Directional, Deviated or Horizontal wellbore?  Yes  No

If Yes, true vertical depth:

Bottom Hole Location:

KCC DKT #:

PRORATED & SPACED: HUGOTON-PANOMA

AFFIDAVIT

The undersigned hereby affirms that the drilling, completion and eventual plugging of this well will comply with K.S.A. 55 et. seq.

It is agreed that the following minimum requirements will be met:

1. Notify the appropriate district office **prior** to spudding of well;
2. A copy of the approved notice of intent to drill **shall be** posted on each drilling rig;
3. The minimum amount of surface pipe as specified below **shall be set** by circulating cement to the top; in all cases surface pipe **shall be set** through all unconsolidated materials plus a minimum of 20 feet into the underlying formation.
4. If the well is dry hole, an agreement between the operator and the district office on plug length and placement is necessary **prior to plugging**;
5. The appropriate district office will be notified before well is either plugged or production casing is cemented in;
6. If an ALTERNATE II COMPLETION, production pipe shall be cemented from below any usable water to surface within **120 DAYS** of spud date. Or pursuant to Appendix "B" - Eastern Kansas surface casing order #133,891-C, which applies to the KCC District 3 area, alternate II cementing must be completed within 30 days of the spud date or the well shall be plugged. **In all cases, NOTIFY district office** prior to any cementing.

Submitted Electronically

**For KCC Use ONLY**  
 API # 15-189-22631-00-00  
 Conductor pipe required 0 feet  
 Minimum surface pipe required 560 feet per ALT  I  II  
 Approved by: Rick Hestermann 12/20/2007  
 This authorization expires: 12/20/2008  
 (This authorization void if drilling not started within 12 months of approval date.)  
 Spud date: Agent:

Remember to:

- File Drill Pit Application (form CDP-1) with Intent to Drill;
- File Completion Form ACO-1 within 120 days of spud date;
- File acreage attribution plat according to field proration orders;
- Notify appropriate district office 48 hours prior to workover or re-entry;
- Submit plugging report (CP-4) after plugging is completed (within 60 days);
- Obtain written approval before disposing or injecting salt water.
- If this permit has expired (See: authorized expiration date) please check the box below and return to the address below.

Well Not Drilled - Permit Expired Date: Signature of Operator or Agent:

1  
33  
38  
 E  
 W



1015027

### IN ALL CASES PLOT THE INTENDED WELL ON THE PLAT BELOW

*Plat of acreage attributable to a well in a prorated or spaced field*

**If the intended well is in a prorated or spaced field, please fully complete this side of the form.** If the intended well is in a prorated or spaced field complete the plat below showing that the well will be properly located in relationship to other wells producing from the common source of supply. Please show all the wells and within 1 mile of the boundaries of the proposed acreage attribution unit for gas wells and within 1/2 mile of the boundaries of the proposed acreage attribution unit for oil wells.

API No. 15 - 15-189-22631-00-00 \_\_\_\_\_  
 Operator: EOG Resources, Inc. \_\_\_\_\_  
 Lease: Savage Heirs \_\_\_\_\_  
 Well Number: 1 #1 \_\_\_\_\_  
 Field: Gentzler \_\_\_\_\_

Location of Well: County: Stevens \_\_\_\_\_  
 1,320 \_\_\_\_\_ feet from  N /  S Line of Section  
 1,980 \_\_\_\_\_ feet from  E /  W Line of Section  
 Sec. 1 \_\_\_\_\_ Twp. 33 \_\_\_\_\_ S. R. 38 \_\_\_\_\_  E  W

Number of Acres attributable to well: \_\_\_\_\_  
 QTR/QTR/QTR/QTR of acreage: \_\_\_\_\_ - \_\_\_\_\_ - E2 - SW

Is Section:  Regular or  Irregular

**If Section is Irregular, locate well from nearest corner boundary.**  
 Section corner used:  NE  NW  SE  SW

### PLAT

*(Show location of the well and shade attributable acreage for prorated or spaced wells.)  
 (Show footage to the nearest lease or unit boundary line.)*

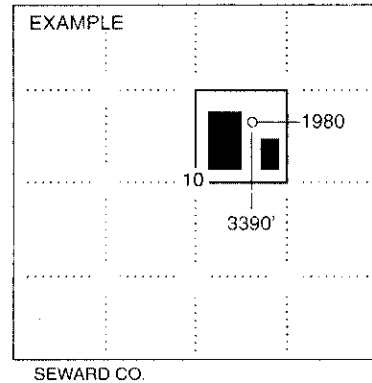
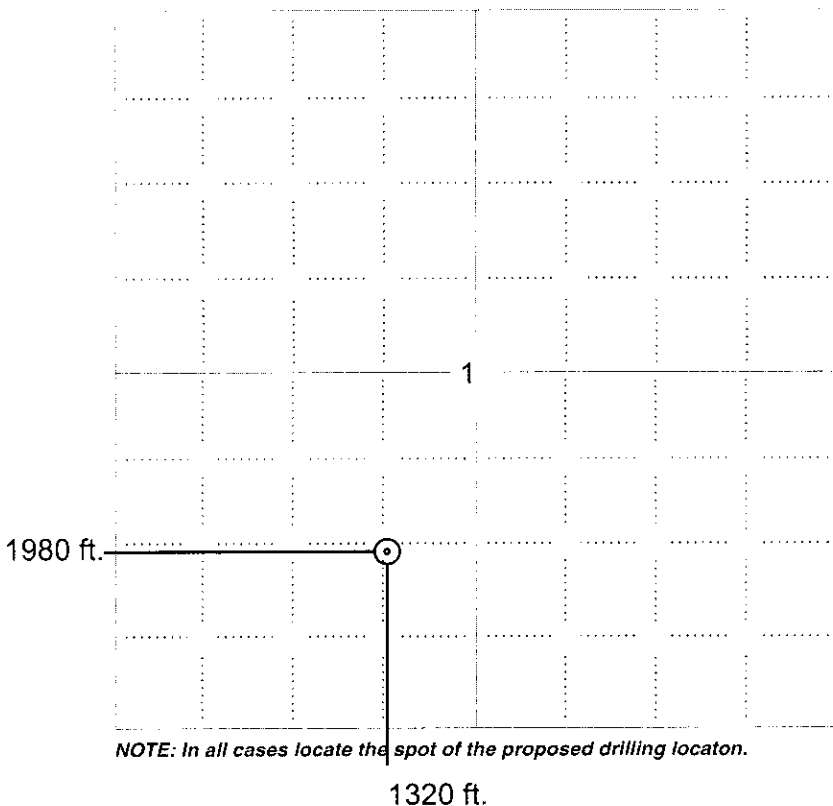

**NOTE: In all cases locate the spot of the proposed drilling locaton.**

**In plotting the proposed location of the well, you must show:**

1. The manner in which you are using the depicted plat by identifying section lines, i.e. 1 section, 1 section with 8 surrounding sections, 4 sections, etc.
2. The distance of the proposed drilling location from the south / north and east / west outside section lines.
3. The distance to the nearest lease or unit boundary line (in footage).
4. If proposed location is located within a prorated or spaced field a certificate of acreage attribution plat must be attached: (C0-7 for oil wells; CG-8 for gas wells).



KANSAS CORPORATION COMMISSION 1015027  
OIL & GAS CONSERVATION DIVISION

Form CDP-1  
April 2004  
Form must be Typed

APPLICATION FOR SURFACE PIT

Submit in Duplicate

Operator Name: EOG Resources, Inc.		License Number: 5278	
Operator Address: 3817 NW EXPRESSWAY STE 500		OKLAHOMA CITY OK 73112	
Contact Person: Melissa Sturm		Phone Number: 405-246-3234	
Lease Name & Well No.: Savage Heirs 1 #1		Pit Location (QQQQ): E2 SW	
Type of Pit: <input type="checkbox"/> Emergency Pit <input type="checkbox"/> Burn Pit <input type="checkbox"/> Settling Pit <input checked="" type="checkbox"/> Drilling Pit <input type="checkbox"/> Workover Pit <input type="checkbox"/> Haul-Off Pit <small>(If WP Supply API No. or Year Drilled)</small>		Pit is: <input checked="" type="checkbox"/> Proposed <input type="checkbox"/> Existing If Existing, date constructed: _____ Pit capacity: 12,500 (bbls)	
Is the pit located in a Sensitive Ground Water Area? <input checked="" type="checkbox"/> Yes <input type="checkbox"/> No		Chloride concentration: _____ mg/l <small>(For Emergency Pits and Settling Pits only)</small>	
Is the bottom below ground level? <input checked="" type="checkbox"/> Yes <input type="checkbox"/> No		Artificial Liner? <input type="checkbox"/> Yes <input checked="" type="checkbox"/> No	
How is the pit lined if a plastic liner is not used? Soil compaction			
Pit dimensions (all but working pits): 125 Length (feet) 125 Width (feet) <input type="checkbox"/> N/A: Steel Pits Depth from ground level to deepest point: 5 (feet) <input type="checkbox"/> No Pit			
If the pit is lined give a brief description of the liner material, thickness and installation procedure.		Describe procedures for periodic maintenance and determining liner integrity, including any special monitoring.	
Distance to nearest water well within one-mile of pit 953 feet    Depth of water well 400 feet		Depth to shallowest fresh water 245 feet. Source of information: <input type="checkbox"/> measured <input type="checkbox"/> well owner <input type="checkbox"/> electric log <input checked="" type="checkbox"/> KDWR	
<b>Emergency, Settling and Burn Pits ONLY:</b> Producing Formation: _____ Number of producing wells on lease: _____ Barrels of fluid produced daily: _____ Does the slope from the tank battery allow all spilled fluids to flow into the pit? <input type="checkbox"/> Yes <input type="checkbox"/> No		<b>Drilling, Workover and Haul-Off Pits ONLY:</b> Type of material utilized in drilling/workover: Gel Number of working pits to be utilized: 0 Abandonment procedure: Evaporation / dewater and backfilling of reserve pit Drill pits must be closed within 365 days of spud date.	
Submitted Electronically			

<b>KCC OFFICE USE ONLY</b>		Steel Pit <input type="checkbox"/>	RFAC <input type="checkbox"/>	RFAS <input type="checkbox"/>
Date Received: 12/19/2007	Permit Number: 15-189-22631-00-00	Permit Date: 12/19/2007	Lease Inspection: <input type="checkbox"/> Yes <input checked="" type="checkbox"/> No	

Mail to: KCC - Conservation Division, 130 S. Market - Room 2078, Wichita, Kansas 67202