

For KCC Use:

Effective Date: 12-31-07

District # 4

SGA? Yes No

KANSAS CORPORATION COMMISSION OIL & GAS CONSERVATION DIVISION

NOTICE OF INTENT TO DRILL

Must be approved by KCC five (5) days prior to commencing well

Form C-1

December 2002

Form must be Typed

Form must be Signed

All blanks must be Filled

Expected Spud Date 1 3 08
month day year

OPERATOR: License# 33325
Name: Petroleum Development Corporation
Address: 1775 Sherman St. Suite 3000
City/State/Zip: Denver, CO 80203
Contact Person: James Annable
Phone: 303-905-4340

CONTRACTOR: License# 33532
Name: Advanced Drilling Technologies

Well Drilled For:	Well Class:	Type Equipment:
<input type="checkbox"/> Oil	<input type="checkbox"/> Enh Rec	<input checked="" type="checkbox"/> Infield
<input checked="" type="checkbox"/> Gas	<input type="checkbox"/> Storage	<input checked="" type="checkbox"/> Mud Rotary
<input type="checkbox"/> OWWO	<input type="checkbox"/> Disposal	<input type="checkbox"/> Pool Ext.
<input type="checkbox"/> Seismic; # of Holes	<input type="checkbox"/> Other	<input type="checkbox"/> Wildcat
<input type="checkbox"/> Other		<input type="checkbox"/> Cable

If OWWO: old well information as follows:
Operator: NA
Well Name: _____
Original Completion Date: _____ Original Total Depth: _____

Directional, Deviated or Horizontal wellbore? Yes No

If Yes, true vertical depth: _____

Bottom Hole Location: _____

KCC DKT #: _____

Spot NE SW SW Sec. 10 Twp. 3 S. R. 40 East West
1090 feet from N / S Line of Section
990 feet from E / W Line of Section
Is SECTION Regular Irregular?

(Note: Locate well on the Section Plat on reverse side)

County: Cheyenne

Lease Name: Stuart Well #: 14-10

Field Name: Cherry Creek Niobrara Gas Area

Is this a Prorated / Spaced Field? Yes No

Target Formation(s): Niobrara

Nearest Lease or unit boundary: 990'

Ground Surface Elevation: 3362' feet MSL

Water well within one-quarter mile: Yes No

Public water supply well within one mile: Yes No

Depth to bottom of fresh water: 150' / 100'

Depth to bottom of usable water: 150' / 100'

Surface Pipe by Alternate: 1 2

Length of Surface Pipe Planned to be set: 200'

Length of Conductor Pipe required: Not Required

Projected Total Depth: 1450'

Formation at Total Depth: Niobrara

Water Source for Drilling Operations:

Well Farm Pond Other X

DWR Permit #: Drilling Contractor will apply.

(Note: Apply for Permit with DWR)

Will Cores be taken? Yes No

If Yes, proposed zone: _____

AFFIDAVIT

The undersigned hereby affirms that the drilling, completion and eventual plugging of this well will comply with K.S.A. 55 et. seq.

It is agreed that the following minimum requirements will be met:

1. Notify the appropriate district office **prior** to spudding of well;
2. A copy of the approved notice of intent to drill **shall be** posted on each drilling rig;
3. The minimum amount of surface pipe as specified below **shall be set** by circulating cement to the top; in all cases surface pipe **shall be set** through all unconsolidated materials plus a minimum of 20 feet into the underlying formation.
4. If the well is dry hole, an agreement between the operator and the district office on plug length and placement is necessary **prior to plugging**;
5. The appropriate district office will be notified before well is either plugged or production casing is cemented in;
6. If an ALTERNATE II COMPLETION, production pipe shall be cemented from below any usable water to surface within **120 days** of spud date.
Or pursuant to Appendix "B" - Eastern Kansas surface casing order #133,891-C, which applies to the KCC District 3 area, alternate II cementing must be completed within 30 days of the spud date or the well shall be plugged. **In all cases, NOTIFY district office** prior to any cementing.

I hereby certify that the statements made herein are true and to the best of my knowledge and belief.

Date: 12/19/07 Signature of Operator or Agent: [Signature] Title: Sr. Regulatory Consultant

For KCC Use ONLY
 API # 15 - 023-20873-00-00
 Conductor pipe required None feet
 Minimum surface pipe required 150 feet per Alt. 1
 Approved by: WJH 12-26-07 OK
 This authorization expires: 12-26-08
 (This authorization void if drilling not started within 12 months of approval date.)
 Spud date: _____ Agent: _____

Remember to:

- File Drill Pit Application (form CDP-1) with Intent to Drill;
- File Completion Form ACO-1 within 120 days of spud date;
- File acreage attribution plat according to field proration orders;
- Notify appropriate district office 48 hours prior to workover or re-entry;
- Submit plugging report (CP-4) after plugging is completed;
- Obtain written approval before disposing or injecting salt water.

- If this permit has expired (See: authorized expiration date) please check the box below and return to the address below.
 Well Not Drilled - Permit Expired
 Signature of Operator or Agent: _____
 Date: _____

10-3-400

RECEIVED
KANSAS CORPORATION COMMISSION

Mail to: KCC - Conservation Division, 130 S. Market - Room 2078, Wichita, Kansas 67202

DEC 21 2007

CONSERVATION DIVISION
WICHITA, KS

IN ALL CASES PLOT THE INTENDED WELL ON THE PLAT BELOW

Plat of acreage attributable to a well in a prorated or spaced field

If the intended well is in a prorated or spaced field, please fully complete this side of the form. If the intended well is in a prorated or spaced field complete the plat below showing that the well will be properly located in relationship to other wells producing from the common source of supply. Please show all the wells and within 1 mile of the boundaries of the proposed acreage attribution unit for gas wells and within 1/2 mile of the boundaries of the proposed acreage attribution unit for oil wells.

API No. 15 - 023-20873-0000
Operator: Petroleum Development Corporation
Lease: Stuart
Well Number: 14-10
Field: Cherry Creek Niobrara Gas Area
Number of Acres attributable to well: NA
QTR / QTR / QTR of acreage: NE - SW - SW

Location of Well: County: Cheyenne
1090 _____ feet from N / S Line of Section
990 _____ feet from E / W Line of Section
Sec. 10 Twp. 3 S. R. 40 East West

Is Section: Regular or Irregular

If Section is Irregular, locate well from nearest corner boundary.
Section corner used: NE NW SE SW

PLAT

*(Show location of the well and shade attributable acreage for prorated or spaced wells.)
(Show footage to the nearest lease or unit boundary line.)*

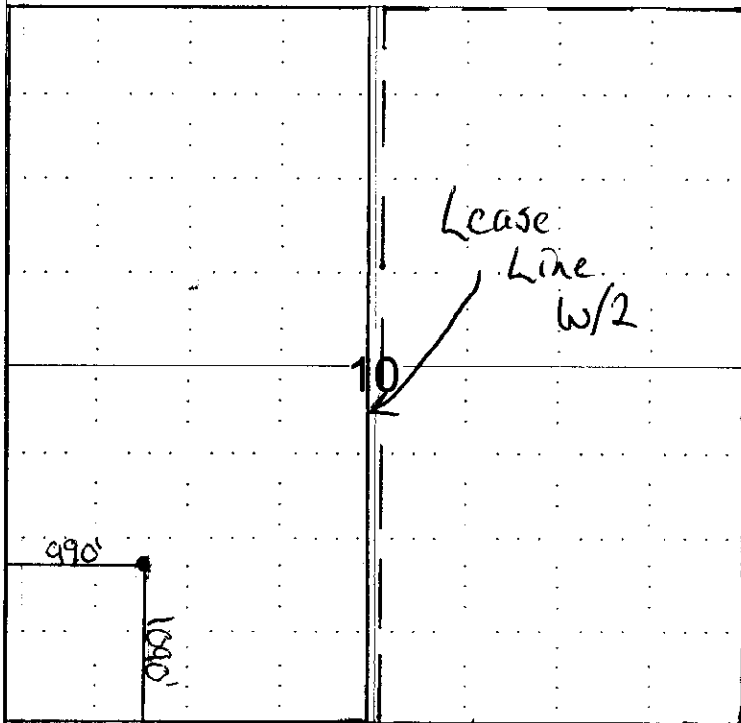

RECEIVED
KANSAS CORPORATION COMMISSION

DEC 2 1 2007

CONSERVATION DIVISION
WICHITA, KS

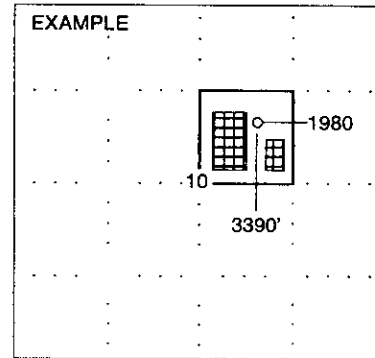

NOTE: In all cases locate the spot of the proposed drilling location.

In plotting the proposed location of the well, you must show:

1. The manner in which you are using the depicted plat by identifying section lines, i.e. 1 section, 1 section with 8 surrounding sections, 4 sections, etc.
2. The distance of the proposed drilling location from the section's south / north and east / west.
3. The distance to the nearest lease or unit boundary line.
4. If proposed location is located within a prorated or spaced field a certificate of acreage attribution plat must be attached: (CO-7 for oil wells; CG-8 for gas wells).

DEC 21 2007

CONSERVATION DIVISION
WICHITA, KS

WELL LOCATION CERTIFICATE

SECTION 10, TOWNSHIP 3 SOUTH, RANGE 40 WEST, 6TH P.M.

NW SEC. 10
FND. #5 REBAR

S 87°24'10" E 5270.86'

NE SEC. 10
SET NAIL

SURFACE LOCATION
GROUND ELEVATION= 3362'
LAT/LONG = 39.80308°
101.80155°

NOTES:
THIS IS A VERTICAL WELL.
LAND SURFACE USE-OPEN FIELD
NO VISIBLE IMPROVEMENTS WITHIN 200'.

10

(BASIS OF BEARINGS)
N 03°03'52" E 5258.91'

S 03°02'14" W 5272.23'

STUART 14-10

990'
1090'

SW SEC. 10
2 1/2" ALUM. CAP
LS 23902

N 87°15'29" W 5273.27'

SE SEC. 10
SET NAIL

I HEREBY STATE TO PETROLEUM DEVELOPMENT CORPORATION THAT THIS WELL LOCATION CERTIFICATE INDICATES THE WELL **STUART 14-10** TO BE LOCATED 1090' FSL AND 990' FWL, SEC. 10, T3S, R40W 6th P.M.

LEGEND

- = FOUND MONUMENT
- = PROPOSED WELL
- = EXISTING WELL



SCALE: 1"=1000'

BASIS OF BEARINGS AS SHOWN ABOVE

GROUND ELEVATION SHOWN IS APPROXIMATE AND IS BASED ON AN OBSERVED GPS ELEVATION (NAVD 1988 DATUM)

LAT. & LONG. SHOWN ARE BASED ON AN OBSERVED GPS OBSERVATION (NAD 1983/92) WITH A PDOP VALUE OF LESS THAN SIX (6)

ALL DISTANCES ARE FIELD MEASURED UNLESS OTHERWISE NOTED
DISTANCES TO WELL ARE SHOWN PERPENDICULAR TO SECTION LINES

R. DAVID RUX, PLS 37045
PETROLEUM FIELD SERVICES, LLC

THIS IS NOT A MONUMENTED BOUNDARY SURVEY, IT IS ONLY A DRAWING INTENDED TO DEPICT THE WELL LOCATION TO SECTION LINES

REVISIONS		PREPARED BY:
INITIAL	DATE	
		<p>Petroleum Field Services, LLC 1801 W. 13th Ave. Denver, CO 80204</p>

FIELD DATE: 12-05-07	WELL NAME: STUART 14-10
DRAWING DATE: 12-10-07	SURFACE LOCATION: CHEYENNE COUNTY, KANSAS SW 1/4 SW 1/4, SEC. 10, T3S, R40W
BY: CAM	

15-023-20073-0000

**KANSAS CORPORATION COMMISSION
OIL & GAS CONSERVATION DIVISION
APPLICATION FOR SURFACE PIT**

Form CDP-1
April 2004
Form must be Typed

Submit in Duplicate

Operator Name: Petroleum Development Corporation		License Number: 33325	
Operator Address: 1775 Sherman St, Suite 3000 Denver, CO 80203			
Contact Person: James Annable		Phone Number: (303) 905 - 4340	
Lease Name & Well No.: Stuart 14-10		Pit Location (QQQQ): _____ NE _____ SW _____ SW Sec. 10 Twp. 3S R. 40 <input type="checkbox"/> East <input checked="" type="checkbox"/> West 1090 Feet from <input type="checkbox"/> North / <input checked="" type="checkbox"/> South Line of Section 990 Feet from <input type="checkbox"/> East / <input checked="" type="checkbox"/> West Line of Section Cheyenne _____ County	
Type of Pit: <input type="checkbox"/> Emergency Pit <input type="checkbox"/> Burn Pit <input type="checkbox"/> Settling Pit <input checked="" type="checkbox"/> Drilling Pit <input type="checkbox"/> Workover Pit <input type="checkbox"/> Haul-Off Pit (If WP Supply API No. or Year Drilled) _____		Pit is: <input checked="" type="checkbox"/> Proposed <input type="checkbox"/> Existing If Existing, date constructed: _____ Pit capacity: 1200 _____ (bbls)	
Is the pit located in a Sensitive Ground Water Area? <input checked="" type="checkbox"/> Yes <input checked="" type="checkbox"/> No		Chloride concentration: _____ mg/l <i>(For Emergency Pits and Settling Pits only)</i>	
Is the bottom below ground level? <input checked="" type="checkbox"/> Yes <input type="checkbox"/> No		Artificial Liner? <input type="checkbox"/> Yes <input checked="" type="checkbox"/> No	
How is the pit lined if a plastic liner is not used? Natural Clay/bentonite			
Pit dimensions (all but working pits): 50 Length (feet) 30 Width (feet) _____ N/A: Steel Pits Depth from ground level to deepest point: 6 (feet)			
If the pit is lined give a brief description of the liner material, thickness and installation procedure. NA		Describe procedures for periodic maintenance and determining liner integrity, including any special monitoring. NA	
Distance to nearest water well within one-mile of pit 3500 feet Depth of water well 23 feet		Depth to shallowest fresh water 10 feet. <input checked="" type="checkbox"/> Source of information: _____ measured _____ well owner _____ electric log <input checked="" type="checkbox"/> KDWR	
Emergency, Settling and Burn Pits ONLY: Producing Formation: _____ Number of producing wells on lease: _____ Barrels of fluid produced daily: _____ Does the slope from the tank battery allow all spilled fluids to flow into the pit? <input type="checkbox"/> Yes <input type="checkbox"/> No		Drilling, Workover and Haul-Off Pits ONLY: Type of material utilized in drilling/workover: Bentonite mud Number of working pits to be utilized: 1 Abandonment procedure: Evaporation/backfill _____ Drill pits must be closed within 365 days of spud date.	
I hereby certify that the above statements are true and correct to the best of my knowledge and belief.		RECEIVED KANSAS CORPORATION COMMISSION	
_____ 12/19/07 _____ Date		 Signature of Applicant or Agent	
		DEC 21 2007 CONSERVATION DIVISION WICHITA, KS	
KCC OFFICE USE ONLY			
Date Received: 12/21/07 Permit Number: _____ Permit Date: 12/21/07 Lease Inspection: <input type="checkbox"/> Yes <input checked="" type="checkbox"/> No			

15-023-20873-0080