

15-163-1916S-0600

Give All Information Completely  
Make Required Affidavit  
Mail or Deliver Report to:  
Conservation Division  
State Corporation Commission  
211 No. Broadway  
Wichita, Kansas

WELL PLUGGING RECORD

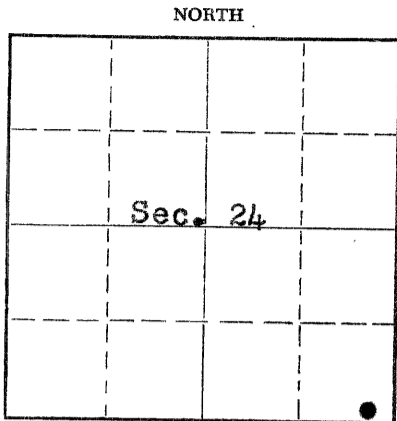

Locate well correctly on above Section Plat

Rooks: \_\_\_\_\_ County. Sec. 24 Twp. 9 Rge. 16 (X) W(W)  
Location as "NE/CNW/SW" or footage from lines SE SE SE  
Lease Owner Petroleum, Inc.  
Lease Name Sarver "C" Well No. 1  
Office Address Route 2, Great Bend, Kansas  
Character of Well (completed as Oil, Gas or Dry Hole) Dry hole  
Date well completed May 11 19 58  
Application for plugging filed May 12 19 58  
Application for plugging approved May 11 19 58  
Plugging commenced May 11 19 58  
Plugging completed May 11 19 58  
Reason for abandonment of well or producing formation No Producing zones

If a producing well is abandoned, date of last production None 19 \_\_\_\_  
Was permission obtained from the Conservation Division or its agents before plugging was commenced? Yes

Name of Conservation Agent who supervised plugging of this well Eldon Petty, Hays, Kansas  
Producing formation \_\_\_\_\_ Depth to top \_\_\_\_\_ Bottom \_\_\_\_\_ Total Depth of Well 3750 Feet  
Show depth and thickness of all water, oil and gas formations.

OIL, GAS OR WATER RECORDS

CASING RECORD

FORMATION	CONTENT	FROM	TO	SIZE	PUT IN	PULLED OUT
				8 5/8"	257'	None

Describe in detail the manner in which the well was plugged, indicating where the mud fluid was placed and the method or methods used in introducing it into the hole. If cement or other plugs were used, state the character of same and depth placed, from \_\_\_\_\_ feet to \_\_\_\_\_ feet for each plug set.

Mud up with heavy mud to 500' followed by a wooden plug and 1/3 sack hulls. Placed 20 sacks cement through drill pipe on to plug. Mud up to 180' followed by wooden plug. Placed 15 sacks cement through drill pipe on to plug. Mud up to 40' followed by a wooden plug and 1/3 sack hulls. Cement to base of well cellar with 10 sacks cement.

STATE CORPORATION COMMISSION  
MAY 17 1958  
CONSERVATION DIVISION  
Wichita, Kansas

5-17-58

Name of Plugging Contractor Garvey Drilling Company  
Address Route 2, Great Bend, Kansas

(If additional description is necessary, use BACK of this sheet)

STATE OF Kansas, COUNTY OF Barton, ss. Don Searle (employee of owner) or (CONTRACTOR) of the above-described well, being first duly sworn on oath, says: That I have knowledge of the facts, statements, and matters herein contained and the log of the above-described well as filed and that the same are true and correct. So help me God.

(Signature) Don Searle  
Route 2, Great Bend, Kansas (Address)

SUBSCRIBED AND SWORN TO before me this 16th day of May 19 58

My commission expires July 11, 1960

Jed L. Bunn  
Notary Public.

PLUGGING  
FILE SEC. 24 T. 9 R. 16 W.  
BOOK PAGE 109 LINE 23

# WELL LOG

15-163-1916S-00-00

COMPANY PETROLEUM, INCORPORATED

SEC. 24 T. 9S R. 16W

FARM SARVER "C" NO. 1

LOC. SE, SE, SE

TOTAL DEPTH 3750'

COUNTY ROOKS CO., KANSAS

COMM. May 2, 1958 COMP. May 11, 1958

CONTRACTOR GARVEY DRILLING COMPANY

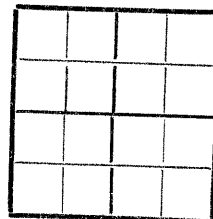

CASING 8 5/8" @ 257' W/175 sax.

ELEVATION 2065' DF

PRODUCTION D & A

FIGURES INDICATE BOTTOM OF FORMATIONS

25	Sand rock
175	Surface clay
200	Clay & shale
258	Blue shale
760	Shale
960	Sand & shale
1268	Red bed & shale
1320	Anhydrite
1980	Shale & shells
2785	Lime & shale
2965	Shale
3056	Lime & shale
3497	Lime
3560	Lime & shale
3622	Lime
3750	Lime & chert (conglomerate)
3750	T. D.

5-17-58

State of KANSAS  
County of BARTON } ss:

PLUGGING  
FILE SEC. 24 T. 9 R. 16W  
BOOK PAGE 100 LINE 23

I, VERNE A. MORRIS of GARVEY DRILLING COMPANY  
upon oath state that the above and foregoing is a true and correct copy of the log of the #1 SARVER "C" well

Subscribed and sworn to before me this 15th day of May 19 58

My Commission Expires: July 11, 1960

Verne A. Morris  
[Signature]  
NOTARY PUBLIC