

15-163-62804-00-00

Give All Information Completely
Make Required Affidavit
Mail or Deliver Report to:
Conservation Division
State Corporation Commission
211 No. Broadway
Wichita, Kansas

WELL PLUGGING RECORD

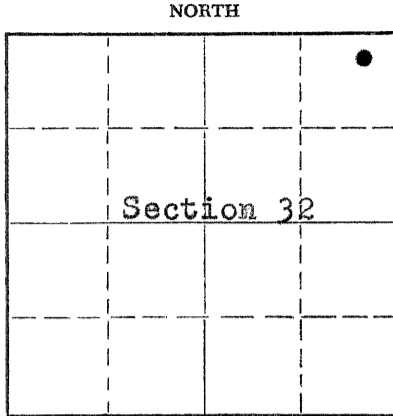

Locate well correctly on above Section Plat

Rocks _____ County. Sec. 32 Twp. 9 Rge. 16 (E) W (W)
Location as "NE/CNW/SW" or footage from lines NE NE NE
Lease Owner Petroleum, Inc.
Lease Name Colohan "B" Well No. 1
Office Address Route 2, Great Bend, Kansas
Character of Well (completed as Oil, Gas or Dry Hole) Dry hole
Date well completed May 3 19 58
Application for plugging filed May 13 19 58
Application for plugging approved May 19 19 58
Plugging commenced July 2 19 58
Plugging completed July 2 19 58
Reason for abandonment of well or producing formation No producible zones

If a producing well is abandoned, date of last production None 19 _____
Was permission obtained from the Conservation Division or its agents before plugging was commenced? Yes

Name of Conservation Agent who supervised plugging of this well Eldon Petty, Hays, Kansas
Producing formation _____ Depth to top _____ Bottom _____ Total Depth of Well 3540 Feet
Show depth and thickness of all water, oil and gas formations.

OIL, GAS OR WATER RECORDS

CASING RECORD

FORMATION	CONTENT	FROM	TO	SIZE	PUT IN	PULLED OUT
Simpson	Water & little oil	3496'	3498'	8 5/8"	275'	None
				4 1/2"	3538'	None
Kansas City	Water & little oil	3376'	3380'			
		3368'	3372'			
		3349'	3353'			
		3294'	3298'			
		3283'	3287'			

Describe in detail the manner in which the well was plugged, indicating where the mud fluid was placed and the method or methods used in introducing it into the hole. If cement or other plugs were used, state the character of same and depth placed, from _____ feet to _____ feet for each plug set.

(Plugged back to 3310')

Globe Oil Well Cementing Company mixed 30 sacks gel and mudded up from 3310' to 600', followed by a plug and pumped in 50 sacks cement to base of well cellar.

(If additional description is necessary, use BACK of this sheet)

Name of Plugging Contractor Petroleum, Inc.
Address Route 2, Great Bend, Kansas

STATE OF Kansas, COUNTY OF Barton, ss.
R. D. Brew (employee of owner) or ~~(owner or operator)~~ of the above-described well, being first duly sworn on oath, says: That I have knowledge of the facts, statements, and matters herein contained and the log of the above-described well as filed and that the same are true and correct. So help me God.

(Signature) R. D. Brew
Route 2, Great Bend, Kansas (Address)

SUBSCRIBED AND SWORN TO before me this 3rd day of July, 19 58

My commission expires July 11, 1960

[Signature] Notary Public.

PLUGGING
FILE SEC 32 T 9 R 16W
BOOK PAGE 101 LINE 17

RECEIVED
STATE CORPORATION COMMISSION

JUL 7 1958

CONSERVATION DIVISION
Wichita, Kansas

WELL LOG

15-163-02804-06-00

COMPANY **PETROLEUM, INCORPORATED**

SEC. 32 T. 9S R. 16W

FARM **COLOHAN "B" NO. 1**

LOC. **NE, NE, NE**

TOTAL DEPTH **3540'**

COUNTY **ROOKS CO., KANSAS**

COMM. **February 18, 1958** COMP. **March 3, 1958**

CONTRACTOR **GARVEY DRILLING COMPANY**

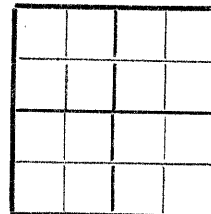

CASING **8 5/8" @ 280' W/200 sax.**
4 1/2" @ 3538' W/600 sax.

ELEVATION **2053' DF**

PRODUCTION

FIGURES INDICATE BOTTOM OF FORMATIONS

40	Clay & post rock
80	Post rock
480	Shale
1050	Sand & pyrite
1258	Red bed
1290	Anhydrite
2160	Shale & shells
2205	Shale & lime
2525	Lime & shale
2930	Shale & lime
3443	Lime
3500	Lime & chert
3508	Simpson
3540	Arbuckle lime
3540	T. D.

RECEIVED
STATE CORPORATION COMMISSION

JUL 7 1958

CONSERVATION DIVISION
Wichita, Kansas

4-7-58

State of KANSAS }
County of BARTON } ss:

PLUGGING
FILE SEC. 32 T. 9 R. 16W
BOOK PAGE 101 LINE 17

I, VERNE A. MORRIS of GARVEY DRILLING COMPANY

upon oath state that the above and foregoing is a true and correct copy of the log of the #1 COLOHAN "B" well

Verne A. Morris

Subscribed and sworn to before me this 1st day of May 19 58

My Commission Expires: July 11, 1960

[Signature]
NOTARY PUBLIC