

STATE OF KANSAS
STATE CORPORATION COMMISSION

Give All Information Completely
M^o Required Affidavit
Mail or Deliver Report to:
Conservation Division,
State Corporation Commission,
800 Bittling Building,
Wichita, Kansas.

15-163-03761-00-00
WELL PLUGGING RECORD

OR

FORMATION PLUGGING RECORD

Strike out upper line
when reporting plug-
ging of formations.

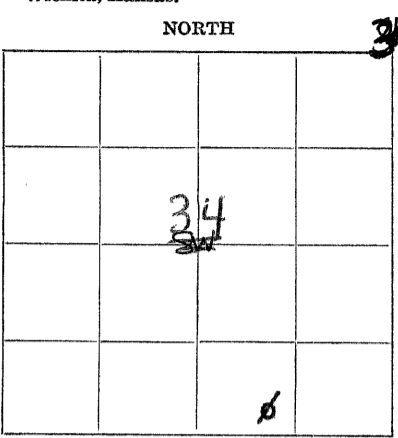

Locate well correctly on above
640 A. Plat

ROOKS County. Sec. 34 Twp. 9 Rge. 16 (E) (W) W
Lease Name. Hoskins
Lease Owner. Yankey-Stearns et al.
Office Address. 4th Natl. Bank Bldg., Wichita Kans.
Character of Well (Oil, Gas or Dry) Oil Total Depth of Well 3596 Feet
Date, well, completed April 26th 1935
Application for plugging and log of well filed..... 193.....
Application for plugging approved..... 193.....
Plugging Commenced..... 193.....
Plugging Completed April 28th. 193 5
Reason for abandonment of well or producing formation No production

If a producing well is abandoned, date of last production..... 193.....
Was permission obtained from the Conservation Division or its agents before plugging was com-
menced? No

Name of Conservation Officer who supervised plugging of this well.....
Producing formation..... Depth to top..... Bottom.....
Show depth and thickness of all water, oil and gas formations.

OIL, GAS OR WATER RECORDS

CASING RECORD

| Formation | Content | From | To | Size | Put In | Pulled Out |
|------------|---------|------|------|--------|---------|------------|
| Slate | | | 57 | 20 | 40.06 | 40.06 |
| Blue Shale | hard | 510 | 520 | 15-1/2 | 520.00 | 520.00 |
| Anhydrite | | 1083 | 1088 | 13-3/8 | 1088.00 | 1088.00 |
| Lime | water | 2225 | 2254 | 10 | 2254.00 | 2254.00 |
| Slate | | 2800 | 2807 | 8-1/4 | 2807.00 | 2807.00 |
| Lime | | 3180 | 3190 | 6-5/8 | 3190.00 | 3190.00 |
| Lime | | | 3446 | 5-3/16 | 3446.00 | 3446.00 |

Describe in detail the manner in which the well was plugged, indicating where the mud fluid was placed and the method or methods used in introducing it into the hole. If cement or other plugs were used, state the character of same and depth placed, from..... feet to..... feet for each plug set.

Cemented with 6 sacks of cement at 140 feet;
Mud to 3446 ft.,
Plug, pine, 5-3/16 set 3446 ft.,
Mud to 3440 ft. Mudded through Oswald formation,
Plug, pine, 6-5/8 at 3190 ft.,
Mud to 3075 ft.,
Plug, pine, 8-1/4 set at 2807 ft.,
Mud to 2760 ft.,
Plug, pine, 10 at 2254 ft.,
Mud to 2200 ft.,
Plug, pine, 13-3/8 set at 1088 ft.,
Mud to 1040 ft.,
Plug, pine, 15-1/2 set at 520 ft.,
Mud to 475 ft.

PLUGGING
FILE SEC 34-9 R16W
BOOK 5-24

Rec'd 12/15/35

(If additional description is necessary use BACK of this sheet)

Does the above conform strictly to the Conservation Division regulations? Approx.
Was exception made?..... If so describe.....
Correspondence regarding this well should be addressed to Yankey-Stearns Leases,
Address 615 Fourth Natl. Bank Bldg., Wichita, Kansas,

STATE OF KANSAS, COUNTY OF SEDGWICK, ss.

R. A. Streeter

(employee of owner) or (owner or operator) of the above-described well,
being first duly sworn on oath, says: That I have knowledge of the facts, statements, and matters herein contained and the log of the above-
described well as filed and that the same are true and correct. So help me God.

(Signature).....

R.A. Streeter

615 Fourth Natl. Bank Bldg.
(Address)

SUBSCRIBED AND SWORN to before me this 29th day of July, 1935.

My commission expires Dec. 15th 1937

STEARNS AND STREETOR.
 Haskins No. 1.

Sec 34 T. 9 R. 16W.

~~SW SE~~

SESWSE

Total Depth. 3596
 Comm. 10-22-34 Comp. 4-26-35
 Shot or Treated.
 Contractor.
 Issued. 5-25-35

15-163-03761-0000
 County. Rocks.
PLUGGING
 FILE SEC 34 T 9 R 16W
 BOOK PAGE 5 LINE 21

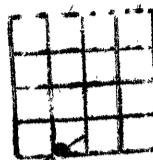

CASING.

20" 40'6 8 1/4" 2635 UR 2807
 15 1/2" 520' UR 690' 65/8" 3081' 3199
 13 3/8" 879' UR 1031' 53/16" 3391'
 10" 2254'

Elevation.

Production. DRY.

Figures Indicate Bottom of Formations.

| | | | | | |
|-------------------------|------|------------------------|------|-------------------------|------|
| cellar | 8 | shale blue | 1625 | shale blue | 2658 |
| slate | 18 | slate blue | 1630 | lime | 2665 |
| slate | 75 | lime shells & slate | 1655 | lime | 2697 |
| mud blue | 90 | lime | 1660 | slate blue | 2702 |
| mud blue | 185 | slate blue | 1675 | lime | 2715 |
| shale blue | 205 | lime broken | 1705 | slate blue | 2733 |
| shale brown | 260 | slate and shells | 1735 | lime | 2745 |
| mud blue | 305 | lime | 1745 | lime shells & slate | 2805 |
| shale blue | 330 | red rock | 1755 | lime | 2813 |
| wdy 1/2 BW 330-340 | 340 | lime | 1796 | slate | 2815 |
| shale blue (10BW375-85) | 375 | slate grey | 1810 | lime white | 2870 |
| sand white | 385 | lime | 1860 | lime white | 2950 |
| shale white | 425 | red rock | 1875 | slate white | 2955 |
| sand white HFW 425-35 | 455 | broken lime | 1915 | lime | 3045 |
| sand | 470 | 1/3BWP 1920-1925 | | shale blue | 3051 |
| shale blue | 480 | lime | 1970 | lime Dodge | 3055 |
| shale blue | 505 | shale blue | 1978 | lime Dodge | 3071 |
| mud yellow | 507 | lime | 1990 | shale blue | 3074 |
| iron caving. | 508 | red rock | 1998 | red rock | 3078 |
| iron | 510 | lime Hole caving some. | 2080 | lime | 3079 |
| shale blue | 520 | lime broken | 2090 | shale blue | 3084 |
| sd shale wh | 530 | red rock | 2105 | Oswald lime | 3084 |
| shale white | 535 | lime | 2130 | 1 BW 3045-55 | |
| shale white | 545 | red rock | 2138 | lime hard | 3093 |
| lime | 550 | lime | 2155 | correction 3095 back to | |
| shale blue | 580 | lime | 2192 | 3093 sh oil 3091 | |
| shale blue | 590 | sand | 2200 | lime soft | 3095 |
| shale brown | 615 | sd lime | 2204 | lime hard | 3110 |
| shale blue | 630 | shale brown | 2235 | slate blue | 3111 |
| sand white | 664 | 3 BWP 2235-2240 | | lime M. | 3120 |
| shale blue | 685 | lime broken | 2260 | lime broken | 3125 |
| lime | 690 | lime | 2290 | lime HFW 3183-86 | 3183 |
| lime & iron | 695 | slate blue | 2300 | sand water | 3185 |
| sand | 700 | shale brown | 2310 | | |
| shale blue | 705 | lime | 2335 | lime | 3230 |
| sand W. | 720 | slate grey | 2345 | slate | 3234 |
| sand | 725 | lime | 2352 | lime | 3247 |
| shale red | 745 | sand | 2365 | lime & shale blue & red | 3255 |
| lime hard | 750 | lime broken | 2377 | lime | 3260 |
| red sand | 760 | lime | 2386 | lime | 3272 |
| sand white | 775 | lime broken | 2405 | shale blk | 3270 |
| sand | 780 | slate blue | 2415 | lime | 3276 |
| red rock | 785 | lime | 2437 | shale | 3231 |
| sand red | 795 | shale brown | 2442 | lime | 3302 |
| sand red | 800 | lime | 2445 | lime broken | 3313 |
| red rock | 940 | shale grey | 2460 | lime hard | 3320 |
| red rock | 1083 | hole caving. | | Hole caving. | |
| white mud anhydrite | 1088 | lime | 2475 | lime broken | 3338 |
| lime | 1128 | slate blue | 2485 | lime hard | 3344 |
| red rock | 1210 | slate and shells | 2505 | shale | 3348 |
| bad hole 1143 | | lime | 2510 | lime hard | 3355 |
| shale brown | 1230 | shale grey | 2517 | conglomerate | 3385 |
| shale blue | 1235 | lime | 2540 | hole caving. | |
| shale brown | 1240 | shale blue | 2580 | conglomerate | 3412 |
| red rock hole cav. | 1315 | hole caving. | | lime | 3420 |
| slate brown | 1350 | slate blk & shells | 2598 | conglomerate | 3423 |
| slate blue | 1450 | fighting cave. | | lime HFW 3452-54 | 3428 |
| slate and shells | 1462 | lime | 2615 | conglomerate | 3452 |
| salt | 1610 | slate and shells | 2635 | lime | 3582 |
| | | | | water sand | 3596 |
| | | | | Total Depth. | |