

STATE OF KANSAS
STATE CORPORATION COMMISSION

WELL PLUGGING RECORD

Give All Information Completely
Make Required Affidavit
Mail or Deliver Report to:
Conservation Division
State Corporation Commission
800 Bittling Building
Wichita, Kansas

Graham County. Sec. 33 Twp. 9S Rge. (E) 21(W)

Location as "NE/CNW/SW" or footage from lines SW SW NW

Lease Owner El Dorado Refining Company

Lease Name Cox Well No. 1

Office Address Wichita, Kansas

Character of Well (completed as Oil, Gas or Dry Hole) Dry

Date well completed 2-23 19 53

Application for plugging filed 2-23 19 53

Application for plugging approved 2-23 19 53

Plugging commenced 2-23 19 53

Plugging completed 2-23 19 53

Reason for abandonment of well or producing formation Dry

If a producing well is abandoned, date of last production Never produced 19

Was permission obtained from the Conservation Division or its agents before plugging was commenced? yes

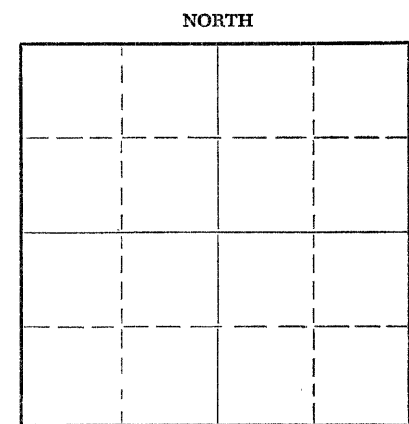

Locate well correctly on above Section Plat

Name of Conservation Agent who supervised plugging of this well Elden Petty

Producing formation Depth to top Bottom Total Depth of Well 3956 Feet

Show depth and thickness of all water, oil and gas formations.

OIL, GAS OR WATER RECORDS

CASING RECORD

FORMATION	CONTENT	FROM	TO	SIZE	PUT IN	PULLED OUT
				8 5/8	240	None

Describe in detail the manner in which the well was plugged, indicating where the mud fluid was placed and the method or methods used in introducing it into the hole. If cement or other plugs were used, state the character of same and depth placed, from feet to feet for each plug set.

1. Filled hole with heavy mud
2. Pushed plug to 235
3. Dumped 1/2 sack hulls on top of plug
4. Mixed 15 sacks cement and dumped on top of hulls
5. Filled hole to top
6. Pushed plug to 40'
7. Dumped in 1/2 sack hulls
8. Mixed 10 sacks cement and filled hole to top with same

3/5/53

Name of Plugging Contractor Jones, Shelburne & Farmer, Inc.
Address Russell, Kansas

STATE OF Kansas, COUNTY OF Russell, ss. John O. Farmer (employee of owner) or (owner or operator) of the above-described well, being first duly sworn on oath, says: That I have knowledge of the facts, statements, and matters herein contained and the log of the above-described well as filed and that the same are true and correct. So help me God.

(Signature) John O. Farmer
Russell, Kansas (Address)

SUBSCRIBED AND SWORN to before me this 24th day of February, 19 53

Bonnie Berryhill Notary Public.

My commission expires April 23, 1956

PLUGGING
FILE SEC 33 T 9 R 2124
BOOK PAGE 81 LINE 10

OPERATOR El Dorado Refining Co.

ADDRESS Wichita, Kansas

FORMATION RECORD

Give detailed description and thickness of all formations drilled through, contents of sand, whether dry, water, oil or gas.

Formation	Top	Bottom	Formation	Top	Bottom
Shale	0	660	TOPS D. F.		
Shale & sand	660	1300	Heebner	3530	
Sand	1300	1480	Dodge	3552	
Shale, Sand, Redbed	1480	1725	Lans	3569	
Shale	1725	1805	Cg.	3862	
Anhydrite	1805	1845	T.D.	3954	
Shale & shells	1845	2250			
Shale	2250	2405			
Shale & shells	2405	2565	Soft 3604-12, foss. ool.		
Shale & lime	2565	3395	poor por. & poor-fair SFO		
Lime & shale	3395	3575			
Lime	3575	3805	DST 3598-3638, op. 1/2 hr.		
Lime & shale	3805	3956	weak blo 6 min., rec.		
			20' mud, BHP 740#		

WELL NO. 1 COUNTY Graham SEC. 33 TWP. 9S RGE. 21W

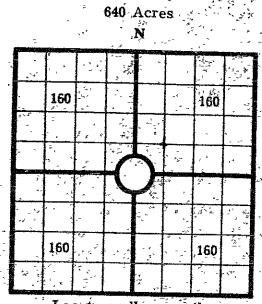

COUNTY Graham SEC. 33 TWP. 9S RGE. 21W
 COMPANY OPERATING El Dorado Refining Co.
 OFFICE ADDRESS Wichita, Kansas
 FARM NAME Cox WELL NO. 1
 DRILLING STARTED 2-13 19 53 DRILLING FINISHED 2-23 19 53
 DATE OF FIRST PRODUCTION _____ COMPLETED _____
 WELL LOCATED SW 1/4 SW 1/4 NE NW 1/4 North of South
 Line and _____ It East of West Line of Quarter Section
 Elevation (Relative to sea level) DERRICK FLOOR 2329 GROUND _____
 CHARACTER OF WELL (Oil, gas or dryhole) Dry

OIL OR GAS SANDS OR ZONES

Name	From	To	Name	From	To
1			4		
2			5		
3			6		

Perforating Record If Any

Shot Record

Formation	From	To	No. of Shots	Formation	From	To	Size of Shot

CASING RECORD

Amount Set				Amount Pulled				Packer Record	
Size	Wt.	Thds.	Make	Ft.	In.	Ft.	In.	Size	Length
8 5/8	24	8	IN	240				none	

Liner Record: Amount _____ Kind _____ Top _____ Bottom _____

CEMENTING AND MUDDING

Size	Amount Set		Sacks Cement	Chemical		Method of Cementing	Amount	Mudding Method	Results (See Note)
	Ft.	In.		Gal.	Make				
8 5/8	240		150						

Note: What method was used to protect sands if outer strings were pulled?

NOTE: Were bottom hole plugs used? If so, state kind, depth set and results obtained

TOOLS USED

Rotary Tools were used from _____ feet to _____ Cable tools were used from _____ feet to _____ feet, and from _____ feet to _____ feet, and from _____ feet to _____ feet.

Type Rig _____

INITIAL PRODUCTION TEST

Describe initial test: whether by flow through tubing or casing or by pumping _____

Amount of Oil Production _____ bbls. Size of choke, if any _____ Length of test _____ Water

Production _____ bbls. Gravity of oil _____ Type of Pump if pump is used, describe _____

PLUGGING
 FILE REC 33 T 9 R 21 W
 BOOK PAGE 81 LINE 10

DIVISION OF COMMISSION
 DIVISION OF DIVISION
 Wichita, Kansas

I, the undersigned, being first duly sworn upon oath, state that this well record is true, correct and complete according to the records of this office and to the best of my knowledge and belief.

John J. Farnice - Pres.
 Name and title of representative of company

Subscribed and sworn to before me this 24th day of February 1953
 My Commission expires April 23, 1956 Donnie Parrish
 Notary Public