

STATE OF KANSAS
STATE CORPORATION COMMISSION

Give All Information Completely
Make Required Affidavit
Mail or Deliver Report to:
Conservation Division
State Corporation Commission
211 No. Broadway
Wichita, Kansas

15-163-02809-0000
WELL PLUGGING RECORD

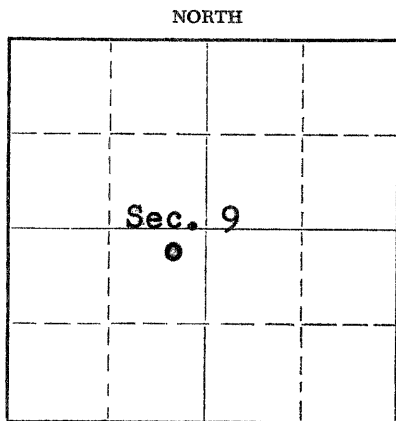

Locate well correctly on above
Section Plat

ROOKS County. Sec. 9 Twp. 9 Rge. 17 (X) W (W)
Location as "NE/CNW/SW" or footage from lines NE NE SW
Lease Owner PETROLEUM, INC.
Lease Name FIKE Well No. 1
Office Address ROUTE 2, GREAT BEND, KANSAS
Character of Well (completed as Oil, Gas or Dry Hole) DRY HOLE
Date well completed April 13, 19 58
Application for plugging filed April 14, 19 58
Application for plugging approved April 13, 19 58
Plugging commenced April 13, 19 58
Plugging completed April 13, 19 58
Reason for abandonment of well or producing formation
No Producing Zones

If a producing well is abandoned, date of last production None 19
Was permission obtained from the Conservation Division or its agents before plugging was commenced? Yes

Name of Conservation Agent who supervised plugging of this well Eldon Petty, Box 326, Hays, Kansas
Producing formation ----- Depth to top -- Bottom --- Total Depth of Well 3501' Feet
Show depth and thickness of all water, oil and gas formations.

OIL, GAS OR WATER RECORDS

CASING RECORD

FORMATION	CONTENT	FROM	TO	SIZE	PUT IN	PULLED OUT
				8-5/8"	279'	None

Describe in detail the manner in which the well was plugged, indicating where the mud fluid was placed and the method or methods used in introducing it into the hole. If cement or other plugs were used, state the character of same and depth placed, from _____ feet to _____ feet for each plug set.

Mud up with heavy mud to 500' pushed down 1/3 sack hulls to 500' followed by wooden plug, placed 20 sacks cement on top of plug. Mud up to 240' placed 1/3 sack hulls at 240' followed by wooden plug, placed 15 sacks cement on top of plug. Mud up to 40', placed 1/3 sack hulls at 40' followed by wooden plug and 10 sacks cement to base of well cellar.

4/15/58
RECEIVED
STATE CORPORATION COMMISSION
APR 19 1958
CONSERVATION DIVISION
Wichita, Kansas

(If additional description is necessary, use BACK of this sheet)
Name of Plugging Contractor GARVEY DRILLING COMPANY
Address ROUTE 2, GREAT BEND, KANSAS

STATE OF KANSAS, COUNTY OF BARTON, ss.
Don Searle (employee of owner) or (~~owner~~) of the above-described well, being first duly sworn on oath, says: That I have knowledge of the facts, statements, and matters herein contained and the log of the above-described well as filed and that the same are true and correct. So help me God.

(Signature) Don Searle
Route 2, Great Bend, Kansas
(Address)

SUBSCRIBED AND SWORN TO before me this 18th day of April, 19 58

My commission expires July 11, 1960
Ed A. Brown
Notary Public.

PLUGGING
FILE NO. 9 T 9 R 17 W
BOOK PAGE 93 LINE 10

WELL LOG

15-163-02809-00-00

COMPANY PETROLEUM, INCORPORATED

SEC. 9 T. 9S R. 17W

FARM FIKE

NO. 1

LOC. NE, NE, SW

TOTAL DEPTH 3501'

COUNTY ROOKS CO., KANSAS

COMM. April 3, 1958

COMP. April 13, 1958

CONTRACTOR GARVEY DRILLING COMPANY

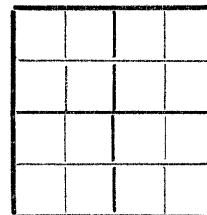

CASING 8 5/8" @ 279' W/150 sax.

ELEVATION 2059' DF

PRODUCTION D & A

FIGURES INDICATE BOTTOM OF FORMATIONS

40	Post rock
200	Gray shale & clay
279	Blue shale
850	Shale
1050	Sand
1180	Red bed & shale
1340	Shale & shells
1385	Anhydrite
1855	Shale & shells
2040	Shale
2150	Shale & shells
2560	Lime & shale
2675	Lime
2845	Lime & shale
3501	Lime
3501	T. D.

4/19/58

RECEIVED
STATE CORPORATION COMMISSION

APR 19 1958

CONSERVATION DIVISION
Geology, Kansas

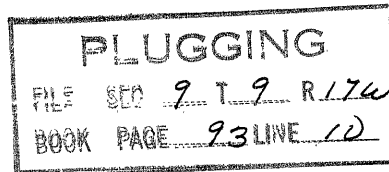

State of KANSAS }
County of BARTON } ss:

I, VERNE A. MORRIS of GARVEY DRILLING COMPANY

upon oath state that the above and foregoing is a true and correct copy of the log of the #1 FIKE well

Verne A. Morris.

Subscribed and sworn to before me this 18th day of April 19 58

My Commission Expires: July 11, 1960

[Signature]
NOTARY PUBLIC