

WELL PLUGGING RECORD

Give All Information Completely
Make Required Affidavit
Mail or Deliver Report to:
Conservation Division
State Corporation Commission
800 Biting Building
Wichita, Kansas

NORTH

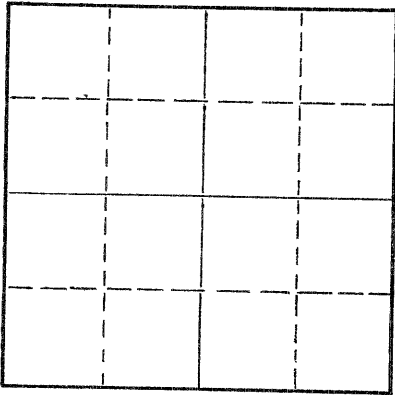

Locate well correctly on above
Section Plat

Rooks County. Sec. 17 Twp. 10 Rge. (E) 20 (W)
Location as "NE/CNW/SW" or footage from lines NE SW NE
Lease Owner Jones, Shelburne & Farmer, Inc.
Lease Name TEALL C Well No. 1
Office Address Russell, Kansas
Character of Well (completed as Oil, Gas or Dry Hole) Dry
Date well completed 11-10 19 55
Application for plugging filed 11-10 19 55
Application for plugging approved 11-10 19 55
Plugging commenced 11-10 19 55
Plugging completed 11-10 19 55
Reason for abandonment of well or producing formation Dry

If a producing well is abandoned, date of last production _____ 19____
Was permission obtained from the Conservation Division or its agents before plugging was commenced? Yes

Name of Conservation Agent who supervised plugging of this well Eldon Petty
Producing formation _____ Depth to top _____ Bottom _____ Total Depth of Well 3870 Feet
Show depth and thickness of all water, oil and gas formations.

OIL, GAS OR WATER RECORDS

CASING RECORD

FORMATION	CONTENT	FROM	TO	SIZE	PUT IN	PULLED OUT
				8-5/8"	166'	None

Describe in detail the manner in which the well was plugged, indicating where the mud fluid was placed and the method or methods used in introducing it into the hole. If cement or other plugs were used, state the character of same and depth placed, from _____ feet to _____ feet for each plug set.

- Filled hole with heavy mud
- Pushed plug to 160'
- Dumped 1/2 sack hulls on top of plug
- Mixed 15 sacks cement and dumped on top of hulls
- Filled hole to top
- Pushed plug to 40'
- Dumped in 1/2 sack hulls
- Mixed 10 sacks cement and filled hole to top with same.

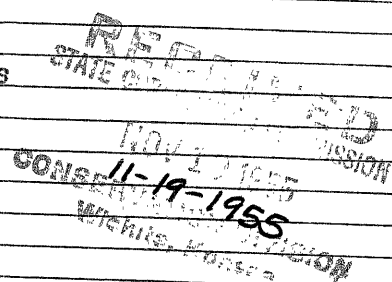

(If additional description is necessary, use BACK of this sheet)
Name of Plugging Contractor Jones, Shelburne & Farmer, Inc.
Address Russell, Kansas

STATE OF Kansas, COUNTY OF Russell, ss. JOHN O. FARMER

(employee of owner) or (owner or operator) of the above-described well, being first duly sworn on oath, says: That I have knowledge of the facts, statements, and matters herein contained and the log of the above-described well as filed and that the same are true and correct. So help me God.

(Signature) John O. Farmer
Russell, Kansas (Address)

SUBSCRIBED AND SWORN TO before me this 16th day of November, 19 55

Luella Kennedy
Notary Public.

My commission expires October 11, 1958

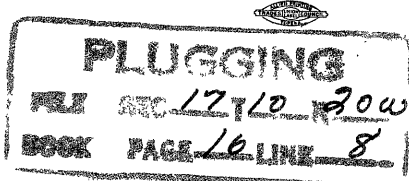

OPERATOR Jones, Shelburne & Farmer, Inc.
ADDRESS Russell, Kansas

15-163-00868-00-50
 FORMATION RECORD

Give detailed description and thickness of all formations drilled through, contents of sand, whether dry, water, oil or gas.

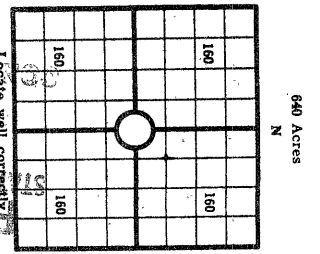

640 Acres
 COUNTY Rooks SEC. 17 TWP. 10 RGE. 20
 COMPANY OPERATING Jones, Shelburne & Farmer, Inc.
 OFFICE ADDRESS Russell, Kansas WELL NO. C #1
 FARM NAME Teall DRILLING STARTED 10-30-55 DRILLING FINISHED 11-9, 1955
 DATE OF FIRST PRODUCTION _____ COMPLETED _____
 WELL LOCATED NE 1/4, SW 1/4, NE 1/4 North of South
 Line and _____ ft. East of West Line of Quarter Section
 Elevation (Relative to sea level) DERRICK FLOOR 2253 ROUND
 CHARACTER OF WELL (Oil, gas or dryhole) dry
 Locate well correctly.

OIL OR GAS SANDS OR ZONES

Name	From	To	Name	From	To
1			4		
2			5		
3			6		

Perforating Record If Any

From	To	No. of Shots	Formation	From	To	Size of Shot

CASING RECORD

Amount Set	Make	Fr.	In.	Fr.	In.	Amount Pulled	Pocket Record
8 5/8	166						

Liner Record: Amount _____ Kind _____ Top _____ Bottom _____
 CEMENTING AND MUDDING

Amount Set	Socks Cement	Chemical Gd.	Method of Cementing	Amount	Mudding Method	Results (See Note)
8 5/8	166	100				

Note: What method was used to protect sands if outer strings were pulled? _____

NOTE: Were bottom hole plugs used? _____ If so, state kind, depth set and results obtained

TOOLS USED

Rotary Tools were used from _____ feet to _____ feet
 Cable tools were used from _____ feet to _____ feet

INITIAL PRODUCTION TEST

Describe initial test: whether by flow through tubing or casing or by pumping _____
 Amount of Oil Production _____ bbls. Size of choke, if any _____ Length of test _____ Water
 Production _____ bbls. Gravity of oil _____ Type of Pump if pump is used, describe _____

Formation	Top	Bottom	Formation	Top	Bottom
Inc.					
Sand & shale	0	166			
Shale	166	750			
Sand & shale	750	1165			
Sand	1165	1460			
Redbed	1460	1734			
Anhydrite	1734	1775			
Shale & shells	1775	2190			
Shale & lime	2190	2440			
Lime & shale	2440	2500			
Shale & lime	2500	2550			
Lime & shale	2550	2890			
Lime	2890	3035			
Shale & lime	3035	3165			
Lime	3165	3795			
Lime & shale	3795	3802			
Conglomerate	3802				

TOPS:

- Elev 2254
- Hebner 3493
- Toronto 3519
- Lansing 3534
- BKC 3757
- Cong. 3802
- T.D. 3870

I, the undersigned, being first duly sworn upon oath, state that this well record is true, correct and complete according to the records of this office and to the best of my knowledge and belief.

Paul James
 Name and title of representative of company

Subscribed and sworn to before me this 15th day of November 19 55
 My Commission expires July 14, 1958
James
 Notary Public.