

STATE CORPORATION COMMISSION OF KANSAS
OIL & GAS CONSERVATION DIVISION

WELL COMPLETION OR RECOMPLETION FORM
ACO-1 WELL HISTORY

DESCRIPTION OF WELL AND LEASE

Operator: License # 5135
Name John O. Farmer, Inc.
Address P.O. Box 352
Russell, KS 67665
City/State/Zip

Purchaser

Operator Contact Person Margaret A. Schulte
Phone (913) 483-3144

Contractor: License # 5135
Name John O. Farmer, Inc.

Wellsite Geologist Blond Farmer
Phone (913) 483-6455

Designate Type of Completion

- New Well Re-Entry Workover
- Oil SWD Temp Abd
- Gas Inj Delayed Comp.
- Dry Other (Core, Water Supply etc.)

If OWWO: old well info as follows:

Operator
Well Name
Comp. Date
Old Total Depth

WELL HISTORY

Drilling Method:

- Mud Rotary Air Rotary Cable

4-3-85 4-9-85 4-9-85
Spud Date Date Reached TD Completion Date
3875'
Total Depth PBD

Amount of Surface Pipe Set and Cemented at 257 feet
Multiple Stage Cementing Collar Used? Yes No
If yes, show depth set feet
If alternate 2 completion, cement circulated from 257 feet depth to surface at 170 SX cmt

INSTRUCTIONS: This form shall be completed in duplicate and filed with the Kansas Corporation Commission, 200 Colorado Derby Building, Wichita, Kansas 67202, within 90 days after completion or recompletion of any well. Rule 82-3-130 and 82-3-107 apply. Information on side two of this form will be held confidential for a period of 12 months if requested in writing and submitted with the form. See rule 82-3-107 for confidentiality in excess of 12 months. One copy of all wireline logs and drillers time log shall be attached with this form. Submit CP-4 form with all plugged wells. Submit CP-111 form with all temporarily abandoned wells.

All requirements of the statutes, rules and regulations promulgated to regulate the oil and gas industry have been fully complied with and the statements herein are complete and correct to the best of my knowledge.

Signature John O. Farmer III
Title Vice-president Date 4-22-85

Subscribed and sworn to before me this 22nd day of April, 1985
Notary Public Margaret A. Schulte
APPOINTED MARGARET A. SCHULTE
Date Commission Expires January 27, 1989

API NO. 15-065-22,149
County Graham
NW SE NW Sec 18 Twp 9S Rge 22W East West

3630 Ft North from Southeast Corner of Section
3630 Ft West from Southeast Corner of Section
(Note: Locate well in section plat below)

Lease Name Ninemire Well # 1
Field Name (Wildcat)

Producing Formation

Elevation: Ground 2389' KB 2394'

Section Plat

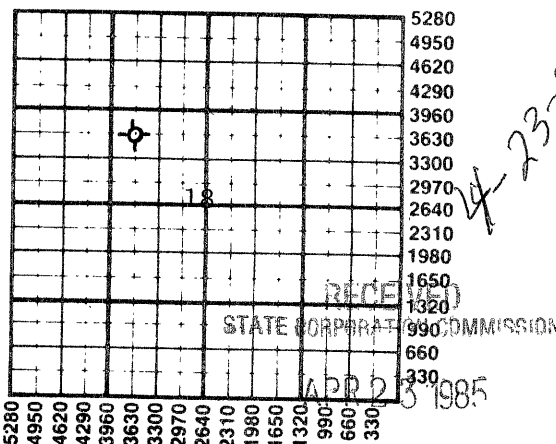

WATER SUPPLY INFORMATION

Disposition of Produced Water: Disposal Repressuring
Docket #

Questions on this portion of the ACO-1 call:
Water Resources Board (913) 296-3717

Source of Water:
Division of Water Resources Permit #
 Groundwater... Ft North from Southeast Corner (Well) ... Ft West from Southeast Corner of Sec Twp Rge East West
 Surface Water 1000 Ft North from Southeast Corner (Stream, pond etc) 200 Ft West from Southeast Corner Sec 14 Twp 9S Rge 23 East West
 Other (explain) (purchased from city, R.W.D. #)

K.C.C. OFFICE USE ONLY
 Letter of Confidentiality Attached
 Wireline Log Received
 Drillers Timelog Received
Distribution
 KCC SWD/Rep NGPA
 KGS Plug Other (Specify)

Sec. 18 Twp. 9 S. Rge. 22 W

SIDE TWO

Operator Name John O. Farmer, Inc Lease Name Ninemire Well # 1

Sec. 18 Twp. 9S Rge. 22W East West County Graham

WELL LOG

INSTRUCTIONS: Show important tops and base of formations penetrated. Detail all cores. Report all drill stem tests giving interval tested, time tool open and closed, flowing and shut-in pressures, whether shut-in pressure reached static level, hydrostatic pressures, bottom hole temperature, fluid recovery, and flow rates if gas to surface during test. Attach extra sheet if more space is needed. Attach copy of log.

Drill Stem Tests Taken Yes No
 Samples Sent to Geological Survey Yes No
 Cores Taken Yes No

Formation Description
 Log Sample

Sand & Shale	675	DST #1 3740-90'
Shale & Sand	1480	Tool open 45-45-15-45'
Sand	1480	1705
Red Bed	1705	1959
Anhydrite	1959	1993
Shale & Shells	1993	2145
Shale	2145	2445
Shale & Lime	2445	3540
Lime & Shale	3540	3700
Lime	3700	3875

Name	Top	Bottom
Anhydrite	1959	(+435)
Base/Anhy.	1993	(+401)
Topeka	3424	(-1030)
Heebner	3639	(-1245)
Toronto	3662	(-1268)
L/KC	3677	(-1283)
R.T.D.	3875	(-1481)

DST #2 3795-3845'
 Tool open 45-45-15-45, very weak blow,
 Rec: 10' mud 45 min.
 IFP: 30-30
 FFP: 30-30
 IBHP: 886
 FBHP: 836

DST #3 3835-75'
 Tool open 45-45-15-45, weak 45"
 Rec: 3' mud
 IFP: 30-30
 FFP: 30-30
 BHP: 50-40

CASING RECORD <input type="checkbox"/> New <input type="checkbox"/> Used							
Report all strings set-conductor, surface, intermediate, production, etc.							
Purpose of String	Size Hole Drilled	Size Casing Set (in O.D.)	Weight Lbs/Ft.	Setting Depth	Type of Cement	#Sacks Used	Type and Percent Additives
Surface	12-1/4"	8-5/8"		257'	60/40 Poz	170	2% gel, 3% C.C.

PERFORATION RECORD		Acid, Fracture, Shot, Cement Squeeze Record	
Shots Per Foot	Specify Footage of Each Interval Perforated	(Amount and Kind of Material Used)	Depth

TUBING RECORD			
Size	Set At	Packer at	Liner Run <input type="checkbox"/> Yes <input type="checkbox"/> No

Date of First Production	Producing Method <input type="checkbox"/> Flowing <input type="checkbox"/> Pumping <input type="checkbox"/> Gas Lift <input type="checkbox"/> Other (explain).....				
	Oil	Gas	Water	Gas-Oil Ratio	Gravity
Estimated Production Per 24 Hours	Bbls	MCF	Bbls	CFPB	

METHOD OF COMPLETION

Production Interval

Disposition of gas: Vented Open Hole Perforation
 Sold Other (Specify)
 Used on Lease Dually Completed
 Commingled