

For KCC Use:
 Effective Date: 1-19-08
 District #: 4
 SGA? Yes No

KANSAS CORPORATION COMMISSION
 OIL & GAS CONSERVATION DIVISION
NOTICE OF INTENT TO DRILL

Form C-1
 December 2002
Form must be Typed
Form must be Signed
All blanks must be Filled

Must be approved by KCC five (5) days prior to commencing well

Expected Spud Date 1 23 08
 month day year

Spot East
 SW NE NE Sec. 8 Twp. 5 S. R. 40 West
740 feet from N / S Line of Section
1100 feet from E / W Line of Section

OPERATOR: License# 33325
 Name: Petroleum Development Corporation
 Address: 1775 Sherman St. Suite 3000
 City/State/Zip: Denver, CO 80203
 Contact Person: James Annable
 Phone: 303-905-4340

Is SECTION Regular Irregular?
 (Note: Locate well on the Section Plat on reverse side)

CONTRACTOR: License# 33532
 Name: Advanced Drilling Technologies

County: Cheyenne
 Lease Name: Culwell Well #: 41-8
 Field Name: Cherry Creek Niobrara Gas Area

Well Drilled For: Oil Enh Rec Infield Mud Rotary
 Gas Storage Pool Ext. Air Rotary
 OWWO Disposal Wildcat Cable
 Seismic; # of Holes Other

Is this a Prorated / Spaced Field? Yes No
 Target Formation(s): Niobrara

Nearest Lease or unit boundary: 740'
 Ground Surface Elevation: 3661' feet MSL

If OWWO: old well information as follows:
 Operator: NA
 Well Name: _____
 Original Completion Date: _____ Original Total Depth: _____

Water well within one-quarter mile: Yes No
 Public water supply well within one mile: Yes No

Depth to bottom of fresh water: 300' 325'
 Depth to bottom of usable water: 300' 325'

Directional, Deviated or Horizontal wellbore? Yes No
 If Yes, true vertical depth: _____
 Bottom Hole Location: _____
 KCC DKT #: _____

Surface Pipe by Alternate: 1 2
 Length of Surface Pipe Planned to be set: 300' 375'

Length of Conductor Pipe required: Not Required
 Projected Total Depth: 1700'
 Formation at Total Depth: Niobrara

Water Source for Drilling Operations:
 Well Farm Pond Other
 DWR Permit #: Drilling Contractor will apply.

(Note: Apply for Permit with DWR)
 Will Cores be taken? Yes No
 If Yes, proposed zone: _____

AFFIDAVIT

RECEIVED
 KANSAS CORPORATION COMMISSION

The undersigned hereby affirms that the drilling, completion and eventual plugging of this well will comply with K.S.A. 55 et. seq.

JAN 11 2008

It is agreed that the following minimum requirements will be met:

CONSERVATION DIVISION

1. Notify the appropriate district office **prior** to spudding of well;
2. A copy of the approved notice of intent to drill **shall be** posted on each drilling rig;
3. The minimum amount of surface pipe as specified below **shall be set** by circulating cement to the top; in all cases surface pipe **shall be set** through all unconsolidated materials plus a minimum of 20 feet into the underlying formation.
4. If the well is dry hole, an agreement between the operator and the district office on plug length and placement is necessary **prior to plugging**;
5. The appropriate district office will be notified before well is either plugged or production casing is cemented in;
6. If an ALTERNATE II COMPLETION, production pipe shall be cemented from below any usable water to surface within **120 days** of spud date. Or pursuant to Appendix "B" - Eastern Kansas surface casing order #133,891-C, which applies to the KCC District 3 area, alternate II cementing must be completed within 30 days of the spud date or the well shall be plugged. **In all cases, NOTIFY district office** prior to any cementing.

I hereby certify that the statements made herein are true and to the best of my knowledge and belief.

Date: 1/9/08 Signature of Operator or Agent: [Signature] Title: Sr. Regulatory Consultant

For KCC Use ONLY
 API # 15 - 023-20932-0000
 Conductor pipe required None feet
 Minimum surface pipe required 375 feet per Alt. 1
 Approved by: [Signature] 1-14-08
 This authorization expires: 1-14-09
 (This authorization void if drilling not started within 1/2 months of approval date.)
 Spud date: _____ Agent: _____

Remember to:

- File Drill Pit Application (form CDP-1) with Intent to Drill;
- File Completion Form ACO-1 within 120 days of spud date;
- File acreage attribution plat according to field proration orders;
- Notify appropriate district office 48 hours prior to workover or re-entry;
- Submit plugging report (CP-4) after plugging is completed;
- Obtain written approval before disposing or injecting salt water.
- If this permit has expired (See: authorized expiration date) please check the box below and return to the address below.

Well Not Drilled - Permit Expired
 Signature of Operator or Agent: _____
 Date: _____

Mail to: KCC - Conservation Division, 130 S. Market - Room 2078, Wichita, Kansas 67202

8
5
40W

IN ALL CASES PLOT THE INTENDED WELL ON THE PLAT BELOW

Plat of acreage attributable to a well in a prorated or spaced field

If the intended well is in a prorated or spaced field, please fully complete this side of the form. If the intended well is in a prorated or spaced field complete the plat below showing that the well will be properly located in relationship to other wells producing from the common source of supply. Please show all the wells and within 1 mile of the boundaries of the proposed acreage attribution unit for gas wells and within 1/2 mile of the boundaries of the proposed acreage attribution unit for oil wells.

API No. 15 - 023-20932-0000
 Operator: Petroleum Development Corporation
 Lease: Culwell
 Well Number: 41-8
 Field: Cherry Creek Niobrara Gas Area

Number of Acres attributable to well: NA
 QTR / QTR / QTR of acreage: SW - NE - NE

Location of Well: County: Cheyenne
 740 feet from N / S Line of Section
 1100 feet from E / W Line of Section
 Sec. 8 Twp. 5 S. R. 40 East West

Is Section: Regular or Irregular

If Section is Irregular, locate well from nearest corner boundary.

Section corner used: NE NW SE SW

PLAT

(Show location of the well and shade attributable acreage for prorated or spaced wells.)

(Show footage to the nearest lease or unit boundary line.)

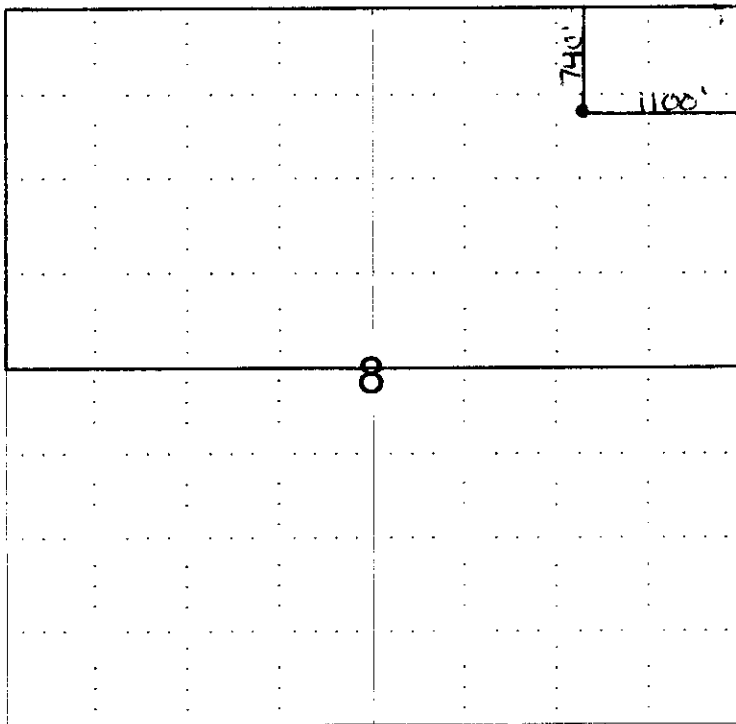

RECEIVED
 KANSAS CORPORATION COMMISSION
 JAN 11 2008
 CONSERVATION DIVISION
 WICHITA, KS

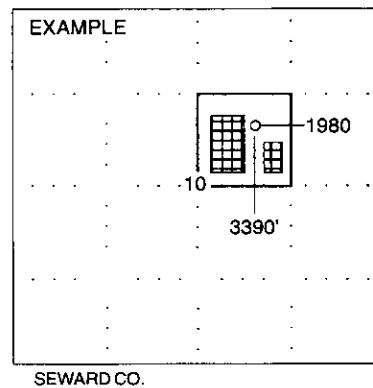

NOTE: In all cases locate the spot of the proposed drilling location.

In plotting the proposed location of the well, you must show:

1. The manner in which you are using the depicted plat by identifying section lines, i.e. 1 section, 1 section with 8 surrounding sections, 4 sections, etc.
2. The distance of the proposed drilling location from the section's south / north and east / west.
3. The distance to the nearest lease or unit boundary line.
4. If proposed location is located within a prorated or spaced field a certificate of acreage attribution plat must be attached: (CO-7 for oil wells; CG-8 for gas wells).

