



For KCC Use:
 Effective Date: 01/20/2008
 District # 3
 SGA? Yes No

KANSAS CORPORATION COMMISSION 1015588
 OIL & GAS CONSERVATION DIVISION

Form C-1
 October 2007
 Form must be Typed
 Form must be Signed
 All blanks must be Filled

NOTICE OF INTENT TO DRILL

Must be approved by KCC five (5) days prior to commencing well

Expected Spud Date: 1/18/2008
 month day year

OPERATOR: License# 31124
 Name: Doty, Tim
 Address 1: PO BOX 117
 Address 2:
 City: SEDAN State: KS Zip: 67361 + 0117
 Contact Person: Tim Doty
 Phone: 620-331-9791

CONTRACTOR: License#
 Name: Advise on ACO-1 -- Must be licensed by KCC

Well Drilled For:	Well Class:	Type Equipment:
<input checked="" type="checkbox"/> Oil	<input type="checkbox"/> Enh Rec	<input checked="" type="checkbox"/> Infield
<input type="checkbox"/> Gas	<input type="checkbox"/> Storage	<input type="checkbox"/> Mud Rotary
<input type="checkbox"/> Seismic	<input type="checkbox"/> Disposal	<input checked="" type="checkbox"/> Air Rotary
<input type="checkbox"/> Other: # of Holes	<input type="checkbox"/> Wildcat	<input type="checkbox"/> Cable
<input type="checkbox"/> Other:	<input type="checkbox"/> Other	

If OWWO: old well information as follows:

Operator:
 Well Name:
 Original Completion Date: Original Total Depth:

Directional, Deviated or Horizontal wellbore? Yes No
 If Yes, true vertical depth:
 Bottom Hole Location:
 KCC DKT #:

Spot Description:
 SE NE SW NE Sec. 6 Twp. 34 S. R. 12 E W
 (0.000) 3,380 feet from N / S Line of Section
 1,350 feet from E / W Line of Section

Is SECTION: Regular Irregular?

(Note: Locate well on the Section Plat on reverse side)

County: Chautauqua
 Lease Name: TDOTGreen Well #: TDOT #1
 Field Name: Peru-Sedan Oil & Gas

Is this a Prorated / Spaced Field? Yes No

Target Formation(s): Wayside Sandstone

Nearest Lease or unit boundary line (in footage): 500

Ground Surface Elevation: 942 feet MSL

Water well within one-quarter mile: Yes No

Public water supply well within one mile: Yes No

Depth to bottom of fresh water: 150

Depth to bottom of usable water: 225

Surface Pipe by Alternate: I II

Length of Surface Pipe Planned to be set: 40

Length of Conductor Pipe (if any):

Projected Total Depth: 1000

Formation at Total Depth: Altamont Limestone

Water Source for Drilling Operations:

Well Farm Pond Other:

DWR Permit #: (Note: Apply for Permit with DWR)

Will Cores be taken? Yes No

If Yes, proposed zone:

AFFIDAVIT

The undersigned hereby affirms that the drilling, completion and eventual plugging of this well will comply with K.S.A. 55 et. seq.

It is agreed that the following minimum requirements will be met:

1. Notify the appropriate district office **prior** to spudding of well;
2. A copy of the approved notice of intent to drill **shall be** posted on each drilling rig;
3. The minimum amount of surface pipe as specified below **shall be set** by circulating cement to the top; in all cases surface pipe **shall be set** through all unconsolidated materials plus a minimum of 20 feet into the underlying formation.
4. If the well is dry hole, an agreement between the operator and the district office on plug length and placement is necessary **prior to plugging**;
5. The appropriate district office will be notified before well is either plugged or production casing is cemented in;
6. If an ALTERNATE II COMPLETION, production pipe shall be cemented from below any usable water to surface within **120 DAYS** of spud date. Or pursuant to Appendix "B" - Eastern Kansas surface casing order #133,891-C, which applies to the KCC District 3 area, alternate II cementing must be completed within 30 days of the spud date or the well shall be plugged. **In all cases, NOTIFY district office** prior to any cementing.

Submitted Electronically

For KCC Use ONLY
 API # 15-019-26870-00-00
 Conductor pipe required 0 feet
 Minimum surface pipe required 40 feet per ALT. I II
 Approved by: Rick Hestermann 01/15/2008
 This authorization expires: 01/15/2009
 (This authorization void if drilling not started within 12 months of approval date.)
 Spud date: Agent:

Remember to:

- File Drill Pit Application (form CDP-1) with Intent to Drill;
- File Completion Form ACO-1 within 120 days of spud date;
- File acreage attribution plat according to field proration orders;
- Notify appropriate district office 48 hours prior to workover or re-entry;
- Submit plugging report (CP-4) after plugging is completed (within 60 days);
- Obtain written approval before disposing or injecting salt water.
- If this permit has expired (See: authorized expiration date) please check the box below and return to the address below.

Well Not Drilled - Permit Expired Date: Signature of Operator or Agent:

6
34
12
 E
 W



1015588

IN ALL CASES PLOT THE INTENDED WELL ON THE PLAT BELOW

Plat of acreage attributable to a well in a prorated or spaced field

If the intended well is in a prorated or spaced field, please fully complete this side of the form. If the intended well is in a prorated or spaced field complete the plat below showing that the well will be properly located in relationship to other wells producing from the common source of supply. Please show all the wells and within 1 mile of the boundaries of the proposed acreage attribution unit for gas wells and within 1/2 mile of the boundaries of the proposed acreage attribution unit for oil wells.

API No. 15 - 15-019-26870-00-00
Operator: Doty, Tim
Lease: TDOTGreen
Well Number: TDOT #1
Field: Peru-Sedan Oil & Gas

Location of Well: County: Chautauqua
3,380 feet from N / S Line of Section
1,350 feet from E / W Line of Section
Sec. 6 Twp. 34 S. R. 12 E W

Number of Acres attributable to well:
QTR/QTR/QTR/QTR of acreage: SE NE SW NE

Is Section: Regular or Irregular

If Section is Irregular, locate well from nearest corner boundary.

Section corner used: NE NW SE SW

PLAT

(Show location of the well and shade attributable acreage for prorated or spaced wells.)

(Show footage to the nearest lease or unit boundary line.)

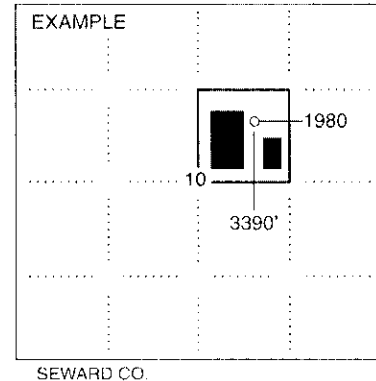
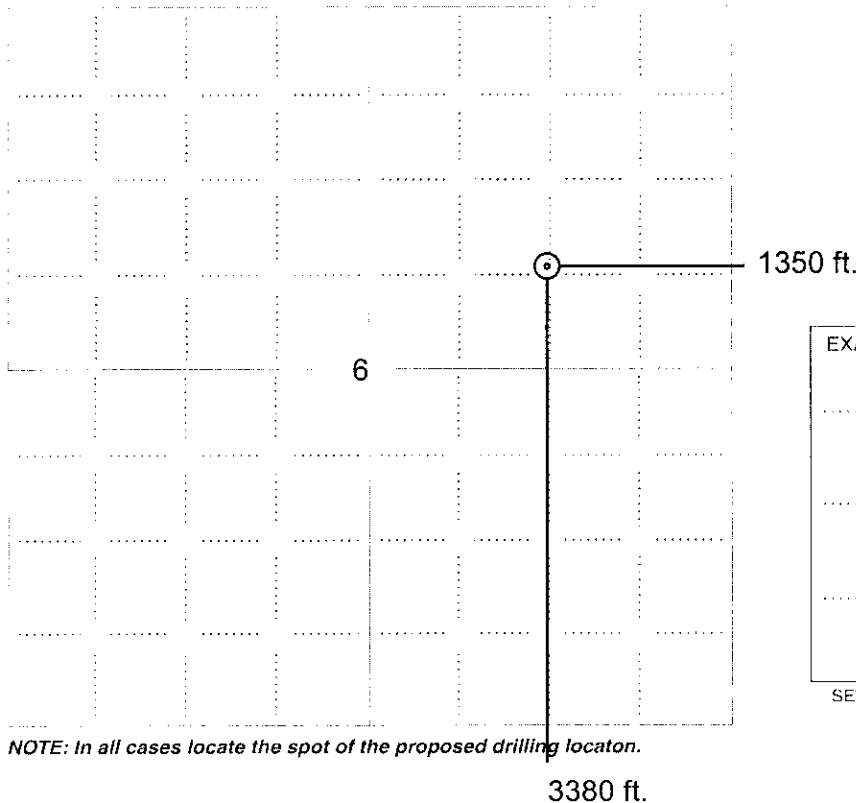

NOTE: In all cases locate the spot of the proposed drilling locaton.

In plotting the proposed location of the well, you must show:

1. The manner in which you are using the depicted plat by identifying section lines, i.e. 1 section, 1 section with 8 surrounding sections, 4 sections, etc.
2. The distance of the proposed drilling location from the south / north and east / west outside section lines.
3. The distance to the nearest lease or unit boundary line (in footage).
4. If proposed location is located within a prorated or spaced field a certificate of acreage attribution plat must be attached: (CO-7 for oil wells; CG-8 for gas wells).



KANSAS CORPORATION COMMISSION 1015588
OIL & GAS CONSERVATION DIVISION

Form CDP-1
April 2004
Form must be Typed

APPLICATION FOR SURFACE PIT

Submit in Duplicate

Operator Name: Doty, Tim		License Number: 31124	
Operator Address: PO BOX 117		SEDAN KS 67361	
Contact Person: Tim Doty		Phone Number: 620-331-9791	
Lease Name & Well No.: TDOTGreen TDOT #1		Pit Location (QQQQ): SE NE SW NE Sec. 6 Twp. 34 R. 12 <input checked="" type="checkbox"/> East <input type="checkbox"/> West 3,380 Feet from <input type="checkbox"/> North / <input checked="" type="checkbox"/> South Line of Section 1,350 Feet from <input checked="" type="checkbox"/> East / <input type="checkbox"/> West Line of Section Chautauqua County	
Type of Pit: <input type="checkbox"/> Emergency Pit <input type="checkbox"/> Burn Pit <input type="checkbox"/> Settling Pit <input checked="" type="checkbox"/> Drilling Pit <input type="checkbox"/> Workover Pit <input type="checkbox"/> Haul-Off Pit <i>(If WP Supply API No. or Year Drilled)</i>		Pit is: <input checked="" type="checkbox"/> Proposed <input type="checkbox"/> Existing If Existing, date constructed: _____ Pit capacity: 300 (bbls)	
Is the pit located in a Sensitive Ground Water Area? <input type="checkbox"/> Yes <input checked="" type="checkbox"/> No		Chloride concentration: _____ mg/l <i>(For Emergency Pits and Settling Pits only)</i>	
Is the bottom below ground level? <input checked="" type="checkbox"/> Yes <input type="checkbox"/> No		Artificial Liner? <input type="checkbox"/> Yes <input checked="" type="checkbox"/> No	
How is the pit lined if a plastic liner is not used? native clays			
Pit dimensions (all but working pits): 40 Length (feet) 10 Width (feet)		<input type="checkbox"/> N/A: Steel Pits	
Depth from ground level to deepest point: 5 (feet)		<input type="checkbox"/> No Pit	
If the pit is lined give a brief description of the liner material, thickness and installation procedure.		Describe procedures for periodic maintenance and determining liner integrity, including any special monitoring.	
Distance to nearest water well within one-mile of pit 3436 feet Depth of water well 82 feet		Depth to shallowest fresh water 65 feet. Source of information: <input type="checkbox"/> measured <input type="checkbox"/> well owner <input type="checkbox"/> electric log <input checked="" type="checkbox"/> KDWR	
Emergency, Settling and Burn Pits ONLY: Producing Formation: _____ Number of producing wells on lease: _____ Barrels of fluid produced daily: _____ Does the slope from the tank battery allow all spilled fluids to flow into the pit? <input type="checkbox"/> Yes <input type="checkbox"/> No		Drilling, Workover and Haul-Off Pits ONLY: Type of material utilized in drilling/workover: Air, fresh & salt water, drill cuttings Number of working pits to be utilized: 1 Abandonment procedure: Let fluids evaporate, cover pit, restore location Drill pits must be closed within 365 days of spud date.	
Submitted Electronically			
KCC OFFICE USE ONLY			
Date Received: 01/14/2008		Permit Number: 15-019-26870-00-00	
Permit Date: 01/15/2008		Lease Inspection: <input type="checkbox"/> Yes <input checked="" type="checkbox"/> No	
Steel Pit <input type="checkbox"/> RFAC <input type="checkbox"/> RFAS <input type="checkbox"/>			