



For KCC Use:
 Effective Date: 01/27/2008
 District # 4
 SGA? Yes No

KANSAS CORPORATION COMMISSION 1015781
 OIL & GAS CONSERVATION DIVISION

Form C-1
 October 2007

Form must be Typed
 Form must be Signed
 All blanks must be Filled

NOTICE OF INTENT TO DRILL

Must be approved by KCC five (5) days prior to commencing well

Expected Spud Date: 2/4/2008
month day year

Spot Description:
 E2 W2 NW NW Sec. 4 Twp. 9 S. R. 18 E W
 (000.00) 660 feet from N / S Line of Section
 515 feet from E / W Line of Section

OPERATOR: License# 30606
 Name: Murfin Drilling Co., Inc.
 Address 1: 250 N WATER STE 300
 Address 2:
 City: WICHITA State: KS Zip: 67202 + 1216
 Contact Person: Shauna Gunzelman
 Phone: 316-267-3241

Is SECTION: Regular Irregular?

CONTRACTOR: License# 30606
 Name: Murfin Drilling Co., Inc.

(Note: Locate well on the Section Plat on reverse side)
 County: Rooks
 Lease Name: Mosher Farms Well # 2-4
 Field Name: unknown
 Is this a Prorated / Spaced Field? Yes No

Well Drilled For: Well Class: Type Equipment:
 Oil Enh Rec Infield Mud Rotary
 Gas Storage Pool Ext. Air Rotary
 Seismic: # of Holes Wildcat Cable
 Other: Other
 If OWWO: old well information as follows:

Target Formation(s): LKC, Arbuckle
 Nearest Lease or unit boundary line (in footage): 515
 Ground Surface Elevation: 2000 feet MSL
 Water well within one-quarter mile: Yes No
 Public water supply well within one mile: Yes No
 Depth to bottom of fresh water: 180
 Depth to bottom of usable water: 860
 Surface Pipe by Alternate: I II
 Length of Surface Pipe Planned to be set: 300
 Length of Conductor Pipe (if any): 0
 Projected Total Depth: 3550
 Formation at Total Depth: Arbuckle

Operator:
 Well Name:
 Original Completion Date: Original Total Depth:

Water Source for Drilling Operations:
 Well Farm Pond Other: haul
 DWR Permit #: (Note: Apply for Permit with DWR)

Directional, Deviated or Horizontal wellbore? Yes No
 If Yes, true vertical depth:
 Bottom Hole Location:
 KCC DKT #:

Will Cores be taken? Yes No
 If Yes, proposed zone:

AFFIDAVIT

The undersigned hereby affirms that the drilling, completion and eventual plugging of this well will comply with K.S.A. 55 et. seq.
 It is agreed that the following minimum requirements will be met:

1. Notify the appropriate district office **prior** to spudding of well;
2. A copy of the approved notice of intent to drill **shall be** posted on each drilling rig;
3. The minimum amount of surface pipe as specified below **shall be set** by circulating cement to the top; in all cases surface pipe **shall be set** through all unconsolidated materials plus a minimum of 20 feet into the underlying formation.
4. If the well is dry hole, an agreement between the operator and the district office on plug length and placement is necessary **prior to plugging**;
5. The appropriate district office will be notified before well is either plugged or production casing is cemented in;
6. If an ALTERNATE II COMPLETION, production pipe shall be cemented from below any usable water to surface within **120 DAYS** of spud date.
 Or pursuant to Appendix "B" - Eastern Kansas surface casing order #133,891-C, which applies to the KCC District 3 area, alternate II cementing must be completed within 30 days of the spud date or the well shall be plugged. **In all cases, NOTIFY district office** prior to any cementing.

Submitted Electronically

For KCC Use ONLY
 API # 15 - 15-163-23682-00-00
 Conductor pipe required 0 feet
 Minimum surface pipe required 200 feet per ALT I II
 Approved by: Rick Hestermann 01/22/2008
 This authorization expires: 01/22/2009
 (This authorization void if drilling not started within 12 months of approval date.)
 Spud date: Agent:

Remember to:

- File Drill Pit Application (form GDP-1) with Intent to Drill;
- File Completion Form ACO-1 within 120 days of spud date;
- File acreage attribution plat according to field proration orders;
- Notify appropriate district office 48 hours prior to workover or re-entry;
- Submit plugging report (CP-4) after plugging is completed (within 60 days);
- Obtain written approval before disposing or injecting salt water.
- If this permit has expired (See: authorized expiration date) please check the box below and return to the address below.

Well Not Drilled - Permit Expired Date:
 Signature of Operator or Agent:

4
9
18
 E
 W



1015781

IN ALL CASES PLOT THE INTENDED WELL ON THE PLAT BELOW

Plat of acreage attributable to a well in a prorated or spaced field

If the intended well is in a prorated or spaced field, please fully complete this side of the form. If the intended well is in a prorated or spaced field complete the plat below showing that the well will be properly located in relationship to other wells producing from the common source of supply. Please show all the wells and within 1 mile of the boundaries of the proposed acreage attribution unit for gas wells and within 1/2 mile of the boundaries of the proposed acreage attribution unit for oil wells.

API No. 15 - 15-163-23682-00-00

Operator: Murfin Drilling Co., Inc.

Lease: Mosher Farms

Well Number: 2-4

Field: unknown

Number of Acres attributable to well: _____

QTR/QTR/QTR/QTR of acreage: E2 W2 NW NW

Location of Well: County: Rooks

660 feet from N / S Line of Section

515 feet from E / W Line of Section

Sec. 4 Twp. 9 S. R. 18 E W

Is Section: Regular or Irregular

If Section is Irregular, locate well from nearest corner boundary.

Section corner used: NE NW SE SW

PLAT

(Show location of the well and shade attributable acreage for prorated or spaced wells.)

(Show footage to the nearest lease or unit boundary line.)

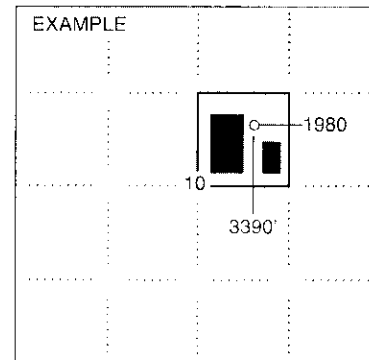
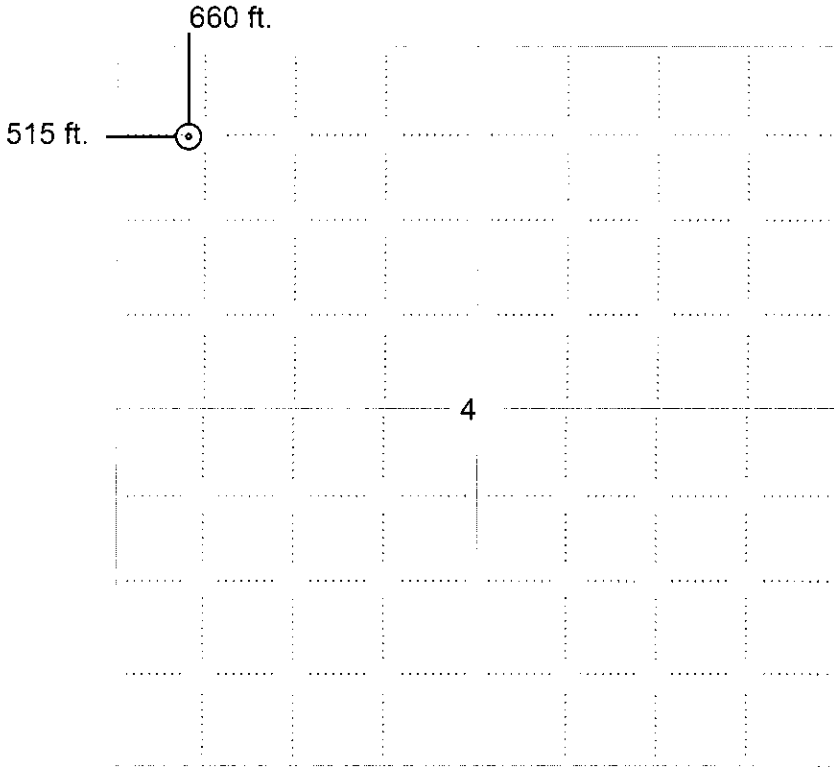

SEWARD CO.

NOTE: In all cases locate the spot of the proposed drilling location.

In plotting the proposed location of the well, you must show:

1. The manner in which you are using the depicted plat by identifying section lines. i.e. 1 section. 1 section with 8 surrounding sections. 4 sections, etc.
2. The distance of the proposed drilling location from the south / north and east / west outside section lines.
3. The distance to the nearest lease or unit boundary line (in footage).
4. If proposed location is located within a prorated or spaced field a certificate of acreage attribution plat must be attached: (CO-7 for oil wells; CG-8 for gas wells).



KANSAS CORPORATION COMMISSION 1015781
 OIL & GAS CONSERVATION DIVISION
APPLICATION FOR SURFACE PIT

Form CDP-1
 April 2004
 Form must be Typed

Submit in Duplicate

Operator Name: Murfin Drilling Co., Inc.		License Number: 30606	
Operator Address: 250 N WATER STE 300		WICHITA KS 67202	
Contact Person: Shauna Gunzelman		Phone Number: 316-267-3241	
Lease Name & Well No.: Mosher Farms 2-4		Pit Location (QQQQ): E2 W2 NW NW	
Type of Pit: <input type="checkbox"/> Emergency Pit <input type="checkbox"/> Burn Pit <input type="checkbox"/> Settling Pit <input checked="" type="checkbox"/> Drilling Pit <input type="checkbox"/> Workover Pit <input type="checkbox"/> Haul-Off Pit <i>(If WP Supply API No. or Year Drilled)</i>	Pit is: <input checked="" type="checkbox"/> Proposed <input type="checkbox"/> Existing If Existing, date constructed: _____ Pit capacity: 600 (bbls)	Sec. 4 Twp. 9 R. 18 <input type="checkbox"/> East <input checked="" type="checkbox"/> West 660 Feet from <input checked="" type="checkbox"/> North / <input type="checkbox"/> South Line of Section 515 Feet from <input type="checkbox"/> East / <input checked="" type="checkbox"/> West Line of Section Rocks _____ County _____	
Is the pit located in a Sensitive Ground Water Area? <input type="checkbox"/> Yes <input checked="" type="checkbox"/> No		Chloride concentration: _____ mg/l <i>(For Emergency Pits and Settling Pits only)</i>	
Is the bottom below ground level? <input checked="" type="checkbox"/> Yes <input type="checkbox"/> No	Artificial Liner? <input type="checkbox"/> Yes <input checked="" type="checkbox"/> No	How is the pit lined if a plastic liner is not used? Bentonite and solids from drilling operations self seal pits.	
Pit dimensions (all but working pits): <u>100</u> Length (feet) <u>100</u> Width (feet) <input type="checkbox"/> N/A: Steel Pits Depth from ground level to deepest point: <u>4</u> (feet) <input type="checkbox"/> No Pit			
If the pit is lined give a brief description of the liner material, thickness and installation procedure.		Describe procedures for periodic maintenance and determining liner integrity, including any special monitoring.	
Distance to nearest water well within one-mile of pit <u>NA</u> feet Depth of water well _____ feet		Depth to shallowest fresh water _____ feet. Source of information: <input type="checkbox"/> measured <input type="checkbox"/> well owner <input type="checkbox"/> electric log <input type="checkbox"/> KDWR	
Emergency, Settling and Burn Pits ONLY: Producing Formation: _____ Number of producing wells on lease: _____ Barrels of fluid produced daily: _____ Does the slope from the tank battery allow all spilled fluids to flow into the pit? <input type="checkbox"/> Yes <input type="checkbox"/> No		Drilling, Workover and Haul-Off Pits ONLY: Type of material utilized in drilling/workover: <u>Bentonite</u> Number of working pits to be utilized: <u>4</u> Abandonment procedure: <u>Allow pits to evaporate until dry then backfill when conditions allow.</u> Drill pits must be closed within 365 days of spud date.	
Submitted Electronically			

KCC OFFICE USE ONLY		Steel Pit <input type="checkbox"/>	RFAC <input type="checkbox"/>	RFAS <input type="checkbox"/>
Date Received: <u>01/21/2008</u>	Permit Number: <u>15-163-23682-00-00</u>	Permit Date: <u>01/22/2008</u>	Lease Inspection: <input type="checkbox"/> Yes <input checked="" type="checkbox"/> No	

Mail to: KCC - Conservation Division, 130 S. Market - Room 2078, Wichita, Kansas 67202