

For KCC Use:  
 Effective Date: 1-28-08  
 District # 4  
 SGA?  Yes  No

KANSAS CORPORATION COMMISSION  
 OIL & GAS CONSERVATION DIVISION

Form C-1

December 2002

Form must be Typed

Form must be Signed

All blanks must be Filled

**NOTICE OF INTENT TO DRILL**

Must be approved by KCC five (5) days prior to commencing well

Expected Spud Date 1 31 08  
 month day year

OPERATOR: License# 33325  
 Name: Petroleum Development Corporation  
 Address: 1775 Sherman St. Suite 3000  
 City/State/Zip: Denver, CO 80203  
 Contact Person: James Annable  
 Phone: 303-905-4340

CONTRACTOR: License# 33532  
 Name: Advanced Drilling Technologies

<b>Well Drilled For:</b>	<b>Well Class:</b>	<b>Type Equipment:</b>
<input type="checkbox"/> Oil	<input type="checkbox"/> Enh Rec	<input checked="" type="checkbox"/> Infield
<input checked="" type="checkbox"/> Gas	<input type="checkbox"/> Storage	<input type="checkbox"/> Pool Ext.
<input type="checkbox"/> OWWO	<input type="checkbox"/> Disposal	<input type="checkbox"/> Wildcat
<input type="checkbox"/> Seismic; # of Holes	<input type="checkbox"/> Other	<input type="checkbox"/> Cable
<input type="checkbox"/> Other		<input checked="" type="checkbox"/> Mud Rotary
		<input type="checkbox"/> Air Rotary

If OWWO: old well information as follows:  
 Operator: NA  
 Well Name: \_\_\_\_\_  
 Original Completion Date: \_\_\_\_\_ Original Total Depth: \_\_\_\_\_

Directional, Deviated or Horizontal wellbore?  Yes  No  
 If Yes, true vertical depth: \_\_\_\_\_  
 Bottom Hole Location: \_\_\_\_\_  
 KCC DKT #: \_\_\_\_\_

Spot  East  
 SE SE SE Sec. 35 Twp. 5 S. R. 42  West  
435 feet from  N /  S Line of Section  
575 feet from  E /  W Line of Section  
 Is SECTION  Regular  Irregular?

(Note: Locate well on the Section Plat on reverse side)

County: Cheyenne  
 Lease Name: Schritter Well #: 44-35  
 Field Name: Cherry Creek Niobrara Gas Area  
 Is this a Prorated / Spaced Field?  Yes  No  
 Target Formation(s): Niobrara  
 Nearest Lease or unit boundary: 435'  
 Ground Surface Elevation: 3782' feet MSL  
 Water well within one-quarter mile:  Yes  No  
 Public water supply well within one mile:  Yes  No  
 Depth to bottom of fresh water: 280' 280'  
 Depth to bottom of usable water: 430' 280'  
 Surface Pipe by Alternate:  1  2  
 Length of Surface Pipe Planned to be set: 300' 330'  
 Length of Conductor Pipe required: Not Required  
 Projected Total Depth: 1750'  
 Formation at Total Depth: Niobrara  
 Water Source for Drilling Operations:  
 Well  Farm Pond  Other X  
 DWR Permit #: Drilling Contractor will apply.

(Note: Apply for Permit with DWR )

Will Cores be taken?  Yes  No  
 If Yes, proposed zone: \_\_\_\_\_

**AFFIDAVIT**

The undersigned hereby affirms that the drilling, completion and eventual plugging of this well will comply with K.S.A. 55 et. seq.

It is agreed that the following minimum requirements will be met:

1. Notify the appropriate district office **prior** to spudding of well;
2. A copy of the approved notice of intent to drill **shall be** posted on each drilling rig;
3. The minimum amount of surface pipe as specified below **shall be set** by circulating cement to the top; in all cases surface pipe shall be set through all unconsolidated materials plus a minimum of 20 feet into the underlying formation.
4. If the well is dry hole, an agreement between the operator and the district office on plug length and placement is necessary **prior to plugging**;
5. The appropriate district office will be notified before well is either plugged or production casing is cemented in;
6. If an ALTERNATE II COMPLETION, production pipe shall be cemented from below any usable water to surface within **120 days** of spud date. Or pursuant to Appendix "B" - Eastern Kansas surface casing order #133,891-C, which applies to the KCC District 3 area, alternate II cementing must be completed within 30 days of the spud date or the well shall be plugged. **In all cases, NOTIFY district office** prior to any cementing.

I hereby certify that the statements made herein are true and to the best of my knowledge and belief.

Date: 1/18/08 Signature of Operator or Agent: [Signature] Title: Sr. Regulatory Consultant

RECEIVED  
 KANSAS CORPORATION COMMISSION  
 JAN 22 2008  
 CONSERVATION DIVISION  
 WICHITA, KANSAS

**For KCC Use ONLY**  
 API # 15 - 023-20959-0000  
 Conductor pipe required None feet  
 Minimum surface pipe required 330 feet per Alt. 1  
 Approved by: [Signature] 1-23-08  
 This authorization expires: 1-23-09  
 (This authorization void if drilling not started within 6 months of approval date.)  
 Spud date: \_\_\_\_\_ Agent: 12

**Remember to:**

- File Drill Pit Application (form CDP-1) with Intent to Drill;
- File Completion Form ACO-1 within 120 days of spud date;
- File acreage attribution plat according to field proration orders;
- Notify appropriate district office 48 hours prior to workover or re-entry;
- Submit plugging report (CP-4) after plugging is completed;
- Obtain written approval before disposing or injecting salt water.
- If this permit has expired (See: authorized expiration date) please check the box below and return to the address below.

Well Not Drilled - Permit Expired  
 Signature of Operator or Agent: \_\_\_\_\_  
 Date: \_\_\_\_\_

Mail to: KCC - Conservation Division, 130 S. Market - Room 2078, Wichita, Kansas 67202

35  
 S  
 42W

### IN ALL CASES PLOT THE INTENDED WELL ON THE PLAT BELOW

*Plat of acreage attributable to a well in a prorated or spaced field*

**If the intended well is in a prorated or spaced field, please fully complete this side of the form.** If the intended well is in a prorated or spaced field complete the plat below showing that the well will be properly located in relationship to other wells producing from the common source of supply. Please show all the wells and within 1 mile of the boundaries of the proposed acreage attribution unit for gas wells and within 1/2 mile of the boundaries of the proposed acreage attribution unit for oil wells.

API No. 15 - 023-20959-0000  
Operator: Petroleum Development Corporation  
Lease: Schritter  
Well Number: 44-35  
Field: Cherry Creek Niobrara Gas Area

Number of Acres attributable to well: NA  
QTR / QTR / QTR of acreage: SE - SE - SE

Location of Well: County: Cheyenne  
435 feet from  N /  S Line of Section  
575 feet from  E /  W Line of Section  
Sec. 35 Twp. 5 S. R. 42  East  West

Is Section:  Regular or  Irregular

**If Section is Irregular, locate well from nearest corner boundary.**

Section corner used:  NE  NW  SE  SW

### PLAT

*(Show location of the well and shade attributable acreage for prorated or spaced wells.)  
(Show footage to the nearest lease or unit boundary line.)*

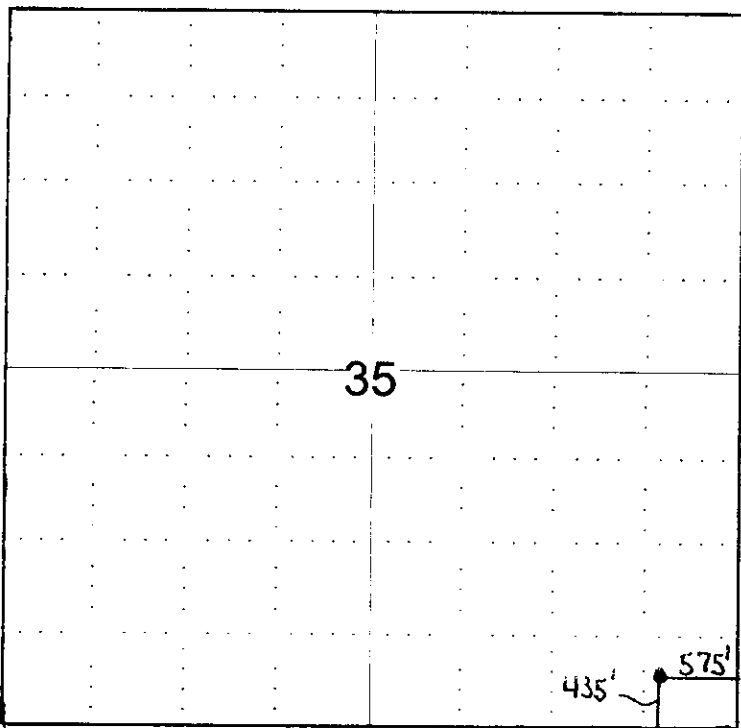

RECEIVED  
KANSAS CORPORATION COMMISSION  
JAN 22 2008  
CONSERVATION DIVISION  
WICHITA, KS

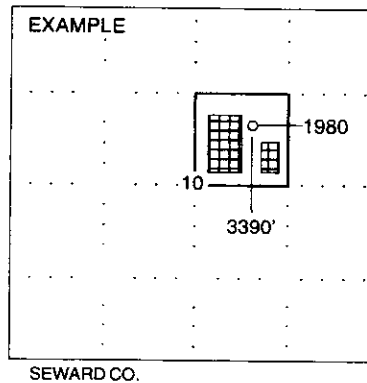

**NOTE: In all cases locate the spot of the proposed drilling location.**

#### In plotting the proposed location of the well, you must show:

1. The manner in which you are using the depicted plat by identifying section lines, i.e. 1 section, 1 section with 8 surrounding sections, 4 sections, etc.
2. The distance of the proposed drilling location from the section's south / north and east / west.
3. The distance to the nearest lease or unit boundary line.
4. If proposed location is located within a prorated or spaced field a certificate of acreage attribution plat must be attached: (CO-7 for oil wells; CG-8 for gas wells).

15-02320959-0000

# WELL LOCATION CERTIFICATE

SECTION 35, TOWNSHIP 5 SOUTH, RANGE 42 WEST, 6TH P.M.

NA SEC 35  
CR 5/3  
INTERSECTION

S 87°41'53" E 5254.88

NE SEC 35  
CR 5 POST  
INTERSECTION

SURFACE LOCATION  
GROUND ELEVATION = 3722'  
LAT/LONG = 39 56946  
101 99819

# 35

NOTES  
THIS IS A DIRECTIONAL WELL  
LAND SURFACE USE: PASTURE FIELD  
APPARENT PROPERTY LINE 435'

SCHRITTER 44-35 -

SW SEC 36  
CR A/3  
INTERSECTION

N 87°34'14" W 5255.68'

435' 575'

SE SEC 35  
CR A/4  
INTERSECTION

I HEREBY STATE TO PETROLEUM DEVELOPMENT CORPORATION THAT THIS WELL LOCATION CERTIFICATE INDICATES THE WELL **SCHRITTER 44-35** TO BE LOCATED 435' FSL AND 575' FEL, SEC. 35, T5S, R42W 6th P.M.

RECEIVED  
KANSAS CORPORATION COMMISSION

JAN 22 2008

CONSERVATION DIVISION  
WICHITA, KS

### LEGEND

- = FOUND MONUMENT
- = PROPOSED WELL
- = EXISTING WELL

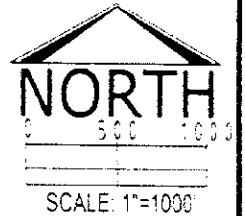

BASIS OF BEARINGS AS SHOWN ABOVE

GROUND ELEVATION SHOWN IS APPROXIMATE AND IS BASED ON AN OBSERVED GPS ELEVATION (NAVD 1988 DATUM)

LAT. & LONG. SHOWN ARE BASED ON AN OBSERVED GPS OBSERVATION (NAD 1983/92) WITH A PDOP VALUE OF LESS THAN SIX (6)

ALL DISTANCES ARE FIELD MEASURED UNLESS OTHERWISE NOTED  
DISTANCES TO WELL ARE SHOWN PERPENDICULAR TO SECTION LINES

PETROLEUM FIELD SERVICES, LLC

THIS IS NOT A MONUMENTED BOUNDARY SURVEY. IT IS ONLY A DRAWING INTENDED TO DEPICT THE WELL LOCATION TO SECTION LINES

REVISIONS	
INITIALS	DATE

PREPARED BY

**PFS**  
Petroleum Field Services, LLC  
1801 W. 13th Ave.  
Denver, CO 80204

FIELD DATE	12-19-07
DRAWING DATE	12-20-07
BY	LB

WELL NAME	SCHRITTER 44-35
SURFACE LOCATION	CHEYENNE COUNTY, KANSAS SE 1/4 SE 1/4, SEC. 35, T5S, R42W

