



For KCC Use:
 Effective Date: 01/05/2008
 District # 4
 SGA? Yes No

KANSAS CORPORATION COMMISSION 1015220
 OIL & GAS CONSERVATION DIVISION

Form C-1
 October 2007

Form must be Typed
 Form must be Signed
 All blanks must be Filled

NOTICE OF INTENT TO DRILL
 Must be approved by KCC five (5) days prior to commencing well

Expected Spud Date: 1/5/2008
 month day year

OPERATOR: License# 33953
 Name: Raven Resources LLC
 Address 1: 13220 N MACARTHUR
 Address 2:
 City: OKLAHOMA CITY State: OK Zip: 73142 + 3019
 Contact Person: David E. Rice
 Phone: 620-624-0156

CONTRACTOR: License# 33532
 Name: Advanced Drilling Technologies LLC

| | | |
|--|---|--|
| Well Drilled For: | Well Class: | Type Equipment: |
| <input type="checkbox"/> Oil | <input type="checkbox"/> Enh Rec | <input checked="" type="checkbox"/> Mud Rotary |
| <input checked="" type="checkbox"/> Gas | <input type="checkbox"/> Storage | <input type="checkbox"/> Air Rotary |
| <input type="checkbox"/> Seismic | <input type="checkbox"/> Disposal | <input checked="" type="checkbox"/> Cable |
| <input type="checkbox"/> Other: # of Holes | <input checked="" type="checkbox"/> Wildcat | |
| | <input type="checkbox"/> Other | |

If OWWO: old well information as follows:
 Operator:
 Well Name:
 Original Completion Date: Original Total Depth:

Directional, Deviated or Horizontal wellbore? Yes No
 If Yes, true vertical depth:
 Bottom Hole Location:
 KCC DKT #:

Spot Description:
 NE NW Sec. 2 Twp. 12 S. R. 42 E W
 (a.o.a.o) 660 feet from N / S Line of Section
 1,980 feet from E / W Line of Section
 Is SECTION: Regular Irregular?

(Note: Locate well on the Section Plat on reverse side)
 County: Wallace
 Lease Name: See Well #: 1-2
 Field Name: Wildcat
 Is this a Prorated / Spaced Field? Yes No
 Target Formation(s): Niobrara
 Nearest Lease or unit boundary line (in footage): 660
 Ground Surface Elevation: 3792 feet MSL
 Water well within one-quarter mile: Yes No
 Public water supply well within one mile: Yes No
 Depth to bottom of fresh water: 100
 Depth to bottom of usable water: 100
 Surface Pipe by Alternate: I II
 Length of Surface Pipe Planned to be set: 275
 Length of Conductor Pipe (if any):
 Projected Total Depth: 1100
 Formation at Total Depth: Niobrara
 Water Source for Drilling Operations:
 Well Farm Pond Other: Haul in
 DWR Permit #:
 (Note: Apply for Permit with DWR)
 Will Cores be taken? Yes No
 If Yes, proposed zone:

AFFIDAVIT

The undersigned hereby affirms that the drilling, completion and eventual plugging of this well will comply with K.S.A. 55 et. seq.
 It is agreed that the following minimum requirements will be met:

1. Notify the appropriate district office **prior** to spudding of well;
2. A copy of the approved notice of intent to drill **shall be** posted on each drilling rig;
3. The minimum amount of surface pipe as specified below **shall be set** by circulating cement to the top; in all cases surface pipe **shall be set** through all unconsolidated materials plus a minimum of 20 feet into the underlying formation.
4. If the well is dry hole, an agreement between the operator and the district office on plug length and placement is necessary **prior to plugging**;
5. The appropriate district office will be notified before well is either plugged or production casing is cemented in;
6. If an ALTERNATE II COMPLETION, production pipe shall be cemented from below any usable water to surface within **120 DAYS** of spud date.
 Or pursuant to Appendix "B" - Eastern Kansas surface casing order #133,891-C, which applies to the KCC District 3 area, alternate II cementing must be completed within 30 days of the spud date or the well shall be plugged. **In all cases, NOTIFY district office** prior to any cementing.

Submitted Electronically

For KCC Use ONLY
 API # 15-199-20379-00-00
 Conductor pipe required 0 feet
 Minimum surface pipe required 150 feet per ALT. I II
 Approved by: Rick Hestermann 12/31/2007
 This authorization expires: 12/31/2008
 (This authorization void if drilling not started within 12 months of approval date.)
 Spud date: Agent:

Remember to:

- File Drill Pit Application (form GDP-1) with Intent to Drill;
- File Completion Form ACO-1 within 120 days of spud date;
- File acreage attribution plat according to field proration orders;
- Notify appropriate district office 48 hours prior to workover or re-entry;
- Submit plugging report (CP-4) after plugging is completed (within 60 days);
- Obtain written approval before disposing or injecting salt water.
- If this permit has expired (See: authorized expiration date) please check the box below and return to the address below.

Well Not Drilled - Permit Expired Date: Signature of Operator or Agent.

2
12
42
 E
 W



1015220

IN ALL CASES PLOT THE INTENDED WELL ON THE PLAT BELOW

Plat of acreage attributable to a well in a prorated or spaced field

If the intended well is in a prorated or spaced field, please fully complete this side of the form. If the intended well is in a prorated or spaced field complete the plat below showing that the well will be properly located in relationship to other wells producing from the common source of supply. Please show all the wells and within 1 mile of the boundaries of the proposed acreage attribution unit for gas wells and within 1/2 mile of the boundaries of the proposed acreage attribution unit for oil wells.

API No. 15 - 15-199-20379-00-00

Operator: Raven Resources LLC

Lease: See

Well Number: 1-2

Field: Wildcat

Number of Acres attributable to well: _____

QTR/QTR/QTR/QTR of acreage: _____ - _____ - NE - NW

Location of Well: County: Wallace

660 feet from N / S Line of Section

1,980 feet from E / W Line of Section

Sec. 2 Twp. 12 S. R. 42 E W

Is Section: Regular or Irregular

If Section is Irregular, locate well from nearest corner boundary.

Section corner used: NE NW SE SW

PLAT

(Show location of the well and shade attributable acreage for prorated or spaced wells.)

(Show footage to the nearest lease or unit boundary line.)

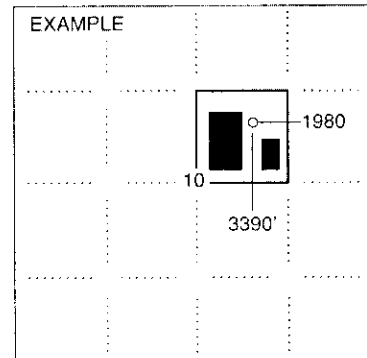
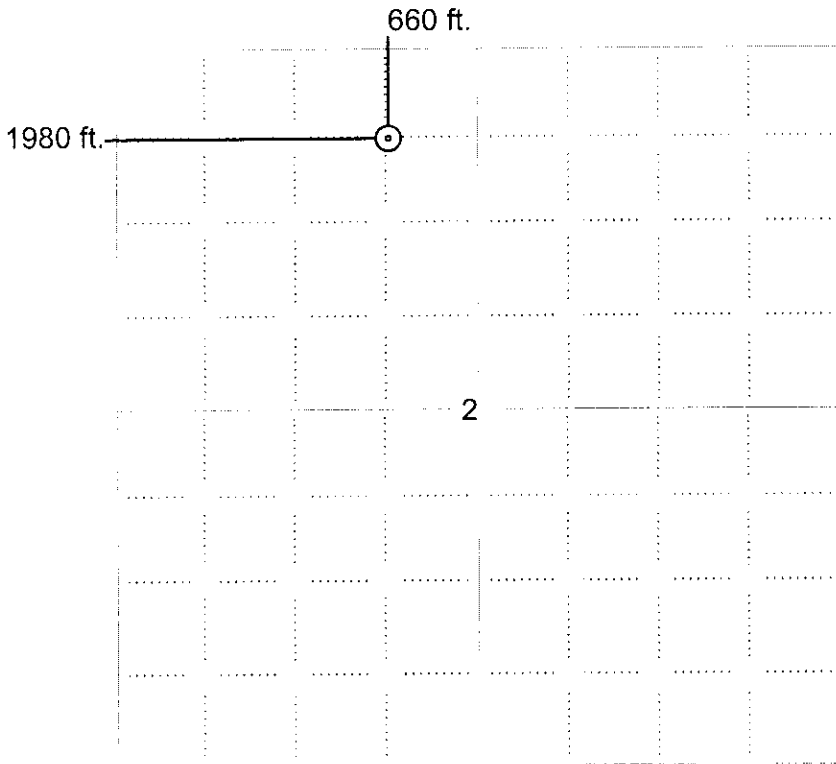

NOTE: In all cases locate the spot of the proposed drilling locaton.

In plotting the proposed location of the well, you must show:

1. The manner in which you are using the depicted plat by identifying section lines, i.e. 1 section, 1 section with 8 surrounding sections, 4 sections, etc.
2. The distance of the proposed drilling location from the south / north and east / west outside section lines.
3. The distance to the nearest lease or unit boundary line (in footage).
4. If proposed location is located within a prorated or spaced field a certificate of acreage attribution plat must be attached: (CO-7 for oil wells; CG-8 for gas wells).



KANSAS CORPORATION COMMISSION 1015220
OIL & GAS CONSERVATION DIVISION

Form CDP-1
April 2004
Form must be Typed

APPLICATION FOR SURFACE PIT

Submit in Duplicate

| | | |
|--|--|---|
| Operator Name: Raven Resources LLC | | License Number: 33953 |
| Operator Address: 13220 N MACARTHUR | | OKLAHOMA CITY OK 73142 |
| Contact Person: David E. Rice | | Phone Number: 620-624-0156 |
| Lease Name & Well No.: See 1-2 | | Pit Location (QQQQ): _____ NE _____ NW |
| Type of Pit: <input type="checkbox"/> Emergency Pit <input type="checkbox"/> Burn Pit <input type="checkbox"/> Settling Pit <input checked="" type="checkbox"/> Drilling Pit <input type="checkbox"/> Workover Pit <input type="checkbox"/> Haul-Off Pit <small>(if WP Supply API No. or Year Drilled)</small> | | Pit is: <input checked="" type="checkbox"/> Proposed <input type="checkbox"/> Existing If Existing, date constructed: _____ Pit capacity: 500 (bbls) |
| Is the pit located in a Sensitive Ground Water Area? <input type="checkbox"/> Yes <input checked="" type="checkbox"/> No | | Chloride concentration: _____ mg/l <small>(For Emergency Pits and Settling Pits only)</small> |
| Is the bottom below ground level? <input checked="" type="checkbox"/> Yes <input type="checkbox"/> No | Artificial Liner? <input type="checkbox"/> Yes <input checked="" type="checkbox"/> No | How is the pit lined if a plastic liner is not used? Natural permeability |
| Pit dimensions (all but working pits): 25 Length (feet) 50 Width (feet) <input type="checkbox"/> N/A: Steel Pits Depth from ground level to deepest point: 4 (feet) <input type="checkbox"/> No Pit | | |
| If the pit is lined give a brief description of the liner material, thickness and installation procedure. | | Describe procedures for periodic maintenance and determining liner integrity, including any special monitoring. |
| Distance to nearest water well within one-mile of pit NA feet Depth of water well _____ feet | | Depth to shallowest fresh water _____ feet. Source of information: <input type="checkbox"/> measured <input type="checkbox"/> well owner <input type="checkbox"/> electric log <input type="checkbox"/> KDWR |
| Emergency, Settling and Burn Pits ONLY: Producing Formation: _____ Number of producing wells on lease: _____ Barrels of fluid produced daily: _____ Does the slope from the tank battery allow all spilled fluids to flow into the pit? <input type="checkbox"/> Yes <input type="checkbox"/> No | | Drilling, Workover and Haul-Off Pits ONLY: Type of material utilized in drilling/workover: Drilling Mud Number of working pits to be utilized: 1 Abandonment procedure: Evaporation and back fill Drill pits must be closed within 365 days of spud date. |
| <p>Submitted Electronically</p> | | |

| | | | | |
|----------------------------------|--|------------------------------------|---|-------------------------------|
| KCC OFFICE USE ONLY | | Steel Pit <input type="checkbox"/> | RFAC <input type="checkbox"/> | RFAS <input type="checkbox"/> |
| Date Received: 12/31/2007 | Permit Number: 15-199-20379-00-00 | Permit Date: 12/31/2007 | Lease Inspection: <input type="checkbox"/> Yes <input checked="" type="checkbox"/> No | |

Mail to: KCC - Conservation Division, 130 S. Market - Room 2078, Wichita, Kansas 67202