

ORIGINAL

SIDE ONE

STATE CORPORATION COMMISSION OF KANSAS
OIL & GAS CONSERVATION DIVISION
WELL COMPLETION FORM
ACO-1 WELL HISTORY
DESCRIPTION OF WELL AND LEASE

API NO. 15- 163-23,088-08-00

County Rooks

C S/2 N/2 N/2 Sec. 20 Twp. 9S Rge. 20 East
West

Operator: License # 6040

4290 Ft. North from Southeast Corner of Section

Name: Bankoff Oil Company

2640 Ft. West from Southeast Corner of Section

Address P. O. Box 700657

(NOTE: Locate well in section plat below.)

City/State/Zip Tulsa, OK 74170

Lease Name Neil Well # 4

Field Name Palco Trust Revival

Purchaser: D & A

Producing Formation D & A

Operator Contact Person: Frank Mize

Elevation: Ground 2257 KB 2262

Phone (316) 262-2784

Total Depth 3880' PBDT

Contractor: Name: Abercrombie Drilling, Inc.

License: 5422

Wellsite Geologist: _____

Designate Type of Completion

New Well Re-Entry Workover

Oil SWD Temp. Abd.

Gas Inj Delayed Comp.

Dry Other (Core, Water Supply, etc.)

If OMMO: old well info as follows:

Operator: N/A

Well Name: _____

Comp. Date _____ Old Total Depth _____

Drilling Method:

Mud Rotary Air Rotary Cable

03-26-90 04-01-90 4-1-90

Spud Date Date Reached TD Completion Date

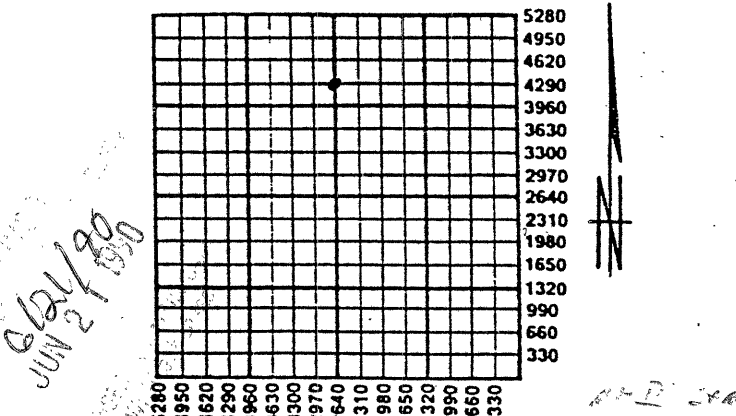

Amount of Surface Pipe Set and Cemented at 270.08 Feet

Multiple Stage Cementing Collar Used? Yes No

If yes, show depth set _____ Feet

If Alternate II completion, cement circulated from _____

feet depth to _____ w/ _____ sx cmt.

INSTRUCTIONS: This form shall be completed in triplicate and filed with the Kansas Corporation Commission, 200 Colorado Derby Building, Wichita, Kansas 67202, within 120 days of the spud date of any well. Rule 82-3-130, 82-3-107 and 82-3-106 apply. Information on side two of this form will be held confidential for a period of 12 months if requested in writing and submitted with the form. See rule 82-3-107 for confidentiality in excess of 12 months. One copy of all wireline logs and drillers time log shall be attached with this form. ALL CEMENTING TICKETS MUST BE ATTACHED. Submit CP-4 form with all plugged wells. Submit CP-111 form with all temporarily abandoned wells. Any recompletion, workover or conversion of a well requires filing of ACO-2 within 120 days from commencement date of such work.

All requirements of the statutes, rules and regulations promulgated to regulate the oil and gas industry have been fully complied with and the statements herein are complete and correct to the best of my knowledge.

Signature Frank S. Mize
Title Exploration Mgr Date 6-12-90

K.C.C. OFFICE USE ONLY

F Letter of Confidentiality Attached
 C Wireline Log Received
 C Drillers Timelog Received

Distribution

KCC SWD/Rep NGPA
 KGS Plug Other
 (Specify)

Subscribed and sworn to before me this 6th day of June,
James B. Branatetter
 Notary Public
 My Commission Expires 4-13-93

JAMES B. BRANATETTER
 NOTARY PUBLIC
 STATE OF KANSAS

1111111111

SIDE TWO

Operator Name Bankoff Oil Company Lease Name Neil Well # 4

Sec. 20 Twp. 9S Rge. 20 East West County Rooks

INSTRUCTIONS: Show important tops and base of formations penetrated. Detail all cores. Report all drill stem tests giving interval tested, time tool open and closed, flowing and shut-in pressures, whether shut-in pressure reached static level, hydrostatic pressures, bottom hole temperature, fluid recovery, and flow rates if gas to surface during test. Attach extra sheet if more space is needed. Attach copy of log.

Drill Stem Tests Taken Yes No
(Attach Additional Sheets.)

Samples Sent to Geological Survey Yes No

Cores Taken Yes No

Electric Log Run Yes No
(Submit Copy.)

Dst #1: 3610-3630/30-30-2-0
wb/d 30" Rec 60' OSM
IFP 31-31# FFP 52-52# SIP 635#

DST#2: 3680-3726/10-30-4-0
wb/d 8" Rec 1'M all FP 10# SIP 15#

| Name | Formation Description | |
|--------------|-----------------------|--------|
| | Top | Bottom |
| Anhydrite | 1760 | |
| Topeka | 3295 | |
| Heebner | 3504 | |
| Lansing | 3542 | |
| Stark Shale | 3726 | |
| BKC | 3763 | |
| Conglomerate | 3809 | |
| Arbuckle | did not reach | |
| RTD | 3880 | |

CASING RECORD New Used
Report all strings set-conductor, surface, intermediate, production, etc.

| Purpose of String | Size Hole Drilled | Size Casing Set (In O.D.) | Weight Lbs./Ft. | Setting Depth | Type of Cement | # Sacks Used | Type and Percent Additives |
|-------------------|-------------------|---------------------------|-----------------|---------------|----------------|--------------|----------------------------|
| Surface | 12 1/4" | 8 5/8" | 20# | 270.08' | 60/40 poz | 150 | 2% gel, 3% c |

| Shots Per Foot | PERFORATION RECORD Specify Footage of Each Interval Perforated | Acid, Fracture, Shot, Cement Squeeze Record (Amount and Kind of Material Used) | Depth |
|----------------|--|---|-------|
| | DST #3: 3723-3750/4-30-0-0 wb/d 3" Rec 1'M w sho heavy oil FP 31-31# SIP 91# | | |

TUBING RECORD Size Set At Packer At Liner Run Yes No

Date of First Production Producing Method Flowing Pumping Gas Lift Other (Explain)

| Estimated Production Per 24 Hours | Oil Bbls. | Gas Mcf | Water Bbls. | Gas-Oil Ratio | Gravity |
|-----------------------------------|-----------|---------|-------------|---------------|---------|
| | | | | | |

Disposition of Gas: Vented Sold Used on Lease (If vented, submit ACO-18.)

METHOD OF COMPLETION Open Hole Perforation Dually Completed Commingled Other (Specify)

Production Interval

ALLIED CEMENTING CO., INC. No 8706

Home Office P. O. Box 31

Russell, Kansas 67665

| | | | | | | | | | | | | | | | |
|---------------------|-------------------------------|----------|------------|----------|-------------------------|-------|-----|------------|-----------|-------------|-----------|---|-----------|--------|-----------|
| Date | 3-26-90 | Sec | 20 | Twp. | 9 ^s | Range | 20W | Called Out | 4:00 P.M. | On Location | 6:30 P.M. | Job Start | 9:20 P.M. | Finish | 9:45 P.M. |
| Lease | NEIT | Well No. | 4 | Location | Palco (Ball Park) 1/2 W | | | County | Rooks | State | Ks. | | | | |
| Contractor | Abencrombie Dalg. Inc. Rig #8 | | | | | | | | | | | Owner | Same | | |
| Type Job | Set Surface Pipe | | | | | | | | | | | To Allied Cementing Co., Inc. You are hereby requested to rent cementing equipment and furnish cementer and helper to assist owner or contractor to do work as listed. | | | |
| Hole Size | 12 1/4" | | T.D. | 275' | | | | | | | | | | | |
| Csg. | 8 3/8" | | Depth | 270' | | | | | | | | | | | |
| Tbg. Size | | | Depth | | | | | | | | | | | | |
| Drill Pipe | | | Depth | | | | | | | | | | | | |
| Tool | | | Depth | | | | | | | | | | | | |
| Cement Left in Csg. | 15' | | Shoe Joint | | | | | | | | | | | | |
| Press Max. | | | Minimum | | | | | | | | | | | | |
| Meas Line | | | Displace | X | | | | | | | | | | | |
| Perf. | | | | | | | | | | | | | | | |

EQUIPMENT

| | | | |
|---------|------|----------|-------------------|
| Pumptrk | No. | Cementer | Gary H. Wayne Mc. |
| | 191 | Helper | |
| Pumptrk | No. | Cementer | Glen C. |
| | | Helper | |
| Bulktrk | #212 | Driver | |
| | | Driver | |

DEPTH of Job

| | | |
|------------|--------------------------|----------|
| Reference: | #1 Pumptruck - surface | \$360.00 |
| | #8 1-8 3/8" surface plug | 40.00 |
| | #14 mileage @ 1.00/mi. | 15.00 |
| | Sub Total | \$415.00 |
| | Tax | |
| | Total | |

Remarks: Cement Circulated.

| | |
|--|----------------------------|
| Charge To | Bank of Oil Company |
| Street | Box 1374 |
| City | Great Bend State Ks. 67530 |
| The above was done to satisfaction and supervision of owner agent or contractor. | |
| Purchase Order No. | |
| X | Anthony Miller |

CEMENT

| | |
|----------------|-----------------------------------|
| Amount Ordered | 150 sks 60/40 poz 20 gel 320 c.c. |
| Consisting of | |
| Common | 90 sks @ 5.00/sk. 450.00 |
| Poz. Mix | 60 sks @ 2.25/sk. 135.00 |
| Gel. | 3 sks |
| Chloride | 5 sks @ 20.00/sk. 100.00 |
| Quickset | |
| Sales Tax | |
| Handling | @ 90¢/sk. (150 sks) 135.00 |
| Mileage | @ 0.34/sk./mi. (15 mi.) 67.50 |
| Sub Total | 887.50 |
| Total | 887.50 |

Floating Equipment: Thanks

RECEIVED STATE CORPORATION COMMISSION

WUN 26 1990

#1302.50
less disc. - 260.00
#1042.50