

STATE OF KANSAS
STATE CORPORATION COMMISSION

15-179-20478-00-00

Give All Information Completely
Make Required Affidavit
Mail or Deliver Report to:
Conservation Division
State Corporation Commission
212 North Market, Insurance Bldg.
Wichita, Kansas

WELL PLUGGING RECORD

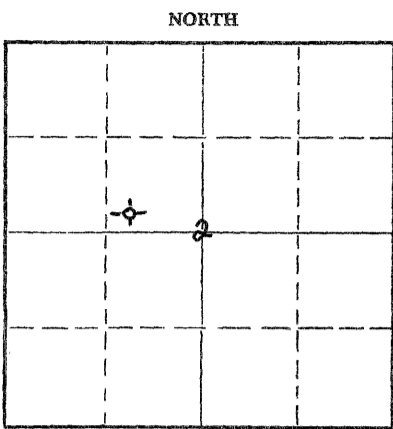

Locate well correctly on above Section Plat

Sheridan County, Sec. 2 Twp. 9S Rge. 28W (E) (W)
Location as "NE/CNW%SW%" or footage from lines SW SE NW
Lease Owner John O. Farmer, Inc.
Lease Name SCHAFFER Well No. 1
Office Address Box 352, Russell, Kansas 67665
Character of Well (completed as Oil, Gas or Dry Hole) Dry Hole
Date well completed 11-1-77 19
Application for plugging filed Yes 19
Application for plugging approved 19
Plugging commenced 19
Plugging completed 12:30 A.M., 11-1-77 19
Reason for abandonment of well or producing formation

If a producing well is abandoned, date of last production 19
Was permission obtained from the Conservation Division or its agents before plugging was commenced? Yes

Name of Conservation Agent who supervised plugging of this well Gilbert Balthazor
Producing formation Depth to top Bottom Total Depth of Well Feet
Show depth and thickness of all water, oil and gas formations.

OIL, GAS OR WATER RECORDS

CASING RECORD

FORMATION	CONTENT	FROM	TO	SIZE	PUT IN	PULLED OUT

Describe in detail the manner in which the well was plugged, indicating where the mud fluid was placed and the method or methods used in introducing it into the hole. If cement or other plugs were used, state the character of same and depth placed, from feet to feet for each plug set.

Plug #1	1300'	70	SX.
Plug #2	240'	20	SX.
Plug #3	40'	10	SX.

NOV 4 1977

(If additional description is necessary, use BACK of this sheet)
Name of Plugging Contractor John O. Farmer, Inc.
Address Box 352, Russell, Kansas 67665

STATE OF KANSAS, COUNTY OF RUSSELL, ss.
John O. Farmer (employee of owner) or (owner or operator) of the above-described well, being first duly sworn on oath, says: That I have knowledge of the facts, statements, and matters herein contained and the log of the above-described well as filed, and that the same are true and correct. So help me God.

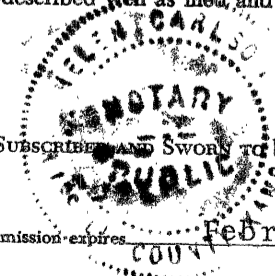

(Signature) John O. Farmer
Box 352, Russell, Kansas 67665 (Address)

SUBSCRIBE AND SWORN to before me this 1st day of November, 1977

Helen Carlson
Helen Carlson Notary Public.

My commission expires February 15, 1979

KANSAS DRILLERS LOG

API No. 15 — 179 — 20478-00-00
County Number

S. 2 T. 9S R. 28W ^E/_W

Loc. SW SE NW

County Sheridan

Operator
John O. Farmer, Inc.

Address
Box 352, Russell, Kansas 67665

Well No. 1 Lease Name SCHAFFER

Footage Location
330 feet from (X) (S) line 990 feet from (E) (W) line

Principal Contractor John O. Farmer, Inc. Geologist Sam Farmer

Spud Date 10-24-77 Total Depth 4125 P.B.T.D.

Date Completed 11-1-77 Oil Purchaser None -- D & A

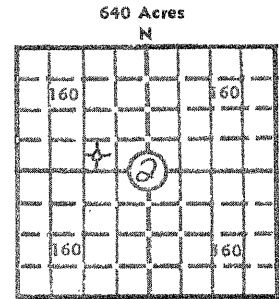

Locate well correctly

Elev.: Gr. 2732

DF. 2735 KB. 2737

CASING RECORD

Report of all strings set — surface, intermediate, production, etc.

Purpose of string	Size hole drilled	Size casing set (in O.D.)	Weight lbs/ft.	Setting depth	Type cement	Sacks	Type and percent additives
Surface	12 1/4	8-5/8	26	241	Common	175	

LINER RECORD

PERFORATION RECORD

Top, ft.	Bottom, ft.	Sacks cement	Shots per ft.	Size & type	Depth interval

TUBING RECORD

Size	Setting depth	Packer set at

ACID, FRACTURE, SHOT, CEMENT SQUEEZE RECORD

Amount and kind of material used	Depth interval treated

RECEIVED
 NOV 04 1977
 11-04-1977
 CONSERVATION DIVISION
 Wichita, Kansas

INITIAL PRODUCTION

Date of first production		Producing method (flowing, pumping, gas lift, etc.)			
RATE OF PRODUCTION PER 24 HOURS	Oil	Gas	Water	Gas-oil ratio	
	bbls.	MCF	bbls.	CFPB	
Disposition of gas (vented, used on lease or sold)			Producing interval (s)		

INSTRUCTIONS: As provided in KCC Rule 82-2-125, within 90 days after completion of a well, one completed copy of this Drillers Log shall be transmitted to the State Geological Survey of Kansas, 4150 Monroe Street, Wichita, Kansas 67209. Copies of this form are available from the Conservation Division, State Corporation Commission, 3830 So. Meridian (P.O. Box 17027), Wichita, Kansas 66217. Phone AC 316-522-2206. If confidential custody is desired, please note Rule 82-2-125. Drillers Logs will be an open file in the Oil and Gas Division, State Geological Survey of Kansas, Lawrence, Kansas 66044.

DESIGNATE TYPE OF COMP.: OIL, GAS, DRY HOLE, SWDW, ETC.:

Operator

John O. Farmer, Inc.

Well No.

1

Lease Name

SCHAFFER

Dry Hole

S 2 T 9S R 28W E W

WELL LOG

Show all important zones of porosity and contents thereof; cored intervals, and all drill-stem tests, including depth interval tested, cushion used, time tool open, flowing and shut-in pressures, and recoveries.

SHOW GEOLOGICAL MARKERS, LOGS RUN, OR OTHER DESCRIPTIVE INFORMATION.

FORMATION DESCRIPTION, CONTENTS, ETC.	TOP	BOTTOM	NAME	DEPTH
			Sample Tops:	
Shale	241	1150	Anhydrite	2383 (+ 354)
Shale & Sand	1150	1425	Base/Anhy.	2417 (+ 320)
Shale & Shells	1425	2016	Heebner	3858 (-1121)
Sand	2016	2174	Toronto	3882 (-1145)
Red Bed	2174	2383	Lansing	3892 (-1155)
Anhydrite	2383	2417	BKC	4120 (-1383)
Shale & Shells	2417	2605	T.D.	4125 (-1388)
Shale & Lime	2605	3600		
Lime & Shale	3600	3690		
Shale & Lime	3690	3895		
Lime & Shale	3895	3905		
Lime	3905	4125		

DST #1 3850-3905

Tool Open 30-30-60-60; good blow
 Rec: 124' mud; 124' slightly oil
 cut mud; 248' muddy water
 IFP: 54-120 FFP: 162-240
 BHP: 1252-1233

USE ADDITIONAL SHEETS, IF NECESSARY, TO COMPLETE WELL RECORD.

Date Received

Signature

President

Title

November 1, 1977

Date