

WELL PLUGGING RECORD

STATE OF KANSAS
STATE CORPORATION COMMISSION
Give All Information Completely
Make Required Affidavit
Mail or Deliver Report to:
Conservation Division
State Corporation Commission
211 No. Broadway
Wichita, Kansas

BARBER

County. Sec. 35 Twp. 31 Rge. 11 (X) W (W)

Location as "NE/CNW/SW" or footage from lines C SE SE

Lease Owner PETROLEUM INC.

Lease Name CHAPIN Well No. 1

Office Address ROUTE 2, GREAT BEND, KANSAS

Character of Well (completed as Oil, Gas or Dry Hole) DRY HOLE

Date well completed JANUARY 15 19 57

Application for plugging filed JANUARY 15 19 57

Application for plugging approved JANUARY 15 19 57

Plugging commenced JANUARY 15 19 57

Plugging completed JANUARY 15 19 57

Reason for abandonment of well or producing formation NO PRODUCIBLE ZONES

If a producing well is abandoned, date of last production NONE 19

Was permission obtained from the Conservation Division or its agents before plugging was commenced? YES

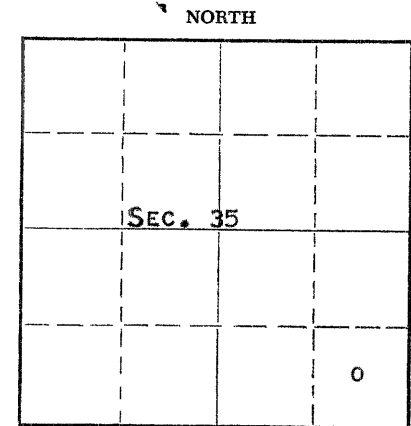

Locate well correctly on above Section Plat

Name of Conservation Agent who supervised plugging of this well M.A. RIVES, BOX 8, PRATT, KANSAS

Producing formation ----- Depth to top ----- Bottom ----- Total Depth of Well 4570 Feet

Show depth and thickness of all water, oil and gas formations.

OIL, GAS OR WATER RECORDS

CASING RECORD

FORMATION	CONTENT	FROM	TO	SIZE	PUT IN	PULLED OUT
				8 5/8" OD	249'	NONE

Describe in detail the manner in which the well was plugged, indicating where the mud fluid was placed and the method or methods used in introducing it into the hole. If cement or other plugs were used, state the character of same and depth placed, from _____ feet to _____ feet for each plug set.

MUD UP WITH HEAVY MUD TO 225', PUSHED DOWN 1/2 SACK HULLS TO 225' FOLLOWED BY WOODEN PLUG. PLACED 20 SACKS CEMENT THROUGH DRILL PIPE ON TO PLUG. MUD UP TO 35' AND PLACE 1/2 SACK HULLS AT 35' FOLLOWED BY WOODEN PLUG AND 10 SACKS CEMENT TO BASE OF WELL CELLAR.

(If additional description is necessary, use BACK of this sheet)

Name of Plugging Contractor HONAKER-DAVIS DRLG. CO.
Address 2008 LAKIN, GREAT BEND, KANSAS

STATE OF KANSAS, COUNTY OF BARTON, ss.
DON SEARLE (employee of owner) or (owner/operator) of the above-described

well, being first duly sworn on oath, says: That I have knowledge of the facts, statements, and matters herein contained and the log of the above-described well as filed and that the same are true and correct. So help me God.

(Signature) Don Searle

ROUTE 2, GREAT BEND, KANSAS (Address)

SUBSCRIBED AND SWORN TO before me this 22ND day of JANUARY, 1957

[Signature] Notary Public.

My commission expires JULY 11, 1960

PLUGGING
FILE SEC. 35 T. 31 R. 11W
BOOK PAGE 134 LINE 25

RECEIVED
STATE CORPORATION COMMISSION
1/25/57
JAN 25 1957
CONSERVATION DIVISION
Wichita, Kansas

DRILLERS LOG

15-007-

15-007-00367-00-00

Chapin No. 1
 Loc: Ctr. SE SE
 Sec: 35-31S-11W
 Barber County, Kansas
 Company: Garvey Drilling Co.
 Contractor: Monaker-Davis Drlg. Co.

Comm: 12-29-56
 Comp: 1-15-57
 Rotary Total Depth: 4570'
 Casing: 8-5/8" at 249'
 D & A

0	20	Surface Soil	
20	30	Sand	
30	250	Red Bed & Shale	8-5/8" casing cemented
250	980	Red Bed, Shale & Shells	at 249' with 200 sacks
980	1270	Shale & Shells	cement, 2% Jel and
1270	1375	Shale & Gyp	2% calcium chloride.
1375	1405	Anhydrite	
1405	1585	Shale & Shells	
1585	1775	Shale & Lime, Shells	
1775	1890	Shale, Shells & Sandy Lime Streaks	
1890	1980	Shale & Lime	
1980	2275	Lime & Shale	
2275	2350	Lime	
2350	3650	Shale & Lime	
3650	3705	Lime & Shale	
3705	3803	Shale & Sand	
3803	4426	Lime	
4426	4479	Lime & Chert	
4479	4510	Chert & Lime	
4510	4535	Lime & Chert	
4535	4548	Chert	
4548	4570	Lime & Chert	
4570		Total Rotary Depth	D & A

I certify that this is the true and correct copy of the above log to the best of my knowledge.

H. S. Forbes

H. S. Forbes

Subscribed and sworn to before me this 18th day of January 18, 1957.

Kenneth G. Fischer

Kenneth G. Fischer, Notary Public

My commission expires: 6-25-59

PLUGGING
 FILE NO. 35-31 R11W
 BOOK PAGE 134 LINE 25

RECEIVED
 STATE CORPORATION COMMISSION
 JAN 21 1957
 CORPORATION DIVISION
 Topeka