



For KCC Use:
 Effective Date: 02/03/2008
 District # 1
 SGA? Yes No

KANSAS CORPORATION COMMISSION 1015584
 OIL & GAS CONSERVATION DIVISION

Form C-1
 October 2007

Form must be Typed
 Form must be Signed
 All blanks must be Filled

NOTICE OF INTENT TO DRILL

Must be approved by KCC five (5) days prior to commencing well

Expected Spud Date: 02/15/2008
 month day year

OPERATOR: License# 5278
 Name: EOG Resources, Inc.
 Address 1: 3817 NW EXPRESSWAY STE 500
 Address 2:
 City: OKLAHOMA CITY State: OK Zip: 73112 + 1483
 Contact Person: MELISSA STURM
 Phone: 405-246-3234

CONTRACTOR: License# 34000
 Name: Kenai Mid-Continent, Inc.

Well Drilled For: Oil Gas Seismic Other
 Enh Rec Storage Disposal
 # of Holes
 Well Class: Infield Pool Ext. Wildcat Other
 Type Equipment: Mud Rotary Air Rotary Cable

If OWWO: old well information as follows:
 Operator:
 Well Name:
 Original Completion Date: Original Total Depth:

Directional, Deviated or Horizontal wellbore? Yes No
 If Yes, true vertical depth:
 Bottom Hole Location:
 KCC DKT #:

**PVPA 010802. PRORATED & SPACED:
 HUGOTON-PANOMA**

Spot Description:
 S2 SW NE NE Sec. 19 Twp. 31 S. R. 34 E W
 (0:0:0:0) 1,170 feet from N / S Line of Section
 990 feet from E / W Line of Section

Is SECTION: Regular Irregular?
 (Note: Locate well on the Section Plat on reverse side)

County: Seward
 Lease Name: LAHEY TRUST Well #: 19 #1
 Field Name: CUTTER

Is this a Prorated / Spaced Field? Yes No
 Target Formation(s): LANSING-KS CITY-MARMATON-UPR MORROW-ST. LOUIS

Nearest Lease or unit boundary line (in footage): 990
 Ground Surface Elevation: 2875 feet MSL
 Water well within one-quarter mile: Yes No
 Public water supply well within one mile: Yes No
 Depth to bottom of fresh water: 400
 Depth to bottom of usable water: 580
 Surface Pipe by Alternate: I II
 Length of Surface Pipe Planned to be set: 1700
 Length of Conductor Pipe (if any): 40
 Projected Total Depth: 5800
 Formation at Total Depth: ST. LOUIS

Water Source for Drilling Operations:
 Well Farm Pond Other:
 DWR Permit #: (Note: Apply for Permit with DWR)
 Will Cores be taken? Yes No
 If Yes, proposed zone:

AFFIDAVIT

The undersigned hereby affirms that the drilling, completion and eventual plugging of this well will comply with K.S.A. 55 et. seq.
 It is agreed that the following minimum requirements will be met:

1. Notify the appropriate district office **prior** to spudding of well;
2. A copy of the approved notice of intent to drill **shall be** posted on each drilling rig;
3. The minimum amount of surface pipe as specified below **shall be set** by circulating cement to the top; in all cases surface pipe **shall be set** through all unconsolidated materials plus a minimum of 20 feet into the underlying formation.
4. If the well is dry hole, an agreement between the operator and the district office on plug length and placement is necessary **prior to plugging**;
5. The appropriate district office will be notified before well is either plugged or production casing is cemented in;
6. If an ALTERNATE II COMPLETION, production pipe shall be cemented from below any usable water to surface within **120 DAYS** of spud date. Or pursuant to Appendix "B" - Eastern Kansas surface casing order #133,891-C, which applies to the KCC District 3 area, alternate II cementing must be completed within 30 days of the spud date or the well shall be plugged. **In all cases, NOTIFY district office** prior to any cementing.

Submitted Electronically

For KCC Use ONLY
 API # 15-175-22130-00-00
 Conductor pipe required 0 feet
 Minimum surface pipe required 600 feet per ALT. I II
 Approved by: Rick Hestermann 01/29/2008
 This authorization expires: 01/29/2009
 (This authorization void if drilling not started within 12 months of approval date.)
 Spud date: Agent:

Remember to:

- File Drill Pit Application (form CDP-1) with Intent to Drill;
- File Completion Form ACO-1 within 120 days of spud date;
- File acreage attribution plat according to field proration orders;
- Notify appropriate district office 48 hours prior to workover or re-entry;
- Submit plugging report (CP-4) after plugging is completed (within 60 days);
- Obtain written approval before disposing or injecting salt water.
- If this permit has expired (See: authorized expiration date) please check the box below and return to the address below.

Well Not Drilled - Permit Expired Date: Signature of Operator or Agent:

19 31 34 E W



1015584

IN ALL CASES PLOT THE INTENDED WELL ON THE PLAT BELOW

Plat of acreage attributable to a well in a prorated or spaced field

If the intended well is in a prorated or spaced field, please fully complete this side of the form. If the intended well is in a prorated or spaced field complete the plat below showing that the well will be properly located in relationship to other wells producing from the common source of supply. Please show all the wells and within 1 mile of the boundaries of the proposed acreage attribution unit for gas wells and within 1/2 mile of the boundaries of the proposed acreage attribution unit for oil wells.

API No. 15 - 15-175-22130-00-00
 Operator: EOG Resources, Inc.
 Lease: LAHEY TRUST
 Well Number: 19 #1
 Field: CUTTER
 Number of Acres attributable to well: _____
 QTR/QTR/QTR/QTR of acreage: S2 - SW - NE - NE

Location of Well: County: Seward
 1,170 feet from N / S Line of Section
 990 feet from E / W Line of Section
 Sec. 19 Twp. 31 S. R. 34 E W

Is Section: Regular or Irregular

If Section is Irregular, locate well from nearest corner boundary.

Section corner used: NE NW SE SW

PLAT

(Show location of the well and shade attributable acreage for prorated or spaced wells.)

(Show footage to the nearest lease or unit boundary line.)

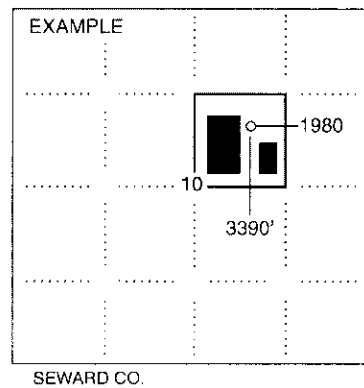
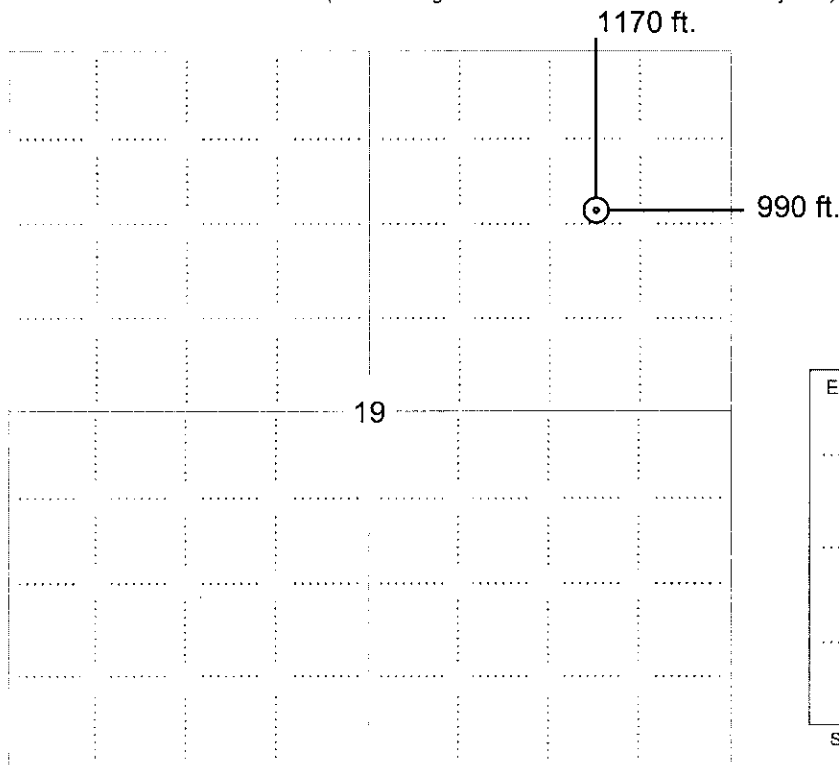

NOTE: In all cases locate the spot of the proposed drilling location.

In plotting the proposed location of the well, you must show:

1. The manner in which you are using the depicted plat by identifying section lines, i.e. 1 section, 1 section with 8 surrounding sections, 4 sections, etc.
2. The distance of the proposed drilling location from the south / north and east / west outside section lines.
3. The distance to the nearest lease or unit boundary line (in footage).
4. If proposed location is located within a prorated or spaced field a certificate of acreage attribution plat must be attached: (CO-7 for oil wells; CG-8 for gas wells).



KANSAS CORPORATION COMMISSION 1015584
OIL & GAS CONSERVATION DIVISION

Form CDP-1
April 2004
Form must be Typed

APPLICATION FOR SURFACE PIT

Submit in Duplicate

| | | |
|--|--|---|
| Operator Name: EOG Resources, Inc. | | License Number: 5278 |
| Operator Address: 3817 NW EXPRESSWAY STE 500 | | OKLAHOMA CITY OK 73112 |
| Contact Person: MELISSA STURM | | Phone Number: 405-246-3234 |
| Lease Name & Well No.: LAHEY TRUST 19 #1 | | Pit Location (QQQQ): S2 SW NE NE |
| Type of Pit: <input type="checkbox"/> Emergency Pit <input type="checkbox"/> Burn Pit <input type="checkbox"/> Settling Pit <input checked="" type="checkbox"/> Drilling Pit <input type="checkbox"/> Workover Pit <input type="checkbox"/> Haul-Off Pit <small>(If WP Supply API No. or Year Drilled)</small> | | Pit is: <input checked="" type="checkbox"/> Proposed <input type="checkbox"/> Existing If Existing, date constructed: _____ Pit capacity: 12,500 (bbls) |
| Is the pit located in a Sensitive Ground Water Area? <input type="checkbox"/> Yes <input checked="" type="checkbox"/> No | | Chloride concentration: _____ mg/l <small>(For Emergency Pits and Settling Pits only)</small> |
| Is the bottom below ground level? <input checked="" type="checkbox"/> Yes <input type="checkbox"/> No | | Artificial Liner? <input type="checkbox"/> Yes <input checked="" type="checkbox"/> No |
| How is the pit lined if a plastic liner is not used? SOIL COMPACTION | | |
| Pit dimensions (all but working pits): <u>125</u> Length (feet) <u>125</u> Width (feet) <input type="checkbox"/> N/A: Steel Pits Depth from ground level to deepest point: <u>5</u> (feet) <input type="checkbox"/> No Pit | | |
| If the pit is lined give a brief description of the liner material, thickness and installation procedure. | | Describe procedures for periodic maintenance and determining liner integrity, including any special monitoring. |
| Distance to nearest water well within one-mile of pit <u>1814</u> feet Depth of water well <u>235</u> feet | | Depth to shallowest fresh water <u>130</u> feet. Source of information: <input type="checkbox"/> measured <input type="checkbox"/> well owner <input type="checkbox"/> electric log <input checked="" type="checkbox"/> KDWR |
| Emergency, Settling and Burn Pits ONLY: Producing Formation: _____ Number of producing wells on lease: _____ Barrels of fluid produced daily: _____ Does the slope from the tank battery allow all spilled fluids to flow into the pit? <input type="checkbox"/> Yes <input type="checkbox"/> No | | Drilling, Workover and Haul-Off Pits ONLY: Type of material utilized in drilling/workover: <u>GEL</u> Number of working pits to be utilized: <u>0</u> Abandonment procedure: <u>EVAPORATION / DEWATER AND BACKFILLING OF RESERVE PIT</u> Drill pits must be closed within 365 days of spud date. |
| <p>Submitted Electronically</p> | | |

| | | | | |
|----------------------------------|--|------------------------------------|---|-------------------------------|
| KCC OFFICE USE ONLY | | Steel Pit <input type="checkbox"/> | RFAC <input type="checkbox"/> | RFAS <input type="checkbox"/> |
| Date Received: <u>01/14/2008</u> | Permit Number: <u>15-175-22130-00-00</u> | Permit Date: <u>01/29/2008</u> | Lease Inspection: <input type="checkbox"/> Yes <input checked="" type="checkbox"/> No | |

Mail to: KCC - Conservation Division, 130 S. Market - Room 2078, Wichita, Kansas 67202

KANSAS CORPORATION COMMISSION
 CONSERVATION DIVISION
 130 S. Market - Room 2078
 Wichita, Kansas 67202

Form VPA-1
 4/01

VERIFIED AFFIDAVIT FOR USE OF MUD AS AN
 ALTERNATIVE TO THE CEMENTING REQUIREMENT IN §18(D)
 OF THE PANOMA COUNCIL GROVE B.P.O.

FORM MUST BE TYPED

Submit in Duplicate
 Attach to Drilling Permit

| | | | | | |
|---|----------------------|--|-------------|--|--|
| Operator Name EOG Resources, Inc. | | | | KCC License No. 5278 | |
| Operator Address 3817 NW Expressway Suite #500 Oklahoma City, OK 73112 | | | | | |
| Contact Person Melissa Sturm | | | | Telephone No. (405) 246-3234 | |
| Lease Name & No. Lahey Trust 19 #1 | | API No. | | KCC Lease Code No. | |
| Location Quarter NE/4 | Section 19 | Township 31S | Range 34 | 1170 E <u>W</u> (circle one) 990 | FL from <u>N</u> S (circle one) Line of Sec. FL from <u>E</u> W (circle one) Line of Sec. |
| County Seward | Field Name Cutter | Producing Formation Group Lansing-KS City-Marmaton-Upper Morrow-St. Louis | | Mud Weight 8.7 | |

AFFIDAVIT CERTIFICATE OF SERVICE

All requirements of the statutes, rules and regulations promulgated to regulate the oil and gas industry have been fully complied with and the statements here are complete and correct to the best of my knowledge. The well subscribed to in this Affidavit will be completed in accordance with all applicable rules and regulations of the KCC. However, applicant intends to use drilling mud of sufficient weight across the interval between the base of the Council Grove Group and the top of the Chase Group as an alternative to the cementing requirements found in paragraph 18(D) of the Panoma Council Grove B.P.O. unless an objection is filed within 15 days of service of this Affidavit. I hereby certify that I caused a true and correct copy of the foregoing Affidavit and any attachments of said Affidavit to be served by placing the same in the United States mail, postage prepaid, to the following parties, which represent all of the operators or lessees of record and the owners of record of unleased acreage within a one mile radius of the well, including operators and working interest owners having interests in the lands covered by the unit on which the well is to be drilled:

Signature Melissa Sturm Date 1/14/08

Title Sr. Operations Assistant

Subscribed and sworn to before me this 14th day of January, 2008

Notary Public Kaye Dawn Rockel

Date Commission Expires _____

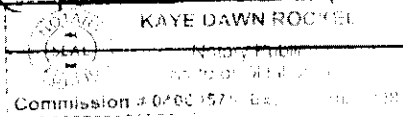

Exhibit "A"
Lahey Trust 19 #1
Section 19-31S-34W
Seward County, Kansas

Page 1 of 1

1. Becker Oil Corp.
P.O. Box 1150
Ponca City, OK 74602-1150

2. Beredco, Inc.
c/o Berexco, Inc.
P.O. Box 20380
Wichita, KS 67208-1380

3. Cimarex Energy Company
1700 Lincoln Street, Suite 1800
Denver, CO 80203

4. ExxonMobil Production Company
P.O. Box 4610
Houston, TX 77210-4610

5. Helmerich & Payne Inc.
1437 S. Boulder Ave.
Tulsa, OK 74119-3623

6. McCoy Petroleum Corporation
8080 East Central Ave., Suite 300
Wichita, Kansas 67206

7. Mesa Operating Limited Partnership
c/o Pioneer Natural Resources
Company
5205 N O'Connor Blvd., Ste 900
Irving, TX 75039-3746

8. OXY USA, Inc.
P.O. Box 27570
Houston, TX 77227-7570

End of Exhibit "A"



*Kathleen Sebelius, Governor
Thomas E. Wright, Chairman
Robert E. Krehbiel, Commissioner
Michael C. Moffet, Commissioner*

January 29, 2008

Melissa Sturm
EOG Resources, Inc.
3817 NW Expressway, Suite 500
Oklahoma City, OK 73112

Re: Lahey Trust 19 #1, API #15-175-22130-0000
Docket # PVPA 010802
NE Sec.19-T31S-R34W
Seward County, Kansas

Dear Ms. Sturm,

The form VPA-1 affidavit filed for the above-referenced well stated that service of the affidavit was mailed on January 14, 2008. The fifteen (15) day protest period has expired and we have not received any protests. Therefore, we are advising you that the drilling of this well may commence and, in lieu of cement, drilling mud of the weight specified in your affidavit may be used across the interval between the base of the Council Grove group and the top of the Chase group.

KCC
Production Department