



For KCC Use:  
 Effective Date: 02/09/2008  
 District # 1  
 SGA?  Yes  No

KANSAS CORPORATION COMMISSION 1016000  
 OIL & GAS CONSERVATION DIVISION

Form C-1  
 October 2007

Form must be Typed  
 Form must be Signed  
 All blanks must be Filled

**NOTICE OF INTENT TO DRILL**

Must be approved by KCC five (5) days prior to commencing well

Expected Spud Date: 02/02/2008  
 month day year

OPERATOR: License# 32972  
 Name: The South Forty, Inc.  
 Address 1: PO BOX 446  
 Address 2:  
 City: LAVERNE State: OK Zip: 73848 + 0446  
 Contact Person: Allen Barby  
 Phone: 580-921-3366  
 CONTRACTOR: License# 33549  
 Name: Landmark Drilling, LLC

Spot Description:  
 NE NE SW NE Sec. 15 Twp. 34 S. R. 22  E  W  
 (0.0/0.0) 3,950 feet from  N /  S Line of Section  
 1,331 feet from  E /  W Line of Section

Is SECTION:  Regular  Irregular?  
 (Note: Locate well on the Section Plat on reverse side)

County: Clark  
 Lease Name: Shurtleff Well #: 2-15  
 Field Name: Snake Creek West

Is this a Prorated / Spaced Field?  Yes  No  
 Target Formation(s): Morrow

Nearest Lease or unit boundary line (in footage): 1331  
 Ground Surface Elevation: 1854 feet MSL

Water well within one-quarter mile:  Yes  No  
 Public water supply well within one mile:  Yes  No

Depth to bottom of fresh water: 100  
 Depth to bottom of usable water: 180

Surface Pipe by Alternate:  I  II  
 Length of Surface Pipe Planned to be set: 750

Length of Conductor Pipe (if any):  
 Projected Total Depth: 5600

Formation at Total Depth: Morrow  
 Water Source for Drilling Operations:

Well  Farm Pond  Other:  
 DWR Permit #: (Note: Apply for Permit with DWR )

Will Cores be taken?  Yes  No  
 If Yes, proposed zone:

Well Drilled For:	Well Class:	Type Equipment:
<input checked="" type="checkbox"/> Oil	<input type="checkbox"/> Enh Rec	<input checked="" type="checkbox"/> Infield
<input type="checkbox"/> Gas	<input type="checkbox"/> Storage	<input type="checkbox"/> Pool Ext.
<input type="checkbox"/> Seismic; # of Holes	<input type="checkbox"/> Disposal	<input type="checkbox"/> Wildcat
<input type="checkbox"/> Other:	<input type="checkbox"/> Other	<input type="checkbox"/> Cable

If OWWO: old well information as follows:

Operator:  
 Well Name:  
 Original Completion Date: Original Total Depth:

Directional, Deviated or Horizontal wellbore?  Yes  No

If Yes, true vertical depth:

Bottom Hole Location:

KCC DKT #:

**AFFIDAVIT**

The undersigned hereby affirms that the drilling, completion and eventual plugging of this well will comply with K.S.A. 55 et. seq.

It is agreed that the following minimum requirements will be met:

1. Notify the appropriate district office **prior** to spudding of well;
2. A copy of the approved notice of intent to drill **shall be** posted on each drilling rig;
3. The minimum amount of surface pipe as specified below **shall be set** by circulating cement to the top; in all cases surface pipe **shall be set** through all unconsolidated materials plus a minimum of 20 feet into the underlying formation.
4. If the well is dry hole, an agreement between the operator and the district office on plug length and placement is necessary **prior to plugging**;
5. The appropriate district office will be notified before well is either plugged or production casing is cemented in;
6. If an ALTERNATE II COMPLETION, production pipe shall be cemented from below any usable water to surface within **120 DAYS** of spud date. Or pursuant to Appendix "B" - Eastern Kansas surface casing order #133,891-C, which applies to the KCC District 3 area, alternate II cementing must be completed within 30 days of the spud date or the well shall be plugged. **In all cases, NOTIFY district office** prior to any cementing.

**Submitted Electronically**

**For KCC Use ONLY**  
 API # 15 - 15-025-21477-00-00  
 Conductor pipe required 0 feet  
 Minimum surface pipe required 200 feet per ALT.  I  II  
 Approved by: Walter Moody 02/04/2008  
 This authorization expires: 02/04/2009  
 (This authorization void if drilling not started within 12 months of approval date.)  
 Spud date: Agent:

**Remember to:**

- File Drill Pit Application (form CDP-1) with Intent to Drill;
- File Completion Form ACO-1 within 120 days of spud date;
- File acreage attribution plat according to field proration orders;
- Notify appropriate district office 48 hours prior to workover or re-entry;
- Submit plugging report (CP-4) after plugging is completed (within 60 days);
- Obtain written approval before disposing or injecting salt water.
- If this permit has expired (See: authorized expiration date) please check the box below and return to the address below.

Well Not Drilled - Permit Expired Date: Signature of Operator or Agent:

15 34 22  
 E  W



1016000

### IN ALL CASES PLOT THE INTENDED WELL ON THE PLAT BELOW

*Plat of acreage attributable to a well in a prorated or spaced field*

**If the intended well is in a prorated or spaced field, please fully complete this side of the form.** If the intended well is in a prorated or spaced field complete the plat below showing that the well will be properly located in relationship to other wells producing from the common source of supply. Please show all the wells and within 1 mile of the boundaries of the proposed acreage attribution unit for gas wells and within 1/2 mile of the boundaries of the proposed acreage attribution unit for oil wells.

API No. 15 - 15-025-21477-00-00  
 Operator: The South Forty, Inc.  
 Lease: Shurtleff  
 Well Number: 2-15  
 Field: Snake Creek West

Location of Well: County: Clark  
 3,950 feet from  N /  S Line of Section  
 1,331 feet from  E /  W Line of Section  
 Sec. 15 Twp. 34 S. R. 22  E  W

Number of Acres attributable to well: \_\_\_\_\_  
 QTR/QTR/QTR/QTR of acreage:  NE  NE  SW  NE

Is Section:  Regular or  Irregular

**If Section is Irregular, locate well from nearest corner boundary.**

Section corner used:  NE  NW  SE  SW

### PLAT

*(Show location of the well and shade attributable acreage for prorated or spaced wells.)  
 (Show footage to the nearest lease or unit boundary line.)*

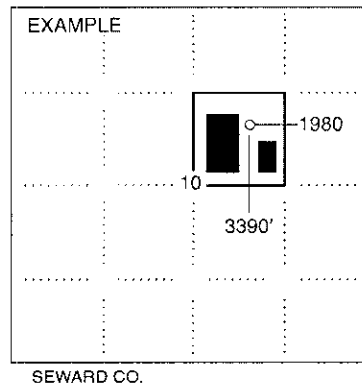
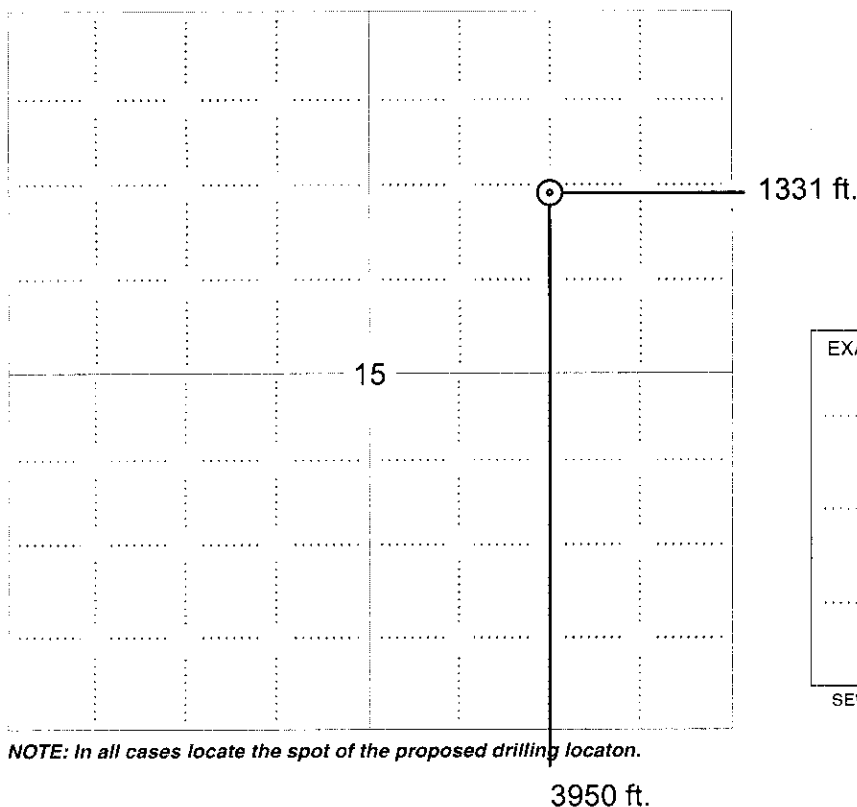

**NOTE: In all cases locate the spot of the proposed drilling location.**

**In plotting the proposed location of the well, you must show:**

1. The manner in which you are using the depicted plat by identifying section lines, i.e. 1 section, 1 section with 8 surrounding sections, 4 sections, etc.
2. The distance of the proposed drilling location from the south / north and east / west outside section lines.
3. The distance to the nearest lease or unit boundary line (in footage).
4. If proposed location is located within a prorated or spaced field a certificate of acreage attribution plat must be attached: (CO-7 for oil wells; CG-8 for gas wells).



KANSAS CORPORATION COMMISSION 1016000  
OIL & GAS CONSERVATION DIVISION

Form CDP-1  
April 2004  
Form must be Typed

**APPLICATION FOR SURFACE PIT**

Submit in Duplicate

Operator Name: The South Forty, Inc.		License Number: 32972	
Operator Address: PO BOX 446		LAVERNE OK 73848	
Contact Person: Allen Barby		Phone Number: 580-921-3366	
Lease Name & Well No.: Shurtleff 2-15		Pit Location (QQQQ): NE NE SW NE Sec. 15 Twp. 34 R. 22 <input type="checkbox"/> East <input checked="" type="checkbox"/> West 3,950 Feet from <input type="checkbox"/> North / <input checked="" type="checkbox"/> South Line of Section 1,331 Feet from <input checked="" type="checkbox"/> East / <input type="checkbox"/> West Line of Section Clark County	
Type of Pit: <input type="checkbox"/> Emergency Pit <input type="checkbox"/> Burn Pit <input type="checkbox"/> Settling Pit <input checked="" type="checkbox"/> Drilling Pit <input type="checkbox"/> Workover Pit <input type="checkbox"/> Haul-Off Pit <i>(If WP Supply API No. or Year Drilled)</i>		Pit is: <input checked="" type="checkbox"/> Proposed <input type="checkbox"/> Existing If Existing, date constructed: _____ Pit capacity: 600 (bbls)	
Is the pit located in a Sensitive Ground Water Area? <input checked="" type="checkbox"/> Yes <input type="checkbox"/> No		Chloride concentration: _____ mg/l <i>(For Emergency Pits and Settling Pits only)</i>	
Is the bottom below ground level? <input checked="" type="checkbox"/> Yes <input type="checkbox"/> No		Artificial Liner? <input type="checkbox"/> Yes <input checked="" type="checkbox"/> No	
How is the pit lined if a plastic liner is not used? Native Clay			
Pit dimensions (all but working pits): _____ Length (feet) _____ Width (feet) <input type="checkbox"/> N/A: Steel Pits Depth from ground level to deepest point: _____ (feet) <input type="checkbox"/> No Pit			
If the pit is lined give a brief description of the liner material, thickness and installation procedure.		Describe procedures for periodic maintenance and determining liner integrity, including any special monitoring.	
Distance to nearest water well within one-mile of pit 1726 feet    Depth of water well 66 feet		Depth to shallowest fresh water 20 feet. Source of information: <input type="checkbox"/> measured <input type="checkbox"/> well owner <input type="checkbox"/> electric log <input checked="" type="checkbox"/> KDWR	
<b>Emergency, Settling and Burn Pits ONLY:</b> Producing Formation: _____ Number of producing wells on lease: _____ Barrels of fluid produced daily: _____ Does the slope from the tank battery allow all spilled fluids to flow into the pit? <input type="checkbox"/> Yes <input type="checkbox"/> No		<b>Drilling, Workover and Haul-Off Pits ONLY:</b> Type of material utilized in drilling/workover: drilling mud Number of working pits to be utilized: 2 Abandonment procedure: Air dry and backfill _____ Drill pits must be closed within 365 days of spud date.	
Submitted Electronically			

<b>KCC OFFICE USE ONLY</b>		Steel Pit <input type="checkbox"/>	RFAC <input checked="" type="checkbox"/>	RFAS <input checked="" type="checkbox"/>
Date Received: 01/25/2008	Permit Number: 15-025-21477-00-00	Permit Date: 02/01/2008	Lease Inspection: <input checked="" type="checkbox"/> Yes <input type="checkbox"/> No	