

For KCC Use:

Effective Date: 2-12-08

District # 1

SGA? ☐ Yes ☒ No

KANSAS CORPORATION COMMISSION
OIL & GAS CONSERVATION DIVISION

NOTICE OF INTENT TO DRILL

Must be approved by KCC five (5) days prior to commencing well

Form C-1

October 2007

Form must be Typed

Form must be Signed

All blanks must be Filled

Expected Spud Date: 2 month 25 day 2008 year

OPERATOR: License# 5822 ✓

Name: VAL Energy Inc.

Address 1: 200 West Douglas #520

Address 2: _____

City: Wichita State: Ks Zip: 67202 + _____

Contact Person: K Todd Allam

Phone: 316-263-6688

CONTRACTOR: License# 5822 ✓

Name: VAL Energy Inc.

Well Drilled For:

☒ Oil ☐ Gas ☐ Enh Rec ☐ Storage ☐ Disposal ☐ Seismic; _____ # of Holes ☐ Other: _____

Well Class:

☒ Infield ☐ Pool Ext. ☐ Wildcat ☐ Other

Type Equipment:

☒ Mud Rotary ☐ Air Rotary ☐ Cable

☐ If OWWO: old well information as follows:

Operator: _____

Well Name: _____

Original Completion Date: _____ Original Total Depth: _____

Directional, Deviated or Horizontal wellbore? ☐ Yes ☒ No

If Yes, true vertical depth: _____

Bottom Hole Location: _____

KCC DKT #: _____

Spot Description: C W/3 E/2 SE/4
C W/2 E/2 SE/4 Sec. 4 Twp. 33 S. R. 12 ☐ E ☒ W
(Q/Q/Q) 1,320 feet from ☐ N / ☒ S Line of Section
990 feet from ☒ E / ☐ W Line of Section

Is SECTION: ☒ Regular ☐ Irregular?

(Note: Locate well on the Section Plat on reverse side)

County: Barber

Lease Name: Ply Well #: 2-4

Field Name: Medicine Lodge - Biggs

Is this a Prorated / Spaced Field? ☐ Yes ☒ No

Target Formation(s): Miss.

Nearest Lease or unit boundary line (in footage): 330

Ground Surface Elevation: 1508 est. _____ feet MSL

Water well within one-quarter mile: ☐ Yes ☒ No

Public water supply well within one mile: ☐ Yes ☒ No

Depth to bottom of fresh water: 180

Depth to bottom of usable water: 180

Surface Pipe by Alternate: ☒ I ☐ II

Length of Surface Pipe Planned to be set: 250

Length of Conductor Pipe (if any): none

Projected Total Depth: 4750

Formation at Total Depth: Mississippian

Water Source for Drilling Operations:

☐ Well ☒ Farm Pond ☐ Other: _____

DWR Permit #: _____

(Note: Apply for Permit with DWR ☒)

Will Cores be taken? ☐ Yes ☒ No

If Yes, proposed zone: _____

RECEIVED
KANSAS CORPORATION COMMISSION

AFFIDAVIT

The undersigned hereby affirms that the drilling, completion and eventual plugging of this well will comply with K.S.A. 55 et. seq.

It is agreed that the following minimum requirements will be met:

1. Notify the appropriate district office **prior** to spudding of well;
2. A copy of the approved notice of intent to drill **shall be posted** on each drilling rig;
3. The minimum amount of surface pipe as specified below **shall be set** by circulating cement to the top; in all cases surface pipe **shall be set** through all unconsolidated materials plus a minimum of 20 feet into the underlying formation.
4. If the well is dry hole, an agreement between the operator and the district office on plug length and placement is necessary **prior to plugging**;
5. The appropriate district office will be notified before well is either plugged or production casing is cemented in;
6. If an ALTERNATE II COMPLETION, production pipe shall be cemented from below any usable water to surface within **120 DAYS** of spud date. Or pursuant to Appendix "B" - Eastern Kansas surface casing order #133,891-C, which applies to the KCC District 3 area, alternate II cementing must be completed within 30 days of the spud date or the well shall be plugged. **In all cases, NOTIFY district office** prior to any cementing.

I hereby certify that the statements made herein are true and correct to the best of my knowledge and belief.

Date: 1/31/08 Signature of Operator or Agent: K Todd Allam Title: President

For KCC Use ONLY

API # 15 - 007-23258-0000

Conductor pipe required None feet

Minimum surface pipe required 200 feet per ALT. ☒ I ☐ II

Approved by: 1/27/08

This authorization expires: 2-7-09

(This authorization void if drilling not started within 12 months of approval date.)

Spud date: _____ Agent: _____

Remember to:

- File Drill Pit Application (form CDP-1) with Intent to Drill;
- File Completion Form ACO-1 within 120 days of spud date;
- File acreage attribution plat according to field proration orders;
- Notify appropriate district office 48 hours prior to workover or re-entry;
- Submit plugging report (CP-4) after plugging is completed (within 60 days);
- Obtain written approval before disposing or injecting salt water.
- If this permit has expired (See: authorized expiration date) please check the box below and return to the address below.

☐ Well Not Drilled - Permit Expired Date: _____

Signature of Operator or Agent: _____

Mail to: KCC - Conservation Division, 130 S. Market - Room 2078, Wichita, Kansas 67202

JAN 31 2008

CONSERVATION DIVISION
WICHITA, KS

4
33
12
☐ E
☒ W

IN ALL CASES PLOT THE INTENDED WELL ON THE PLAT BELOW*Plat of acreage attributable to a well in a prorated or spaced field*

If the intended well is in a prorated or spaced field, please fully complete this side of the form. If the intended well is in a prorated or spaced field complete the plat below showing that the well will be properly located in relationship to other wells producing from the common source of supply. Please show all the wells and within 1 mile of the boundaries of the proposed acreage attribution unit for gas wells and within 1/2 mile of the boundaries of the proposed acreage attribution unit for oil wells.

API No. 15 - 007-232580000Operator: VAL Energy Inc.Lease: PlyeWell Number: 2-4

Field: _____

Number of Acres attributable to well: _____

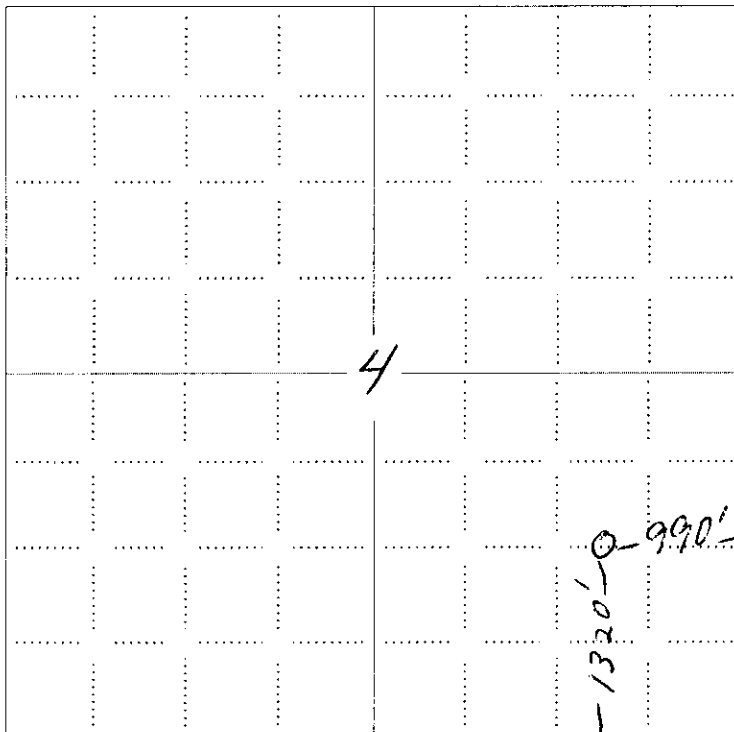
QTR/QTR/QTR/QTR of acreage: C - W/2 - E/2 - SE/4Location of Well: County: Barber1,320 feet from ☐ N / ☒ S Line of Section990 feet from ☐ E / ☐ W Line of SectionSec. 4 Twp. 33 S. R. 12 ☐ E ☒ WIs Section: ☒ Regular or ☐ Irregular**If Section is Irregular, locate well from nearest corner boundary.**Section corner used: ☐ NE ☐ NW ☐ SE ☐ SW**PLAT***(Show location of the well and shade attributable acreage for prorated or spaced wells.)**(Show footage to the nearest lease or unit boundary line.)***NOTE: In all cases locate the spot of the proposed drilling location.**

RECEIVED
KANSAS CORPORATION COMMISSION

JAN 31 2008

CONSERVATION DIVISION
WICHITA, KS

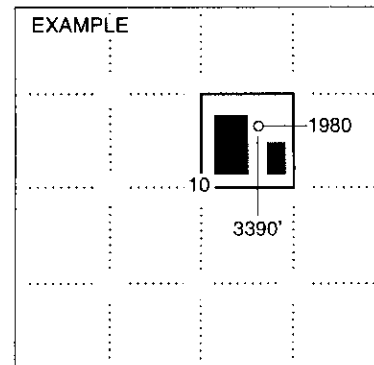

SEWARD CO.

In plotting the proposed location of the well, you must show:

1. The manner in which you are using the depicted plat by identifying section lines, i.e. 1 section, 1 section with 8 surrounding sections, 4 sections, etc.
2. The distance of the proposed drilling location from the south / north and east / west outside section lines.
3. The distance to the nearest lease or unit boundary line (in footage).
4. If proposed location is located within a prorated or spaced field a certificate of acreage attribution plat must be attached: (CO-7 for oil wells; CG-8 for gas wells).

**KANSAS CORPORATION COMMISSION
OIL & GAS CONSERVATION DIVISION
APPLICATION FOR SURFACE PIT**

Form CDP-1
April 2004
Form must be Typed

Submit in Duplicate

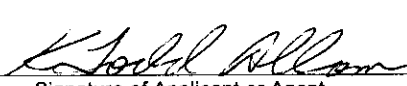
Operator Name: VAL Energy Inc.		License Number: 5822	
Operator Address: 200 West Douglas #520		Wichita Ks 67202	
Contact Person: K Todd Allam		Phone Number: 316-263-6688	
Lease Name & Well No.: Plye 2-4		Pit Location (QQQQ): C W/2 E/2 SE/4 Sec. 4 Twp. 33 R. 12 <input type="checkbox"/> East <input checked="" type="checkbox"/> West 1,320 Feet from <input type="checkbox"/> North / <input checked="" type="checkbox"/> South Line of Section 990 Feet from <input checked="" type="checkbox"/> East / <input type="checkbox"/> West Line of Section Barber County	
Type of Pit: <input type="checkbox"/> Emergency Pit <input type="checkbox"/> Burn Pit <input type="checkbox"/> Settling Pit <input checked="" type="checkbox"/> Drilling Pit <input type="checkbox"/> Workover Pit <input type="checkbox"/> Haul-Off Pit <small>(If WP Supply API No. or Year Drilled)</small>		Pit is: <input checked="" type="checkbox"/> Proposed <input type="checkbox"/> Existing If Existing, date constructed: _____ Pit capacity: 3,000 (bbis)	
Is the pit located in a Sensitive Ground Water Area? <input type="checkbox"/> Yes <input checked="" type="checkbox"/> No		Chloride concentration: _____ mg/l <small>(For Emergency Pits and Settling Pits only)</small>	
Is the bottom below ground level? <input checked="" type="checkbox"/> Yes <input type="checkbox"/> No		Artificial Liner? <input type="checkbox"/> Yes <input checked="" type="checkbox"/> No	
How is the pit lined if a plastic liner is not used?			
Pit dimensions (all but working pits): 120 Length (feet) 120 Width (feet) <input type="checkbox"/> N/A: Steel Pits Depth from ground level to deepest point: 4 (feet) <input type="checkbox"/> No Pit			
If the pit is lined give a brief description of the liner material, thickness and installation procedure.		Describe procedures for periodic maintenance and determining liner integrity, including any special monitoring.	
		<div align="right"> RECEIVED KANSAS CORPORATION COMMISSION JAN 31 2008 CONSERVATION DIVISION WICHITA, KS </div>	
Distance to nearest water well within one-mile of pit NA feet Depth of water well _____ feet		Depth to shallowest fresh water _____ feet. Source of information: <input type="checkbox"/> measured <input type="checkbox"/> well owner <input type="checkbox"/> electric log <input type="checkbox"/> KDWR	
Emergency, Settling and Burn Pits ONLY: Producing Formation: _____ Number of producing wells on lease: _____ Barrels of fluid produced daily: _____ Does the slope from the tank battery allow all spilled fluids to flow into the pit? <input type="checkbox"/> Yes <input type="checkbox"/> No		Drilling, Workover and Haul-Off Pits ONLY: Type of material utilized in drilling/workover: fresh mud Number of working pits to be utilized: 1 Abandonment procedure: let dry and cover Drill pits must be closed within 365 days of spud date.	
I hereby certify that the above statements are true and correct to the best of my knowledge and belief.			
1/31/08 Date		 Signature of Applicant or Agent	

15-007-23 258-0320

KCC OFFICE USE ONLY		Steel Pit <input type="checkbox"/>	RFAC <input checked="" type="checkbox"/> RFAS <input checked="" type="checkbox"/>
Date Received: 1/31/08	Permit Number: _____	Permit Date: 2/7/08	Lease Inspection: <input checked="" type="checkbox"/> Yes <input type="checkbox"/> No

Mail to: KCC - Conservation Division, 130 S. Market - Room 2078, Wichita, Kansas 67202



*Kathleen Sebelius, Governor
Thomas E. Wright, Chairman
Michael C. Moffet, Commissioner
Joseph F. Harkins, Commissioner*

February 7, 2008

Mr. Todd Allam
VAL Energy, Inc.
200 W. Douglas, Ste 520
Wichita, KS 67202

RE: Drilling Pit Application
Plye Lease Well No. 2-4
SE/4 Sec. 04-33S-12W
Barber County, Kansas

Dear Mr. Allam:

District staff has inspected the above referenced location and has determined that the reserve pit shall be constructed **without slots**, the bottom shall be flat and reasonably level and the free fluids must be removed. The fluids are to be removed from the reserve pit as soon as the Hutchinson Salt section has been drilled through and displacement of the fluids into the reserve pit has occurred. The fluids should be removed again as soon as practical after drilling operations have ceased.
Keep pits to the west or southwest of the stake high up on ridge.

If production casing is set all completion fluids shall be removed from the working pits daily. NO completion fluids or non-exempt wastes shall be placed in the reserve pit.

The fluids should be taken to an authorized disposal well. Please call the District Office at (620) 225-8888 when the fluids have been removed. Please file form CDP-5 (August 2004), Exploration and Production Waste Transfer, within 30 days of fluid removal. Conservation division forms are available through our office and on the KCC web site: www.kcc.state.ks.us/conservation/forms.

A copy of this letter should be posted in the doghouse along with the approved Intent to Drill.

If you have any questions or concerns please feel free to contact the undersigned at the above address.

Sincerely,

Kathy Haynes
Department of Environmental Protection and Remediation

cc: File