

* Location Correction

For KCC Use:
 Effective Date: 2-5-08
 District # 3
 SGA? Yes No

KANSAS CORPORATION COMMISSION
 OIL & GAS CONSERVATION DIVISION

Form C-1
 October 2007
 Form must be Typed
 Form must be Signed
 Blanks must be Filled

NOTICE OF INTENT TO DRILL **CORRECTED**
 Must be approved by KCC five (5) days prior to commencing well

Expected Spud Date: February 4, 2008
month day year

OPERATOR: License# 33344
 Name: Quest Cherokee, LLC
 Address 1: 210 W. Park Ave., Suite 2750
 Address 2: _____
 City: Oklahoma City State: OK Zip: 73102
 Contact Person: Richard Martin
 Phone: 405-702-7480
 CONTRACTOR: License# 33837 or another Licensed by KCC
 Name: Will advise on the ACO-1

Spot Description: _____
N/2 - S/2 - SW Sec. 17 Twp. 29 S. R. 20 E W
(or 0000) 990 feet from N / S Line of Section
 * 1,320 - 1,170 feet from E / W Line of Section
 Is SECTION: Regular Irregular?

(Note: Locate well on the Section Plat on reverse side)

County: Neosho
 Lease Name: Janssen, Donald E. Well #: 17-1
 Field Name: Cherokee Basin CBM

Is this a Prorated / Spaced Field? Yes No

Target Formation(s): Cherokee Coals

Nearest Lease or unit boundary line (in footage): 330
 Ground Surface Elevation: 808 feet MSL

Water well within one-quarter mile: Yes No

Public water supply well within one mile: Yes No

Depth to bottom of fresh water: 100

Depth to bottom of usable water: 150

Surface Pipe by Alternate: I II

Length of Surface Pipe Planned to be set: 25

Length of Conductor Pipe (if any): _____

Projected Total Depth: 1500

Formation at Total Depth: Cherokee Coals

Water Source for Drilling Operations:
 Well Farm Pond Other: Air

DWR Permit #: _____
 (Note: Apply for Permit with DWR)

Will Cores be taken? Yes No

If Yes, proposed zone: _____

RECEIVED
 KANSAS CORPORATION COMMISSION

Well Drilled For: Oil Gas Enh Rec Storage Disposal Seismic; # of Holes _____ Other: Coalbed Methane

Well Class: Infield Pool Ext. Wildcat Other _____

Type Equipment: Mud Rotary Air Rotary Cable

If OWWO: old well information as follows:

Operator: _____
 Well Name: _____
 Original Completion Date: _____ Original Total Depth: _____

Directional, Deviated or Horizontal wellbore? Yes No
 If Yes, true vertical depth: _____
 Bottom Hole Location: _____
 KCC DKT #: _____

Was: 1320 FWL
 IS: 1170 FWL

AFFIDAVIT

The undersigned hereby affirms that the drilling, completion and eventual plugging of this well will comply with K.S.A. 55 et. seq.
 It is agreed that the following minimum requirements will be met:

JAN 31 2008

1. Notify the appropriate district office *prior* to spudding of well;
2. A copy of the approved notice of intent to drill *shall be* posted on each drilling rig;
3. The minimum amount of surface pipe as specified below *shall be set* by circulating cement to the top; in all cases surface pipe *shall be set* through all unconsolidated materials plus a minimum of 20 feet into the underlying formation.
4. If the well is dry hole, an agreement between the operator and the district office on plug length and placement is necessary *prior to plugging*;
5. The appropriate district office will be notified before well is either plugged or production casing is cemented in;
6. If an ALTERNATE II COMPLETION, production pipe shall be cemented from below any usable water to surface within **120 DAYS** of spud date. Or pursuant to Appendix "B" - Eastern Kansas surface casing order #133,891-C, which applies to the KCC District 3 area, alternate II cementing must be completed within 30 days of the spud date or the well shall be plugged. *In all cases, NOTIFY district office* prior to any cementing.

CONSERVATION DIVISION
 WICHITA, KS

I hereby certify that the statements made herein are true and correct to the best of my knowledge and belief.

Date: January 29, 2008 Signature of Operator or Agent: Richard Martin Title: Vice President

For KCC Use ONLY
 API # 15 - 133-27400-0000
 Conductor pipe required None feet
 Minimum surface pipe required 20 feet per ALT. I II
 Approved by: Jan 23 08 / Mr 2-12-08
 This authorization expires: 1-31-09
(This authorization void if drilling not started within 12 months of approval date.)
 Spud date: _____ Agent: _____

Remember to:

- File Drill Pit Application (form CDP-1) with Intent to Drill;
- File Completion Form ACO-1 within 120 days of spud date;
- File acreage attribution plat according to field proration orders;
- Notify appropriate district office 48 hours prior to workover or re-entry;
- Submit plugging report (CP-4) after plugging is completed (within 60 days);
- Obtain written approval before disposing or injecting salt water.

If this permit has expired (See: authorized expiration date) please check the box below and return to the address below.

Well Not Drilled - Permit Expired Date: _____
 Signature of Operator or Agent: _____

17
 29
 20
 E
 W

Mail to: KCC - Conservation Division, 130 S. Market - Room 2078, Wichita, Kansas 67202

RECEIVED
 KANSAS CORPORATION COMMISSION

FEB 12 2008

CONSERVATION DIVISION
 WICHITA, KS

IN ALL CASES PLOT THE INTENDED WELL ON THE PLAT BELOW

Plat of acreage attributable to a well in a prorated or spaced field

CORRECTED

If the intended well is in a prorated or spaced field, please fully complete this side of the form. If the intended well is in a prorated or spaced field complete the plat below showing that the well will be properly located in relationship to other wells producing from the common source of supply. Please show all the wells and within 1 mile of the boundaries of the proposed acreage attribution unit for gas wells and within 1/2 mile of the boundaries of the proposed acreage attribution unit for oil wells.

API No. 15 133-27400-0000
Operator: Quest Cherokee, LLC
Lease: Janssen, Donald E.
Well Number: 17-1
Field: Cherokee Basin CBM

Location of Well: County: Neosho
990 feet from N / S Line of Section
* 1,320 1170 feet from E / W Line of Section
Sec. 17 Twp. 29 S. R. 20 E W

Number of Acres attributable to well: _____
QTR/QTR/QTR/QTR of acreage: _____ - N/2 - S/2 - SW

Is Section: Regular or Irregular

If Section is Irregular, locate well from nearest corner boundary.

Section corner used: NE NW SE SW

PLAT

(Show location of the well and shade attributable acreage for prorated or spaced wells.)
(Show footage to the nearest lease or unit boundary line.)

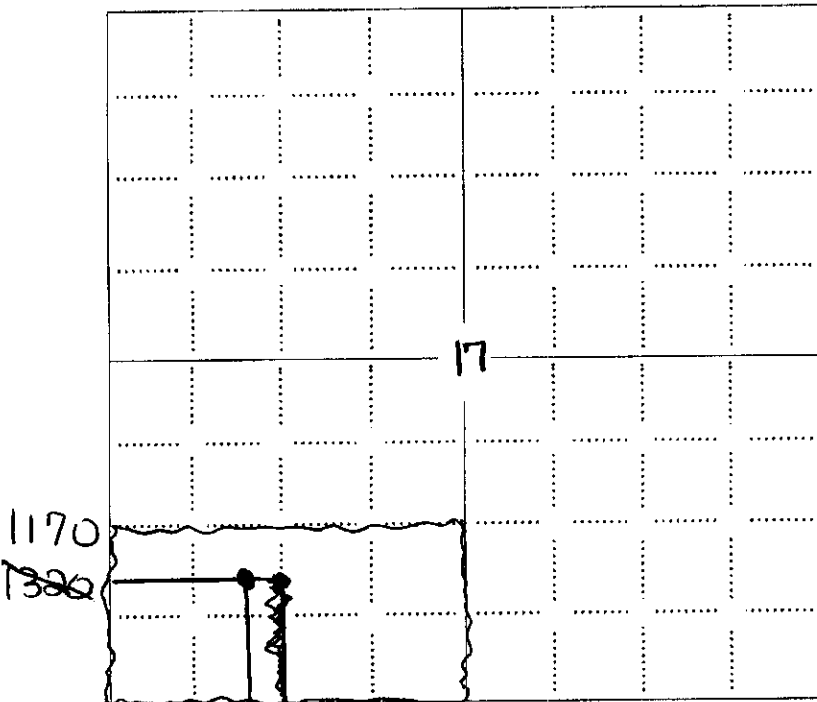

NOTE: In all cases locate the spot of the proposed drilling location.

RECEIVED
KANSAS CORPORATION COMMISSION
JAN 31 2008
CONSERVATION DIVISION
WICHITA, KS

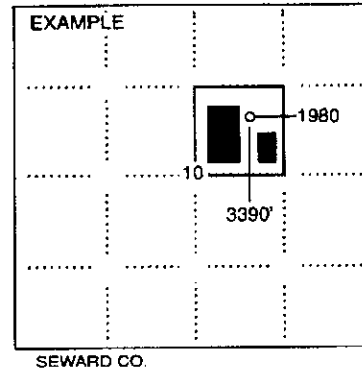

In plotting the proposed location of the well, you must show:

1. The manner in which you are using the depicted plat by identifying section lines, i.e. 1 section, 1 section with 8 surrounding sections, 4 sections, etc.
2. The distance of the proposed drilling location from the south / north and east / west outside section lines.
3. The distance to the nearest lease or unit boundary line (In footage).
4. If proposed location is located within a prorated or spaced field a certificate of acreage attribution plat must be attached: (CO-7 for oil wells, CG-8 for gas wells).

RECEIVED
KANSAS CORPORATION COMMISSION

FEB 12 2008

CONSERVATION DIVISION
WICHITA, KS

**KANSAS CORPORATION COMMISSION
OIL & GAS CONSERVATION DIVISION
APPLICATION FOR SURFACE PIT**

Form CDP-1
April 2004
Form must be Typed

Submit in Duplicate

CORRECTED

Operator Name: Quest Cherokee, LLC		License Number: 33344	
Operator Address: 210 W. Park Ave., Suite 2750		Oklahoma City OK 73107	
Contact Person: Richard Marlin		Phone Number: 405-702-7480	
Lease Name & Well No.: Janssen, Donald E. 17-1		Pit Location (QQQQ): _____ N/2 _____ S/2 _____ SW Sec. <u>17</u> Twp. <u>29</u> R. <u>20</u> <input checked="" type="checkbox"/> East <input type="checkbox"/> West 990 Feet from <input type="checkbox"/> North / <input checked="" type="checkbox"/> South Line of Section * 7,320 1170 Feet from <input type="checkbox"/> East / <input checked="" type="checkbox"/> West Line of Section Neosho County	
Type of Pit: <input type="checkbox"/> Emergency Pit <input type="checkbox"/> Burn Pit <input type="checkbox"/> Settling Pit <input checked="" type="checkbox"/> Drilling Pit <input type="checkbox"/> Workover Pit <input type="checkbox"/> Haul-Off Pit <i>(If WP Supply API No. or Year Drilled)</i>		Pit is: <input checked="" type="checkbox"/> Proposed <input type="checkbox"/> Existing If Existing, date constructed: _____ Pit capacity: 300 (bbls)	
Is the pit located in a Sensitive Ground Water Area? <input checked="" type="checkbox"/> Yes <input checked="" type="checkbox"/> No		Chloride concentration: _____ mg/l <i>(For Emergency Pits and Settling Pits only)</i>	
Is the bottom below ground level? <input type="checkbox"/> Yes <input checked="" type="checkbox"/> No		Artificial Liner? <input type="checkbox"/> Yes <input checked="" type="checkbox"/> No	
How is the pit lined if a plastic liner is not used? Air Drilling Well			
Pit dimensions (all but working pits): <u>30</u> Length (feet) <u>10</u> Width (feet) <input type="checkbox"/> N/A: Steel Pits Depth from ground level to deepest point: <u>10</u> (feet) <input type="checkbox"/> No Pit			
If the pit is lined give a brief description of the liner material, thickness and installation procedure. Well is being air drilled.		Describe procedures for periodic maintenance and determining liner integrity, including any special monitoring. Well is being air drilled with operations lasting approx. 3 days	
Distance to nearest water well within one-mile of pit <u>NA</u> feet Depth of water well _____ feet		Depth to shallowest fresh water _____ feet. Source of information: <input type="checkbox"/> measured <input type="checkbox"/> well owner <input type="checkbox"/> electric log <input type="checkbox"/> KDWR	
Emergency, Settling and Burn Pits ONLY: Producing Formation: _____ Number of producing wells on lease: _____ Barrels of fluid produced daily: _____ Does the slope from the tank battery allow all spilled fluids to flow into the pit? <input type="checkbox"/> Yes <input type="checkbox"/> No		Drilling, Workover and Haul-Off Pits ONLY: Type of material utilized in drilling/workover: <u>Air Drilled</u> Number of working pits to be utilized: <u>1</u> Abandonment procedure: <u>Air Dry, Back fill and cover.</u> Drill pits must be closed within 365 days of spud date.	
I hereby certify that the above statements are true and correct to the best of my knowledge and belief.			
January 29, 2008 Date		<u>Richard Marlin</u> Signature of Applicant or Agent	
RECEIVED JAN 31 2008 CONSERVATION DIVISION WICHITA, KS			

15733-27400-0200

KCC OFFICE USE ONLY			
Date Received: <u>1/31/08</u>	Permit Number: _____	Permit Date: <u>1/31/08</u>	Lease Inspection: <input type="checkbox"/> Yes <input checked="" type="checkbox"/> No
		Steel Pit <input type="checkbox"/>	RFAC <input type="checkbox"/> RFAS <input type="checkbox"/>

Mail to: KCC - Conservation Division, 130 S. Market - Room 2078, Wichita, Kansas 67202
 RECEIVED
FEB 12 2008
 CONSERVATION DIVISION
 WICHITA, KS