

For KCC Use: 2-19-08
 Effective Date: _____
 District # 4
 SGA? Yes No

KANSAS CORPORATION COMMISSION
 OIL & GAS CONSERVATION DIVISION

Form C-1

October 2007

Form must be Typed
 Form must be Signed
 All blanks must be Filled

NOTICE OF INTENT TO DRILL

Must be approved by KCC five (5) days prior to commencing well

Expected Spud Date: March 4 2008
month day year

OPERATOR: License# 31790 ✓
 Name: Fremont Exploration, Inc.
 Address 1: 12412 St. Andrews Dr.
 Address 2: _____
 City: Oklahoma City State: OK Zip: 73120 + _____
 Contact Person: Tom Conroy
 Phone: 405-936-0012
 CONTRACTOR: License# 33575 ✓
 Name: WW Drilling, LLC

Spot Description: _____
 SE SE NW Sec. 21 Twp. 9 S. R. 25 E W
(Q/Q/Q) 2,310 feet from N / S Line of Section
2,450 feet from E / W Line of Section

Is SECTION: Regular Irregular?

(Note: Locate well on the Section Plat on reverse side)

County: Graham
 Lease Name: Pfeifer Well #: 2-21
 Field Name: Knobel South

Is this a Prorated / Spaced Field? Yes No
 Target Formation(s): LKC

Nearest Lease or unit boundary line (in footage): 190' (common mineral owner & lease) ✓
 Ground Surface Elevation: 2595 (est.) feet MSL

Water well within one-quarter mile: Yes No ✓
 Public water supply well within one mile: Yes No ✓

Depth to bottom of fresh water: 180'

Depth to bottom of usable water: 1360'

Surface Pipe by Alternate: I II

Length of Surface Pipe Planned to be set: 250'

Length of Conductor Pipe (if any): _____

Projected Total Depth: 4150'

Formation at Total Depth: Marmaton ✓

Water Source for Drilling Operations:
 Well Farm Pond Other: Haul if necessary ✓

DWR Permit #: _____ (Note: Apply for Permit with DWR)

Will Cores be taken? Yes No

If Yes, proposed zone: _____

Well Drilled For: Oil Gas Seismic; _____ # of Holes Other: _____
 Enh Rec Storage Disposal
 Well Class: Infield Pool Ext. Wildcat Other
 Type Equipment: Mud Rotary Air Rotary Cable

If OWWO: old well information as follows:
 Operator: _____
 Well Name: _____
 Original Completion Date: _____ Original Total Depth: _____

Directional, Deviated or Horizontal wellbore? Yes No

If Yes, true vertical depth: _____

Bottom Hole Location: _____

KCC DKT #: _____

Oil & Gas leases w/pooling clauses attached. ✓

AFFIDAVIT

The undersigned hereby affirms that the drilling, completion and eventual plugging of this well will comply with K.S.A. 55 et. seq.

It is agreed that the following minimum requirements will be met:

1. Notify the appropriate district office prior to spudding of well;
2. A copy of the approved notice of intent to drill shall be posted on each drilling rig;
3. The minimum amount of surface pipe as specified below shall be set by circulating cement to the top; in all cases surface pipe shall be set through all unconsolidated materials plus a minimum of 20 feet into the underlying formation.
4. If the well is dry hole, an agreement between the operator and the district office on plug length and placement is necessary prior to plugging;
5. The appropriate district office will be notified before well is either plugged or production casing is cemented in;
6. If an ALTERNATE II COMPLETION, production pipe shall be cemented from below any usable water to surface within 120 DAYS of spud date. Or pursuant to Appendix "B" - Eastern Kansas surface casing order #133,891-C, which applies to the KCC District 3 area, alternate II cementing must be completed within 30 days of the spud date or the well shall be plugged. In all cases, NOTIFY district office prior to any cementing.

I hereby certify that the statements made herein are true and correct to the best of my knowledge and belief.

Date: 2/12/08 Signature of Operator or Agent: Tom Conroy Title: Agent

For KCC Use ONLY
 API # 15 - 065-23413-0000
 Conductor pipe required None feet
 Minimum surface pipe required 230 feet per ALT. I II
 Approved by: RA 2-14-08
 This authorization expires: 2-14-09
(This authorization void if drilling not started within 12 months of approval date.)
 Spud date: _____ Agent: _____

Remember to:
 - File Drill Pit Application (form CDP-1) with Intent to Drill;
 - File Completion Form ACO-1 within 120 days of spud date;
 - File acreage attribution plat according to field proration orders;
 - Notify appropriate district office 48 hours prior to workover or re-entry;
 - Submit plugging report (CP-4) after plugging is completed (within 60 days);
 - Obtain written approval before disposing or injecting salt water.
 - If this permit has expired (See: authorized expiration date) please check the box below and return to the address below.
 Well Not Drilled - Permit Expired Date: _____
 Signature of Operator or Agent: _____

RECEIVED
 KANSAS CORPORATION COMMISSION
 FEB 14 2008
 CONSERVATION DIVISION
 WICHITA, KS

21
9
25
 E W

IN ALL CASES PLOT THE INTENDED WELL ON THE PLAT BELOW

Plat of acreage attributable to a well in a prorated or spaced field

If the intended well is in a prorated or spaced field, please fully complete this side of the form. If the intended well is in a prorated or spaced field complete the plat below showing that the well will be properly located in relationship to other wells producing from the common source of supply. Please show all the wells and within 1 mile of the boundaries of the proposed acreage attribution unit for gas wells and within 1/2 mile of the boundaries of the proposed acreage attribution unit for oil wells.

API No. 15 - 065-23413-0000
 Operator: Fremont Exploration, Inc.
 Lease: Pfeifer
 Well Number: 2-21
 Field: Knobel South

Location of Well: County: Graham
2,310 feet from N / S Line of Section
2,450 feet from E / W Line of Section
 Sec. 21 Twp. 9 S. R. 25 E W

Number of Acres attributable to well: 20
 QTR/QTR/QTR/QTR of acreage: SE - SE - NW

Is Section: Regular or Irregular

If Section is Irregular, locate well from nearest corner boundary.

Section corner used: NE NW SE SW

PLAT

*(Show location of the well and shade attributable acreage for prorated or spaced wells.)
 (Show footage to the nearest lease or unit boundary line.)*

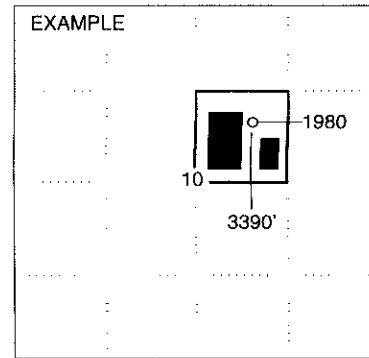
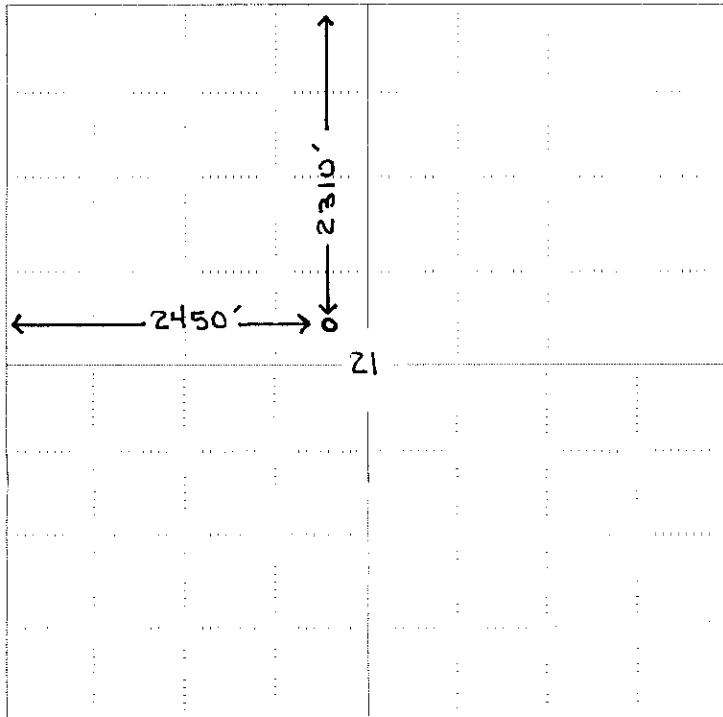

NOTE: In all cases locate the spot of the proposed drilling location.

In plotting the proposed location of the well, you must show:

1. The manner in which you are using the depicted plat by identifying section lines, i.e. 1 section, 1 section with 8 surrounding sections, 4 sections, etc.
2. The distance of the proposed drilling location from the south / north and east / west outside section lines.
3. The distance to the nearest lease or unit boundary line (in footage).
4. If proposed location is located within a prorated or spaced field a certificate of acreage attribution plat must be attached: (CO-7 for oil wells; CG-8 for gas wells).

RECEIVED
 KANSAS CORPORATION COMMISSION

FEB 14 2008

CONSERVATION DIVISION
 WICHITA, KS

KANSAS CORPORATION COMMISSION
OIL & GAS CONSERVATION DIVISION

Form CDP-1
April 2004
Form must be Typed

APPLICATION FOR SURFACE PIT

Submit in Duplicate

| | | | |
|---|--|---|--|
| Operator Name: Fremont Exploration, Inc. | | License Number: 31790 | |
| Operator Address: 12412 St. Andrews Dr. | | Oklahoma City OK 73120 | |
| Contact Person: Tom Conroy | | Phone Number: 405-936-0012 | |
| Lease Name & Well No.: Pfeifer 2-21 | | Pit Location (QQQQ): SE SE SE NW Sec. 21 Twp. 9 R. 25 <input type="checkbox"/> East <input checked="" type="checkbox"/> West 2,310 Feet from <input checked="" type="checkbox"/> North / <input type="checkbox"/> South Line of Section 2,450 Feet from <input type="checkbox"/> East / <input checked="" type="checkbox"/> West Line of Section Graham County | |
| Type of Pit: <input type="checkbox"/> Emergency Pit <input type="checkbox"/> Burn Pit <input type="checkbox"/> Settling Pit <input checked="" type="checkbox"/> Drilling Pit <input type="checkbox"/> Workover Pit <input type="checkbox"/> Haul-Off Pit (If WP Supply API No. or Year Drilled) | | Pit is: <input checked="" type="checkbox"/> Proposed <input type="checkbox"/> Existing If Existing, date constructed: _____ Pit capacity: _____ (bbls) | |
| Is the pit located in a Sensitive Ground Water Area? <input type="checkbox"/> Yes <input checked="" type="checkbox"/> No | | Chloride concentration: 2,000 mg/l <i>(For Emergency Pits and Settling Pits only)</i> | |
| Is the bottom below ground level? <input checked="" type="checkbox"/> Yes <input type="checkbox"/> No | | Artificial Liner? <input type="checkbox"/> Yes <input checked="" type="checkbox"/> No | |
| | | How is the pit lined if a plastic liner is not used? Drilling mud | |
| Pit dimensions (all but working pits): 80 Length (feet) 80 Width (feet) <input type="checkbox"/> N/A: Steel Pits Depth from ground level to deepest point: 4 (feet) <input type="checkbox"/> No Pit | | | |
| If the pit is lined give a brief description of the liner material, thickness and installation procedure. | | Describe procedures for periodic maintenance and determining liner integrity, including any special monitoring. | |
| Distance to nearest water well within one-mile of pit 3330 feet Depth of water well 80 feet | | Depth to shallowest fresh water 125 feet. Source of information: <input type="checkbox"/> measured <input type="checkbox"/> well owner <input type="checkbox"/> electric log <input checked="" type="checkbox"/> KDWR | |
| Emergency, Settling and Burn Pits ONLY: Producing Formation: _____ Number of producing wells on lease: _____ Barrels of fluid produced daily: _____ Does the slope from the tank battery allow all spilled fluids to flow into the pit? <input type="checkbox"/> Yes <input type="checkbox"/> No | | Drilling, Workover and Haul-Off Pits ONLY: Type of material utilized in drilling/workover: Drilling mud Number of working pits to be utilized: 2 Abandonment procedure: Evaporate & back-fill Drill pits must be closed within 365 days of spud date. | |
| I hereby certify that the above statements are true and correct to the best of my knowledge and belief. | | | |
| 2/12/08 Date | | <i>Tom Conroy</i> Signature of Applicant or Agent | |
| RECEIVED FEB 14 2008 CONSERVATION DIVISION WICHITA, KS | | | |
| KCC OFFICE USE ONLY Steel Pit <input type="checkbox"/> RFAC <input type="checkbox"/> RFAS <input type="checkbox"/> | | | |
| Date Received: 2/14/08 Permit Number: _____ Permit Date: 2/14/08 Lease Inspection: <input type="checkbox"/> Yes <input checked="" type="checkbox"/> No | | | |

15-005-23413-005