

2-15-07  
**CORRECTED**

For KCC Use:

Effective Date: \_\_\_\_\_

District # 3

SGA?  Yes  No

KANSAS CORPORATION COMMISSION  
OIL & GAS CONSERVATION DIVISION

**NOTICE OF INTENT TO DRILL**

Must be approved by KCC five (5) days prior to commencing well

Expected Spud Date June 28, 2007  
month day year

OPERATOR: License# 33074  
Name: Dart Cherokee Basin Operating Co. LLC  
Address: 211 W. Myrtle  
City/State/Zip: Independence KS 67301  
Contact Person: Tony Williams  
Phone: 620-331-7870

CONTRACTOR: License# 5675  
Name: McPherson Drilling

Well Drilled For:  Oil  Gas  OWWO  Seismic; # of Holes  Other  
Well Class:  Enh Rec  Storage  Disposal  Other  
Type Equipment:  Infield  Pool Ext.  Wildcat  Other  
 Mud Rotary  Air Rotary  Cable

If OWWO: old well information as follows:  
Operator: \_\_\_\_\_  
Well Name: \_\_\_\_\_  
Original Completion Date: \_\_\_\_\_ Original Total Depth: \_\_\_\_\_

Directional, Deviated or Horizontal wellbore?  Yes  No

If Yes, true vertical depth: \_\_\_\_\_

Bottom Hole Location: \_\_\_\_\_

KCC DKT #: \_\_\_\_\_

\*\* Was 3450 FSL, Is 3913 FSL  
Was 2280 FLE, Is 2265 FEL

# WAS: NLU8 360  
IS: NLU8 375

Spot  East  West  
NW SW NE Sec. 34 Twp. 29 S. R. 14E

\* 3913 FSL feet from  N /  S Line of Section  
\* 2265 FEL feet from  E /  W Line of Section

Is SECTION  Regular  Irregular?

(Note: Locate well on the Section Plat on reverse side)

County: Wilson

Lease Name: Edens Well #: B3-34

Field Name: Cherokee Basin Coal Gas Area

Is this a Prorated / Spaced Field?  Yes  No

Target Interval(s): Mississippian

\* Nearest Lease or unit boundary: 360 feet 375 feet

Ground Surface Elevation: 868 feet MSL

Water well within one-quarter mile:  Yes  No

Public water supply well within one mile:  Yes  No

Depth to bottom of fresh water: 175' +

Depth to bottom of usable water: 200'

Surface Pipe by Alternate:  1  2

Length of Surface Pipe Planned to be set: 40'

Length of Conductor Pipe required: \_\_\_\_\_

Projected Total Depth: 1448 feet

Formation at Total Depth: Mississippian

Water Source for Drilling Operations:

Well  Farm Pond  Other \_\_\_\_\_

DWR Permit #: \_\_\_\_\_

(Note: Apply for Permit with DWR )

Will Cores be taken?  Yes  No

If Yes, proposed zone: \_\_\_\_\_

**AFFIDAVIT**

RECEIVED  
KANSAS CORPORATION COMMISSION

FEB 15 2008

CONSERVATION DIVISION  
WICHITA, KS

The undersigned hereby affirms that the drilling, completion and eventual plugging of this well will comply with K.S.A. 55 et. seq.

It is agreed that the following minimum requirements will be met:

1. Notify the appropriate district office **prior** to spudding of well;
2. A copy of the approved notice of intent to drill **shall be** posted on each drilling rig;
3. The minimum amount of surface pipe as specified below **shall be set** by circulating cement to the top; in all cases surface pipe shall be set through all unconsolidated materials plus a minimum of 20 feet into the underlying formation.
4. If the well is dry hole, an agreement between the operator and the district office on plug length and placement is necessary **prior to plugging**;
5. The appropriate district office will be notified before well is either plugged or production casing is cemented in;
6. If an ALTERNATE II COMPLETION, production pipe shall be cemented from below any usable water to surface **within 120 days** of spud date. Or pursuant to Appendix "B" - Eastern Kansas surface casing order #133,891-C, which applies to the KCC District 3 area, alternate II cementing must be completed within 30 days of the spud date or the well shall be plugged. **In all cases, NOTIFY district office** prior to any cementing.

I hereby certify that the statements made herein are true and to the best of my knowledge and belief.

Date: February 13, 2008 Signature of Operator or Agent: Tony Williams Title: Safety & Environmental Manager

For KCC Use ONLY

API # 15 - 205-27240-0000

Conductor pipe required None feet

Minimum surface pipe required 40 feet per Alt. **X 2**

Approved by: Ran 6-19-07 / 2-15-08

This authorization expires: 12-19-07

(This authorization void if drilling not started within 6 months of effective date.)

Spud date: \_\_\_\_\_ Agent: \_\_\_\_\_

**Remember to:**

- File Drill Pit Application (form CDP-1) with Intent to Drill;
- File Completion Form ACO-1 within 120 days of spud date;
- File acreage attribution plat according to field proration orders;
- Notify appropriate district office 48 hours prior to workover or re-entry;
- Submit plugging report (CP-4) after plugging is completed;
- Obtain written approval before disposing or injecting salt water.
- If this permit has expired (See: authorized expiration date) please check the box below and return to the address below.

**Well Not Drilled - Permit Expired**

Signature of Operator or Agent: \_\_\_\_\_

Date: \_\_\_\_\_

34  
29  
14E

**CORRECTED**

**IN ALL CASES PLOT THE INTENDED WELL ON THE PLAT BELOW**

*Plat of acreage attributable to a well in a prorated or spaced field*

**If the intended well is in a prorated or spaced field, please fully complete this side of the form.** If the intended well is in a prorated or spaced field complete the plat below showing that the well will be properly located in relationship to other wells producing from the common source of supply. Please show all the wells and within 1 mile of the boundaries of the proposed acreage attribution unit for gas wells and within 1/2 mile of the boundaries of the proposed acreage attribution unit for oil wells.

API No. 15 - 205-27240 0000  
 Operator: Dart Cherokee Basin Operating Co. LLC  
 Lease: Edens  
 Well Number: B3-34  
 Field: Cherokee Basin Coal Gas Area  
 Number of Acres attributable to well: 40  
 QTR / QTR / QTR of acreage: NW - SW - NE

Location of Well: County: Wilson  
3913 FSL feet from  N /  S Line of Section  
2265 FEL feet from  E /  W Line of Section  
 Sec. 34 Twp. 29 S. R. 14E  East  West

Is Section:  Regular or  Irregular

**If Section is Irregular, locate well from nearest corner boundary.**

Section corner used:  NE  NW  SE  SW

**PLAT**

*(Show location of the well and shade attributable acreage for prorated or spaced wells.)*

*(Show footage to the nearest lease or unit boundary line.)*

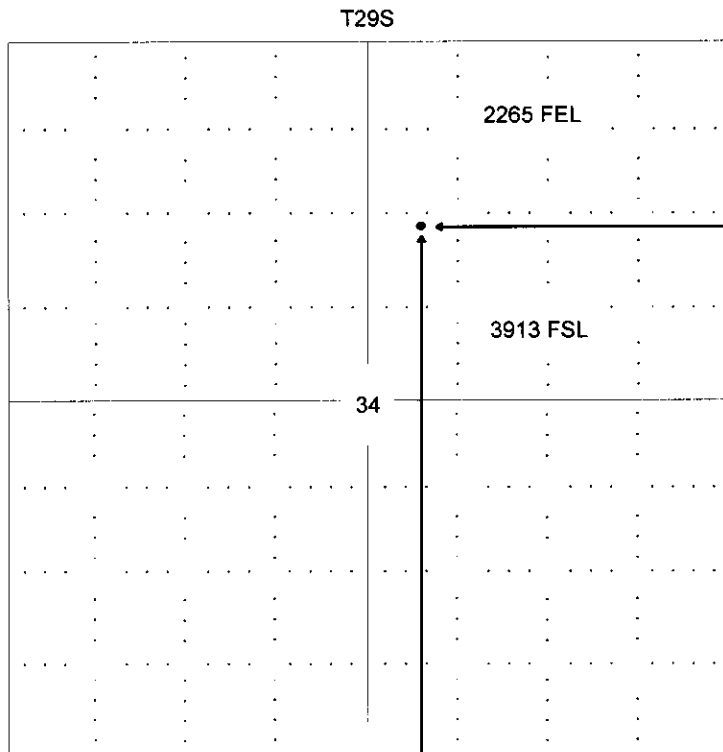

R14E

RECEIVED  
 KANSAS CORPORATION COMMISSION  
**FEB 15 2008**  
 CONSERVATION DIVISION  
 WICHITA, KS

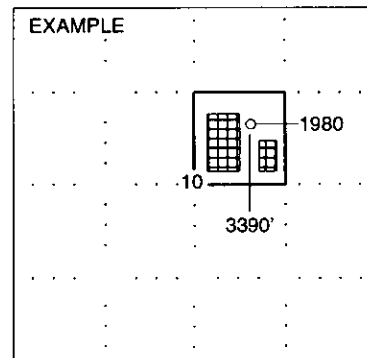

SEWARD CO.

Wilson Co.

**NOTE: In all cases locate the spot of the proposed drilling location.**

**In plotting the proposed location of the well, you must show:**

1. The manner in which you are using the depicted plat by identifying section lines, i.e. 1 section, 1 section with 8 surrounding sections, 4 sections, etc.
2. The distance of the proposed drilling location from the section's south / north and east / west.
3. The distance to the nearest lease or unit boundary line.
4. If proposed location is located within a prorated or spaced field a certificate of acreage attribution plat must be attached: (CO-7 for oil wells; CG-8 for gas wells).

KANSAS CORPORATION COMMISSION  
OIL & GAS CONSERVATION DIVISION  
APPLICATION FOR SURFACE PIT

**CORRECTED**

Submit in Duplicate

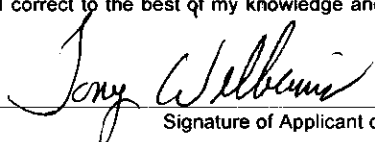
Operator Name: Dart Cherokee Basin Operating Co. LLC		License Number: 33074	
Operator Address: 211 W. Myrtle		Independence KS 67301	
Contact Person: Tony Williams		Phone Number: ( 620 ) 331 - 7870	
Lease Name & Well No.: Edens B3-34		Pit Location (QQQQ): NW SW NE Sec. 34 Twp. 29 R. 14E <input checked="" type="checkbox"/> East <input type="checkbox"/> West 3913 FSL Feet from <input type="checkbox"/> North / <input checked="" type="checkbox"/> South Line of Section 2265 FEL Feet from <input checked="" type="checkbox"/> East / <input type="checkbox"/> West Line of Section Wilson County	
Type of Pit: <input type="checkbox"/> Emergency Pit <input type="checkbox"/> Burn Pit <input type="checkbox"/> Settling Pit <input checked="" type="checkbox"/> Drilling Pit <input type="checkbox"/> Workover Pit <input type="checkbox"/> Haul-Off Pit <small>(If WP Supply API No. or Year Drilled)</small>	Pit is: <input checked="" type="checkbox"/> Proposed <input type="checkbox"/> Existing If Existing, date constructed: Pit capacity: 926 (bbls)		
Is the pit located in a Sensitive Ground Water Area? <input type="checkbox"/> Yes <input checked="" type="checkbox"/> No		Chloride concentration: _____ mg/l <small>(For Emergency Pits and Settling Pits only)</small>	
Is the bottom below ground level? <input checked="" type="checkbox"/> Yes <input type="checkbox"/> No	Artificial Liner? <input type="checkbox"/> Yes <input checked="" type="checkbox"/> No	How is the pit lined if a plastic liner is not used? <b>Natural Clays</b>	
Pit dimensions (all but working pits): 35 Length (feet) 30 Width (feet) N/A: Steel Pits Depth from ground level to deepest point: 5 (feet)			
If the pit is lined give a brief description of the liner material, thickness and installation procedure.		Describe procedures for periodic maintenance and determining liner integrity, including any special monitoring.	
Distance to nearest water well within one-mile of pit N/A feet Depth of water well _____ feet		Depth to shallowest fresh water _____ feet. Source of information: _____ measured _____ well owner _____ electric log WICHITA/KRVR	
<b>Emergency, Settling and Burn Pits ONLY:</b> Producing Formation: _____ Number of producing wells on lease: _____ Barrels of fluid produced daily: _____ Does the slope from the tank battery allow all spilled fluids to flow into the pit? <input type="checkbox"/> Yes <input type="checkbox"/> No		<b>Drilling, Workover and Haul-Off Pits ONLY:</b> Type of material utilized in drilling/workover: Air Number of working pits to be utilized: one Abandonment procedure: Air dry, fill Drill pits must be closed within 365 days of spud date.	
I hereby certify that the above statements are true and correct to the best of my knowledge and belief.			
February 13, 2008 Date		 Signature of Applicant or Agent	

RECEIVED  
KANSAS CORPORATION COMMISSION

FEB 15 2008

CONSERVATION DIVISION  
WICHITA/KRVR

15-205-27240-0000

KCC OFFICE USE ONLY

Date Received: 2/15/08 Permit Number: \_\_\_\_\_ Permit Date: 2/15/08 Lease Inspection:  Yes  No